

Property Description

Offered with NO ONWARD CHAIN and LOCATED OPPOSITE LAWNS PARK is a FIRST FLOOR ONE BEDROOM apartment with SECURE GATED PARKING. The property has BUS LINKS TO ROMFORD STATION CLOSE BY via COLLIER ROW LANE and would be IDEAL FOR A FIRST PURCHASE! Call KEYSTONES today to BOOK YOUR VIEWING!

The property is located on the first floor with an entrance hallway giving access to all rooms. The 13ft double bedroom is located on the left, the bathroom and 11ft kitchen are located on the right and last there is a 20ft dual aspect lounge diner at the bottom of the hallway. Externally there is a secure gated parking area with communal gardens.

Entrance Hallway

Lounge/Diner - 20'7 x 10'8

Kitchen - 11'6 x 6'7

Bedroom - 13'5 x 10'8

Bathroom - 7'0 x 5'8

Communal Garden

Secure Gated Parking

Keystones property also offer a professional, ARLA accredited Lettings and Management Service. If you are considering renting your property in order to purchase, are looking at buy to let or would like a free review of your current portfolio then please call the Lettings Branch Manager on the number shown above.

Disclaimer: Information provided about this property does not constitute or form part of an offer or contract, nor may be it be regarded as representations. All interested parties must verify accuracy and your solicitor must verify tenure/lease information, fixtures & fittings and, where the property has been extended/converted, planning/building regulation consents.

All dimensions are approximate and quoted for guidance only as are floor plans which are not to scale and their accuracy cannot be confirmed. Reference to appliances and/or services does not imply that they are necessarily in working order or fit for the purpose.

"Our Service is Key"

1 Bedroom
First Floor Apartment
Offers Over £220,000
Hillcrest Court, Collier Row, Romford, RM5 3HB



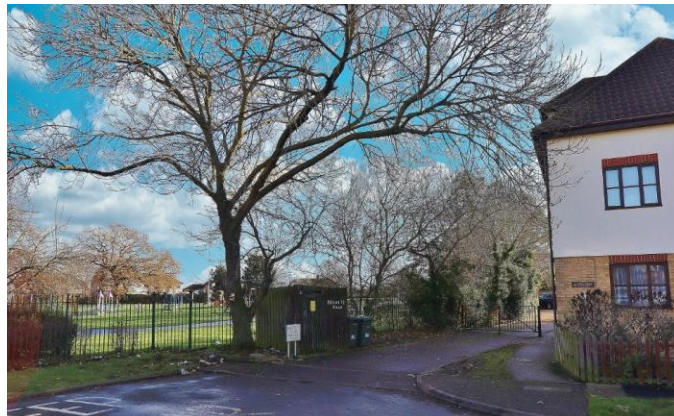

FIRST FLOOR

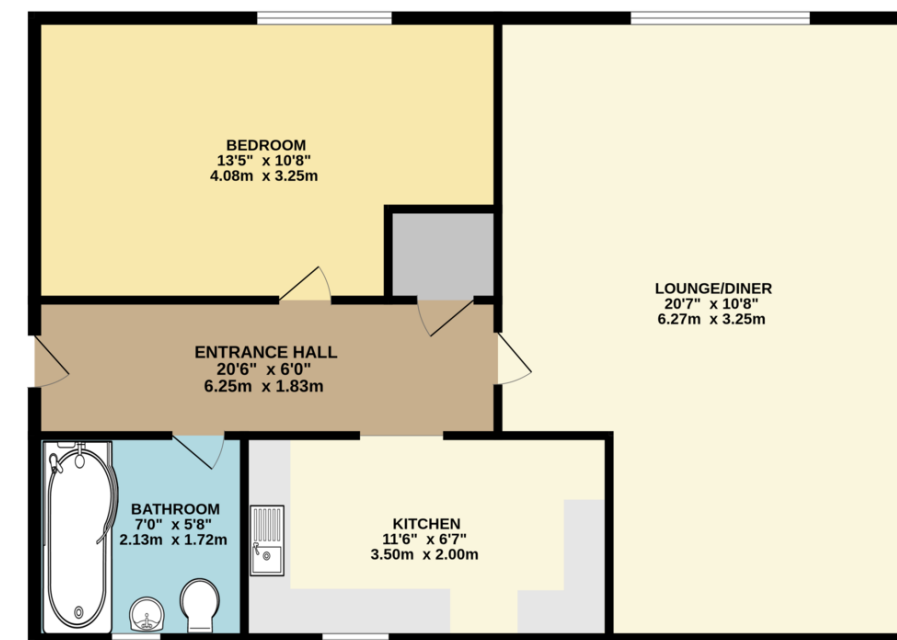

While every attempt has been made to ensure the accuracy of the floorplan contained here, measurements of doors, windows, rooms and any other items are approximate and no responsibility is taken for any error, omission or mis-statement. This plan is for illustrative purposes only and should be used as such by any prospective purchaser. The services, systems and appliances shown have not been tested and no guarantee as to their operability or efficiency can be given.
 Made with Metropix ©2022