

Agents Note: Whilst every care has been taken to prepare these particulars, they are for guidance purposes only. All measurements are approximate and whilst every care has been taken to ensure their accuracy, they should not be relied upon and potential buyers/tenants are advised to recheck the measurements.

Graph_c_1_340_r180%

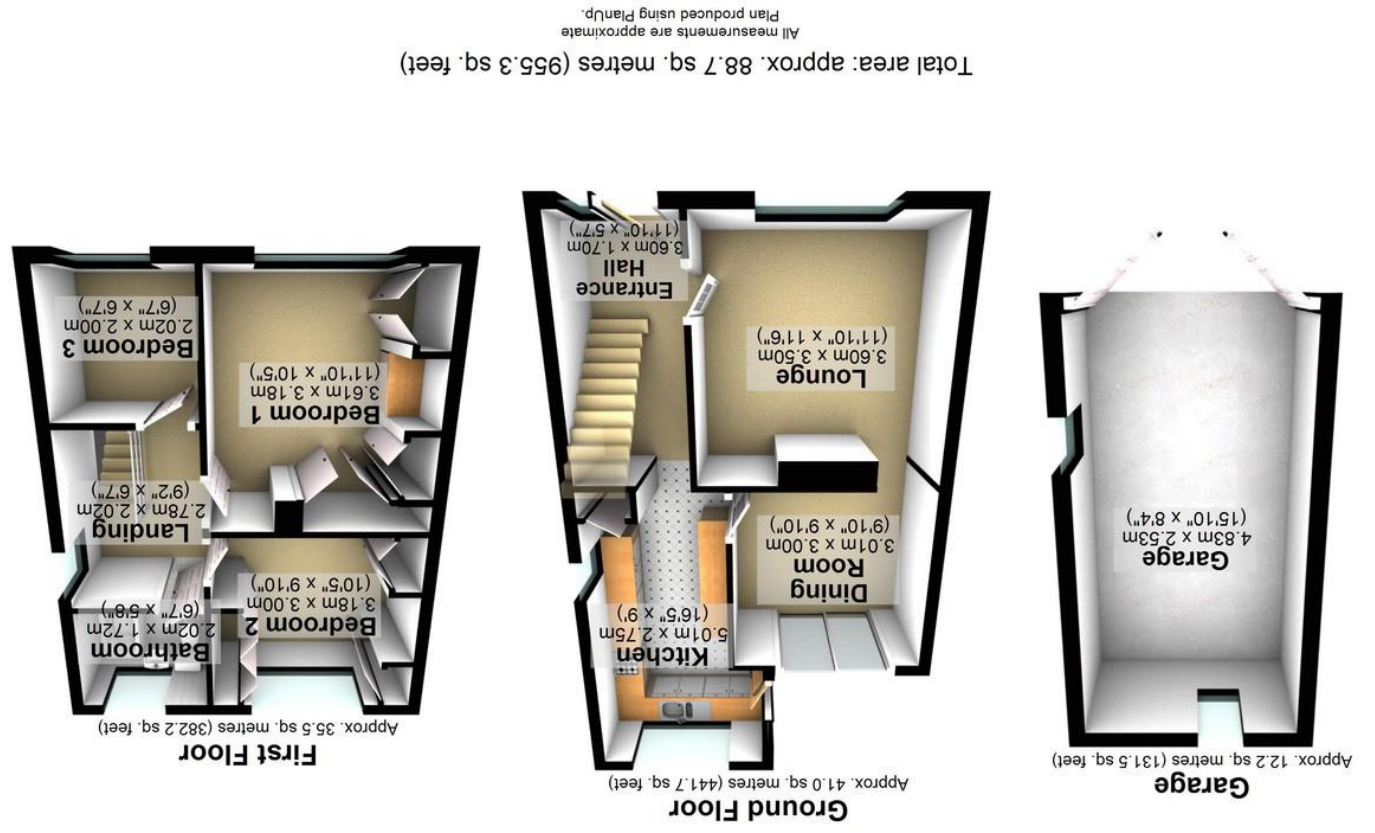



125 Mount View Road | | Sheffield | S8 8PJ Property Tenure: Freehold

Quietly tucked away on this well sought after residential after residential road in the very heart of ultra popular Norton Lees is this superb three bedroomed semi detached family home. With a wealth of local amenities as well as reputable local schools and the ever popular Graves Park all within easy walking distance this property will be incredibly popular with the growing family market. Enjoying a super deceptive spacious feel that is flooded with light and with accommodation spanning two superb floors this property briefly consists of entrance hallway, lounge, dining room, breakfasting kitchen, three bedrooms and family bathroom. Outside is off road parking, detached garage and large private garden that would be perfect for families.



PROPERTY FEATURES

- THREE BEDROOMS
- SEMI-DETACHED FAMILY HOME
- LARGE GARDEN
- DETACHED GARAGE
- CLOSE TO GREAT TRANSPORT LINKS
- REPUTABLE LOCAL SCHOOLS
- CLOSE TO GRAVES PARK
- POTENTIAL FOR EXPANSION
- CLOSE TO LOCAL AMENITIES
-

ASKING PRICE OF £285,000

