







Seymours



Cranleigh Court Farnborough, GU14 0HE £550,000

Arrange a viewing: 01276 534100

Property Details

-  4 bedrooms
-  1 baths
-  EPC Rating TBC
-  1295 sqft (Inc Garage)
-  Famborough Main (1.0 miles)

- Four double bedrooms
- Modern kitchen and bathroom
- Cloakroom
- Two good receptions
- Southerly facing rear garden
- Driveway parking for several cars leading to garage
- Local shops and amenities at Cove
- Near to Famborough town and stations

This beautifully presented family home is brought to the market in excellent condition and offers two spacious reception rooms with a modern kitchen. Upstairs there are four double bedrooms and a recently fitted bathroom. To the rear of the house is an attractive mature southerly facing garden and to the front of the property is driveway parking for several cars leading to the garage. The house is located in this popular close and benefits from being near to local shops and amenities as well as being convenient for Famborough with its range of shops and also the mainline station and Famborough college.

[01276 534100](tel:01276534100) / james@seymours-blackwater.co.uk



Cranleigh Court

Approximate Gross Internal Area = 107 sq m / 1152 sq ft
 Approximate Garage Internal Area = 13.2 sq m / 143 sq ft
 Approximate Total Internal Area = 120.2 sq m / 1295 sq ft
 (excludes store)

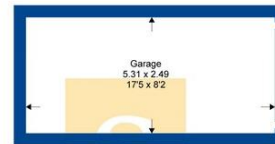

Garage = 13.2 sqm / 143 sqft

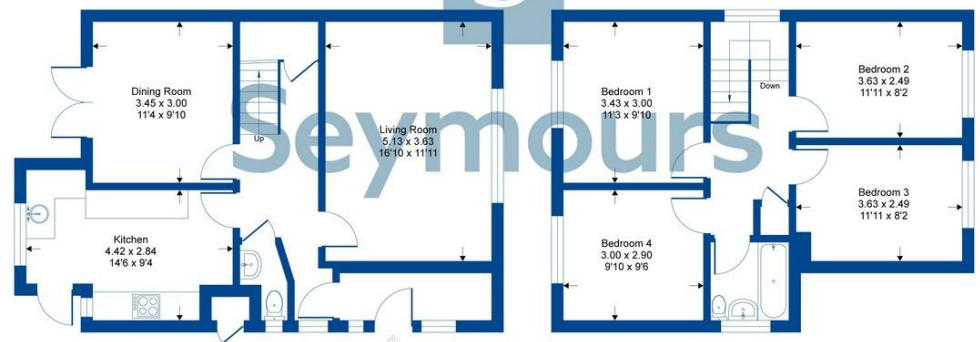

Ground Floor = 57.1 sqm / 615 sqft

First Floor = 49.8 sqm / 537 sqft

Whilst every attempt has been made to ensure the accuracy of the floor plan contained here, measurements of doors, windows, rooms and any other items are approximate and no responsibility is taken for any error, omission or mis-statement. This plan is for illustrative purposes only and should be used as such by any prospective purchaser.