



Jones Lane
Hythe, Southampton

- MODERN TOP FLOOR APARTMENT
- DOUBLE BEDROOM WITH STORAGE
- GOOD SIZED BATHROOM
- LOUNGE

Shared Ownership - £126,000

EPC Rating

TBC





Property Description

COMMUNAL ENTRANCE LOBBY The communal entrance lobby has a double glazed entrance door and an entry phone system. Inside you will find stairs leading to all floors.

APARTMENT ENTRANCE HALL The entrance hallway has a wooden front door and oak effect laminate flooring. The hallway benefits from two full height storage cupboards, perfect for keeping your belongings organised. The intercom system provides an extra layer of security. Doors lead from the hallway to all the rooms in the apartment, and there is a loft hatch with access to the loft and extra storage space.



LOUNGE 14' 1" x 11' 20" (4.29m x 3.86m) The spacious lounge is complete with a front aspect window flooding the room with natural light, oak effect laminate flooring, and ample space for lounge furniture. With room to spare for a dining table and chairs, this versatile living space is perfect for entertaining guests or relaxing after a long day.



KITCHEN 9' 96" x 7' 7" (5.18m x 2.31m) A modern kitchen with a good range of oak wall and base units providing ample storage. There are dark grey mottled worktops, coordinated with white tiled splashbacks and a stainless steel sink and drainer with chrome mixer tap. There is space for a fridge freezer, washing machine, and tumble dryer, and the kitchen comes complete with a built-in Beko electric oven, hob, and extractor fan.



DOUBLE BEDROOM 12' 36" x 10' 60" (4.57m x 4.57m) The double bedroom boasts a front aspect window with fitted roller blind, light oak effect laminate flooring, built-in mirrored wardrobes, and a full-height airing cupboard with additional storage. There is also a ceiling fan light.



BATHROOM 7' 6" x 6' 96" (2.29m x 4.27m) The bathroom has a modern white suite complete with a bath and mains shower and a fitted glass shower screen. There is a low level W.C and pedestal wash hand basin, a shaver point and extractor fan. The bathroom is finished with beautiful pale grey ceramic wall tiles that perfectly complement the attractive mottled grey floor tiles.

STORAGE This apartment has 2 full height storage cupboards in the entrance hallway, along with an airing cupboard and fitted wardrobes in the bedroom. Being on the top floor, this apartment also has the added benefit of a loft.

OUTSIDE PROPERTY Outside the property there is bin store and a convenient and secure bike store. The apartment has it's own allocated car parking space and there are additional visitor spaces for guests.



PROPERTY INFORMATION A beautiful top floor apartment in the charming market town of Hythe. Boasting gas central heating, UPVC double glazing, and an intercom entry system for added security, this property is not only well-maintained and decorated throughout but also offers modern fittings in both the kitchen and bathroom.

With good storage space and plenty of natural light, this apartment provides a bright and spacious living environment for its lucky new occupants. The EPC rating of C ensures energy efficiency, while the NFDCC council tax band A keeps living costs manageable. There are 106 years left on the lease, the management company is ABRI, and the housing association is Swaythling Housing Society Limited.

The monthly charge is £154.28 which includes £133.33 service charge, £12 management fee and £8.95 insurance.

SHARED OWNERSHIP This property is sold with a 75% Shared Ownership.

The remaining 25% share is charged as a rental of £129.19

Buyers can buy the additional 25%.

LOCATION This lovely apartment is just a short walk away from the centre of Hythe, giving the the convenience of supermarkets, a post office, independent shops, and restaurants, while also boasting good bus routes and transport links for easy commuting.

Hythe also boasts a waterfront promenade, with views of Southampton Water, and there are lovely parks to enjoy.

For nature lovers and outdoor enthusiasts, the New Forest National Park and the nearby beaches at Lepe and Calshot are just a short drive away. Explore the stunning landscapes, enjoy scenic walks or partake in a variety of outdoor activities. Hythe has good transport links to Southampton & beyond.



GROUND FLOOR

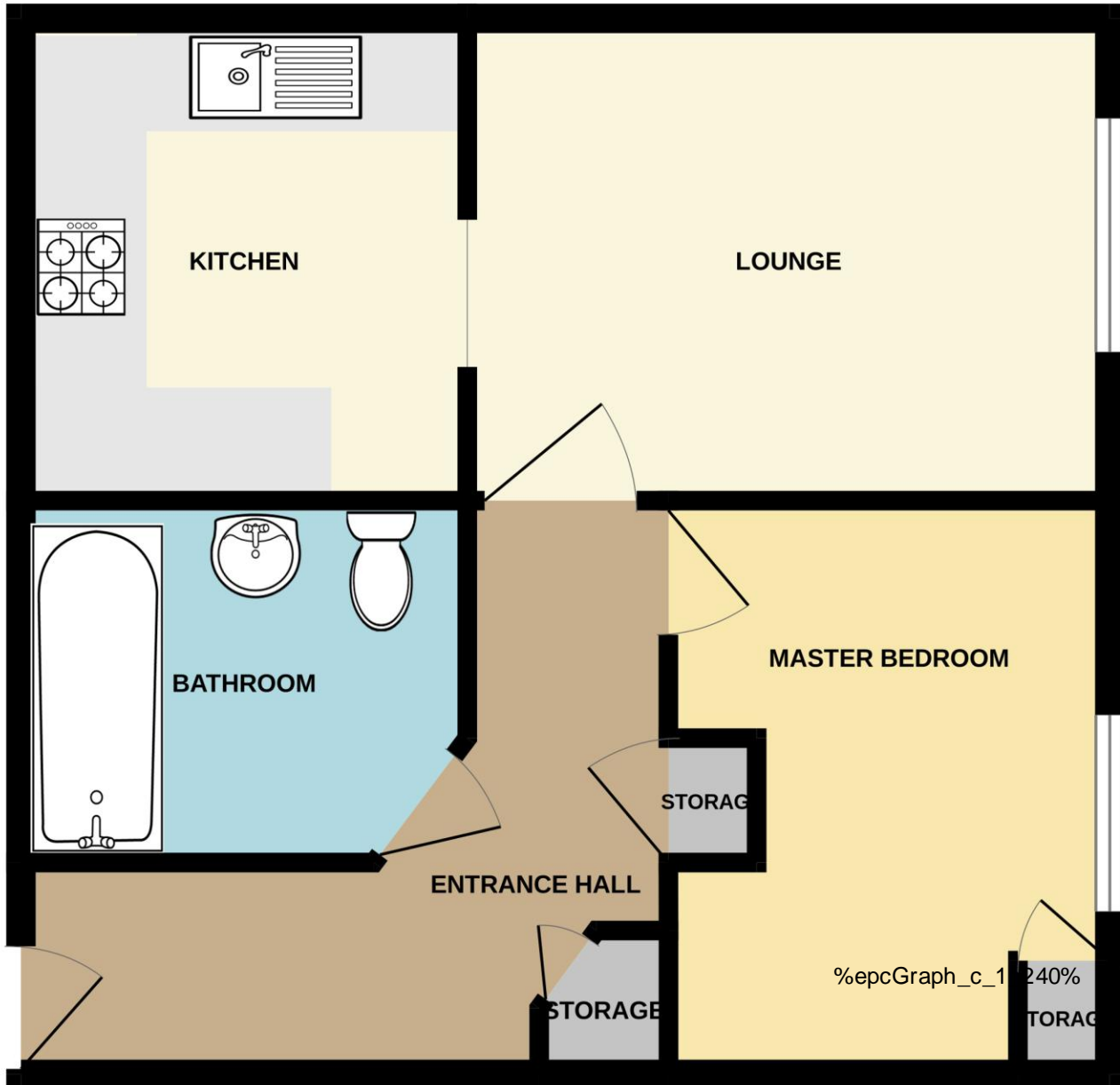

Hotspur House
Prospect Place
Hythe
Southampton
Hampshire
SO45 6AU

www.hytheandwaterside.com
darren@hytheandwaterside.com
0238 0845 434

Agents Note: Whilst every care has been taken to prepare these sales particulars, they are for guidance purposes only. All measurements are approximate are for general guidance purposes only and whilst every care has been taken to ensure their accuracy, they should not be relied upon and potential buyers are advised to recheck the measurements

