



Seymours



The Glebe
Camberley, GU17 9BB
£450,000

Arrange a viewing: 01276 534100

Property Details

-  3 bedrooms
-  1 baths
-  EPC Rating TBC
-  1572 sqft (inc garage)
-  Blackwater (0.4 miles)

- No chain
- Three bedrooms
- Three receptions
- Sunroom
- Cloakroom and bathroom
- Large mature rear garden
- Garage and driveway parking
- Convenient for local shops, amenities and railway station
- Good local schools

NO ONWARD CHAIN. An extended three-bedroom semi-detached home which benefits from a spacious Living room as well as a family room and dining room. There is also a sunroom and a downstairs cloakroom. To the rear and side is a very large mature garden and the property also has a detached garage as well as driveway parking. The house is conveniently located in this tucked away dose and is close to local shops, amenities, and railway station at Blackwater as well as good local schools and attractive countryside at Hawley woods.

[01276 534100](tel:01276534100) / james@seymours-blackwater.co.uk



The Glebe

Approximate Gross Internal Area = 126.3 sq m / 1359 sq ft
 Garage = 19.8 sq m / 213 sq ft
 Total = 146.1 sq m / 1572 sq ft

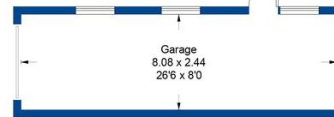

(Not Shown In Actual Location / Orientation)

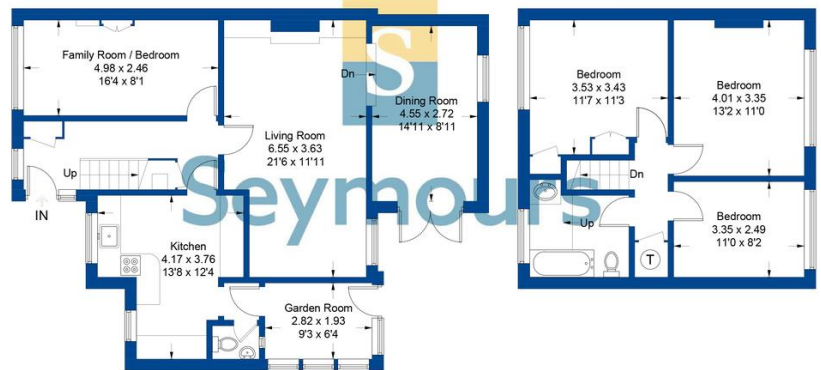

Ground Floor = 79.8 sq m / 859 sq ft

First Floor = 46.5 sq m / 500 sq ft

Illustration for identification purposes only, measurements are approximate, not to scale. FloorplansUsketch.com © 2023 (ID971148)