



Seymours



Kingsway
Camberley, GU17 0JW
£335,000 Offers In Excess Of

Arrange a viewing: 01276 534100

Property Details

 3 bedrooms

 1 baths

 EPC Rating A

 852 Sqft

 Station Name (0.0 miles)

- Three bedrooms
- Living room
- Kitchen/dining room
- Porch
- Bathroom
- Private enclosed rear garden
- Driveway parking for two cars
- Convenient for local shops and amenities
- and railway station

A well-presented three bedroom home with the benefit of a recently added large porch. The property has driveway parking to the front for two cars as well as an attractive private and enclosed rear garden. To the rear of the garden is an easily accessible storage space/workshop, which was converted from a garage. The property includes solar panels and benefits from an efficient EPC rating. It is situated in Blackwater and is walking distance from several local shops, amenities, and a railway station – as well being near good local schools and pleasant countryside.

[01276 534100](tel:01276534100) / james@seymours-blackwater.co.uk



Kingsway

Approximate Gross Internal Area = 69.5 sq m / 748 sq ft
Garage = 9.7 sq m / 104 sq ft
Total = 79.2 sq m / 852 sq ft

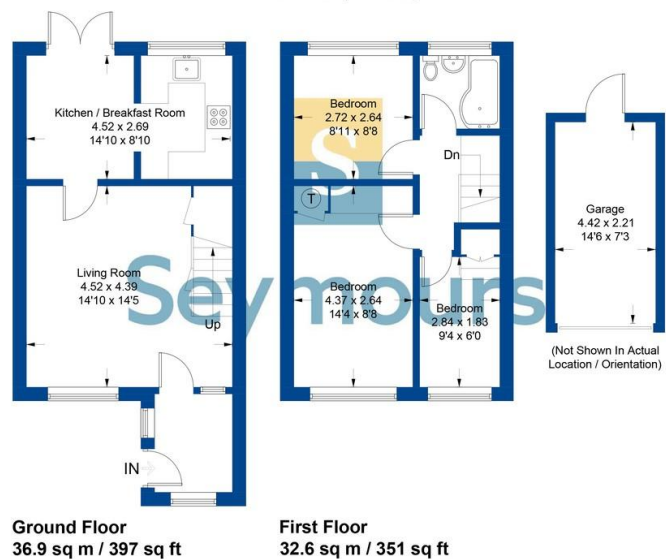

Ground Floor
36.9 sq m / 397 sq ft

First Floor
32.6 sq m / 351 sq ft

Illustration for identification purposes only, measurements are approximate, not to scale. FloorplansUsketch.com © 2023 (ID979557)