

wh



10 Parham House, Chatsworth Square, Hove, BN3 1WF

Asking Price Of £430,000

- TWO DOUBLE BEDROOMS
- ENSUITE SHOWER ROOM
- BATHROOM
- KITCHEN/BREAKFAST ROOM
- DOUBLE ASPECT LIVING/DINING ROOM
- COVERED ALLOCATED PARKING SPACE
- GATED DEVELOPMENT
- CENTRAL LOCATION

wh
whitlock & heaps

01273 778577
whitlockandheaps.co.uk

This first floor apartment forms part of this purpose built gated development being presented in excellent order throughout and being sold with no onward chain. The two double bedroom accommodation benefits from an ensuite shower room to the master bedroom and separate family bathroom. The spacious accommodation features a south/west facing living/dining room with 'Juliet' balcony and a separate kitchen/breakfast room with integrated appliances.

The flat also benefits from an allocated covered parking space.

ENTRANCE HALL Fitted coat/store cupboard, second fitted cupboard with hot water cylinder, radiator, entry system telephone.

LIVING/DINING ROOM Double aspect, south/west facing with 'Juliet balcony', two radiators, two UPVC double glazed windows.

KITCHEN/BREAKFAST ROOM Incorporating stainless steel sink unit with drainer and mixer tap, adjacent laminate work surface with cupboards and drawers under, matching eye level wall cupboards, inset four ring ceramic hob with concealed extractor over, eye level double oven, integrated fridge/freezer and dishwasher, washing machine, UPVC double glazed window, tiled splashback, radiator, tiled floor, space for table and chairs.

BEDROOM 1 Double aspect with two UPVC double glazed windows, fitted wardrobe, radiator.

ENSUITE SHOWER ROOM Comprising white suite with walk in shower, pedestal wash hand basin, low level w.c., radiator, tiled walls.

BEDROOM 2 UPVC double glazed window, fitted wardrobes, radiator.

BATHROOM White suite comprising panelled bath with mixer tap and shower attachment, pedestal wash hand basin, low level w.c., tiled walls, radiator.

OUTSIDE Underground allocated parking space.

OUTGOINGS Lease: 125 years from 1st January 1999
Service Charge: £524.09 per quarter
Ground Rent: £200 per annum

EPC: Current 78C Potential 82B

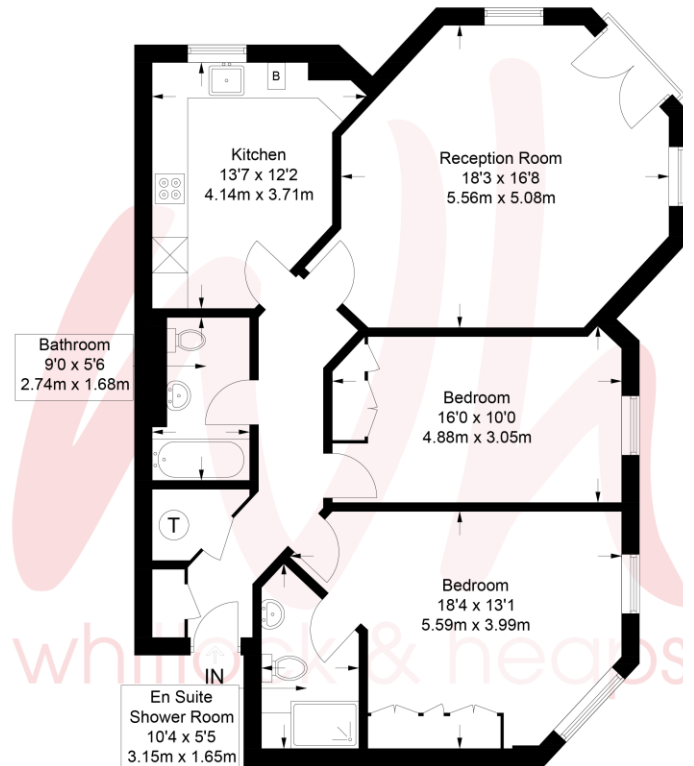

First Floor

Approximate Gross Internal Area = 976 sq ft / 90.7 sq m

Illustration for identification purposes only, measurements are approximate, not to scale. © Whitlock and Heaps 2022



Portslade Branch

48 Boundary Road, Portslade BN3 4EF
portslade@whitlockandheaps.co.uk
01273 422706

Hove Branch

65 Sackville Road, Hove BN3 3WE
hove@whitlockandheaps.co.uk
01273 778577



Disclaimer: Whitlock & Heaps have produced these particulars in good faith and they are set out as a general guide. Accuracy is not guaranteed, nor do they form part of any contract. If there is any particular aspect of these details which you require any confirmation, please do contact us, especially if contemplating a long journey. All measurements are approximate. Fixtures and fittings, other than those mentioned above, to be agreed with the seller. Any services, systems or appliances at the property have not been tested.