







Seymours



# Rosemary Gardens Camberley, GU17 0NH £550,000

Arrange a viewing: 01276 534100

## Property Details

-  3 bedrooms
-  2 baths
-  EPC Rating TBC
-  1526 (Inc Garage & Outbuilding)
-  Blackwater Station (0.7 miles)

- Three bedrooms
- Spacious open plan Living/dining/kitchen
- Two beautiful bathrooms
- Magnificent living space
- Large mature rear garden and garden room
- Driveway parking leading to garage
- Convenient location for shops and amenities
- Near to Blackwater nature reserve
- Juliet Balcony

A superbly enlarged and beautifully refurbished chalet which offers fantastic open plan living space as well as versatility and flexibility to the incoming purchaser. Downstairs is made up of a magnificent open plan Kitchen/dining living room with a stunning modern kitchen and doors out onto the beautiful, landscaped garden and also to the modern office space. To the front of the property are two bedrooms and a modern refitted contemporary bathroom. Upstairs benefits from a fabulous main bedroom with a beautifully constructed en suite bathroom. To the front of the property is a driveway leading to a garage. The property is ideally situated near to Blackwater and the local shops and amenities as well as good local schools and Blackwater nature reserve.

[01276 534100](tel:01276534100) / [james@seymours-blackwater.co.uk](mailto:james@seymours-blackwater.co.uk)



### Rosemary Gardens

Approximate Gross Internal Area = 116.2 sq m / 1251 sq ft  
 Approximate Garage Internal Area = 12.7 sq m / 137 sq ft  
 Approximate Outbuilding Internal Area = 12.8 sq m / 138 sq ft  
 Approximate Total Internal Area = 141.7 sq m / 1526 sq ft

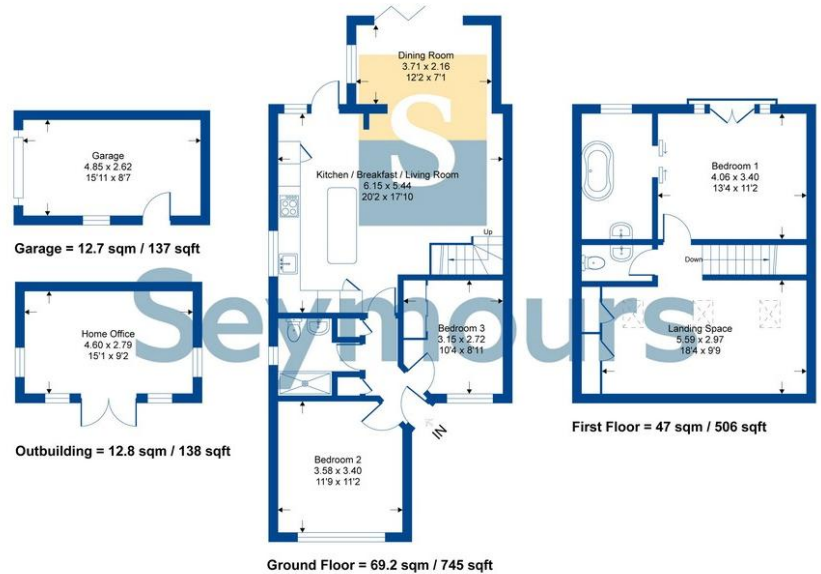

Whilst every attempt has been made to ensure the accuracy of the floor plan contained here, measurements of doors, windows, rooms and any other items are approximate and no responsibility is taken for any error, omission or mis-statement. This plan is for illustrative purposes only and should be used as such by any prospective purchaser.