

105 Bell Barn Road

Birmingham City Centre

B15 2GL

Asking Price Of £210,000

Two Bedroom Apartment

Second Floor

Open-Plan Living Space

Two Bathrooms



Property Description

DESCRIPTION A bright and spacious two-bedroom two-bathroom second floor apartment which has been tastefully refurbished to a high standard, located in a popular Park Central apartment block.

The internal accommodation comprises an entrance hallway with storage and airing cupboards, leading to an open-plan kitchen / lounge / diner with a south-west facing balcony, with two double bedrooms (one of which has an ensuite bathroom), and a family bathroom.

As mentioned previously, the property has been refurbished to a high standard throughout, with new flooring and painting throughout, the kitchen features an extended breakfast bar in the kitchen area, and fitted furniture in the bedrooms and bathrooms.

Outside of the property there is an allocated parking space within the development's secure car park. The balcony offers a comfortable outdoor space and is South-West facing offering an abundance of sunlight throughout the day. The property is being sold with no upward chain and benefits from an EPC Rating of B, which places it well above the UK average for energy efficiency. This apartment is an ideal starter home or buy-to-let investment.

LOCATION The development is overlooking and in close proximity to a welcoming green park-for which Park Central is named after.

Sunset Park - Which has outdoor events space and is good for exercise and also have jogging track.

Moonlit Park - Is mainly kids friendly which has basketball court for practising and also for kids having Climbing frame, Swings, Slides and dog walking as well.

The development has a modern feel throughout and is located just a short walk away from both New Street Train and metro station, and a plethora of popular bar, restaurant and shopping amenities including the prestigious Mailbox complex, Bullring shopping centre and Grand Central. Beyond is the city's bustling financial district whilst immediate access to good road and transport

Floor Layout

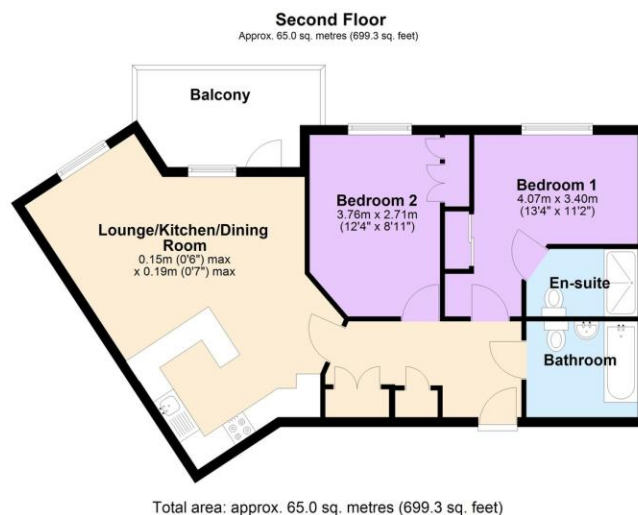

Total approx. floor area 699 sq ft (65 sq m)

Whilst every attempt has been made to ensure the accuracy of the floor plan contained here, measurements of doors, windows, rooms and any other items are approximate and no responsibility is taken for any error, omission, or mis-statement. This plan is for illustrative purposes only and should be used as such by any prospective purchaser. The services, systems and appliances shown have not been tested and no guarantee as to their operability or efficiency can be given. Made with Metropix ©2019.

Score	Energy rating	Current	Potential
92+	A		
81-91	B	84 B	87 B
69-80	C		
55-68	D		
39-54	E		
21-38	F		
1-20	G		

