



Apartment 8,52 South Marine Drive
Bridlington

YO15 3JJ

ASKING PRICE OF

£240,000

2 Bedroom Apartment

Est. 1891
Ulllyotts
Estate Agents

01262 401401



View



2



1



2



Allocated
Parking



Gas Central Heating

Apartment 8, 52 South Marine Drive, Bridlington, YO15 3JJ

This stunning second-floor apartment is beautifully presented throughout and offers stylish, contemporary living with sea views, with the added convenience of lift access. The property features two well-proportioned bedrooms, including a master bedroom with ensuite, alongside a modern shower room. At the heart of the home is an impressive open-plan lounge, dining, and kitchen area, perfectly designed for both everyday living and entertaining. A standout feature is the spacious balcony, ideal for dining, seating, and relaxing while enjoying fantastic views across the south-facing seafront stretching up towards Hornsea. Offered with no onward chain and benefitting from an allocated parking space, this exceptional apartment is ready to move straight into.

South Marine Drive enjoys a prime position to the south of the town centre, just moments from the beautiful South Bay beach. This highly sought-after location offers an exceptional blend of convenience and coastal living. Residents can take full advantage of the nearby Belvedere Golf Course, as well as immediate access to the seafront and the picturesque South Marine Drive promenade-perfect for leisurely walks and enjoying the sea air. The area is also home to a variety of popular local amenities, including The Bridlington Spa, a Mediterranean restaurant, a Chinese restaurant, the South Cliff public house, and the former lifeboat station, which now hosts a charming pop-up serving fresh seafood dishes and coffee. Altogether, it provides an ideal setting for those seeking a relaxed lifestyle by the coast.



Communal Entrance



Entrance Hall



Lounge/Dining area



Lounge/Dining Area

Accommodation

COMMUNAL ENTRANCE

Beautifully presented with lift and stairs to all floors.

ENTRANCE HALL

9' 3" x 6' 1" (2.82m x 1.86m)

with doors to all rooms.

LOUNGE/DINING AREA

14' 1" x 13' 3" (4.31m x 4.06m)

A spacious open plan lounge with a superb dining area, featuring a uPVC door opening onto a balcony providing seating and dining space with attractive sea views. A further window enjoys stunning sea views, filling the room with natural light. Radiator to wall. Open access leading to:

KITCHEN

18' 10" x 9' 7" (5.76m x 2.94m)

Fitted with a range of white gloss wall, base and drawer units with work surfaces over, incorporating a stainless-steel sink with drainer and mixer tap. Integrated oven with four-ring gas hob and extractor hood above, integrated dishwasher and integrated washer dryer. Space provided for a fridge freezer. Finished with wood-effect vinyl flooring.

BEDROOM 1

11' 10" x 10' 9" (3.63m x 3.30m)

Window to the rear of the property, radiator and storage cupboard with door leading to Ensuite shower room.



Kitchen



Bedroom 1



Ensuite



Bedroom 2

ENSUITE

8' 10" x 4' 7" (2.70m x 1.41m)

Comprising a low-level WC, wash hand basin and thermostatic shower. Partly tiled walls, vinyl flooring, radiator and extractor fan.

BEDROOM 2

12' 9" x 7' 11" (3.90m x 2.42m)

Double room with window to the front and sea views, radiator to the wall.

SHOWER ROOM

7' 10" x 6' 9" (2.39m x 2.06m)

Comprising a low level WC, wash hand basin and thermostatic shower. Partly tiled walls, vinyl flooring, radiator and extractor fan.

CENTRAL HEATING

Gas fired central heating to radiators. The boiler also provides domestic hot water.

DOUBLE GLAZING

UPVC double glazing throughout.

PARKING

Allocated parking space available

TENURE

We understand that the property is leasehold. Further details on the lease and any additional charges are available upon request.



View

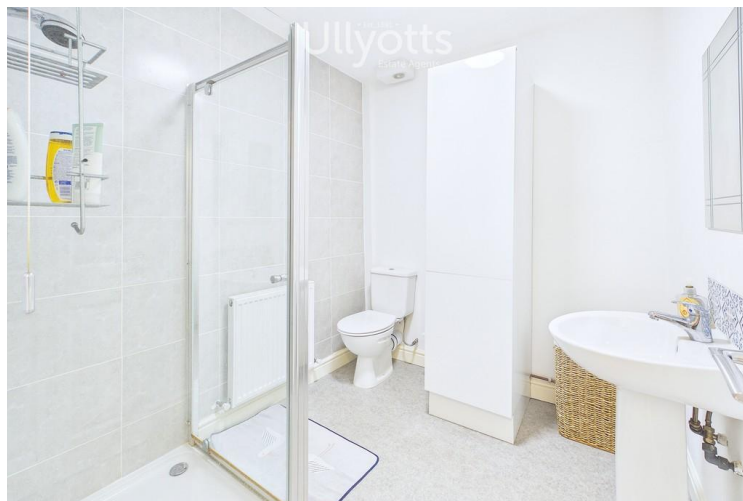

Shower Room



Balcony

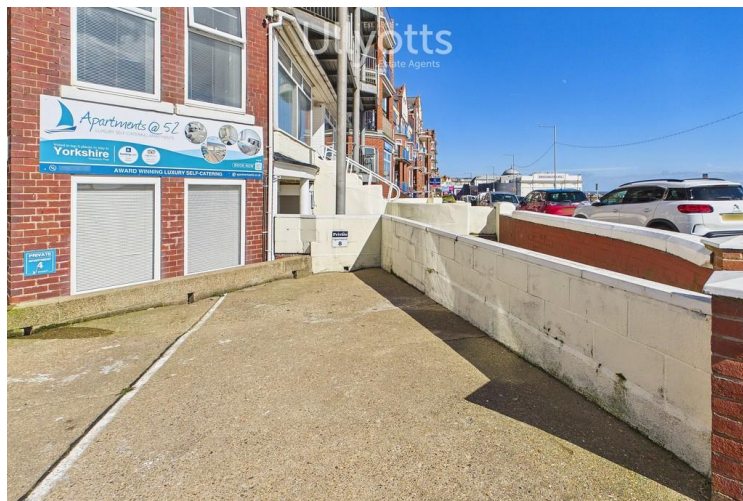

Parking

SERVICES

All mains services are available at the property.

COUNCIL TAX BAND - C

ENERGY PERFORMANCE CERTIFICATE – RATED B

NOTE

Heating systems and other services have not been checked.

All measurements are provided for guidance only.

None of the statements contained in these particulars as to this property are to be relied upon as statements or representations of fact. In the event of a property being extended or altered from its original form, buyers must satisfy themselves that any planning regulation was adhered to as this information is seldom available to the agent.

Floor plans are for illustrative purposes only.

VIEWING

Strictly by appointment with Ulllyotts 01262 401401
- Option 1.

Regulated by RICS

The digitally calculated floor area is 67 sq m (721 sq ft). This area may differ from the floor area on the Energy Performance Certificate.

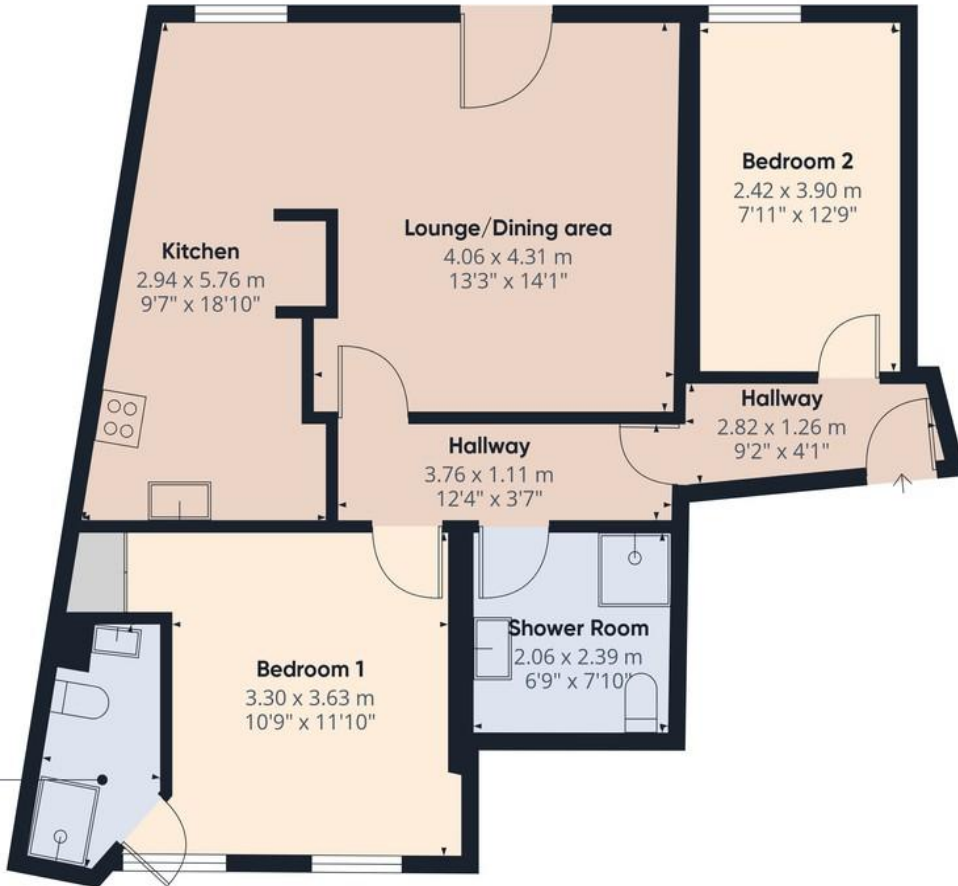

Approximate total area⁽¹⁾
69.2 m²
743 ft²

(1) Excluding balconies and terraces

Calculations reference the RICS IPMS 3C standard. Measurements are approximate and not to scale. This floor plan is intended for illustration only.

GIRAFFE360





Apartment 8, 52 South Marine Drive

BRIDLINGTON

Bridlington

Hilderthorpe

Old Town

West Hill

Sewerby

North Sands

▪ Est. 1891 ▪
Ulllyotts
Estate Agents



16 Prospect Street,
Bridlington, YO15 2AL

Telephone 01262 401401

Email sales@ullyottsbrid.co.uk

64 Middle Street South,
Driffield, YO25 6QG

Telephone 01377 253456

Email sales@ullyotts.co.uk

www.ullyotts.co.uk



- Residential Sales
- Property Management
- Valuations

