

Client Testimonials

“

Amazing, Outstanding customer service! We have sold and purchased 3 properties now with S J Smith Estate Agents was founded with a singular goal – to provide an unparalleled level of service and client care not readily available in our local market.

”

Our aim is to establish S J Smith as the premier estate agency in our area of operations. To that end, we blend proven real estate practices with cutting-edge technology to deliver the very best service possible.

“

However, our greatest asset is our exceptional staff, whose dedication and expertise set us apart from competitors.

Let's stay in touch! Get tips, sneak peeks, and early access to our newest properties!

”

We sold our house with S J Smiths and they were incredible throughout. Their photographer did a fantastic job at capturing our home from some tricky angles. Then when our house went on sale, they were very responsive and communicative throughout the viewings process, giving us feedback after each viewing. Our house sold within a week and we really do believe that was down to their hard work. We are so glad we chose S J Smiths and couldn't recommend them more. Thanks so much guys.

”

Holly

Dani Atkinson

Mark Sheildrake

Holly

Dani Atkinson

Mark Sheildrake

About Us



S J Smith Estate Agents was founded with a singular goal – to provide an unparalleled level of service and client care not readily available in our local market.

Our aim is to establish S J Smith as the premier estate agency in our area of operations. To that end, we blend proven real estate practices with cutting-edge technology to deliver the very best service possible.

However, our greatest asset is our exceptional staff, whose dedication and expertise set us apart from competitors.

Let's stay in touch! Get tips, sneak peeks, and early access to our newest properties!



Contact Details

6 Station Approach,
Ashford,
Surrey,
TW15 2QN

T: 01784 243 333

E: ashford@sjsmithestateagents.co.uk

www.sjsmithestateagents.co.uk



27 Wolsey Road, Ashford, TW15 2RA

£800,000 Freehold

- No onward chain
- Off street parking
- Central Ashford location
- Charming character property
- Three double bedrooms
- Approved planning permission for a two-storey extension (21/01086/CPD)
- EPC rating C
- EPC Rating Band

Council Tax

Spelthome Borough Council, Tax Band F being £3,649.38.

Council tax bands can be reassessed by local authorities at any point, the council tax band is only taken at point of listing and should not be relied on as current banding

Located just moments from the amenities of Ashford high street and mainline station, this charming character property offers three double bedrooms, off street parking, and no onward chain.

The ground floor features a bright bay-fronted principal reception room with a desirable south-facing aspect. To the rear, the dining room enjoys views over the private garden through patio doors, while a convenient downstairs WC is positioned off the entrance hallway. The modern fitted kitchen benefits from sleek cabinetry, integrated appliances, and direct access to the garden.

Upstairs, the first floor comprises three well-proportioned double bedrooms, a family bathroom, and a separate WC.

This property is offered with planning permission already granted for a two-storey rear extension, creating the potential for spacious open-plan living to the ground floor, along with a separate study. To the first floor, the approved plans allow a larger third bedroom, family bathroom and ensuite.

In addition, there is a pending planning application for the development of two semi-detached houses within the existing boundaries, offering alternative potential development subject to approval.

Approximate Gross Internal Area = 97.85 sq m / 1053 sq ft
 Garage = 10.29 sq m / 111 sq ft
 Total = 108.14 sq m / 1164 sq ft

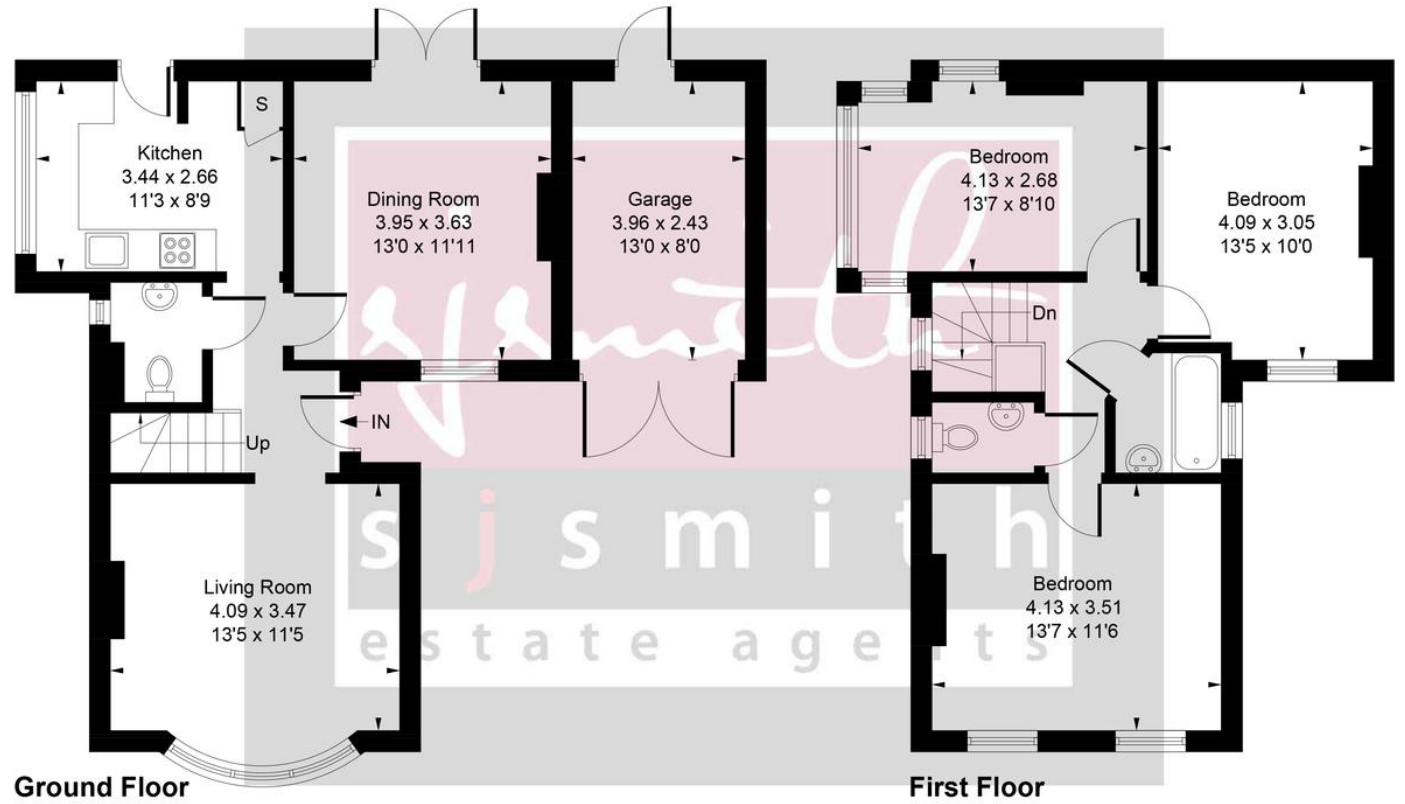

Whilst every attempt has been made to ensure the accuracy of the floor plan contained here, measurements of doors, windows, rooms and any other items are approximate and no responsibility is taken for any error, omission, or mis-statement. This plan is for illustrative purposes only and should be used as such by any prospective purchase.

