



HDS 5/12 C

Unique eco!efficiency mode, simple one-button operation, integrated tanks, on-board practical hose/cable storage, accessory compartment, large wheels and swivel castor – welcome to the hot water compact class!



1 Efficiency

- eco!efficiency mode – economical and environmentally friendly, even during longer periods of use.
- Reduces fuel consumption and CO2 emissions by 20%.

2 Ease of use

- Intuitive operation with large single-button selector switch.
- Large tank opening with filling chute.

3 Storage

- Lockable accessory compartment for nozzles, tools, etc.
- Storage hooks for power cord and high-pressure hose.

4 Mobility

- Jogger principle with large wheels and steering roller.
- Large integrated handles in the chassis.



HDS 5/12 C

■ Economical ecoefficiency mode

Technical data

| | | |
|------------------------|-------------|------------------|
| Order Number | | 1.272-902.0 |
| EAN code | | 4054278168845 |
| Current type | Ph / V / Hz | 1 / 240 / 50 |
| Flow rate | l/h | 500 |
| Pressure | bar / MPa | 120 / 12 |
| Max. temperature | °C | 80 |
| Power rating | kW | 2,9 |
| Consumption fuel oil | kg/h | 3,2 |
| Fuel tank | l | 15 |
| Weight | kg | 93,4 |
| Dimensions (L x W x H) | mm | 1060 × 650 × 920 |

Equipment

| | | |
|----------------------------------|----|---------------------|
| Trigger gun | | EASY!Force Advanced |
| High-pressure hose | m | 10 / ID 6, 250 bar |
| Spray lance | mm | 840 |
| SDS system | | ■ |
| ANTI!Twist | | ■ |
| Pressure switch control | | ■ |
| Integral fuel and detergent tank | | ■ |
| Servo Control | | - |

■ Included in delivery.

ACCESSORIES FOR HDS 5/12 C

1.272-902.0

KÄRCHER

| | | Order Number | ID | Max. working pressure | Length | Price | Description | |
|--|----|--------------|-------|-----------------------|--------|-------|---|---|
| Standard with unions on both sides | | | | | | | | |
| High-pressure hose, 10 m DN 8, AVS trigger gun connector | 1 | 6.110-031.0 | ID 8 | 315 bar | 10 m | | 10 m high-pressure hose (M 22 x 1.5) with kink protection. With patented rotating AVS trigger gun connector and manual coupling. Further data: DN 8/155°C/315 bar. | ▲ |
| High-pressure hose, 15 m DN 8, AVS trigger gun connector | 2 | 6.110-030.0 | ID 8 | 315 bar | 15 m | | 15 m high-pressure hose (M 22 x 1.5) with kink protection. With patented rotating AVS trigger gun connector and manual coupling. Further data: DN 8/155°C/315 bar. | ▲ |
| High-pressure hose, 20 m DN 8, AVS trigger gun connector | 3 | 6.110-032.0 | ID 8 | 315 bar | 20 m | | 20 m high-pressure hose (M 22 x 1.5) with kink protection. With patented rotating AVS trigger gun connector and manual coupling. Further data: DN 8/155°C/315 bar. | ▲ |
| High-pressure hose, 30 m DN 8, including rotary coupling | 4 | 6.110-014.0 | ID 8 | 315 bar | 30 m | | With rotary coupling, 2 x M 22 x 1.5 | ▲ |
| High-pressure hose, 15 m DN 10, 220 bar, extension | 5 | 6.110-042.0 | ID 10 | 220 bar | 15 m | | 15 m high-pressure hose M 22 x 1.5) with kink protection and threaded couplings at both ends. Further data: DN 10/155°C/220 bar. | ▲ |
| High-pressure hose, 20 m DN 10, 220 bar, extension | 6 | 6.110-043.0 | ID 10 | 220 bar | 20 m | | with union on both sides, M 22 x 1.5 with anti-kink protection. NW 10/155°C/220 bar | ▲ |
| High-pressure hose, 25 m DN 10, extension, not rotatable | 7 | 6.110-044.0 | ID 10 | 220 bar | 25 m | | | ▲ |
| Hose assembly premium DN10 22MPa 40m | 8 | 6.110-045.0 | ID 10 | 220 bar | 40 m | | | ▲ |
| Hose assembly premium DN12 21MPa 15m | 9 | 6.110-059.0 | ID 12 | 210 bar | 15 m | | High-pressure hose for water volumes greater than 1,800 l/h. With union on both sides. 2x M 22 x 1.5 with anti-kink protection. | ▲ |
| Hose assembly premium DN12 21MPa 40m | 10 | 6.110-060.0 | ID 12 | 210 bar | 40 m | | | ▲ |
| Hose assembly TR DN10 22MPa 10m | 11 | 6.110-041.0 | ID 10 | 220 bar | 10 m | | | ▲ |
| High-pressure hose, 10 m DN 6, AVS trigger gun connector | 12 | 6.110-034.0 | ID 6 | 250 bar | 10 m | | 10 m high-pressure hose (M 22 x 1.5) with kink protection. With patented rotating AVS trigger gun connector and manual coupling. Further data: DN 6/155°C/250 bar. | ■ |
| | 13 | 6.110-035.0 | ID 6 | 250 bar | 10 m | | | □ |
| High-pressure hose, 10 m, DN 6, 300 bar, AVS trigger gun connection | 14 | 6.110-056.0 | ID 6 | 300 bar | 10 m | | With patented AVS connection in the trigger gun (pivot-mounted) and hand screw union. M 22 x 1.5 with anti-kink protection. NW 6/155°C/300 bar | □ |
| Longlife 400 with unions on both sides | | | | | | | | |
| High-pressure hose Longlife 400, 30 m DN 8, including rotary coupling | 15 | 6.110-023.0 | ID 8 | 400 bar | 30 m | | With rotary coupling, 2 x M 22 x 1.5 | ▲ |
| High-pressure hose Longlife 400, 20 m, DN 8, extension | 16 | 6.110-027.0 | ID 8 | 400 bar | 20 m | | with rotary coupling, 2 x M 22 x 1.5 | ▲ |
| High-pressure hose Longlife 400, 15 m, DN 8, including rotary coupling | 17 | 6.110-029.0 | ID 8 | 400 bar | 15 m | | With rotary coupling, 2 x M 22 x 1.5 | ▲ |
| High-pressure hose 1.5 m, DN 8, including connectors | 18 | 6.110-024.0 | ID 8 | 400 bar | 1.5 m | | 1.5 m high-pressure hose (DN 8, M 22 x 1.5) with kink protection and connectors at both ends. For connecting to hose reels with appropriate connector (M 22 x 1.5). | □ |
| | 19 | 6.110-069.0 | ID 8 | 400 bar | 1.5 m | | | □ |
| Food industry version with unions on both sides | | | | | | | | |
| High-pressure hose, 10 m ID 8, suitable for food industry, extension piece | 20 | 6.110-051.0 | ID 8 | 250 bar | 10 m | | 10 m high-pressure hose (DN 8) with patented (rotating) AVS trigger gun connector. Non-discolouring outer layer for use in the food industry. M 22 x 1.5 with anti-kink sleeve. | ▲ |

■ Included in delivery. □ Available accessories. ▲ Extension hose.

ACCESSORIES FOR HDS 5/12 C

1.272-902.0

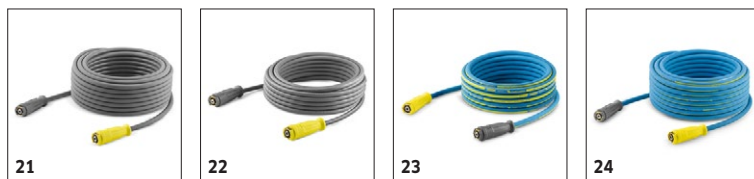

| | | Order Number | ID | Max. working pressure | Length | Price | Description | |
|---|----|--------------|------|-----------------------|--------|-------|--|---|
| High-pressure hose, 20 m ID 8, suitable for food industry, extension piece | 21 | 6.110-052.0 | ID 8 | 250 bar | 20 m | | 20 m high-pressure hose (DN 8) with swivel coupling. Non-discolouring outer layer for use in the food industry. Connectors at both ends, M 22 x 1.5, with kink protection. NW 8/155°C/250 bar. | ▲ |
| High-pressure hose 15 m ID 6, AVS trigger gun connector 11 mm, suitable for food industry, grey | 22 | 6.110-063.0 | ID 6 | 250 bar | 15 m | | 15 m high-pressure hose (DN 6) with patented (rotating) AVS trigger gun connector. Non-discolouring outer layer for use in the food industry. DN 6/155°C/250 bar. | □ |
| Longlife food industry version with unions on both sides | | | | | | | | |
| High pressure hose food DN 8 / 10 m | 23 | 6.110-053.0 | ID 8 | 400 bar | 10 m | | Longlife HP hose for use in the food industry. Außendecke## animal-grease-resistant, non-colour-bleeding material. With rotary coupling, 2 x M 22 x 1,5 | ▲ |
| High-pressure hose Longlife 400, 15 m, ID 6, AVS trigger gun connection | 24 | 6.110-054.0 | ID 8 | 400 bar | 20 m | | Longlife HP hose for use in the food industry. Außendecke## animal-grease-resistant, non-colour-bleeding material. With patented AVS connection in the pistol (pivot mounted) | □ |

■ Included in delivery. □ Available accessories. ▲ Extension hose.

ACCESSORIES FOR HDS 5/12 C

1.272-902.0



| | | Order Number | Flow rate | | | | Price | Description | |
|--|---|--------------|-----------|--|--|--|-------|--|--------------------------|
| Trigger guns | | | | | | | | | |
| Extended easy press trigger gun | 1 | 4.118-005.0 | | | | | | Extended easy press high-pressure trigger gun for high-pressure hoses with rotating connector. | ■ |
| Quick connect | | | | | | | | | |
| Quick-fitting pipe union coupler trapezo | 2 | 2.115-000.0 | | | | | | | <input type="checkbox"/> |
| Quick-fitting pipe union plug nipple tra | 3 | 2.115-001.0 | | | | | | | <input type="checkbox"/> |

■ Included in delivery.
 ☐ Available accessories.
 ▲ Extension hose.

ACCESSORIES FOR HDS 5/12 C

1.272-902.0

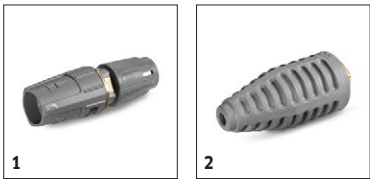

| | | Order Number | Max. working pressure | Nozzle size | | | Price | Description | |
|--|---|--------------|-----------------------|-------------|--|--|-------|---|---|
| Triple nozzles | | | | | | | | | |
| Triple nozzle 034 | 1 | 4.117-029.0 | 300 bar | 34 | | | | Triple nozzle with manual nozzle changeover. Convenient spray adjustment. For high-pressure cleaners with injector; low-pressure fan jet for detergent removal and application. Connector M 18x1.5. | ■ |
| Dirt blaster, large | | | | | | | | | |
| Dirt blaster - without changeover function | 2 | 4.114-040.0 | 300 bar | 35 | | | | The dirt blaster with rotating pencil jet offers 10 times better cleaning performance. Ceramic nozzle and bearing ring for a long service life. Further data: Max. 300 bar, 30 MPa, 85°C. | □ |

■ Included in delivery. □ Available accessories. ▲ Extension hose.

ACCESSORIES FOR HDS 5/12 C

1.272-902.0

KÄRCHER

| | | Order Number | Max. working pressure | Length | | | Price | Description | |
|--|----|--------------|-----------------------|---------|--|--|-------|---|---|
| Rotating spray lances | | | | | | | | | |
| Lance 850 mm, rotatable, ergonomic | 1 | 4.112-006.0 | 300 bar | 840 mm | | | | 850 mm stainless steel lance (manual coupling) with ergonomic handle for ease of use and protection. Rotatable 360° under pressure. | ■ |
| Lance 250 mm, non-rotatable | 2 | 4.112-027.0 | 300 bar | 250 mm | | | | | □ |
| 550 mm lance, non-rotatable | 3 | 4.112-024.0 | 300 bar | 400 mm | | | | | □ |
| Rotatable lance, 600 mm, ergonomic | 4 | 4.112-007.0 | 300 bar | 600 mm | | | | 600 mm stainless steel lance (manual coupling) with ergonomic handle for ease of use and protection. Rotatable 360° under pressure. | □ |
| 1050 mm lance, rotatable, ergonomic | 5 | 4.112-000.0 | 300 bar | 1050 mm | | | | 1050 mm stainless steel lance (manual coupling) with ergonomic handle for ease of use and protection. Rotatable 360° under pressure. | □ |
| Lance 1550 mm, rotatable, ergonomic | 6 | 4.112-018.0 | 300 bar | 1550 mm | | | | 1550 mm stainless steel lance (manual coupling) with ergonomic handle for ease of use and protection. Rotatable 360° under pressure. | □ |
| Lance 2050 mm, rotatable, ergonomic | 7 | 4.112-021.0 | 300 bar | 2050 mm | | | | 2050 mm stainless steel lance (manual coupling) with ergonomic handle for ease of use and protection. Rotatable 360° under pressure. | □ |
| Jet pipe extension TR 1000 mm | 8 | 4.112-048.0 | 300 bar | 1000 mm | | | | | □ |
| Double lance | | | | | | | | | |
| Double lance 960 mm | 9 | 2.112-016.0 | 310 bar | 960 mm | | | | 960 mm double lance for variable pressure adjustment on handle at full water flow rate. Suitable for agricultural use (e.g. stable cleaning). | □ |
| Angular spray lance | | | | | | | | | |
| WC and gutter lance | 10 | 4.112-029.0 | | | | | | Stainless steel lance WC and gutter with nozzle insert. Specially shaped for effective and hygienic cleaning of gutters and toilets. | □ |
| Flexible spray lance | | | | | | | | | |
| Flexible lance 1050 mm | 11 | 4.112-035.0 | 210 bar | 1050 mm | | | | 1050 mm flexible lance with variable bend from 20° to 140°, ideal for cleaning difficult to reach areas, e.g. gutters. | □ |
| Articulated joint TR 20 | 12 | 4.112-057.0 | 300 bar | | | | | | □ |
| Telescopic spray lance | | | | | | | | | |
| Telescopic jet pipe | 13 | 4.112-037.0 | 225 bar | 5400 mm | | | | | □ |
| Restraint belt for telescopic jet pipe | 14 | 6.373-987.0 | | | | | | Convenient strap for relief when working with the telescopic spray lance (6.394-690). The burden is optimally distributed on the body and longer periods of use are possible. | □ |
| Gutter cleaner | | | | | | | | | |
| Gutter cleaning lance | 15 | 2.112-015.0 | | 960 mm | | | | The lance is suited for cleaning of gutter systems. Because of the shape of the lance and the special nozzle the gutter can be cleaned without removing the cover plates. | □ |
| Undercarriage spray lance | | | | | | | | | |
| Underbody lance | 16 | 4.112-032.0 | | 700 mm | | | | Stainless steel lance for effective and easy underbody and wheel arch cleaning. Without high-pressure nozzle. | □ |
| Additional handle | | | | | | | | | |
| | 17 | 4.321-380.0 | | | | | | | □ |
| PowerControl spray lance | | | | | | | | | |
| Pressure regulating jet pipe packaged Po | 18 | 4.112-045.0 | | | | | | | □ |

■ Included in delivery. □ Available accessories. ▲ Extension hose.

ACCESSORIES FOR HDS 5/12 C

1.272-902.0



| | | Order Number | | | | | Price | Description | |
|--|---|--------------|--|--|--|--|-------|-------------|--------------------------|
| Crane lifting kit | | | | | | | | | |
| Add-on kit suspension crane HDS C | 1 | 2.642-638.0 | | | | | | | <input type="checkbox"/> |
| Flame monitoring attachment kit | | | | | | | | | |
| ABS flame monitor for HDS C | 2 | 2.642-711.0 | | | | | | | <input type="checkbox"/> |
| Y distributor | | | | | | | | | |
| Y distributor | 3 | 4.111-024.0 | | | | | | | <input type="checkbox"/> |

■ Included in delivery. □ Available accessories. ▲ Extension hose.

ACCESSORIES FOR HDS 5/12 C

1.272-902.0

KÄRCHER

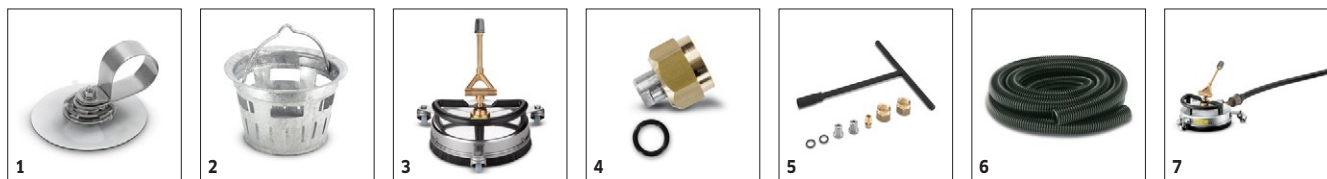

| | | Order Number | Flow rate | Nozzle size | Diameter | Price | Description | |
|---|---|--------------|-------------|-------------|----------|-------|--|--------------------------|
| Hard Surface Cleaner FRV 30 | | | | | | | | |
| Add-on kit hose attachment | 1 | 2.642-528.0 | | | | | | <input type="checkbox"/> |
| Add-on kit dirt trap | 2 | 2.642-532.0 | | | | | | <input type="checkbox"/> |
| Hard surface cleaner FR 30 ME | | | | | | | | |
| FR 30 ME surface cleaner | 3 | 2.111-013.0 | | | 300 mm | | Hot water resistant stainless steel surface cleaner with double ceramic bearings, non-marking swivel castors and suction hose connection. Ideal for indoor cleaning, e.g. food industry. | <input type="checkbox"/> |
| Machine-specific nozzle kit for FR | | | | | | | | |
| Nozzle kit for surface cleaners (type-specific) 450 - 500 l/h | 4 | 2.640-482.0 | 450-500 l/h | | | | Nozzle kit includes power nozzles and unions. For Kärcher surface cleaners (450 to 500 l/h). | <input type="checkbox"/> |
| Machine-specific nozzle kits for FRV | | | | | | | | |
| Nozzle kit 035 for FRV 30 | 5 | 2.642-430.0 | | 35 | | | | <input type="checkbox"/> |
| Hard surface cleaner FRV 30 Me | | | | | | | | |
| Suction hose FRV 30 me | 6 | 4.441-040.0 | | | | | | <input type="checkbox"/> |
| FRV 30 ME | 7 | 2.111-012.0 | | | | | Surface cleaner with integrated waste water pick-up | <input type="checkbox"/> |

■ Included in delivery. □ Available accessories. ▲ Extension hose.

ACCESSORIES FOR HDS 5/12 C

1.272-902.0

KÄRCHER

| | | Order Number | | | | | | Price | Description | |
|---|----|--------------|--|--|--|--|--|-------|--|---|
| Nozzle union | | | | | | | | | | |
| Protection part TR only for replacement | 1 | 4.112-011.0 | | | | | | | | <input type="checkbox"/> |
| Rotary coupling | | | | | | | | | | |
| Rotary coupling | 2 | 4.111-021.0 | | | | | | | Kärcher rotary coupling prevents twisting and kinking of high-pressure hoses for ease of use. Connector M 22 x 1.5 m. With grip protection. | <input type="checkbox"/> |
| Coupling | | | | | | | | | | |
| Coupler -2xM22x1,5 | 3 | 4.111-037.0 | | | | | | | Brass double connector for connecting and extending high-pressure hoses. With rubber protection. Connector: 2x M 22 x 1.5 m. | <input type="checkbox"/> |
| Connector | | | | | | | | | | |
| Nozzle connector/screw connector | 4 | 4.111-022.0 | | | | | | | Nozzle connector/screw connector for connecting high-pressure nozzles and accessories to the high-pressure trigger gun (with nozzle connector). Connectors: 1x M 22 x 1.5 and 1x M 18 x 1.5. | <input type="checkbox"/> |
| | 5 | 4.111-038.0 | | | | | | | | <input type="checkbox"/> |
| Adapter EASY!Lock | | | | | | | | | | |
| Adapter 1 M22AG-TR22AG | 6 | 4.111-029.0 | | | | | | | | <input type="checkbox"/> |
| Adapter 2 M22IG-TR22AG | 7 | 4.111-030.0 | | | | | | | | <input type="checkbox"/> |
| Adapter 3 M22IG-TR22AG | 8 | 4.111-031.0 | | | | | | | | <input type="checkbox"/> |
| Adapter M22 - Swivel | 9 | 4.111-032.0 | | | | | | | | M22 x 1,5female and swivel connection. For extension of high-pressure hoses with AVS connection or for usage of the telescopic lance with a high-pressure hose with AVS connection. |
| Adapter 5 TR22IG-M22AG | 10 | 4.111-033.0 | | | | | | | | <input type="checkbox"/> |
| Adapter 6 TR22IG-M22AG | 11 | 4.111-034.0 | | | | | | | | <input type="checkbox"/> |
| Adapter 7 M18IG-TR20AG | 12 | 4.111-035.0 | | | | | | | | <input type="checkbox"/> |
| Adapter 8 TR20IG-M18AG | 13 | 4.111-036.0 | | | | | | | | <input type="checkbox"/> |
| ADAPTER for replacement TR22IG-M22AG Er | 14 | 4.111-046.0 | | | | | | | | <input type="checkbox"/> |
| Flue pipe | | | | | | | | | | |
| Flue gas adapter | 15 | 4.656-149.0 | | | | | | | Flue gas adapter with draught damper for flue pipe connection (adapter for HDS burners for connection to a stack system). | <input type="checkbox"/> |
| | 16 | 4.656-080.0 | | | | | | | | <input type="checkbox"/> |
| HP detergent injector | | | | | | | | | | |
| Detergent injector for high and low pressure (without nozzles) | 17 | 4.637-032.0 | | | | | | | Detergent injector for independent high and low pressure dosage. Maximum dosage about 15%. | <input type="checkbox"/> |
| Detergent injector for high pressure | 18 | 4.637-033.0 | | | | | | | Cleaning agent dosage at high pressure 3 - 5 % | <input type="checkbox"/> |
| Machine-specific nozzle kit with order no. 3.637-170 | | | | | | | | | | |
| Nozzle insert trapezoidal thread HDS-GER | 19 | 4.769-009.0 | | | | | | | | <input type="checkbox"/> |
| Nozzle insert with order no. 3.637-001 | | | | | | | | | | |
| Nozzle insert for Order No. 3.637-001, high-pressure for machines up to 1100 l/h. | 20 | 4.769-003.0 | | | | | | | Nozzle insert for detergent injector 3.637-001 for high-pressure detergent application. For high-pressure cleaners with a water flow rate up to 1100 l/h. | <input type="checkbox"/> |
| Low pressure for units rated up to 1100 l/h | 21 | 4.769-001.0 | | | | | | | For low pressure with machines up to 1.100 l/h | <input type="checkbox"/> |

■ Included in delivery. □ Available accessories. ▲ Extension hose.

ACCESSORIES FOR HDS 5/12 C

1.272-902.0



| | | Order Number | Nozzle size | | | | Price | Description | |
|--|---|--------------|-------------|--|--|--|-------|--|--------------------------|
| HP nozzle spray angle 0° | | | | | | | | | |
| High-pressure nozzle spray angle 0° | 1 | 2.113-001.0 | 40 | | | | | High-pressure nozzle with powerful jet for extremely stubborn dirt. | <input type="checkbox"/> |
| Power nozzle spray angle 15° | | | | | | | | | |
| Power nozzle 15034 | 2 | 2.113-042.0 | 34 | | | | | | <input type="checkbox"/> |
| Power nozzle spray angle 25° | | | | | | | | | |
| Power nozzle spray angle 25° | 3 | 2.113-000.0 | 34 | | | | | Fan jet nozzle with 25° spray angle, suitable for large areas and removing stubborn dirt and stains. | <input type="checkbox"/> |
| Nozzle chemical TR for replacement 25250 | 4 | 2.113-020.0 | 250 | | | | | | <input type="checkbox"/> |
| Power nozzle spray angle 40° | | | | | | | | | |
| Power nozzle spray angle 40° | 5 | 2.113-003.0 | 40 | | | | | Power nozzle with a 40° spray angle and fan jet, suitable for large areas and sensitive surfaces. | <input type="checkbox"/> |

■ Included in delivery. □ Available accessories. ▲ Extension hose.

ACCESSORIES FOR HDS 5/12 C

1.272-902.0



| | | Order Number | Nozzle size | | | | | Price | Description |
|---|---|--------------|-------------|--|--|--|--|-------|---|
| Wet blasting attachment (without nozzle) | | | | | | | | | |
| Wet blasting attachment with flow control (without nozzles) | 1 | 4.115-000.0 | | | | | | | Paint, rust and scale removal made easy: Kärcher wet blasting attachment with flow control for adding blasting abrasive to the high-pressure jet. <input type="checkbox"/> |
| Wet blasting attachment without flow control (nozzles not included) | 2 | 4.115-006.0 | | | | | | | Paint, rust and scale removal made easy: Kärcher wet blasting attachment with flow control for adding blasting abrasive to the high-pressure jet. Without flow control. <input type="checkbox"/> |
| Nozzle pack for wet blasting attachment | | | | | | | | | |
| Nozzle pack TR wet jet set 0035 | 3 | 2.112-021.0 | 35 | | | | | | <input type="checkbox"/> |
| Nozzle kit for wet blasting attachment 035 | 4 | 2.638-526.0 | 30 | | | | | | Nozzle kit with wet blasting nozzle and nozzle insert (type specific). For optimal Kärcher wet blasting attachment performance. Only in combination with wet blasting attachment 4.762-010/-022. <input type="checkbox"/> |
| Boron carbide nozzle | | | | | | | | | |
| Boron carbide nozzle, for machines as of 1000 l/h | 5 | 6.415-084.0 | 6 mm | | | | | | In addition to nozzle packs. Very wear-resistant nozzle with boron carbide chuck for continuous-duty operation. <input type="checkbox"/> |

■ Included in delivery. □ Available accessories. ▲ Extension hose.

ACCESSORIES FOR HDS 5/12 C

1.272-902.0

KÄRCHER

| | | Order Number | Max. working pressure | Nozzle size | Diameter | Price | Description | |
|--|----|--------------|-----------------------|-------------|----------|-------|---|--------------------------|
| Pipe cleaning hose, ID 6 | | | | | | | | |
| Hose assembly TR pipe cleaning DN6 max.2 | 1 | 6.110-046.0 | 250 bar | | | | | <input type="checkbox"/> |
| Pipe cleaning hose, DN 6, 20 m, 220 bar | 2 | 6.110-008.0 | 250 bar | | | | 20 m flexible high-pressure hose (DN 6) for cleaning pipes up to 220 bar (threaded connection for R 1/8 nozzle). | <input type="checkbox"/> |
| Hose assembly TR pipe cleaning DN6 max.2 | 3 | 6.110-047.0 | 250 bar | | | | | <input type="checkbox"/> |
| Pipe cleaning nozzle | | | | | | | | |
| Dirt blaster pipe cleaning D21/040 | 4 | 4.765-001.0 | | 40 | 21 mm | | | <input type="checkbox"/> |
| Dirt blaster pipe cleaning D30/040 | 5 | 4.765-004.0 | | 40 | 30 mm | | | <input type="checkbox"/> |
| Nozzle pipe cleaning size 120 | 6 | 5.763-089.0 | | 120 | 24 mm | | Pipe cleaning nozzle with 24 mm diameter. With 8 nozzles tilted back at a 30° angle. | <input type="checkbox"/> |
| Pipe cleaning nozzle | 7 | 5.763-015.0 | | 55 | 16 mm | | 16 mm pipe cleaning nozzle with internal thread. Various jet directions for environmentally-friendly cleaning of blocked drains and pipes. | <input type="checkbox"/> |
| | 8 | 5.763-016.0 | | 60 | 16 mm | | | <input type="checkbox"/> |
| | 9 | 5.763-017.0 | | 50 | 30 mm | | 30 mm pipe cleaning nozzle with internal thread. Various jet directions for environmentally-friendly cleaning of blocked drains and pipes. | <input type="checkbox"/> |
| Rotating pipe cleaning nozzle | 10 | 6.415-428.0 | | 50 | 16 mm | | Rotating pipe cleaning nozzle with internal thread and four rotating jets for environmentally-friendly cleaning of blocked drains and pipes. | <input type="checkbox"/> |
| Drain cleaning dirt blaster D 25/040 | 11 | 6.415-944.0 | | 40 | 25 mm | | The forward-tilted rotating pencil jet removes the most stubborn dirt. The three backwards-tilted jets ensure the necessary forward movement, as well as convenient handling. | <input type="checkbox"/> |
| Drain cleaning dirt blaster D 30/040 | 12 | 6.415-946.0 | | 40 | 30 mm | | | <input type="checkbox"/> |
| Drain cleaning dirt blaster D 35/040 | 13 | 6.415-948.0 | | 40 | 35 mm | | | <input type="checkbox"/> |

■ Included in delivery. □ Available accessories. ▲ Extension hose.

ACCESSORIES FOR HDS 5/12 C

1.272-902.0

KÄRCHER

| | | Order Number | Flow rate | | | | | Price | Description | |
|---|---|--------------|-------------|--|--|--|--|-------|---|--------------------------|
| Cup foam lance | | | | | | | | | | |
| Foam lance TR | 1 | 4.112-053.0 | 350-600 l/h | | | | | | | <input type="checkbox"/> |
| Packing complete for 6.394-969.0 | 2 | 2.112-018.0 | | | | | | | | <input type="checkbox"/> |
| Tank grey only for replacement 1L | 3 | 6.414-050.0 | | | | | | | | <input type="checkbox"/> |
| Inno Foam Set | | | | | | | | | | |
| Inno foam kit with detergent injector | 4 | 2.112-000.0 | | | | | | | High-pressure foam system with double lance (foam nozzle and high-pressure jet for rinsing). For use with mobile and stationary high-pressure and HDS pressure cleaners for cleaning or disinfection. | <input type="checkbox"/> |
| Inno foam kit | 5 | 2.112-008.0 | | | | | | | | <input type="checkbox"/> |
| Easy Foam Set | | | | | | | | | | |
| Easy Foam Set with RM injector | 6 | 2.112-010.0 | | | | | | | HP foam system for use with. HD/HDS units for cleaning and disinfecting. Foam nozzle for connection to lance and HP chemical injector with precision 0-5% metering valve. The machine specific nozzle kit has to be ordered separately. | <input type="checkbox"/> |
| Easy foam set | 7 | 2.112-011.0 | | | | | | | | <input type="checkbox"/> |
| Nozzle kits for Inno/Easy Foam Set | | | | | | | | | | |
| Nozzle kit 055 z. Inno/Easy Set 500 - 600 l/h | 8 | 2.111-009.0 | 500-600 l/h | | | | | | Optimal adaptation to different machine outputs for economic use. | <input type="checkbox"/> |
| Foam nozzle mounting kit | | | | | | | | | | |
| Foam nozzle kit | 9 | 2.112-013.0 | | | | | | | Foaming agent kit. The foam nozzle is ideal for use in sanitary areas and the food industry and wherever long application times are necessary. | <input type="checkbox"/> |

■ Included in delivery. □ Available accessories. ▲ Extension hose.

ACCESSORIES FOR HDS 5/12 C

1.272-902.0

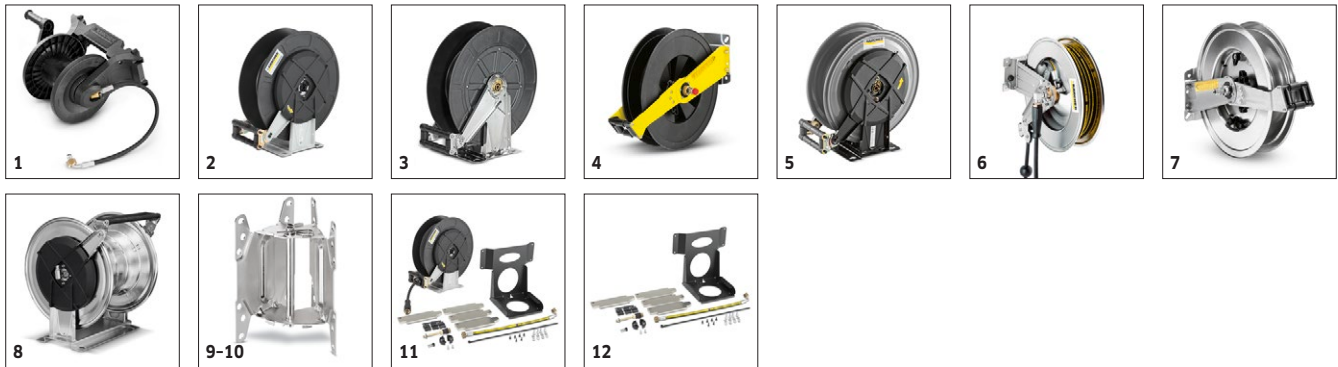
KÄRCHER

| | | Order Number | Length | | | | | Price | Description | |
|---|----|--------------|--------|--|--|--|--|-------|--|--------------------------|
| Hose reel add-on kit | | | | | | | | | | |
| Hose reel kit, plastic, for HDS 5/12 C - HDS 8/18-4 C | 1 | 2.110-010.0 | 20 m | | | | | | | <input type="checkbox"/> |
| Automatic, self-winding hose reels | | | | | | | | | | |
| Add-on kit hose reel plastics | 2 | 6.392-074.0 | 20 m | | | | | | Automatic hose reel for 20 m high-pressure hose. The console is made from powder-coated steel, the drum is made from plastic. | <input type="checkbox"/> |
| Add-on kit hose reel | 3 | 6.392-083.0 | 20 m | | | | | | Automatic hose reel for 20 m high-pressure hose. The console consists of stainless steel, the drum is made from plastic. | <input type="checkbox"/> |
| Hose reel, automatic, 20 m, painted | 4 | 6.392-106.0 | 20 m | | | | | | Automatic hose reel of durable plastic. Painted steel bracket. Suitable for 20 m high-pressure hose. | <input type="checkbox"/> |
| | 5 | 6.392-105.0 | 20 m | | | | | | | <input type="checkbox"/> |
| Hose reel, automatic, 20 m, stainless steel | 6 | 6.392-076.0 | 20 m | | | | | | Automatic stainless steel hose reel. With swivel holder. Suitable for 20 m high-pressure hose. | <input type="checkbox"/> |
| ABS hose reel stainless steel | 7 | 6.392-122.0 | 20 m | | | | | | High-grade, automatic steel hose reel. Especially suitable for use in the food industry. The material and finish provide for a corrosion-resistant, watertight capsuled sprong drive. Connection for HP hoses with nipple. | <input type="checkbox"/> |
| Add-on kit hose reel TR 40m | 8 | 6.392-442.0 | 40 m | | | | | | | <input type="checkbox"/> |
| Swivel holder | 9 | 2.639-931.0 | | | | | | | Swivel holder for automatic hose reel wall mounting. For maximum action radius and flexibility of high-pressure hose. Rotatable 120°. Galvanised steel. | <input type="checkbox"/> |
| ABS wall fastening stainless steel | 10 | 2.641-867.0 | | | | | | | Swivelling wall bracket made of high-grade steel (for 2.641-866). This makes maximum flexibility and convenience possible when working with the HP hose. | <input type="checkbox"/> |
| Anbausatz Schlauchtrommel automatik | | | | | | | | | | |
| Add-on kit automatic hose reel HDS-C | 11 | 2.110-012.0 | | | | | | | | <input type="checkbox"/> |
| Add-on kit hose reel | 12 | 2.110-013.0 | | | | | | | | <input type="checkbox"/> |

■ Included in delivery. □ Available accessories. ▲ Extension hose.

ACCESSORIES FOR HDS 5/12 C

1.272-902.0



| | | Order Number | Flow rate | | | | Price | Description | |
|--------------------------------|---|--------------|-------------|--|--|--|-------|--|--------------------------|
| Push-on washing brush | | | | | | | | | |
| Push-on washing brush | 1 | 4.762-497.0 | | | | | | With clamp for mounting directly to units' double or triple nozzle. Fits on new double and triple nozzles. | <input type="checkbox"/> |
| Push-on wash brush, M 18 x 1.5 | 2 | 4.113-001.0 | | | | | | Push-on wash brush for universal use. Simply push on to lance. Connector: M 18 x 1.6. | <input type="checkbox"/> |
| Rotating washing brush | | | | | | | | | |
| | 3 | 4.113-004.0 | 500-800 l/h | | | | | | <input type="checkbox"/> |
| | 4 | 4.113-003.0 | 500-800 l/h | | | | | | <input type="checkbox"/> |

■ Included in delivery. □ Available accessories. ▲ Extension hose.

ACCESSORIES FOR HDS 5/12 C

1.272-902.0

KÄRCHER

| | | Order Number | Length | Diameter | | | Price | Description | |
|--------------------------------------|----|--------------|--------|----------|--|--|-------|--|--------------------------|
| Geka coupling | | | | | | | | | |
| With hose nozzle, R 1/2" | 1 | 6.388-461.0 | | | | | | with hose liner | <input type="checkbox"/> |
| With hose nozzle, R 3/4" | 2 | 6.388-455.0 | | | | | | | <input type="checkbox"/> |
| With hose nozzle, R 1" | 3 | 6.388-465.0 | | | | | | | <input type="checkbox"/> |
| Hose coupling | 4 | 6.388-458.0 | | | | | | with female thread | <input type="checkbox"/> |
| Suction filter | | | | | | | | | |
| Water filter | 5 | 6.414-956.0 | | | | | | | <input type="checkbox"/> |
| Suction filter with check valve | 6 | 4.730-012.0 | | | | | | Brass suction filter suitable for ponds, storage tanks, etc. With check valve. | <input type="checkbox"/> |
| Fine-mesh water filter | | | | | | | | | |
| Fine-mesh water filter with adapter | 7 | 4.730-102.0 | | | | | | Fine-mesh water filter, 125 µm, max. temperature 50°C. Protects the high-pressure cleaner from dirt particles contained in the water. Water flow rate up to 1200 l/h. Connection 3/4", with adapter, 1". | <input type="checkbox"/> |
| Fine-mesh water filter, 100 µm, R 1" | 8 | 2.638-270.0 | | | | | | Fine-mesh water filter, 100 µm, max. temperature 60°C. Connects to high-pressure cleaner. Protects the high-pressure cleaner from dirt particles contained in the water. Water flow rate up to 1200 l/h. Connector 1". | <input type="checkbox"/> |
| Water supply hose | | | | | | | | | |
| Water supply hose | 9 | 4.440-038.0 | 7,5 m | | | | | NW 13 R1" / R 3/4", up to 30 °C | <input type="checkbox"/> |
| | 10 | 4.440-207.0 | 7,5 m | | | | | NW 19 R1" / R 3/4", up to 85 °C, for pick-up | <input type="checkbox"/> |

■ Included in delivery. □ Available accessories. ▲ Extension hose.