

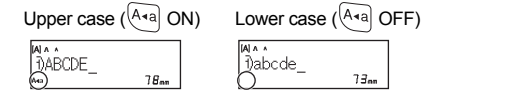

BASIC USAGE

Entering Text

Switching Upper Case/Lower Case



Making Two Lines of Text

- To make two lines of text, do one of the following:
- Enter the text for the first line and then press for the second line.
  - Move the cursor to where the second line starts and press .

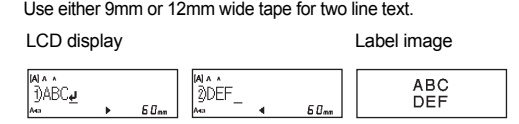

NOTE

Do not press after the second line; otherwise the "Line Limit" error message will appear.

To Clear

- Press to delete the letters one by one.
- To delete all text and settings :

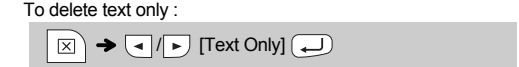
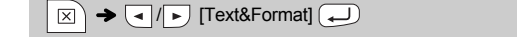

Entering Tab

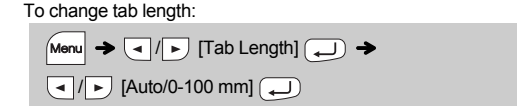

Using a 9mm wide tape with settings of [Small] text size, [x 1/2] text width and [15mm] tab length, you can create a label suitable for patch panel.

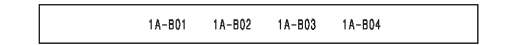

NOTE

Entering a Tab will position the cursor to the next Tab Length starting from the left side of the label and not from the last character position.

Entering Accented Characters



A	A A A A	Æ A A A A A	a	a a a a æ a a a a
C	C C C	D D D	c	c c c d d d
E	E E E E E E E		e	ë ê ë é ê é ê
G	G G	I I I I I I I	g	ğ ğ i i i i i i
K	K	L L L L L	k	k l l l l l
N	N N N N	R R R R	n	ñ ñ ñ ñ r r r r
O	O O O Ø O Ø	œ œ	o	ö ö ø ø œ œ
S	S S S S B	T T T P	s	š š š š B t t t b
U	U U U U U U U		u	ü ü ü ü ü ü ü
Y	Y Y	Z Z Z Z	y	ý ý z z z z

- To cancel the current operation, press .
- The order of accented characters differs depending on the selected LCD language.

Changing Label Length

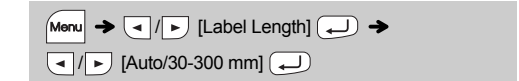

NOTE

- After the label is printed, cut along the printed dots (:) with scissors so that the label length matches the P-touch setting.
- If a specific label length has been selected, also appears on the LCD.

Reset the P-touch E100

You can reset your P-touch E100 labelling system when you need to initialize the settings, or if the P-touch E100 is not working correctly.

- Turn off the P-touch labeller, hold down and and then press to turn the P-touch back on.

- Release and .
- The P-touch turns on with the internal memory reset.

NOTE

All text, settings and stored files are cleared.

Printing Labels

Preview

You can preview the text before printing.



Feeding (Tape Feed)

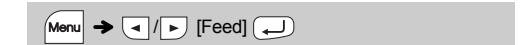

Printing



- If you need only 1 copy of the label, press without selecting the number of copies.
- The number of copies can also be specified by pressing a number key.
- To prevent damage to the tape, do not touch the cutter lever while the message "Printing..." or "Feeding..." is displayed.
- To cut off the label, push in the tape cutter lever on the upper-right corner of the P-touch.
- Peel the printed label from the backing and apply the label.
- You can print up to 9 copies of each label.

Setting Margin

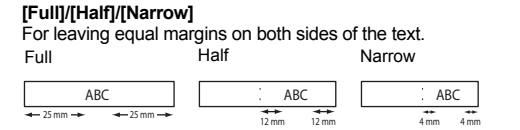
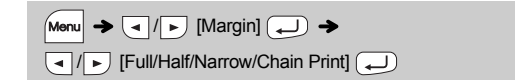

- [Full]/[Half]/[Narrow]
- For leaving equal margins on both sides of the text.
- Full Half Narrow
- [Chain Print]
- For batch printing without ejecting each label.
- Enter text.
  - Press , then [Copies: ] appears.
  - Press or enter a number using the number keys to select the number of copies.
  - Press . Printing will start, and then the message "OK to Feed?" appears.
  - Press to enter more text.
  - Clear the text, enter the text for the next label, and then press .
  - When the message "OK to Feed?" appears after the last label is printed, press .
  - After the tape is fed, press the cutter lever to cut off the chain of labels.

NOTE

- When [Half] or [Narrow] is set, the displayed label length is the length from the printed dots (:) to the end of the label.

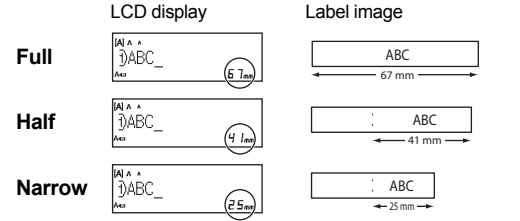

- To print more than 1 copy of a label with minimum margins, set the margin to [Narrow].
- When [Chain Print] is set, feed the tape before using the cutter otherwise a part of the text may be cut off. Also, cut along the printed dots (:) with scissors so the text is centred in the label. \*Feed the tape before using the cutter.
- Do not pull the tape since this may damage the tape cassette.

Saving Label Files

You can save up to 9 labels and recall them for printing at a later date. A maximum of 80 characters can be saved per file, a maximum total of 720 characters for the total memory. You can also edit and overwrite the stored label.

Print

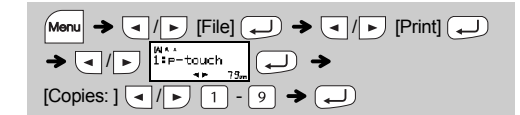

Save

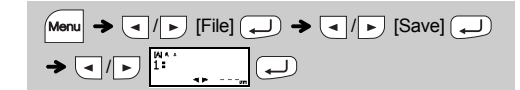

Open

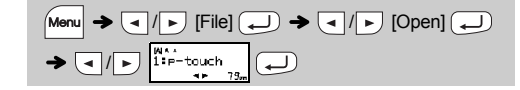

NOTE

If you try to store a label when there is already a label stored to that number, a message "Overwrite?" will appear. Press to save your new label. Press to cancel.

Accessories

**Tape Cassettes:** See the included "Tape catalog".  
**Cutter Unit:** TC-4 (replacement)

If the cutter blade becomes blunt after repetitive use and the tape cannot be cut cleanly, replace with a new cutter (stock no. TC-4) obtained from an authorized Brother reseller.

Replacing the Cutter Unit

- Pull out the two sections of the cutter unit (green) in the direction of the arrows shown in the illustration.

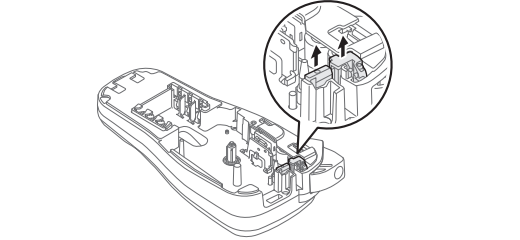

- Install a new cutter unit. Push it in until it snaps into place.
- Do not touch the cutter blade directly with your fingers.

USING TEMPLATES

Cable Wrap

You can create a label that can be wrapped around a cable or wire. The input text line is rotated 90° counterclockwise and printed on a label whose length is automatically determined by setting the cable diameter.

With the CableRot/Rpt function, the text is printed repeatedly along the length of the label so that it can easily be read from any angle.

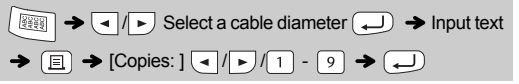
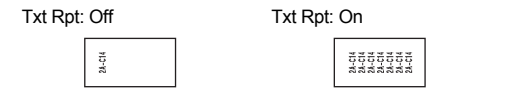

- Cable diameter: 3mm to 90mm available  
Default: 6mm
- To activate the Txt Rpt function, press and then select [CableRot/Rpt].

NOTE

- For labels attached to cables and wires, we recommend using Flexible ID Tape. Use the cable flag function when the diameter of the object is less than 3mm.
- To deactivate the Cable Wrap/Cable Flag/Faceplate function during operation, press / / accordingly and the settings change back to standard.

Faceplate

Labels printed with this function can be used to identify various components or panels.

A block of text is evenly spaced on a single label.



- Faceplate length: 30mm to 300mm  
Default: 50mm

NOTE

To position the text appropriately for multiple ports in a single print, either use the chain print function with the Faceplate length equal to the port width, or enter the Faceplate length equal to the total length over all the ports and then use the tab function to space out each port data.

USEFUL FUNCTIONS

Underline and Frame

You can select the desired frame design.



	2
12345	~ ~ ~ ~ ~
	3

NOTE

Frames cannot be printed on 3.5mm tape.

Short Cut Keys

Size	→ 1	Tab	→ 8
Style	→ 2	Tab Length	→ 9
Width	→ 3	Preview	→ 0
Undl/Frame	→ 4	Margin	→ -
Label Length	→ 5	Unit	→ .
CableRot/Rpt	→ 6	Feed	→
File	→ 7	Language	→

Text Keys + 1 / 2 / 3

- Press + 1 / 2 / 3 to select the settings to enter the text.



- Press / to select the settings.

Size	Large	
+ 1	Medium	
	Small	
Style	Normal	
+ 2	Bold	
	Outline	
	Shadow	
	Italic	
	I+Bold	
	I+Outline	
	I+Shadow	
	Vertical	
Width	Normal	
+ 3	x 2	
	x 1/2	

Cable Flag

With this function, a label can be wrapped around a cable or wire with its ends stuck together to form a flag. The input text lines are printed at the both ends of a label.

You can select the desired flag length. When [Auto] is selected, the flag length is automatically adjusted according to the text length.

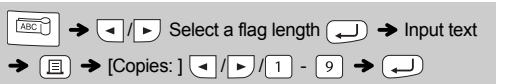

- Flag length: 10mm to 200mm, Auto  
Default: Auto

Serialize

Using the Serialize function, you can print multiple labels with a number or letter automatically incremented on each label.

This serializing function can also be used with the Cable Wrap, Cable Flag or Faceplate templates to save time entering and printing a series of labels.

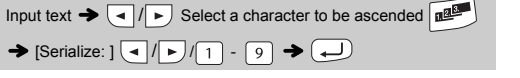

Symbol Key

- Press to select one of 12 symbol categories.



- Use / to select the desired symbol.

/  Select a symbol	1	2	3	4	5	6	7
Punctuation	.	,	?	!	"	'	:
	8	9	10	11	12	13	14
	:	-	-	\	/	&	¢
	15	16	17	18	19	20	21
	!	~	•	*	@	#	%
Brackets	1	2	3	4	5	6	7
	(	)	[	]	<	>	«
	8						
	»						
Bullets	1	2	3	4	5	6	
	✓	☑	●	○	■	□	
Sup(Superscript)/ Subscript	1	2	3	4	5	6	7
	o	®	©	™		1	2
	8	9	10				
	1	2	3				
Mathematics	1	2	3	4	5	6	
	+	-	x	÷	±	=	
Arrows	1	2	3	4	5	6	7
	→	←	↑	↓	↗	↘	↖
	8	9	10	11	12	13	
	↙	↘	↖	↗	↘	↙	
Currency	1	2	3	4	5		
	\$	¢	€	£	¥		
Greek	1	2	3	4	5	6	7
	α	β	γ	δ	φ	λ	μ
	8						
	Ω						
Electrical	1	2	3	4	5	6	7
	⏻		○	⌚	⌚	⌚	⌚
	8	9	10	11	12	13	14
	⏻	⏻	⏻	⏻	⏻	⏻	⏻
	15	16	17	18	19	20	21
	⏻	⏻	⏻	⏻	⏻	⏻	⏻
	22	23	24	25	26	27	28
	⏻	⏻	⏻	⏻	⏻	⏻	⏻
	29	30	31	32	33	34	35
	⏻	⏻	⏻	⏻	⏻	⏻	⏻
	36	37					
	⏻	⏻					
Datacom	1	2	3	4	5	6	7
	☎	☎	☎	☎	☎	☎	☎
	8	9	10	11	12	13	
	☎	☎	☎	☎	☎	☎	
AV / Security	1	2	3	4	5	6	7
	📺	📺	📺	📺	📺	📺	📺
	8	9	10	11	12	13	14
	📺	📺	📺	📺	📺	📺	📺
	15	16	17	18	19	20	21
	📺	📺	📺	📺	📺	📺	📺
	22						
	⏮						
Safety	1	2	3	4	5	6	7
	⚠	⚠	⚠	⚠	⚠	⚠	⚠
	8	9	10	11	12	13	14
	⚠	⚠	⚠	⚠	⚠	⚠	⚠
	15	16	17	18	19		
	⚠	⚠	⚠	⚠	⚠		

NOTE

- Press to return to the previous step.
- The symbols shown in the above table may look slightly different on the machine LCD and when printed.