



de Gebrauchsanweisung Bodenstaubsauger

en Vacuum cleaner operating instructions

fr Mode d'emploi pour aspirateur traîneau

nl Gebruiksaanwijzing stofzuigers

it Istruzioni d'uso per aspirapolvere a traino

HS12

en - Contents

Warning and Safety instructions	21
Guide to the appliance	26
Caring for our environment	28
Preparing for use	29
Using the accessories supplied	30
Use	30
Unwind the mains cable	30
To switch on and off.	30
During vacuuming	31
To regulate the suction power	31
To open the air inlet valve	31
Parking and storing the cleaner	31
Maintenance	32
Purchasing new dustbags and filters	32
Ordering the correct dustbags and filters	32
When to change the dustbag	33
How the dustbag change indicator works.	33
How to replace the dustbag	33
When to change the dust compartment filter (for motor protection)	34
How to change the dust compartment filter	34
When to replace the AirClean exhaust filter	34
How to replace the AirClean filter	34
Replacing one type of exhaust filter with another	34
When to replace an Active AirClean 30 / HEPA AirClean 30 filter	34
How to replace an Active AirClean 30 filter or a HEPA AirClean 30 filter	34
When to change the thread lifters	35
How to replace the thread lifters	35
Problem solving guide	35
After sales service	35
Guarantee	35
Electrical connection for the UK	36
Electrical connection AU, NZ	36

This vacuum cleaner complies with statutory safety requirements. Improper use can, however, lead to personal injury and damage to property.

To avoid the risk of accidents and damage to the vacuum cleaner, please read these instructions carefully before using it for the first time. They contain important information on its safety, operation and maintenance.

Keep these instructions in a safe place and ensure that new users are familiar with the content. Pass them on to any future owner.

Always disconnect the vacuum cleaner from the mains supply when you have finished using it, before changing over accessories, as well as for maintenance work and cleaning. Switch the vacuum cleaner off at the wall socket and unplug it.

Correct application

- ▶ This vacuum cleaner is intended for cleaning flooring in domestic households and similar residential environments.
- ▶ This vacuum cleaner is intended for daily cleaning of carpets, rugs and hard flooring.
- ▶ This vacuum cleaner is not intended for outdoor use.

en - Warning and Safety instructions

- ▶ The vacuum cleaner must only be used to vacuum dry floor surfaces. Do not use on people or animals. Any other usage, modification or alteration is not supported by the manufacturer and could be dangerous.
- ▶ This vacuum cleaner can only be used by people with reduced physical, sensory or mental capabilities, or lack of experience or knowledge, if they are supervised whilst using it or have been shown how to use it in a safe way and understand and recognise the consequences of incorrect operation.

Safety with children

- ▶ Children under 8 years of age must be kept away from the vacuum cleaner unless they are constantly supervised.
- ▶ Children 8 years and older may only use the vacuum cleaner unsupervised if they have been shown how to use it safely and recognise and understand the consequences of incorrect operation.
- ▶ Children must not be allowed to clean or maintain the vacuum cleaner unsupervised.
- ▶ Please supervise children in the vicinity of the vacuum cleaner and do not let them play with it.

Technical safety

- ▶ Before using the vacuum cleaner and its accessories, check for any visible signs of damage. Do not use a damaged appliance.
- ▶ Ensure that the connection data on the data plate of the vacuum cleaner (voltage and frequency) match the mains electricity supply exactly.
- ▶ The mains electrical plug must be fitted with a 13 A fuse (UK).
- ▶ While the vacuum cleaner is under guarantee, repairs should only be undertaken by a Miele authorised service technician. Otherwise the guarantee will be invalidated.
- ▶ Do not pull or carry the vacuum cleaner by the cable, and be careful not to damage the cable when withdrawing the plug from the socket.
Keep the cable away from sharp edges and do not let it get squashed, for example, under a door.
Avoid running the vacuum cleaner over the cable. This could damage the cable, plug or socket.
The appliance must not be used if any of these have suffered damage.
- ▶ Do not use the vacuum cleaner if the cable is damaged. If the cable is damaged it must be replaced together with a complete cable rewind. For safety reasons this work must be done by the Miele Service Department or a Miele authorised service technician.

en - Warning and Safety instructions

- ▶ When vacuuming fine dust, e.g. sawdust, sand, plaster, flour, talcum powder etc., electrostatic charges build up naturally. Under certain conditions these charges will be released. To avoid the unpleasant effects of these discharges, a metal inlay has been incorporated into the underside of the handle. Please make sure that you keep your hand in constant contact with this metal strip during vacuuming.
- ▶ Do not let the vacuum cleaner get wet. Clean only with a dry cloth or slightly damp cloth when disconnected from the mains supply.
- ▶ Repairs should only be carried out by a Miele authorised service technician. Repairs and other work by unqualified persons can cause considerable danger to users.

Correct use

- ▶ To avoid the risk of damage, do not use the vacuum cleaner without the dustbag, dust compartment filter and exhaust filter in place.
- ▶ The dust compartment cover will not close without a dustbag fitted. Do not force it.
- ▶ Do not vacuum up anything which has been burning or is still glowing e.g. cigarettes, ashes or coal, whether glowing or apparently extinguished.
- ▶ Do not use the vacuum cleaner to vacuum up any water, liquid or damp dirt. Wait until any freshly cleaned or shampooed carpets or floor coverings are completely dry before attempting to vacuum.

- ▶ Do not use the vacuum cleaner to vacuum toner dust. Toner, such as that used in printers and photocopiers, can conduct electricity.
- ▶ Do not vacuum up any inflammable or combustible liquids or gases and do not vacuum in areas where such substances are stored.
- ▶ Floor attachments, accessories and tubes must not be used at head level to avoid the risk of injury, e.g. to eyes and ears.

Accessories

- ▶ To avoid the risk of injury when vacuuming with a Miele Turbobrush, do not touch the rotating roller brush.
- ▶ It is not advisable to vacuum directly with the handle, i.e. without an accessory attached as the rim could get damaged and you could hurt yourself on sharp edges.
- ▶ Only use genuine dustbags, filters and accessories with the "Original Miele" logo on them. Otherwise the manufacturer cannot guarantee the safety of the product.

Miele cannot be held liable for damage caused by incorrect use or operation or by non-compliance with these Warning and Safety instructions.

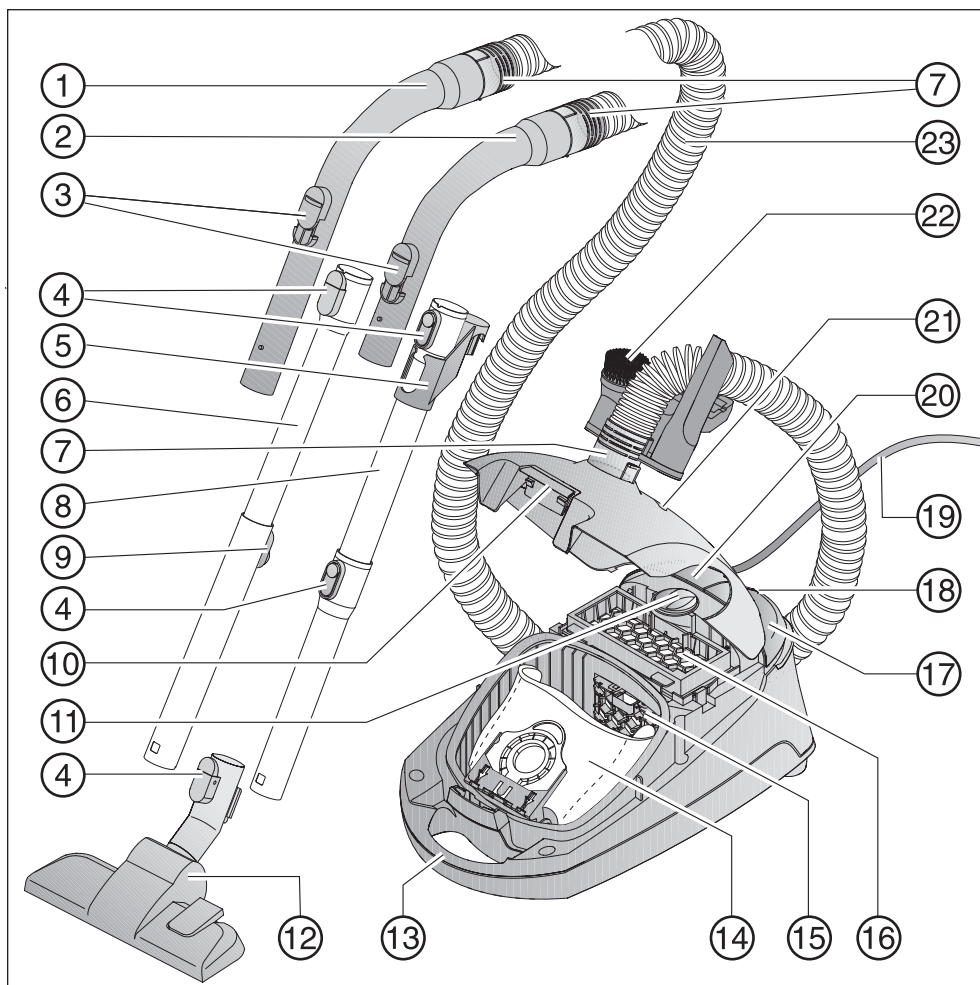

- ① XXL handle *
- ② Handle *
- ③ Air inlet valve
- ④ Release buttons
- ⑤ Connection piece for storage *
- ⑥ Telescopic tube *
- ⑦ Hose connection socket
- ⑧ EasyLock suction tube *
- ⑨ Release button for the telescopic tube *
- ⑩ Dust compartment release catch
- ⑪ Suction power selector
- ⑫ Floorhead *
- ⑬ Carrying handle
- ⑭ Dustbag
- ⑮ Dust compartment filter (for motor protection)
- ⑯ AirClean filter
- ⑰ On/Off foot control ①
- ⑱ Park system
- ⑲ Mains cable
- ⑳ Foot switch for automatic cable rewind
- ㉑ Dustbag change indicator
- ㉒ Accessories holder with three accessories
- ㉓ Suction hose

Underneath - suction tube holder (not illustrated)

Features marked * depend on model and may vary or not be available on your vacuum cleaner.

Optional accessories

Miele accessories are available to order from your Miele Dealer, the Miele Spare Parts Department or via the internet at www.miele-shop.com.

Disposal of packing material

The packaging is designed to protect the vacuum cleaner from damage during transportation. The packaging materials used are selected from materials which are environmentally friendly for disposal and should be recycled.

Recycling the packaging reduces the use of raw materials in the manufacturing process and also reduces the amount of waste in landfill sites.

Ensure that any plastic wrappings, bags, etc. are disposed of safely and kept out of the reach of babies and young children. Danger of suffocation.

Disposing of the dustbag and filters

These are made from environmentally friendly materials. The filters can be disposed of with the normal household waste. The dustbag can also be disposed of in this way if it has been used exclusively for general household dust.

Disposing of your old appliance

Before disposing of your old appliance remove the dustbag and all the filters and dispose of them with your normal household waste.

Electrical and electronic appliances often contain valuable materials. They also contain materials which, if handled or disposed of incorrectly, could be potentially hazardous to human health and to the environment. They are, however, essential for the correct functioning of your appliance. Please do not therefore dispose of it with your household waste.

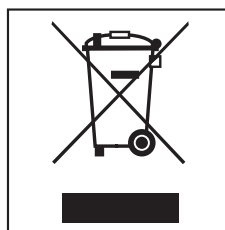

Please dispose of it at your local community waste collection/recycling centre, or contact your dealer for advice.

Ensure that it presents no danger to children while being stored for disposal.

The illustrations referred to in the text are shown on the fold-out pages at the end of these operating instructions.

Preparing for use

Attach the suction hose (dia. 1)

- ① Insert the hose connector into the suction socket on the vacuum cleaner until it clicks into position.

To detach the suction hose

- ② Press the release buttons at the side of the hose connector, and lift the hose from the socket.

Connect the handle to the suction hose (dia. 2)

- Fit the connector at the other end of the suction hose into the handle until it clicks into position.

Your vacuum cleaner is fitted with one of the following tubes, depending on model (see "Description of the vacuum cleaner"):

- EasyLock suction tube
- Telescopic suction tube

To assemble the EasyLock tube (dia. 3)

- Hold the suction tube by the connection piece and push it into the second suction tube, turning it clockwise or anti-clockwise until it clicks into position.
- Slide the connection piece upwards until it clicks into position.

Attach the handle to the suction tube (dia. 4)

- ① Insert the handle into the suction tube until it clicks into position. To do this, line up the guides on the two pieces.

To detach the handle

- ② Press the release button and pull the handle out of the suction tube, twisting it slightly as you do so.

To adjust the telescopic tube (dia. 5)

One part of this telescopic tube is packed inside the other and can be adjusted to suit your height for comfortable vacuum cleaning.

- Press the release button (see arrow) to release the tubes and adjust to the required height.

Attach the standard floorhead (dia. 6)

- ① Push the suction tube into the floorhead and turn it clockwise or anti-clockwise until it clicks into position.

To detach the floorhead

- ② Press the release button and pull the suction tube away from the floorhead, twisting it slightly as you do so.

To adjust the standard floorhead

This floorhead can be used for all normal cleaning of carpets, rugs and robust hard flooring.

Miele offer a range of other floorheads, brushes and accessories for other types of flooring and special requirements.

Please observe the flooring manufacturer's cleaning and care instructions.

- ③ Vacuum carpets and rugs with the brush retracted (Press the  foot control). Clean hard flooring with is not susceptible to scratching, as well as flooring with gaps or deep crevices in it with the brush protruding (press the  foot control).

AirTeQ floorhead

If the suction power of the AirTeQ floorhead seems too high, reduce the suction until the floorhead is easier to manoeuvre (see "Use - To regulate the suction power").

Using the accessories supplied (dia. 7 + 8)

The following accessories are supplied:

- ① Dusting brush
- ② Upholstery nozzle
- ③ Crevice nozzle
- ④ Accessory holder for the three accessories supplied:

Symbols on the holder show where to attach the different accessories.

- Attach the accessories holder to the hose connector socket at the top or bottom of the suction hose. Make sure it clicks into position.

Depending on model, your vacuum cleaner may be supplied with an Active AirClean 30 or HEPA AirClean 30 filter which can be fitted instead of the standard AirClean filter (see "Maintenance and care - Replacing one type of exhaust filter with another").

Floorhead (dia. 9)

For general use and also for vacuuming the stairs.

 For safety reasons when vacuuming stairs it is best to start at the bottom of the stairs and move upwards.

Use

Unwind the mains cable (dia. 10)

- ① Pull the mains cable out to the required length (max. cable length approx. 5.5 m). Insert the plug into the socket correctly and switch on.

 If vacuuming for longer than 30 minutes, the mains cable must be pulled out to its fullest extent. Otherwise there is a danger of overheating and damage.

To rewind the cable

- Switch off at the wall socket and remove the plug.
- ② Press the rewind foot switch. The cable will rewind automatically.

To switch on and off (dia. 11)

- Press the On/Off foot control ①.

During vacuuming (dia. 12)

 When vacuuming fine dust, e.g. sawdust, sand, plaster, flour, talcum powder etc., electrostatic charges build up naturally. Under certain conditions these charges will be released. To avoid the unpleasant effects of these discharges, a metal inlay has been incorporated into the underside of the handle. Please make sure that you keep your hand in constant contact with this metal strip during vacuuming.

To regulate the suction power (dia. 13)

The suction power can be regulated to suit the type of flooring being cleaned. Reducing the suction power reduces the amount of effort required to manoeuvre the floorhead.

The vacuum cleaner has symbols on the controls which indicate the type of use the settings are suitable for.

 - curtains, fabric

 - upholstery, cushions

 - thick pile carpets, rugs and runners

 - for energy-saving vacuuming (this setting is also very quiet)

 - loop pile carpet

 - heavily soiled hard flooring and intensive cleaning of carpets

When using the AirTeQ floorhead, if the suction seems too high, reduce the suction until the floorhead is easier to manoeuvre.

- Turn the suction power selector manually to the suction power setting you require.

To open the air inlet valve (dia. 14 + 15)

It is easy to reduce the suction power for a short time, e.g. to prevent rugs or other objects being sucked into the vacuum cleaner.

- Open the air inlet valve on the handle far enough to reduce the suction power.

The floorhead will be easier to manoeuvre. Close the valve up again when you are ready to use full power again.

Parking and storing the cleaner

Park system (dia. 16)

The Park system allows you to conveniently park the suction tube and floorhead during pauses.

- Slot the floorhead into the parking attachment at the back of the vacuum cleaner.

If your vacuum cleaner is on a sloping surface, e.g. a ramp,
 - retract the telescopic tube fully
 - do not use the park system if your vacuum cleaner has an EasyLock suction tube!

Storage (dia. 17 + 18)

- Stand the vacuum cleaner upright.
- Slot the floorhead downwards into the parking attachment on the side of the vacuum cleaner.

If your vacuum cleaner has a telescopic tube, retract the tubes fully so that it takes up less room for storage.

If your vacuum cleaner has an EasyLock suction tube you can separate the two sections for storage purposes.

- Press the release button on the lower section and pull the top section out.
- Push the connection piece attached to the upper tube into the lower tube.

Maintenance

⚠ Always disconnect the vacuum cleaner from the electrical supply for maintenance work and for cleaning. Switch off at the wall socket and unplug it.

The Miele filtration system consists of three filters.

- Dustbag
- Dust compartment filter (for motor protection)
- Exhaust filter

These will need to be replaced from time to time to ensure that your vacuum cleaner performs efficiently.

Only use genuine dustbags, filters and accessories with the "Original Miele" logo on them. This will ensure that the suction power of the vacuum cleaner is maintained, giving the best possible cleaning results.

⚠ The use of dustbags made from paper or paper-based materials, or dustbags with a cardboard collar, or dustbags that do not carry the "Original Miele" logo, can seriously damage the vacuum cleaner and invalidate the warranty.

Purchasing new dustbags and filters

Original Miele dustbags and filters can be ordered from Miele, your Miele dealer or online at:



Ordering the correct dustbags and filters

Only use original Miele **G/N** dustbags with a **blue** collar and original Miele filters. These are identified by the "Original Miele" logo on the packaging or directly on the dustbag.



An Air Clean filter and a dust compartment filter are supplied with every packet of Miele dustbags.

These can also be purchased separately from your Miele Dealer, from Miele or from the online shop. Please quote the model number of your vacuum cleaner when ordering to make sure you get the correct filter.

When to change the dustbag (dia. 19)

Change the dustbag when the colour marker in the dustbag change indicator turns red, or sooner if it is no longer effective (see possible reasons for this below).

Miele dustbags are disposable and designed for single use only. Dispose of the dustbag when full. Do not attempt to reuse. Blocked pores in used dustbags will reduce the suction power of the vacuum cleaner.

Checking the dustbag change indicator

- Attach the standard floorhead to the suction tube.
- Switch the vacuum cleaner on and select the highest power setting.
- Lift the floorhead off the floor a little.

How the dustbag change indicator works

The dustbag change indicator is set for normal household dust. This generally contains a mixture of: dust, hair, threads, carpet fluff, grit etc.

However, if the cleaner has been used to vacuum up fine dust, such as plaster, brick dust, cement or flour, the pores of the dustbag will become blocked very quickly. This affects the air permeability of the bag, and the marker will indicate that the bag is "full" even when it is not. If this happens you must still change the dustbag because suction power will be greatly reduced by blocked pores in the dustbag. If, on the other hand, a large amount of hair and carpet fluff which typically contains a lot of air is vacuumed up, the indicator may fail to react even though the bag is full. You should still change it. Both these extremes can occur.

How to replace the dustbag (dia. 20 + 21)

- Press the release catch for the dust compartment lid and raise the lid as far as it will go.

The dustbag has a closing flap which closes automatically when the dust compartment lid is raised to prevent any dust escaping.

- ① Pull the dustbag out by the grip on the collar.
 - ② Fit the new dustbag into the holder as far as it will go. Leave it folded up when you take it out of the box.
- It should be unfolded as far as possible in the dust compartment.
 - Close the dust compartment lid securely, making sure it clicks into position. Take care not to trap the dustbag when doing so.

The lid will not close without a dustbag in place. Do not force it!

When to change the dust compartment filter (for motor protection)

Replace this filter every time you start a new packet of dustbags. A dust compartment filter is supplied with every packet of Miele dustbags.

How to change the dust compartment filter (dia. 22)

- Open the dust compartment lid.
- Unclip the filter frame and replace the dust compartment filter.
- Close the filter frame.
- Close the dust compartment lid.

When to replace the AirClean exhaust filter

Replace this filter every time you start a new packet of Miele dustbags. An AirClean exhaust filter is supplied with every packet of Miele dustbags.

How to replace the AirClean filter (dia. 23)

Do not use more than one exhaust filter at a time.

- Open the dust compartment lid.
- ① Release the filter grille and raise it upwards. Grasp the used AirClean filter by the clean, unsoiled section (see arrow) and take it out.
- ② Replace it with a new filter.
- Close the filter grille.
- Close the dust compartment lid.

Replacing one type of exhaust filter with another

Depending on model, your vacuum cleaner may also be supplied with an Active AirClean 30 or HEPA AirClean 30 filter which can be fitted instead of the standard AirClean filter.

In order to use either of these filters you first have to remove the AirClean filter and the filter grille and replace these with the new filter. You will also need to activate the exhaust filter change indicator ► (dia. 24).

After approx. 10 - 15 seconds a thin red stripe will appear in the left hand side of the display (dia. 25).

When to replace an Active AirClean 30 / HEPA AirClean 30 filter (dia. 26)

Replace if the display for the exhaust filter change indicator is completely filled with red.

This occurs after approx. 50 hours of operation which is equivalent to about a year of average use. The vacuum cleaner can still be used. However, the suction power will be reduced as will the effectiveness of the filter if it is not replaced in good time.

How to replace an Active AirClean 30 filter or a HEPA AirClean 30 filter (dia. 27)

- ① Lift out the old exhaust filter.
- ② Replace it with a new filter.

When to change the thread lifters

The thread lifters on the suction inlet to the floorhead can be replaced.

Check them from time to time and replace them if the pile has worn down.

How to replace the thread lifters (dia. 28)

- Use a suitable screwdriver to remove the thread lifters from the slots.
- Fit new thread lifters.

Replacement parts are available from your Miele Dealer or from Miele (see end of booklet for contact details).

Problem solving guide

The vacuum cleaner switches off automatically.

A temperature limiter switches the vacuum cleaner off automatically if it gets too hot.

This can occur if, for instance, large articles block the suction tube or when the dustbag is full or contains particles of fine dust. A heavily soiled exhaust or dust compartment filter can also be the cause of overheating. Switch the vacuum cleaner off immediately using the On/Off foot control ①. Disconnect from the electricity supply. Switch off at the wall socket and unplug it.

After removing the cause, wait for approximately 20 - 30 minutes to allow the vacuum cleaner to cool down. It can then be switched on again.

After sales service

In the event of a fault that you cannot easily remedy, please contact

- your Miele Dealer, or
- Miele (see end of booklet for contact details)

Please note that telephone calls may be monitored or recorded for training purposes (UK only).

Guarantee

This appliance is guaranteed for 2 years from the date of purchase. In the UK you must activate your cover by calling 0845 365 6640 or registering online at www.miele.co.uk.

For information on the appliance guarantee specific to your country please contact Miele. See end of booklet for contact details.

Electrical connection for the UK

All electrical work should be carried out by a suitably qualified and competent person in strict accordance with current national and local safety regulations (BS 7671 in the UK).

The voltage and frequency are given on the data plate located underneath the vacuum cleaner. Please ensure that these match the household mains supply. The fuse rating is quoted on the plug.

The appliance is supplied with a cable and moulded plug ready for connection to a 230-240 V/50 Hz a.c. single phase supply.

Non-rewireable plugs BS 1363

The fuse cover must be re-fitted when changing the fuse, and if the fuse cover is lost the plug must not be used until a suitable replacement is obtained. The colour of the correct replacement cover is that of the coloured insert in the base of the plug, or the colour that is embossed in words on the base of the plug, (as applicable to the design of plug fitted).

Replacement fuses should be ASTA approved to BS1362 and have the correct rating. Replacement fuses and fuse covers may be purchased from your local electrical supplier.

Electrical connection AU, NZ

All work should be carried out by a suitably qualified and competent person in strict accordance with national and local safety regulations.

The voltage and rated load are given on the data plate located underneath the vacuum cleaner. Please ensure that these match the household mains supply. The fuse rating is quoted on the plug.

The appliance is supplied with a cable and moulded plug ready for connection to a 230V/50Hz AC single phase supply.

Test Marks	Electrical safety RCM Mark
------------	----------------------------

Electrically suppressed according to	AS/NZS 1044
--------------------------------------	-------------