

Operating and installation instructions

SmartLine downdraft extractor

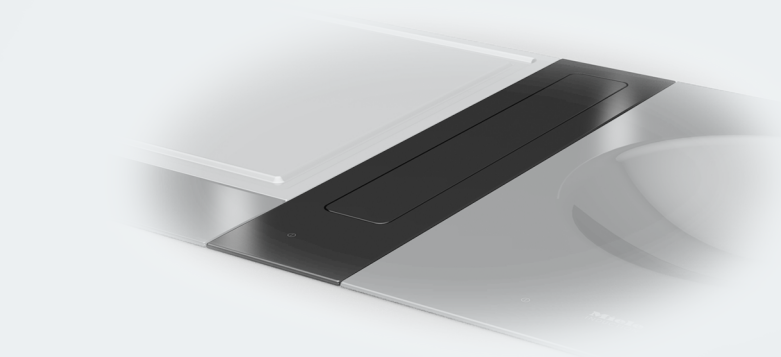

To avoid the risk of accidents or damage to the appliance it is **essential** to read these instructions before it is installed and used for the first time.

Contents

Warning and Safety instructions	4
Caring for the environment	13
Guide to the appliance	14
Downdraft extractor	14
Controls / Indicators	15
Cleaning the SmartLine element for the first time	16
Modes of operation	17
Tips on saving energy	18
Operation	19
FlameGuard	19
Switching the countertop extractor on	19
Setting/changing the power level	19
Switching the downdraft extractor off	19
Run-on time	19
Cleaning and care	20
Ceramic surface	21
Drip tray	21
Grease filter	22
Problem solving guide	23
Optional accessories	24
Safety instructions for installation	25
Installation notes	26
Onset installation	26
Installing several SmartLine elements	28
Minimum plinth height	28
Worktop depth	28
Installation examples	29
Building-in dimensions	30
Onset installation	30
Flush-fit installation	31
Worktop cut-out for onset installation	32
Surface-mounted installation	35

Worktop cut-out for flush-fit installation	36
Flush-mounted installation	39
Spacer bars	40
Installation	42
Preparing the worktop	42
Fitting the spacer bars	43
Installing the countertop extractor	44
E-box	45
Connection for air extraction	48
Electrical connection	49
After sales service	51
Contact in case of malfunction	51
Data plate	51
Warranty	51
Product data sheets	52

Warning and Safety instructions

This downdraft extractor complies with all relevant safety requirements. Inappropriate use can, however, lead to personal injury and damage to property.

Please read these operating and installation instructions carefully before using the downdraft extractor for the first time. They contain important information on the safety, installation, use and maintenance of the appliance. This prevents both personal injury and damage to the appliance. Miele cannot be held liable for damage caused by non-compliance with these instructions.

Keep these instructions in a safe place and pass them on to any future owner.

For safe operation, please also refer to the operating and installation instructions for the SmartLine elements and hob units installed adjacent to the downdraft extractor.

Correct application

► This downdraft extractor is intended for use in domestic households and similar working and residential environments.

► The downdraft extractor is not suitable for outdoor use.

► It must only be used as a domestic appliance to extract vapours and remove odours from cooking.

All other types of use are not permitted.

► This downdraft extractor can only be used by people with reduced physical, sensory or mental capabilities or lack of experience and knowledge if they are supervised whilst using it.

They may only use the downdraft extractor unsupervised if they have been shown how to use it in a safe manner. They must be able to recognise and understand the consequences of incorrect operation.

Warning and Safety instructions

Safety with children

- ▶ Children under 8 years of age must be kept away from the downdraft extractor unless they are constantly supervised.
- ▶ Children aged 8 and older may only use the downdraft extractor without supervision if they have been shown how to use it in a safe manner. Children must be able to recognise and understand the potential risks of improper use.
- ▶ Children must not be allowed to clean or maintain the downdraft extractor unsupervised.
- ▶ Children should be supervised in the vicinity of the downdraft extractor. Do not allow them to play with the downdraft extractor.
- ▶ Danger of suffocation. Packaging, e.g. plastic wrappings, must be kept out of the reach of babies and children. Whilst playing, children could become entangled in packaging or pull it over their head and suffocate.

Technical safety

- ▶ Unauthorised installation, maintenance and repairs can cause considerable danger for the user. Installation, maintenance and repairs must only be carried out by a Miele authorised technician.
- ▶ The downdraft extractor must only be installed and operated in combination with those SmartLine elements and hob units specified by Miele.
- ▶ Damage to the downdraft extractor can compromise your safety. Check it for visible signs of damage. Do not use a damaged downdraft extractor.
- ▶ Reliable and safe operation of this downdraft extractor can only be assured if it has been connected to the mains electricity supply.
- ▶ The electrical safety of the downdraft extractor can only be guaranteed when continuity is complete between it and an effective earthing system. It is most important that this basic safety requirement is present and tested regularly. If in doubt, the electrical installation should be checked by a qualified electrician.
- ▶ Before connecting the downdraft extractor to the mains supply, ensure that the connection data on the data plate (voltage and frequency) match the mains electricity supply. This data must correspond in order to avoid the risk of damage to the downdraft extractor. Compare this data before connecting the appliance to the mains. Consult a qualified electrician if in any doubt.
- ▶ Multi-socket adapters and extension leads do not guarantee the required safety of the appliance (fire hazard). Do not use these to connect the downdraft extractor to the mains electricity supply.
- ▶ For safety reasons, this downdraft extractor may only be used after it has been built in.
- ▶ This downdraft extractor must not be installed and operated in mobile installations (e.g. on a ship).

Warning and Safety instructions

- ▶ Any contact with live connections or tampering with the electrical or mechanical components of the downdraft extractor will endanger your safety and may lead to appliance malfunctions. Only open the casing as described in the installation instructions and in the “Cleaning and care” section of this booklet. Under no circumstances should any other parts of the casing be opened.
- ▶ The manufacturer's warranty will be invalidated if the downdraft extractor is not repaired by a Miele approved service technician.
- ▶ Miele can only guarantee the safety of the appliance when genuine original Miele replacement parts are used. Faulty components must only be replaced by Miele spare parts.
- ▶ The downdraft extractor is not intended for use with an external timer switch or a remote control system.
- ▶ If the plug is removed from the connection cable or if the cable is supplied without a plug, the downdraft extractor must be connected to the electrical supply by a suitably qualified electrician.
- ▶ If the mains connection cable is damaged, it must be replaced with a special connection cable by an electrician (see “Electrical connection”).
- ▶ During installation, maintenance and repair work, the downdraft extractor must be completely disconnected from the mains electricity supply. It is only completely isolated from the electricity supply when:
 - the mains fuse has been disconnected or
 - the screw-out fuses have been fully unscrewed or
 - the plug (if present) is removed from the socket. To do this, pull the plug not the mains connection cable.

Warning and Safety instructions

Using at the same time as other heating appliances that depend on the air from the room

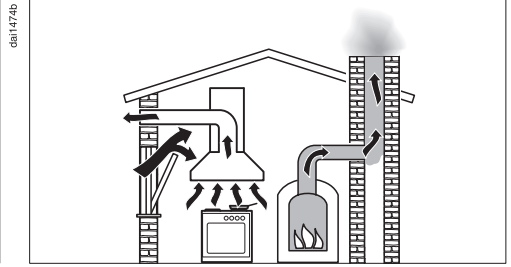
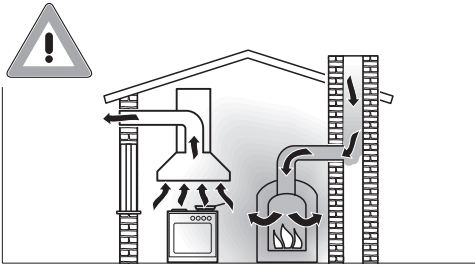

⚠ Danger of toxic fumes!

Great care should be taken when using the downdraft extractor in the same room or the same area of the house as another heating appliance that depends on the air from the room.

Such heating appliances draw in air from the room and duct exhaust gases out through a chimney or extraction ducting. They include gas, oil, wood and coal-fired boilers and heaters, continuous flow or other water heaters, gas hobs and ovens.

The downdraft extractor draws in air from the kitchen and from neighbouring rooms. This applies to the following modes of operation:

- extraction mode,
- recirculation mode with a recirculation box installed outside the room.

If there is insufficient air, an underpressure will occur. The heating appliance may be starved of oxygen. This impairs combustion. Harmful gases could be drawn from the chimney or extraction ducting back into the room.

This could have potentially fatal consequences!

Warning and Safety instructions

In order to ensure safe operation and to prevent gases given off by the heating appliance from being drawn back into the room, when the downdraft extractor and the heater are both operated simultaneously, an underpressure in the room of 0.04 mbar (4 Pa) is the maximum permissible.

Sufficient ventilation can be maintained by air inlets which cannot be blocked, e.g. in windows, doors and outside wall vents. The diameter of the inlet openings must enable sufficient ventilation. A ventilation brick alone is not generally sufficient to ensure safe ventilation.

The overall ventilation condition of the dwelling must be taken into account. If in any doubt, the advice of a competent builder, or for gas, a qualified gas fitter should be sought.

If the downdraft extractor is being operated in recirculation mode, where the air is directed back into the room in which it is located, operating a heating appliance which depends on the room air at the same time is not hazardous.

Correct use

- Open flames are a fire hazard!

Never use an open flame beside the downdraft extractor. To avoid the danger of fire, do not flambé or grill over an open flame. When switched on, the downdraft extractor could draw flames into the filter. Fat deposits could ignite, presenting a fire hazard

- Overheated oil and fat can ignite, causing fire damage to the downdraft extractor.

When cooking with oil or fat, chip pans and deep fat fryers etc, do not leave the pans unattended. Similarly, never leave an open grill unattended when grilling.

- Deposits of grease and dirt will prevent the downdraft extractor from working properly.

Do not use the downdraft extractor without the grease filters in place. Otherwise cooking vapours will not be cleaned.

- Hot cooking vapours during cooking can cause the downdraft extractor to get hot.

Do not touch the casing or the grease filters until the downdraft extractor has cooled down.

- Do not use the downdraft extractor for resting objects on.

- Liquids can damage the downdraft extractor if they get into it. Keep liquids away from the downdraft extractor.

- Light objects can be drawn into the downdraft extractor and impair its operation.

Do not place any light objects (e.g. paper towels) within close proximity of the downdraft extractor.

- If you are operating a gas cooking element directly next to the downdraft extractor, the FlameGuard must be placed between the downdraft extractor and the element.

Warning and Safety instructions

Cleaning and care

► The steam from a steam cleaning appliance could reach live electrical components and cause a short circuit.

Do not use a steam cleaner to clean the downdraft extractor.

► There is a risk of fire if the cooker hood is not cleaned as described in these operating instructions.

Accessories

► Only use genuine original Miele accessories and spare parts with this appliance. Using accessories or spare parts from other manufacturers will invalidate the warranty and Miele cannot accept liability.

Disposal of the packing material

The packaging is designed to protect the appliance from damage during transportation. The packaging materials used are selected from materials which are environmentally friendly for disposal and should be recycled.

Recycling the packaging reduces the use of raw materials in the manufacturing process and also reduces the amount of waste in landfill sites.

Disposing of your old appliance

Electrical and electronic appliances often contain valuable materials. They also contain specific materials, compounds and components, which were essential for their correct function and safety. These could be hazardous to human health and to the environment if disposed of with your domestic waste or if handled incorrectly. Please do not, therefore, dispose of your old appliance with your household waste.



Please dispose of it at your local community waste collection / recycling centre for electrical and electronic appliances, or contact your dealer or Miele for advice. You are also responsible (by law, depending on country) for deleting any personal data that may be stored on the appliance being disposed of. Please ensure that your old appliance poses no risk to children while being stored prior to disposal.

Guide to the appliance

Downdraft extractor

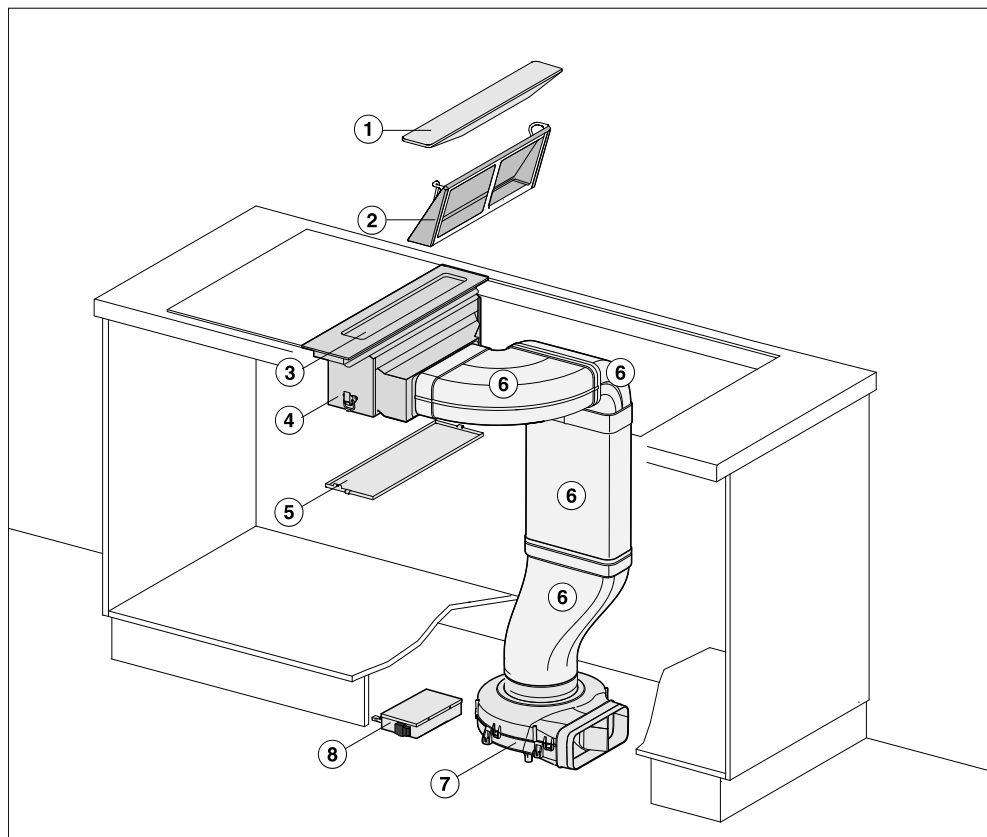

- ① FlameGuard
- ② Grease filter
- ③ Cover with control unit
- ④ Casing
- ⑤ Grease trap
- ⑥ Air duct
- ⑦ Fan
- ⑧ E-box

Controls / Indicators

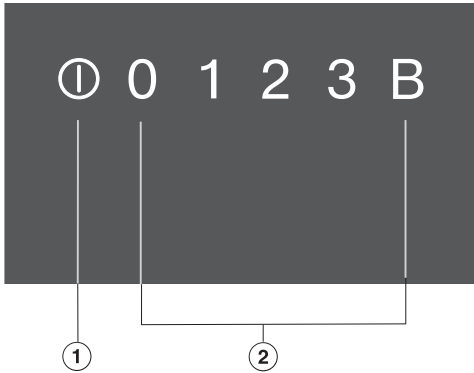

- ① Switching the downdraft extractor on/off
- ② Numerical keybank for setting the power level

Cleaning the SmartLine element for the first time

- Please stick the extra data plate for the appliance supplied with this documentation in the space provided in the “After sales service” section of this booklet.
- Remove any protective wrapping and stickers.
- Clean the ceramic surface with a damp cloth, and then wipe dry.

Depending on the model of the downdraft extractor, the following options are available:

Extraction mode

The air is drawn in and cleaned by the grease filter and directed outside.

Recirculation mode

(DUU 1000(-1) conversion kit required)

The air is drawn in and cleaned by the grease filter. The air is then directed into the recirculation box where it is also cleaned by the charcoal filters. The cleaned air is then recirculated back into the kitchen.

Tips on saving energy

This downdraft extractor operates very efficiently and economically. The following will help you to save even more energy when using it:

- It is important to ensure that the kitchen is well ventilated during operation. In extraction mode if there is insufficient air flow, the downdraft extractor cannot operate efficiently and this causes increased operating noise levels.
- Always cook with the lowest possible setting. This produces fewer cooking vapours, so you can use a lower power level and therefore benefit from reduced energy consumption.
- Check the selected power level on the downdraft extractor. A low power level is usually sufficient. Only use the Booster setting when necessary.
- When a large volume of cooking vapours are being produced, switch to a high power level in good time. This is more efficient than operating the downdraft extractor for longer to try to capture cooking vapours which have already been distributed throughout the kitchen.
- Switch the downdraft extractor off after cooking.
- Clean or replace the filters at regular intervals. Heavily soiled filters reduce performance, increase the risk of fire and are unhygienic.

FlameGuard

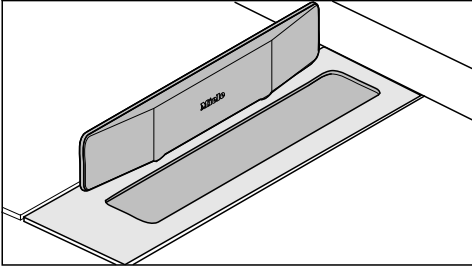

- Install the FlameGuard when you are operating a gas hob or a gas wok burner directly next to the downdraft extractor.

Switching the countertop extractor on

The countertop extractor must only be operated when the flame guard has been removed.

- Remove the FlameGuard.
- Activate the ① touchpad.

The sensor controls light up.

If no further entry is made, the countertop extractor will switch itself off after a few seconds.

Setting/changing the power level

For light to heavy cooking vapours and odours, select from power levels **1** to **3**. For short periods of cooking food with intensive vapours and a strong aroma, e.g. when searing meat, select Booster setting **B**.

- Touch the desired power level.

Booster

The maximum duration for the Booster is 10 minutes.

- To switch it off early, set a different power level.

Switching the downdraft extractor off

- Touch the ① sensor control.

The sensor controls go out.

If the downdraft extractor is not switched off, it will switch itself off 12 hours after the last automatic operation.

Run-on time

In order to rid kitchen air of steam and odours, the downdraft extractor continues to run for 5 minutes on the power level that was set last. The power level is gradually reduced during the run-on time. The current power level pulsates during the run-on time.

Cleaning and care



Danger of burning.

The downdraft extractor and the cooking elements must be switched off. The cooking elements need to have cooled down.



Risk of injury!

The steam from a steam cleaning appliance could reach live electrical components and cause a short circuit.

Do not use a steam cleaner to clean the downdraft extractor.

All surfaces could be discoloured or damaged if unsuitable cleaning agents are used.

All surfaces are susceptible to scratching.

Remove all cleaning agent residues immediately.

Allow the SmartLine element to cool down before cleaning.

- Clean the SmartLine element and accessories after each use.
- Dry the SmartLine element thoroughly after every cleaning to avoid limescale residue.

Unsuitable cleaning agents

To avoid damaging the surfaces of your appliance, do not use:

- washing-up liquid
- cleaning agents containing soda, alkalines, ammonia, acids or chlorides
- cleaning agents containing descaling agents
- stain and rust removers
- abrasive cleaning agents, e.g. powder cleaners and cream cleaners
- solvent-based cleaning agents
- dishwasher cleaner
- oven sprays
- glass cleaning agents
- hard, abrasive brushes or sponges, e.g., pot scourers, brushes or sponges which have been previously used with abrasive cleaning agents
- eraser blocks

Ceramic surface

Risk of damage from sharp and pointed objects!

Do not clean the area between the ceramic surface and the worktop with sharp, pointed objects.

Not all soiling and residues can be removed using a solution of washing-up liquid.

An invisible film can develop that can lead to discolouration of the ceramic glass. This discolouration cannot be removed.

Clean the ceramic surface regularly with a suitable ceramic cleaning agent such as the Miele ceramic and stainless steel hob cleaner.

- Remove any coarse soiling with a damp cloth and more stubborn soiling with a scraper blade suitable for use on glass.
- Then clean the ceramic surface with the Miele ceramic and stainless steel hob cleaner (see “Optional accessories”) or with a commercially available ceramic glass cleaner applied with kitchen paper or a clean cloth. Please follow the cleaning agent manufacturer's instructions.
- Then clean the ceramic surface with a damp cloth, and wipe dry. Ensure that all cleaning agent residues are removed.
- **Spots** caused by limescale and water residues can be removed using Miele's ceramic and stainless steel hob cleaner.

Drip tray

Clean the drip tray if liquids have boiled over or spilled into the downdraft extractor.

- Remove and clean the grease filter as described in the “Grease filter” section.

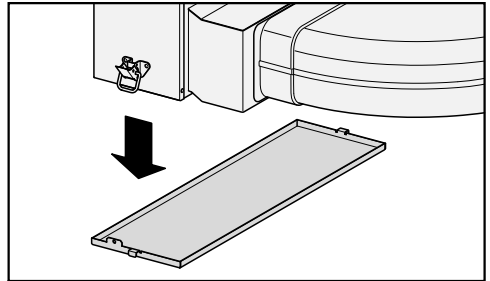

- Hold the drip tray and open the 2 clips (1x front, 1x rear). Carefully remove the tray from the casing, making sure it is kept horizontal.
- Pour out the liquid.
- Clean and dry the drip tray.
- Clean and dry the accessible inside of the downdraft extractor.
- Fasten the drip tray back onto the casing.
- Replace the grease filter and the cover on top.

Cleaning and care

Grease filter

The reusable metal grease filter removes solid particles from kitchen vapours (grease, dust, etc.) and therefore prevents soiling of the downdraft extractor. Accumulated grease solidifies over a longer period of time and makes cleaning more difficult. The grease filter should therefore be cleaned at least every 3 to 4 weeks.

An oversaturated filter is a fire hazard.

Clean the grease filter regularly.

Removing the grease filter

- Remove the FlameGuard.
- Carefully remove the grease filter. Ensure that you do not tilt the grease filter.
- Pour out any liquid which has collected at the bottom of the grease filter.

Cleaning the grease filter by hand

- Clean the grease filter with a soft nylon brush in a mild solution of hot water and a little washing-up liquid. Do not use concentrated washing-up liquid.

Cleaning the grease filter in the dishwasher

- Place the grease filter with its base facing upwards in the lower basket. Ensure the spray arm is not obstructed.
- Use a commercially available household dishwasher detergent.

- Select a dishwasher programme with a wash temperature between 50 °C and 65 °C.

Depending on the detergent used, cleaning the grease filter in a dishwasher can cause permanent discolouration to the internal surfaces of the filter. However, this will not affect the functioning of the grease filter in any way.

Fitting the grease filter

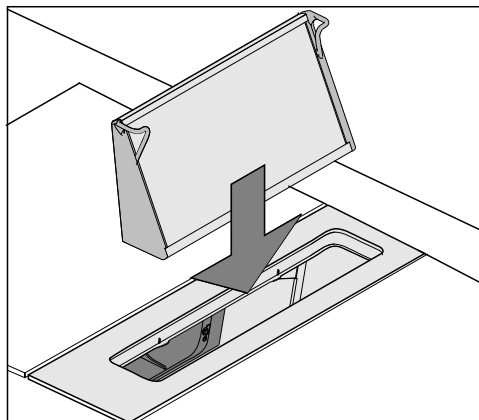

- Fit the grease filter so that the open side of the grease filter is on the open side of the casing.

Interior of the casing

- When removing the grease filter for cleaning, also clean off any accessible oil or fat build-up from the casing. Doing so will prevent a fire hazard.

Problem solving guide

Many malfunctions and faults that can occur in daily operation can be easily remedied. Time and money will be saved because a service call will not be needed.

The following guide may help you to find the reason for a malfunction or a fault, and to correct it.

Problem	Cause and remedy
The SmartLine element cannot be switched on.	There is no power to the SmartLine element. ■ Check whether the mains fuse has tripped. Contact an electrician or Miele Service (for the minimum fuse rating, see data plate).
	There may be a technical fault. ■ Disconnect the appliance from the mains electricity supply for approx. 1 minute by – tripping the relevant mains fuse or screwing the fuse out completely, or – switching off the residual current protection device. ■ If, after resetting the trip switch in the mains fuse box or the residual current protection device, the appliance will still not turn on, contact a qualified electrician or Miele Service.
The power levels 1 to B light up one after the other.	An automatic reset is performed after an interruption to the power supply.

Optional accessories

Miele offer a comprehensive range of useful accessories as well as cleaning and conditioning products for your Miele appliances.

These products can be ordered through the Miele Webshop.

They can also be ordered from Miele (see end of this booklet for contact details) or from your Miele dealer.

FlameGuard

For installing between the downdraft extractor and a gas SmartLine element

Ceramic and stainless steel hob cleaner 250 ml



Removes heavy soiling, limescale deposits and aluminium residues

Microfibre cloth

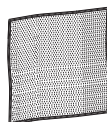

Removes finger marks and light soiling

Safety instructions for installation

Fit the wall units before fitting the SmartLine element to avoid damaging it.

- ▶ After installation, the mains connection cable of the SmartLine element must not come into contact with any moving kitchen component (e.g. a drawer) or be subject to mechanical loads which could damage it.
- ▶ Combination with gas appliances
Only Miele CS 7xxx gas appliances may be installed next to the downdraft extractor.
- ▶ Observe carefully the safety clearances listed on the following pages.
- ▶ Exhaust ducting must be of non-inflammable material. Suitable material is available from Miele specialist dealers or the Miele Spares Dept.
- ▶ The appliance must not be connected to a chimney or flue which is in use. Neither should it be connected to ducting which ventilates rooms with fireplaces.
- ▶ If exhaust air is to be extracted into a chimney or ventilation duct no longer used for other purposes, seek professional advice.

Installation notes

All dimensions are given in mm.

Onset installation

Sealing between the SmartLine Element and the worktop

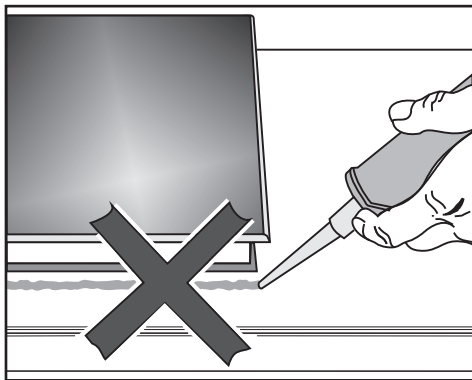

The SmartLine element and worktop may be damaged if the element needs to be removed after it has been sealed with a sealant.

Do not use any sealant between the SmartLine element and the worktop. The seal under the edge of the top part of the appliance provides a sufficient seal for the worktop.

Tiled worktop

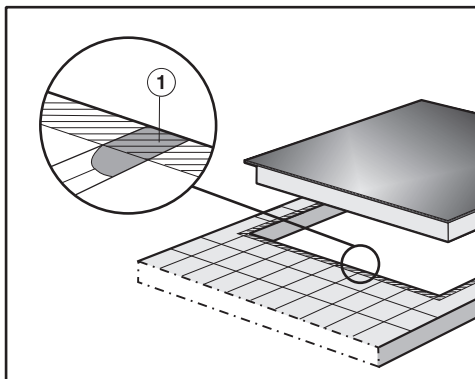

Grout lines ① and the hatched area underneath the SmartLine element frame must be smooth and even. If they are not, the SmartLine element will not sit flush with the worktop and the sealing strip underneath the top part of the appliance will not provide a good seal between the appliance and the worktop.

Flush-fit installation

Flush-fit installation is only possible in natural stone (granite, marble), solid wood and tiled worktops. For installation in worktops made of other materials, please consult the relevant manufacturer as to whether their worktops are suitable for flush-fit installation.

The internal width of the base unit underneath the appliance must be at least as wide as the inner worktop cut-out (see “Cut-out dimensions for flush-fit installation”), so that the SmartLine element is easily accessible from underneath after installation and the bottom half of the casing can be removed for maintenance. If the element is not freely accessible from below after installation, the sealant must be removed so that the element can be removed.

The SmartLine element is

- directly installed in a suitable cut-out in a natural stone worktop,
- secured in a suitable cut-out in solid wood and tiled worktops with a wooden support frame. The frame must be provided on site, and is not supplied with the appliance.

Installation notes

Installing several SmartLine elements

The gaps between the individual SmartLine elements are sealed with a silicone sealant that is heat-resistant to at least 160 °C. With flush-fit installation, the gap between the SmartLine element(s) and the worktop must also be sealed with a silicone sealant that is heat-resistant to at least 160 °C.

After installation, the SmartLine elements must be easily accessible from below, so that the bottom half of the casing can be removed for maintenance. If the SmartLine elements are not accessible from below, the sealant must be removed so that they can be removed.

Minimum plinth height

The downdraft extractor fan is installed in the plinth below the cabinet floor. The minimum plinth height must be 100 mm.

Worktop depth

The downdraft extractor can be installed with the connector for the air duct on either the right or the left side.

Minimum worktop depth for

- right connector 600 mm
- left connector 665 mm

Housing unit back panel

The extraction ducting is laid behind the housing unit back panel. The back panel must be removable for maintenance purposes.

Grease trap

The downdraft extractor must be installed in such a way that the grease trap is freely accessible and can be removed for cleaning.

Installation examples

Recirculation mode

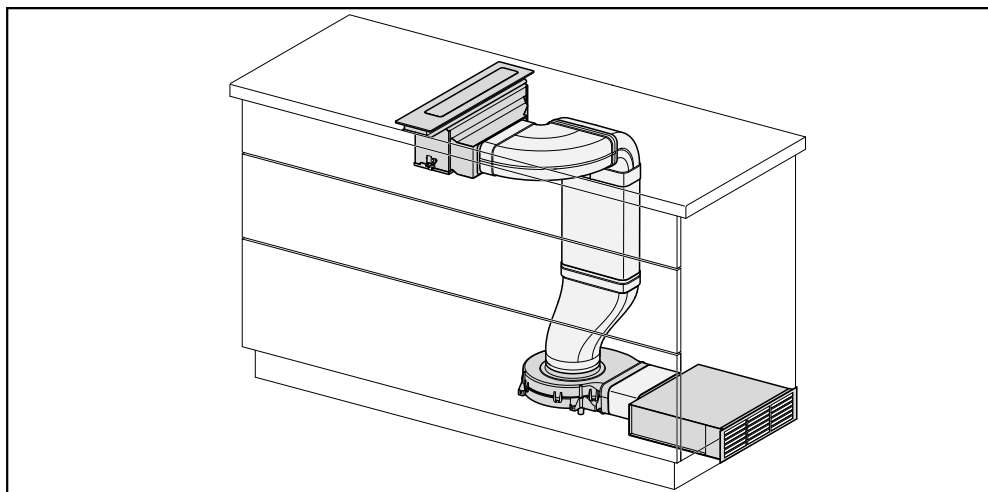

Extraction mode

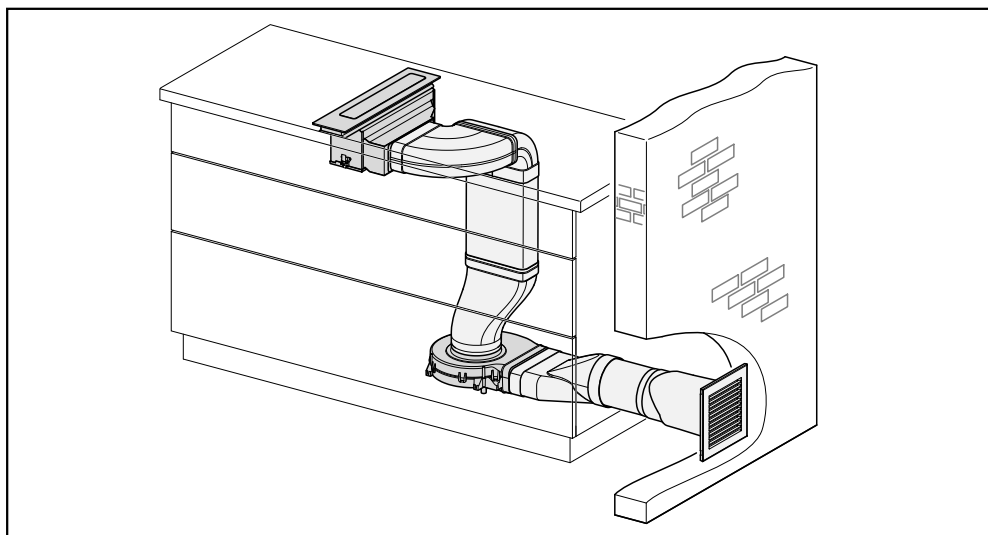

Building-in dimensions

Onset installation

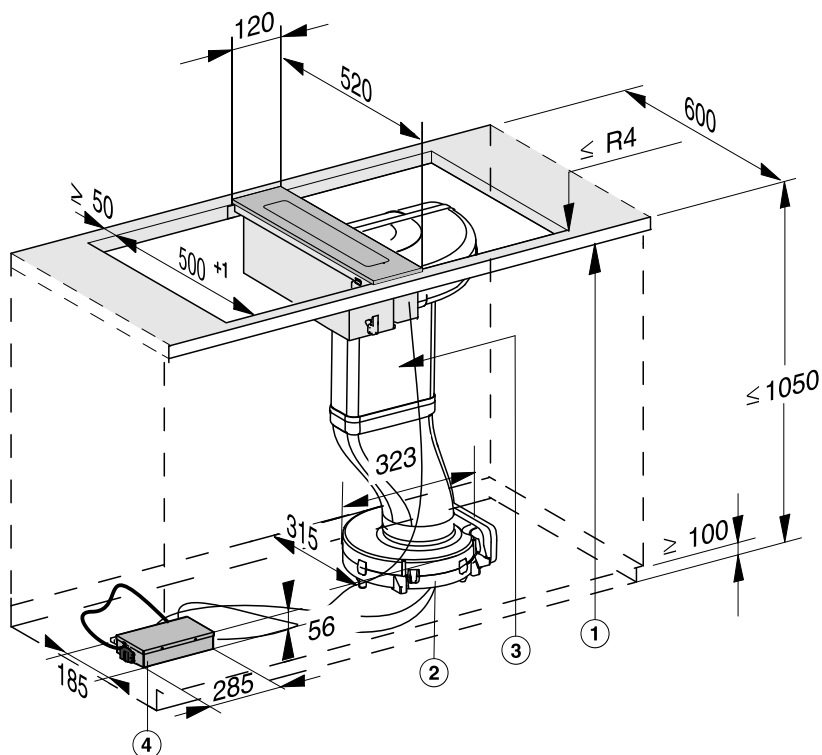

- ① Front
- ② Fan (in the plinth on the floor)
- ③ Air duct
- ④ E-box

Flush-fit installation

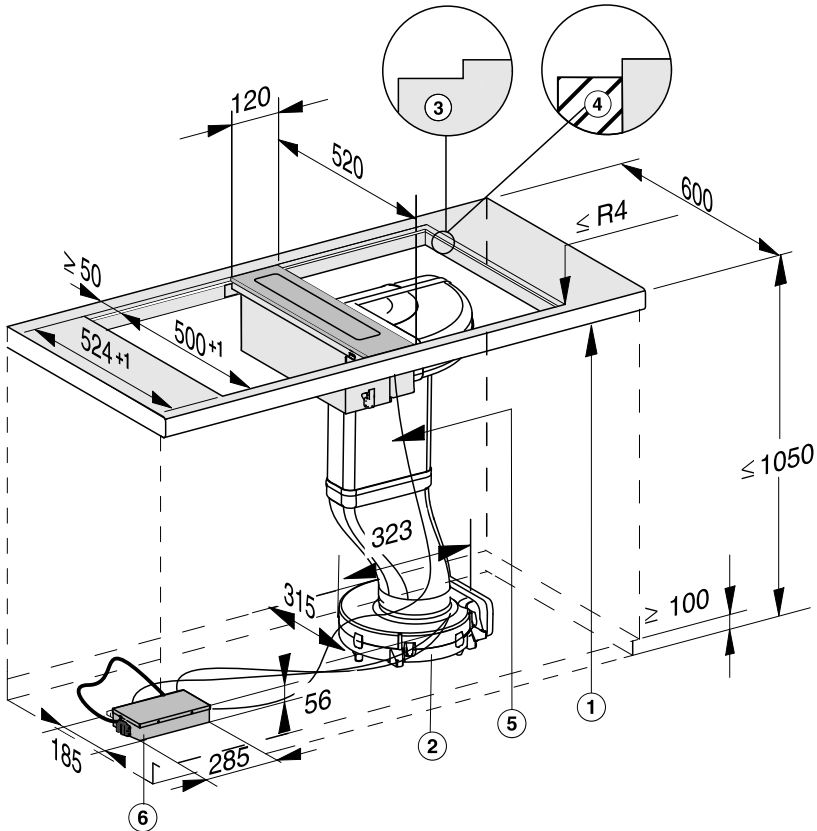

- ① Front
- ② Fan (in the plinth on the floor)
- ③ Stepped cut-out (for detailed illustrations, see "Worktop cut-out for flush-fit installation")
- ④ 12 mm wooden frame (not supplied, for detailed illustrations, see "Worktop cut-out for flush-fit installation")
- ⑤ Air duct
- ⑥ E-box

Worktop cut-out for onset installation

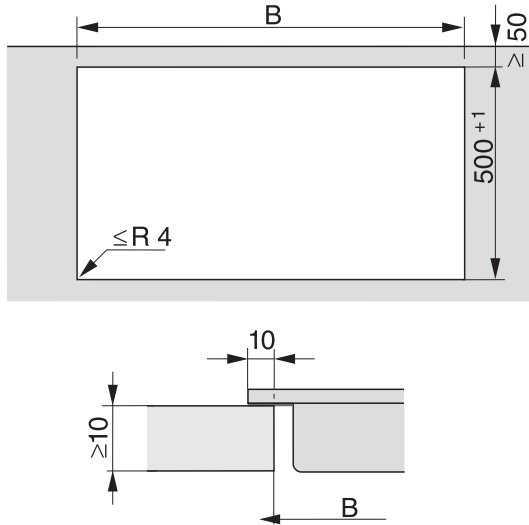

Information for calculating the cut-out

The elements overlap the worktop by 10 mm.

When installing several elements, a distance of 2 mm must be observed between the individual elements.

Calculating cut-out dimension **B**







1 element = width of the element minus 10 mm on the right, minus 10 mm on the left

Several elements = total width of the elements plus 2 mm distance between the elements, minus 10 mm on the right, minus 10 mm on the left.

Some examples are illustrated below.

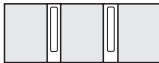





Worktop cut-out for onset installation

Installation with a downdraft extractor

Sample combinations	Number x width [mm]		Dimension B [mm]
	Cooking elements	Downdraft extractor	
	1 x 378	1 x 120	480 ⁺¹
	2 x 378	1 x 120	860 ⁺¹
	1 x 378 1 x 620	2 x 120	1224 ⁺¹
	3 x 378	2 x 120	1362 ⁺¹
	2 x 378 1 x 620	2 x 120	1604 ⁺¹
	4 x 378	2 x 120	1742 ⁺¹
	1 x 620	2 x 120	844 ⁺¹

Worktop cut-out for onset installation

Installation without a downdraft extractor

Sample combinations	Number x width [mm] Cooking elements	Dimension B [mm]
	1 x 378	358 ⁺¹
	2 x 378	738 ⁺¹
	1 x 378 1 x 620	980 ⁺¹
	3 x 378	1118 ⁺¹
	2 x 378 1 x 620	1360 ⁺¹
	4 x 378	1498 ⁺¹

Surface-mounted installation

If the worktop is more than 24 mm deep, it must be cut-away on the underside on the right or left hand side.

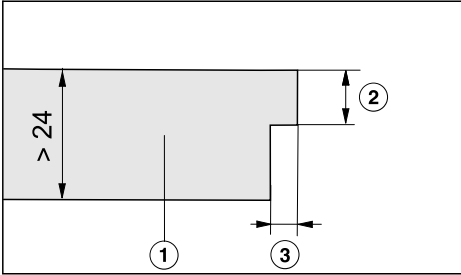

- ① Worktop
- ② Max. 24 mm
- ③ 12 mm

Securing the bracket

1 bracket (supplied with the spacer bar) must be secured centrally to the right or left hand side of the cut-out.

Wooden worktops

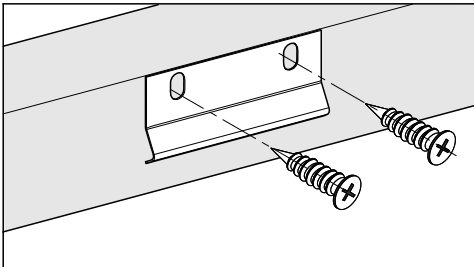

- Fit the bracket so that it sits flush with the top edge of the worktop cut-out.
- Secure the bracket with the 3.5 x 25 mm wood screws supplied.

Natural stone worktops

You will need heavy-duty double-side tape (not supplied) to secure the bracket.

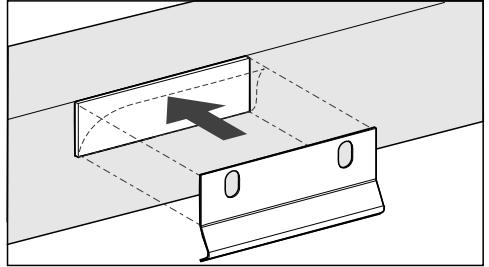

- Stick the tape along the top edge of the worktop cut-out.
- Fit the bracket so that it sits flush with the top edge of the worktop cut-out.
- Press the bracket firmly into position.

Worktop cut-out for flush-fit installation

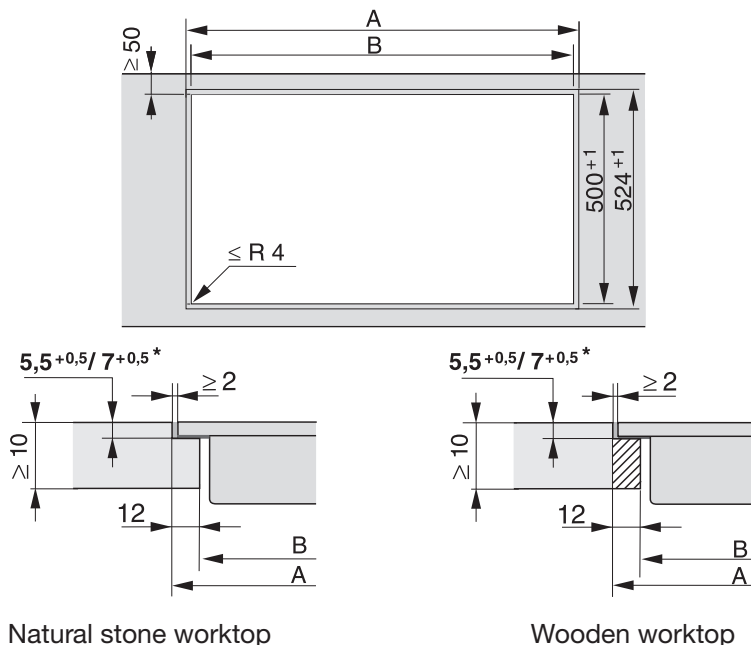

* $7^{+0,5}$ mm for CS 7611

Information for calculating the cut-out

The elements overlap the worktop by 10 mm.

When installing several elements, a distance of 2 mm must be observed between the individual elements.

Calculating cut-out dimension **A**

1 element = width of the element plus 2 mm on the right, plus 2 mm on the left.







Several elements = total width of the elements plus 2 mm distance between the elements, plus 2 mm on the right, plus 2 mm on the left

Calculating cut-out dimension **B** = cut-out dimension A minus 12 mm on the right, minus 12 mm on the left.

Some examples are illustrated below.

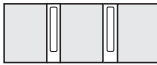





Worktop cut-out for flush-fit installation

Installation with a downdraft extractor

Sample combinations	Number x width [mm]		Dimension A [mm]	Dimension B [mm]
	Cooking elements	Downdraft extractor		
	1 x 378	1 x 120	504 ⁺¹	480 ⁺¹
	2 x 378	1 x 120	884 ⁺¹	860 ⁺¹
	1 x 378 1 x 620	2 x 120	1248 ⁺¹	1224 ⁺¹
	3 x 378	2 x 120	1386 ⁺¹	1362 ⁺¹
	2 x 378 1 x 620	2 x 120	1628 ⁺¹	1604 ⁺¹
	4 x 378	2 x 120	1766 ⁺¹	1742 ⁺¹
	1 x 620	2 x 120	868 ⁺¹	844 ⁺¹

Worktop cut-out for flush-fit installation

Installation without a downdraft extractor

Sample combinations	Number x width [mm] Cooking elements	Dimension A [mm]	Dimension B [mm]
	1 x 378	382^{+1}	358^{+1}
	2 x 378	762^{+1}	738^{+1}
	1 x 378 1 x 620	1004^{+1}	980^{+1}
	3 x 378	1142^{+1}	1118^{+1}
	2 x 378 1 x 620	1384^{+1}	1360^{+1}
	4 x 378	1522^{+1}	1498^{+1}

Flush-mounted installation

If the worktop is more than 28 mm deep, it must be cut-away on the underside on the right or left hand side.

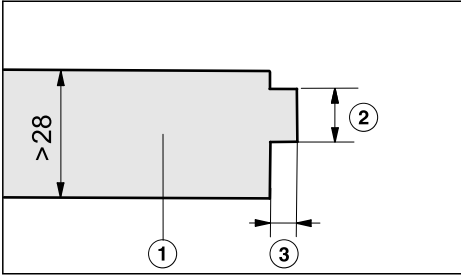

- ① Worktop
- ② Max. 24 mm
- ③ 12 mm

Securing the bracket

1 bracket (supplied with the spacer bar) must be secured centrally to the right or left hand side of the cut-out.

Wooden worktops

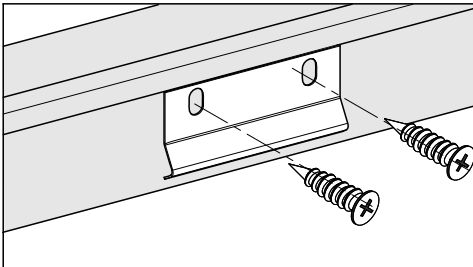

- Fit the bracket so that it sits flush with the top edge of the lower step of the stepped cut-out.
- Secure the bracket with the 3.5 x 25 mm wood screws supplied.

Natural stone worktops

You will need heavy-duty double-side tape (not supplied) to secure the bracket.

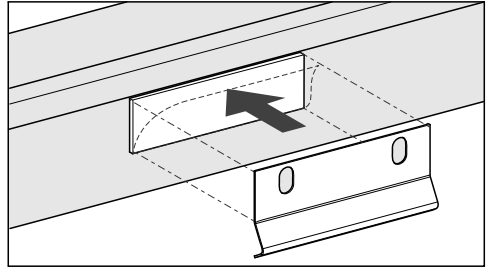

- Stick the tape onto the upper edge of the lower step of the stepped cut-out.
- Fit the bracket so that it sits flush with the top edge of the lower step of the stepped cut-out.
- Press the bracket firmly into position.

Spacer bars

When installing several SmartLine elements, an additional spacer bar must be fitted in between the individual elements.

The clips supplied with the spacer bars are only required for installing the CSDA.

Installing 3 elements and 2 spacer bars

Onset installation

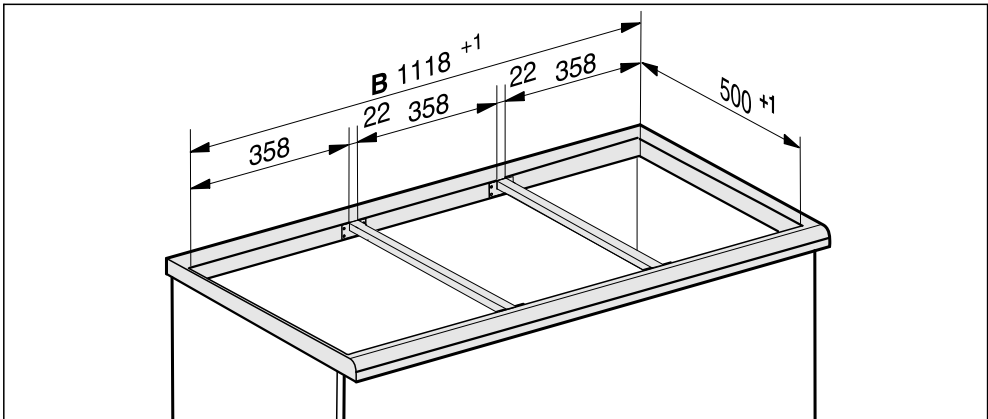

Flush-fit installation

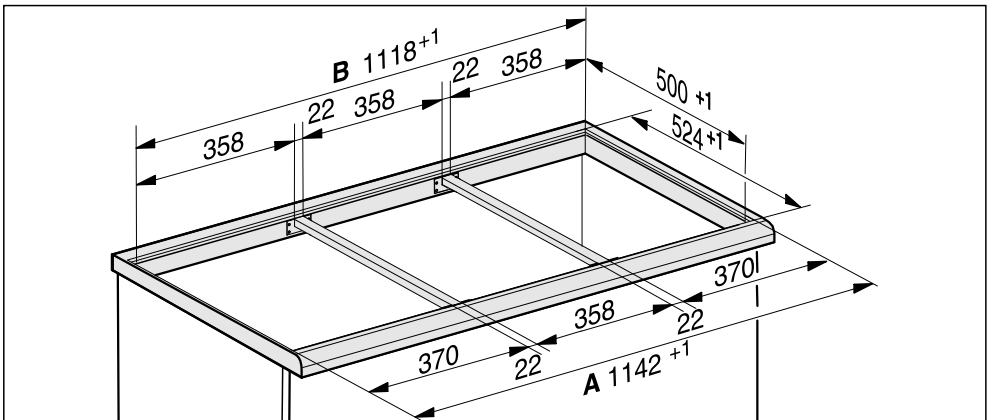

Spacer bars for the downdraft extractor

Onset installation

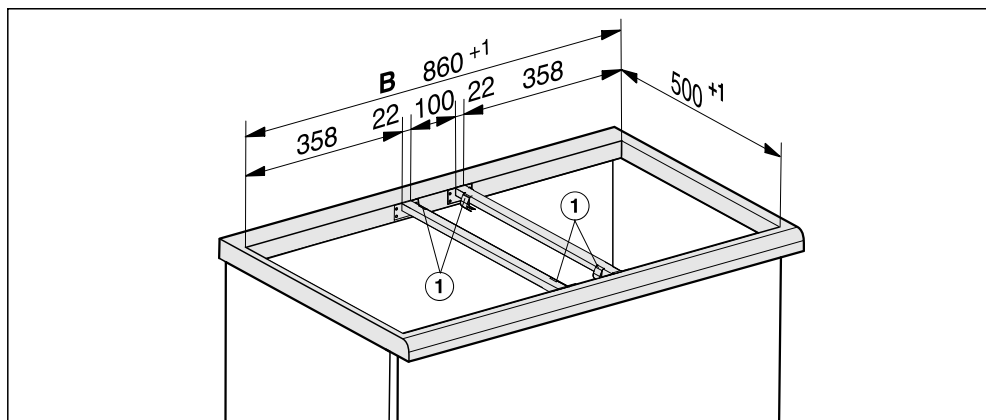

① Clips

Flush-fit installation

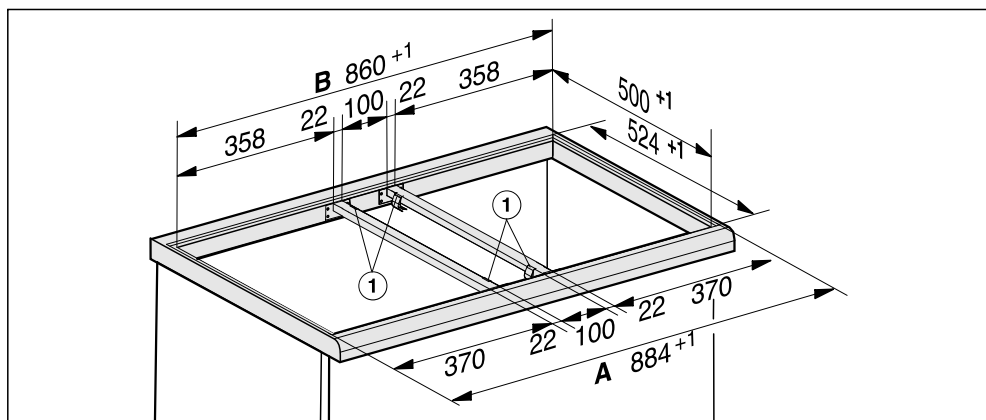

① Clips

Installation

Preparing the worktop

- Create the worktop cut-out. Remember to maintain the minimum safety distances (see “Safety distances”).
- Seal any cut surfaces on **wooden worktops** with a special varnish, silicone rubber or resin to prevent the wood from swelling as a result of moisture. The sealant must be temperature-resistant.

Make sure that the sealant does not come into contact with the top of the worktop.

Flush-fit installation

- For wooden worktops, secure the wooden frames 5.5 mm below the upper edge of the worktop.
For CS 7611, the wooden frame must be secured 7 mm under the upper edge of the worktop.

Fitting the spacer bars

Use the middle screw holes if one of the following SmartLine elements is installed to the right or left of the spacer bar: CS 7611, CS 7101, CS 7102

Wooden worktops

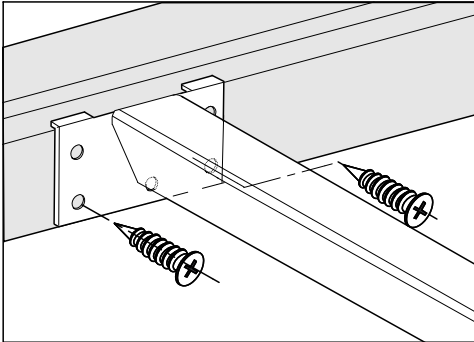
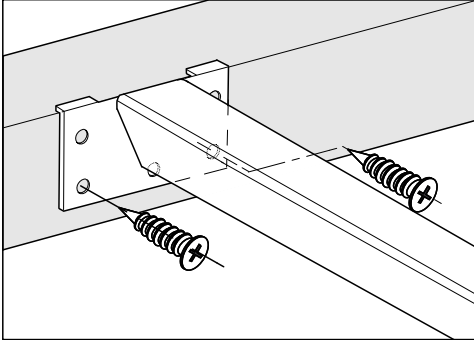

- Position the spacer bars flush onto the upper edge of the cut-out or onto the lower step of the stepped cut-out.
- Secure the spacer bars with the 3.5 x 25 mm wood screws supplied.

Natural stone worktops

You will need heavy-duty double-side tape (not supplied) to secure the spacer bars.

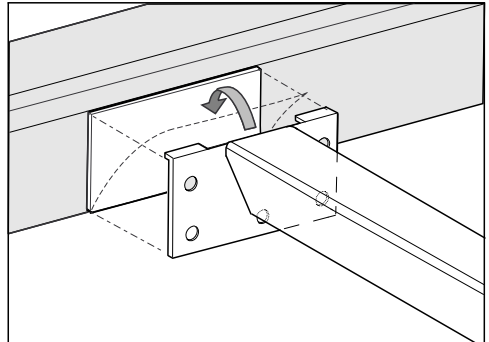
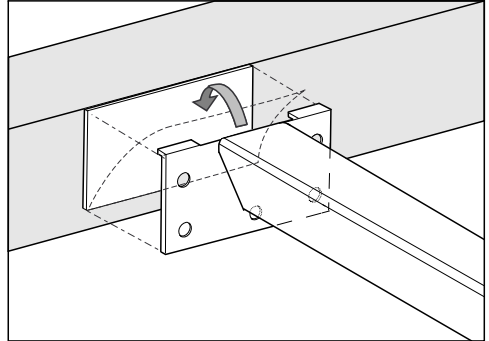

- Stick the tape onto the upper edge of the cut-out or onto the lower step of the stepped cut-out.
- Position the spacer bars flush onto the upper edge of the cut-out or onto the lower step of the stepped cut-out.
- Press the spacer bars firmly into place.

Installation

Installing the countertop extractor

The countertop extractor can be installed with the connector for the air duct on either the right or the left side.

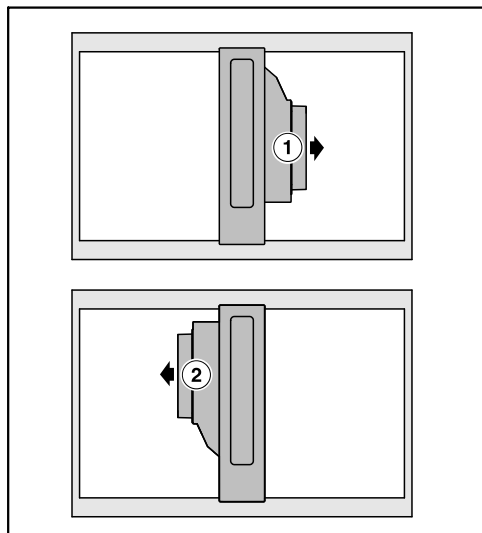

① Connector for air duct on the right

② Connector for air duct on the left

- Stick the supplied sealing strip under the edge of the cover. Do not apply the sealing strip under tension.
- Fit the clips onto the spacer bars.
- Guide the control cable downwards between the spacer bars.
- Fit the cover onto the spacer bars.

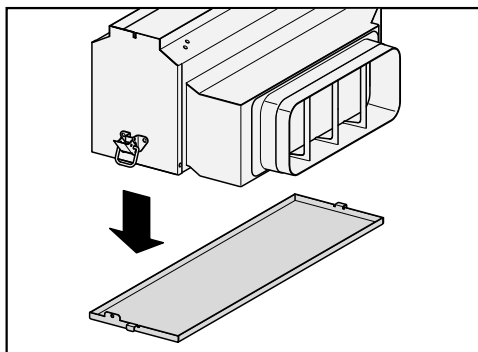

- Remove the grease trap from the casing.

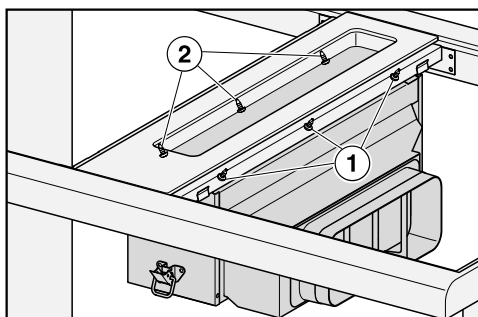

- Fasten the casing from the inside with the screws ① on the right and left ② sides (3 in each case).
- Fasten the grease trap.
- Mount the air duct.

Ensure that the air duct is not under mechanical tension after installation!

E-box

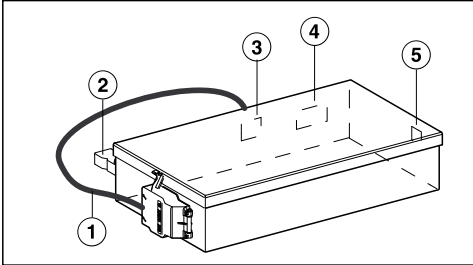

- ① Mains connection cable
- ② Connection to window contact
- ③ Connection socket for the fan operating voltage cable
- ④ Connection socket for the fan control cable
- ⑤ Connection socket for the control unit cable

Connection to window contact, if required

 The window contact connection is live!

Danger of electric shock!

Disconnect the countertop extractor from the mains before connecting the switching system.

The connection cable of the switching system must only be connected by a suitably qualified and competent person.

The connection cable of the switching system must comply with type H03VV-F 2 x 0.75 mm² and must not exceed 2.0 m in length.

The switching system must be equipped with a potential-free contact suitable for 230 V, 1 A. The extractor is switched off when the switch is open.

Only use DIPT-approved and tested radio switching systems (e.g. window contact switches, pressure switches) and have them approved by authorised specialists (e.g. building regulations inspector).

The switching system must be suitable for use with a BLDC motor.

You will need the appropriate external switching system documents to safely connect and operate the switch.

Installation

- Loosen the lug and pull the plug out.

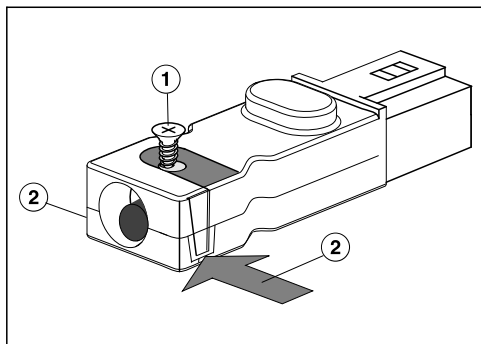

- Loosen the strain relief screw ① and unlock the casing on both sides ②.
- Open the casing.
- Remove the stopper.

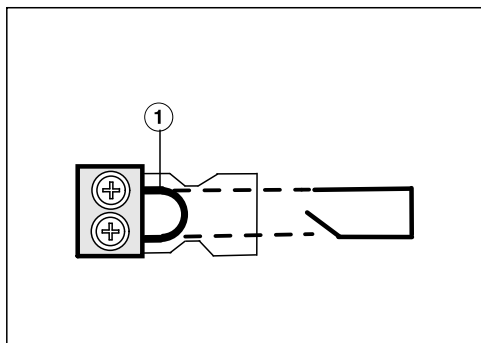

- Exchange the jumper ① with the connection cable of the switching system.
- Close the casing.
- Tighten the strain relief screw.
- Reinsert the plug.

Connecting the e-box

- Connect the operating voltage and fan control cables to the e-box and the fan.
- Connect the control unit cable to the e-box.

The socket positions are designed in such a way that they cannot be mixed up.

- Connect the downdraft extractor to the mains.
- Check that the downdraft extractor works.

Sealing the gaps

- Seal the gaps between the individual SmartLine elements, and between the flush-mounted SmartLine elements and the worktop, with a silicone sealant that is heat-resistant to at least 160 °C.

Unsuitable sealant can damage natural stone.

For natural stone worktops and natural stone tiles, only use silicone sealant that is specially formulated for natural stone.

Please follow the manufacturer's instructions.

Connection for air extraction

! If the downdraft extractor is used at the same time as a heating appliance that relies on oxygen from the same room, there is a risk of toxic fumes.

It is essential that the “Warning and Safety” instructions are observed.

The downdraft extractor should be installed according to local and national building regulations. Seek approval from the building inspector where necessary.

The downdraft extractor has an exhaust connection of 222 x 89 mm.

- Use smooth pipes or flexible ducting made from non-flammable materials for vent ducting.
- To achieve the most efficient air extraction with the lowest noise levels, please note the following:
 - The cross-section of the vent ducting must not be smaller than the cross-section of the exhaust connection (see “Appliance dimensions”).
 - The vent ducting should be as short and straight as possible.
 - Only use wide radius bends.
 - The vent ducting must not be kinked or compressed.
 - Ensure that all connections are strong and airtight.

Remember that any constriction of the air flow will reduce extraction performance and increase operating noise.

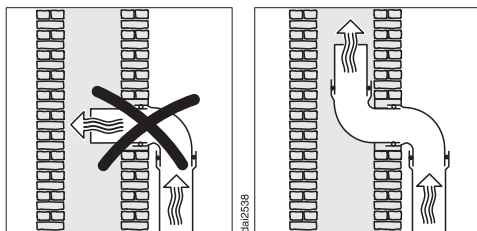

- If the exhaust air is to be ducted into a flue, the ducting must be directed in the flow direction of the flue.
- If ducting is to be laid horizontally it must be laid with a downwards sloping gradient. This is to ensure that condensate cannot drain back into the extractor.
- If the vent ducting is to run through rooms, ceiling space, etc. there may be great variations in temperature between the different areas. The problem of condensation will need to be addressed. The vent ducting will need to be suitably insulated.

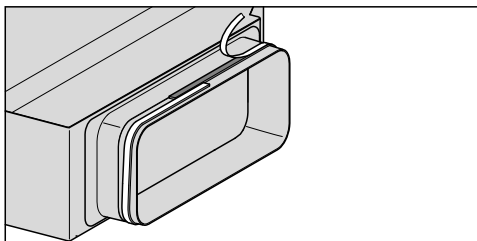

- Stick the supplied sealing strip on the exhaust connection if the ducting does not sit securely up against the exhaust connection.

We recommend that you connect the SmartLine element to the mains via a suitable switched electric socket. This simplifies servicing. The socket must be easily accessible after the SmartLine element has been installed.



Danger of injury!

Installation, repairs and other work by unqualified persons could be dangerous. Miele cannot be held liable for unauthorised work.

Miele cannot be held liable for damage or injury caused by the lack of or inadequacy of an on-site earthing system (e.g. electric shock).

If the plug is removed from the connection cable or if the cable is supplied without a plug, the SmartLine element must be connected to the electrical supply by a suitably qualified electrician.

If the socket is no longer accessible, or if a hard-wired connection is planned, an additional means of disconnection must be provided for all poles. Suitable means of disconnection include switches with an all-pole contact gap of at least 3 mm. These include miniature circuit breakers, fuses and relays. The connection data is quoted on the data plate. Please ensure these match the household mains supply.

After installation ensure that all electrical components are shielded and cannot be accessed by users.

Total power rating

See data plate

Connection data

The connection data is quoted on the data plate. Please ensure these match the household mains supply.

Residual current device

For extra safety, it is advisable to protect the SmartLine element with a suitable residual current device (RCD) with a trip range of 30 mA.

WARNING!

**THIS APPLIANCE MUST BE
EARTHED**

Electrical connection

Disconnecting from the mains

 **Danger of electric shock.**
After disconnection, ensure the appliance cannot be switched back on by mistake.

To disconnect the appliance from the mains power supply, do one of the following depending on installation:

Safety fuses

- Completely remove fuses

Automatic circuit breakers

- Press the (red) button until the middle (black) button springs out.

Built-in circuit breakers

- Circuit breakers, type B or C: switch the on-off switch from 1 (on) to 0 (off).

Residual current device (RCD)

- Switch the main switch from 1 (on) to 0 (off) or press the test button.

Replacing the mains connection cable

 **Danger of electric shock!**
The mains connection cable must only be fitted by a suitably qualified electrician.

When replacing the mains connection cable, please use cable type H 05 VV-F with a suitable cross-section. These cables are available from the manufacturer or from the Miele Spare Parts Department.

Contact in case of malfunction

In the event of any faults which you cannot remedy yourself, please contact your Miele Dealer or Miele Service.

Contact information for Miele Service can be found at the end of this document.

Please note that telephone calls may be monitored and recorded for training purposes and that a call-out charge will be applied to service visits where the problem could have been resolved as described in this booklet.

Please quote the model and serial number of your appliance when contacting Miele. This information can be found on the data plate.

Data plate

Stick the extra data plate supplied with the appliance here. Make sure that the model number matches the one specified on the back cover of this document.



Warranty

The appliance warranty is valid for 2 years from date of purchase. In the UK, you must activate your cover by calling 0330 160 6640 or registering online at www.miele.co.uk.

For further information on country specific warranty terms and conditions, please refer to your warranty booklet or contact Miele Customer Service.

Product data sheets

The following data sheets apply to the models described in this operating instruction manual.

Data sheet for household cooker hoods

In acc. with delegated regulation (EU) No. 65/2014 and regulation (EU) No. 66/2014

MIELE	
Model name / identifier	CSDA 7000
Annual Energy Consumption (AEC_{hood})	29,3 kWh/year
Energy efficiency class	A+
Energy efficiency index (EEl_{hood})	42,7
Fluid Dynamic Efficiency (FDE_{hood})	32,5
Fluid Dynamic Efficiency class	
A (most efficient) to G (least efficient)	A
Lighting Efficiency (LE_{hood})	lx/W
Lighting Efficiency class	
A (most efficient) to G (least efficient)	-
Grease Filtering Efficiency	91,4%
Grease Filtering Efficiency class	
A (most efficient) to G (least efficient)	B
Airflow at best efficiency point	296,1 m ³ /h
Air flow (min. speed)	150 m ³ /h
Air flow (max. speed)	440 m ³ /h
Air flow (intensive or boost setting)	535 m ³ /h
Max. air flow (Q_{max})	535 m ³ /h
Air pressure at best efficiency point	384 Pa
Airborne acoustical A-weighted sound power emissions (min. speed)	44 dB
Airborne acoustical A-weighted sound power emissions (max. speed)	66 dB
Airborne acoustical A-weighted sound power emissions (intensive or boost setting)	70 dB
Electrical power input at best efficiency point	97,0 W
Power consumption in off mode (P_o)	W
Power consumption in standby mode (P_s)	0,30 W
Nominal power of lighting system	0,0 W
Average illumination of the lighting system on the cooking surface	0 lx
Time increase factor	0,8

United Kingdom

Miele Co. Ltd.
Fairacres, Marcham Road
Abingdon, Oxon, OX14 1TW
Customer Contact Centre Tel: 0330 160 6600
E-mail: mielecare@miele.co.uk
Internet: www.miele.co.uk

Australia

Miele Australia Pty. Ltd.
ACN 005 635 398
ABN 96 005 635 398
1 Gilbert Park Drive
Knoxfield, VIC 3180
Tel: 1300 464 353
Internet: www.miele.com.au

China

Miele (Shanghai) Trading Ltd.
1-3 Floor, No. 82 Shi Men Yi Road
Jing' an District
200040 Shanghai, PRC
Tel: +86 21 6157 3500
Fax: +86 21 6157 3511
E-mail: info@miele.cn
Internet: www.miele.cn

Miele (Hong Kong) Limited

41/F - 4101, Manhattan Place
23 Wang Tai Road
Kowloon Bay, Hong Kong
Tel: (852) 2610 1025
Fax: (852) 3579 1404
Email:
customerservices@miele.com.hk
Website: www.miele.hk

India

Miele India Pvt. Ltd.
Ground Floor
Copia Corporate Suites
Plot No. 9, Jasola
New Delhi - 110025
Tel: 011-46 900 000
Fax: 011-46 900 001
E-mail: customercare@miele.in
Internet: www.miele.in

Manufacturer: Miele & Cie. KG, Carl-Miele-Straße 29, 33332 Gütersloh, Germany

Miele

Ireland

Miele Ireland Ltd.
2024 Bianconi Avenue
Citywest Business Campus
Dublin 24
Tel: (01) 461 07 10
Fax: (01) 461 07 97
E-Mail: info@miele.ie
Internet: www.miele.ie

Malaysia

Miele Sdn Bhd
Suite 12-2, Level 12
Menara Sapura Kencana
Petroleum
Solaris Dutamas No. 1
Jalan Dutamas 1
50480 Kuala Lumpur, Malaysia
Phone: +603-6209-0288
Fax: +603-6205-3768

New Zealand

Miele New Zealand Limited
IRD 98 463 631
Level 2, 10 College Hill
Freemans Bay, Auckland 1011
New Zealand
Tel: 0800 464 353
Internet: www.miele.co.nz

Singapore

Miele Pte. Ltd.
163 Penang Road
04 - 03 Winsland House II
Singapore 238463
Tel: +65 6735 1191
Fax: +65 6735 1161
E-Mail: info@miele.com.sg
Internet: www.miele.sg

South Africa

Miele (Pty) Ltd
63 Peter Place, Bryanston 2194
P.O. Box 69434, Bryanston 2021
Tel: (011) 875 9000
Fax: (011) 875 9035
E-mail: info@miele.co.za
Internet: www.miele.co.za

Taiwan

K.E. & Kingstone Co., Ltd.
6th Fl., No. 120, Sec. 2
Jianguo N. Rd.
Taipei, Taiwan
TEL: +886 2 2502-7256
FAX: +886 2 2502-3077
E-mail: kenk@kenk.com.tw
Website:
www.kenk.com.tw/ke/miele

Thailand

BHIRAJ TOWER at EmQuartier
43rd Floor Unit 4301-4303
689 Sukhumvit Road
North Klongton Sub-District
Vadhana District
Bangkok 10110, Thailand

United Arab Emirates

Miele Appliances Ltd.
Gold & Diamond Park
Office No. 6-217
Sheikh Zayed Road
P.O. Box 11 47 82 - Dubai
Tel. +971 4 3044 999
Fax. +971 4 3418 852
800-MIELE (64353)
E-Mail: info@miele.ae
Website: www.miele.ae

CSDA 7000 FL

en-GB

M.-Nr. 10 746 530 / 03