

BSH Home Appliances Group

B/S/H/

Step by step guide to connecting your HomeConnect appliance and how to add Alexa

December 2018

What this document will help you do...

- 1. Install Oven and Connect to HomeConnect**
 - a. WPS Button Set Up**
 - b. Manual Set Up**
- 2. Unbox Alexa and set it up**
- 3. Connect the Oven to Alexa**
- 4. Use Alexa with voice commands**

What type of network do you have?



HomeConnect is designed to work on a home network so if you have this use this guide to set up which is how a consumer would set up.

All set up videos are on YouTube:

[For Bosch](#)
[For Siemens](#)

If you have a corporate or more complicated network you are likely to have a few problems.

There is an [Advanced Configuration Pack](#) on The Hub. Download this and give the pack to the dealer's IT person and it should resolve these problems.

1 Install Oven and Connect to HomeConnect

WPS Set Up

1. Download HomeConnect App
2. Switch on Oven
 - Find HomeConnect Setting and check Wi-Fi is on
 - Find HomeConnect Assistant, click Connect Manually
3. HC App
 1. Go to Settings on iPad
 2. Select Wi-Fi
 3. Now follow instructions on front of oven
4. In HC App
 - Put in dealers network info
 - Check back in setting that is it connected to dealers network
5. On oven press Connect to App
6. [YouTube](#) Video



Step One: Download the HomeConnect App

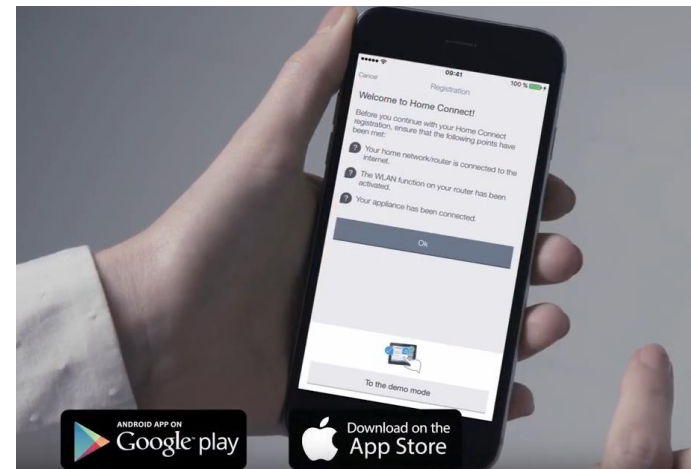

Step Two: Create a HomeConnect account

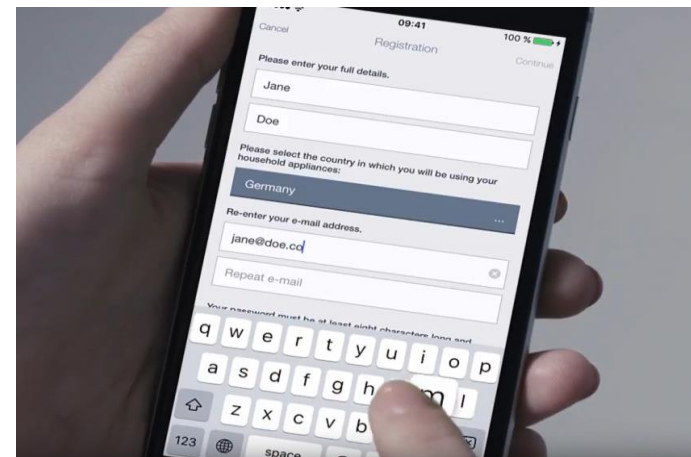

Step Three:

Make sure you can get to your router



Step Four:

Press Menu on your oven



Step Five:

Scroll on the menu until you can see home connect then press home connect assistant your screen will then direct you



Step Six:

Press the WPS button on your router and wait for the lights to flash



Step Seven:

Go back to the appliance and read the screen



Step Eight:

Now connect the appliance to the app.
By clicking connect with app



Step Nine:

On your phone follow the instructions

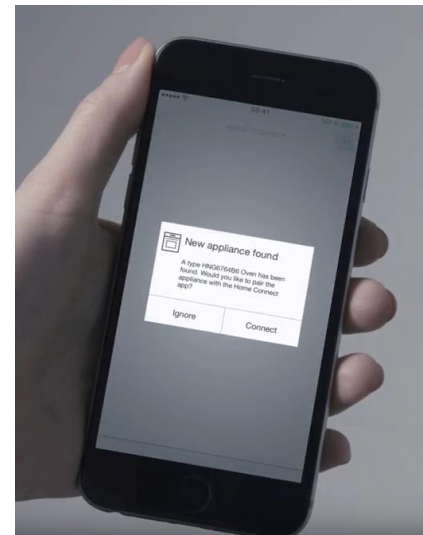

Step Ten:

You are now connected

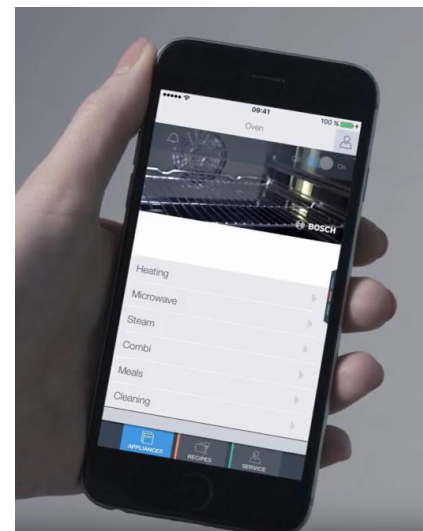

How to Connect Your Bosch Oven to the Home Connect App



Step One: Download the HomeConnect App

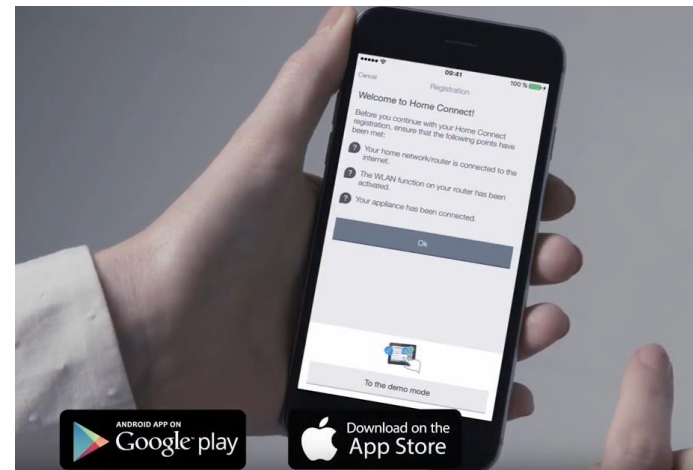

Step Two: Create a HomeConnect account

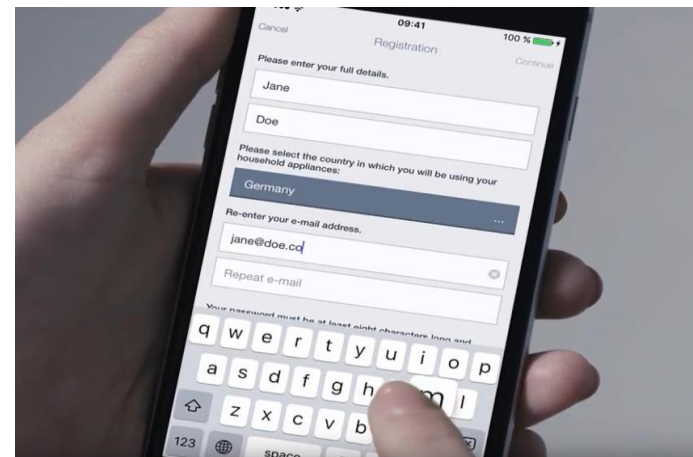

Step Three:

Move back to your appliance



Step Four:

Press menu on your oven



Step Five:

Scroll on the menu until you can see Home Connect
then press Home Connect Assistant



Step Six:

Your screen will direct you
Press Manually connect



Step Seven:

Open General settings on you phone, then Wi-Fi

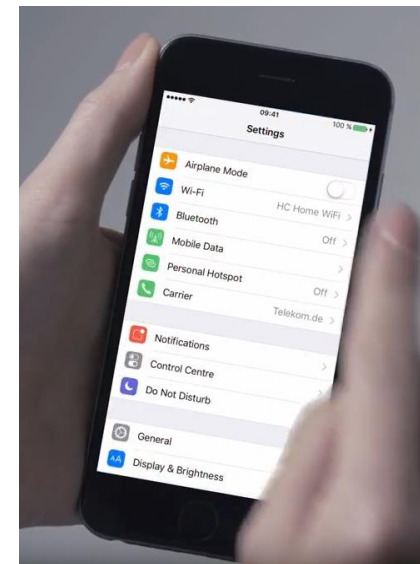

Step Eight:

Wait for the network to show HomeConnect,
Select this and wait for it to connect

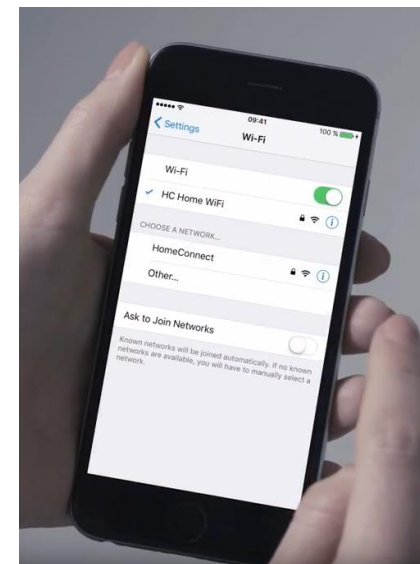

Step Nine:

You will be asked for a password,
Type HomeConnect

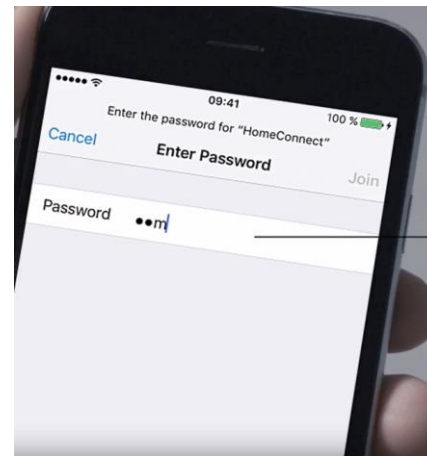

Step Ten:

You will be asked for your internet password
Enter this now

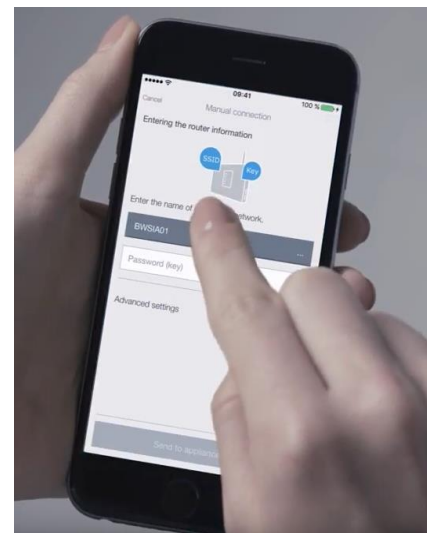

Step Eleven:
Select your internet network name

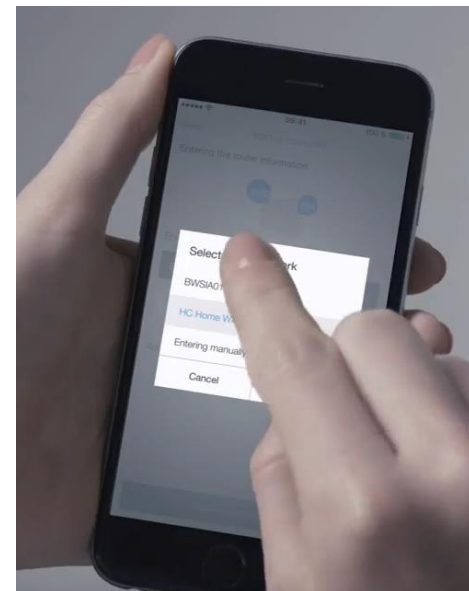

Step Twelve:
Go back to the appliance and read the screen



Step Thirteen:
On your phone follow the instructions

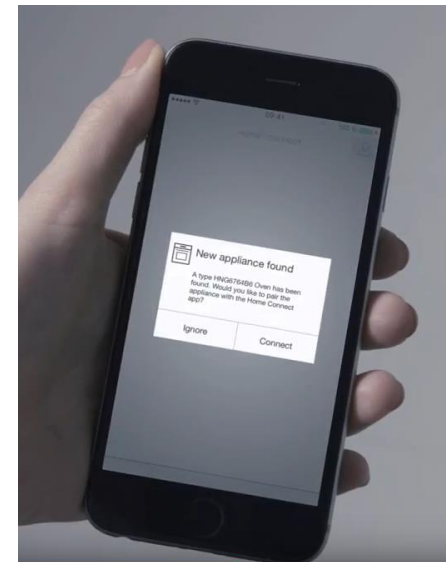

Step Fourteen:
You are now connected

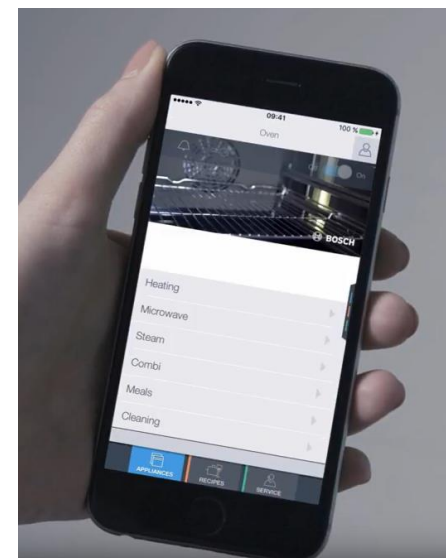

2 Unbox Alexa and set it up

1. Plug in the Alexa
2. Download the Alexa App
3. Will need an Amazon Account or set up a new one in the App
4. Connect to your Wi-Fi
5. [Echo Step by Step Video](#)



Step One:

Remove your Alexa from the box



Step Two:

Download the Alexa app from the App Store or Play store

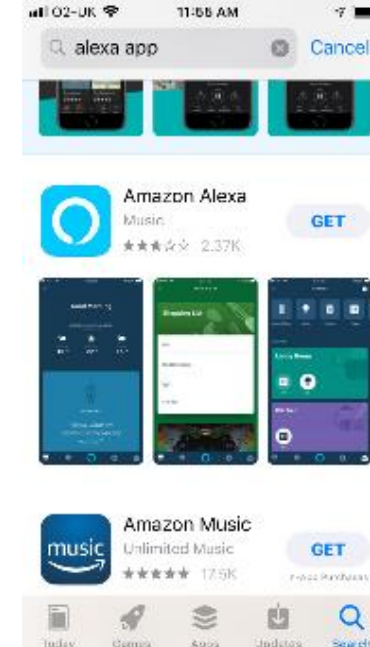

Step Three:

Download the app

Step Four:

Create a new or sign into your amazon account

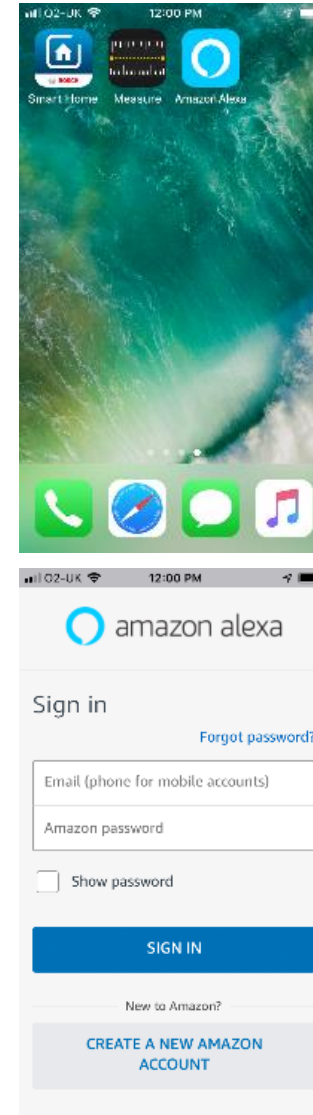

Step Five:

Run through the app and read all of the steps

Step Six:

Choose your Alexa device type

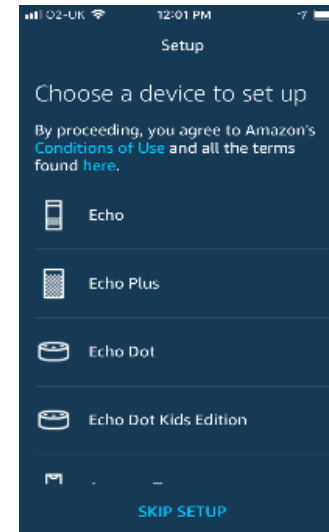
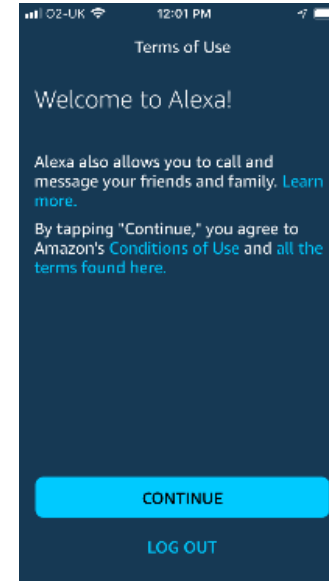

Step Seven:

Select the correct model



Step Eight:

The app will talk you through the next steps

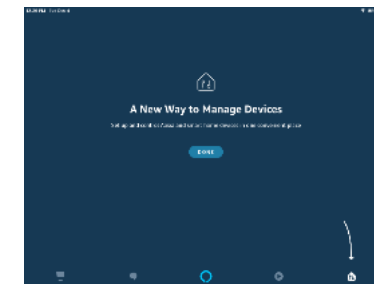
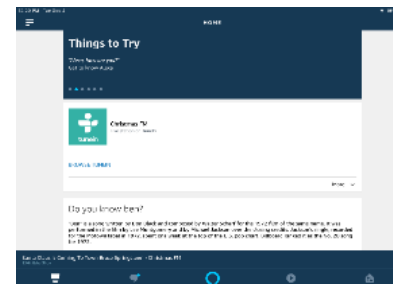
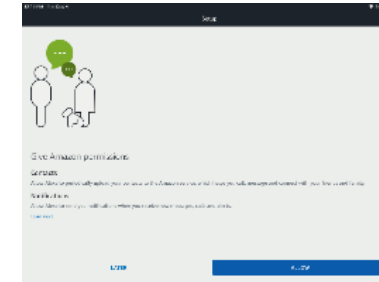

Step Nine:

Watch the YouTube film
[You Tube Video](#)

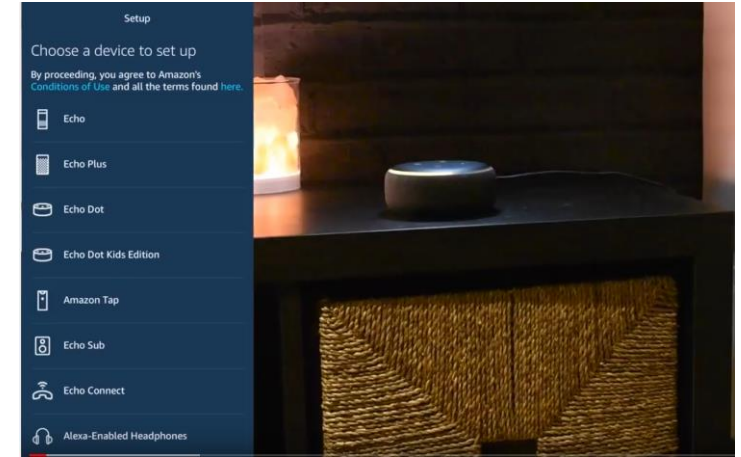

Step Ten:

Follow the steps on your Alexa App

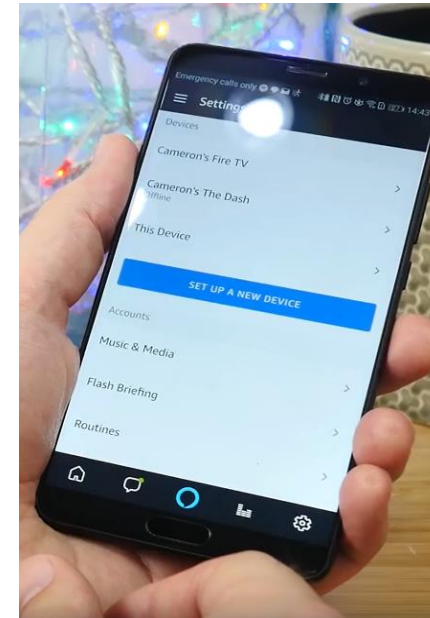

Step Eleven:

You will need to be next to your Alexa whilst you set up your account

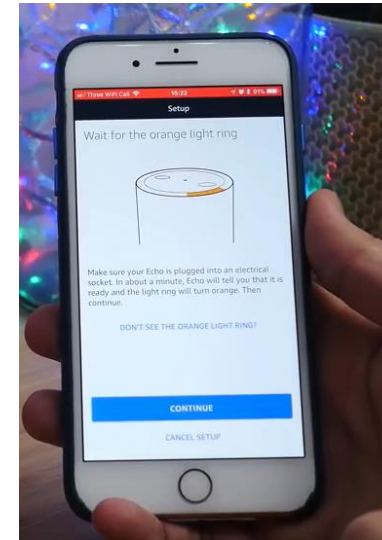

Step Twelve:

You will need your Wi-Fi Password Code

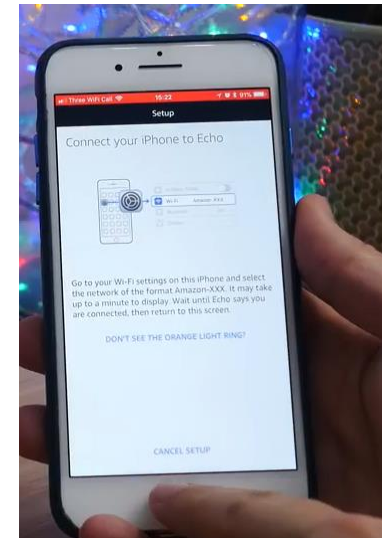

Step Thirteen:

When directed you need to go to your device setting and find the Wi-Fi for the Alexa



Step Fourteen:

Go back to the Alexa App and continue



Step Fifteen:

Please open your Skills on the Alexa app

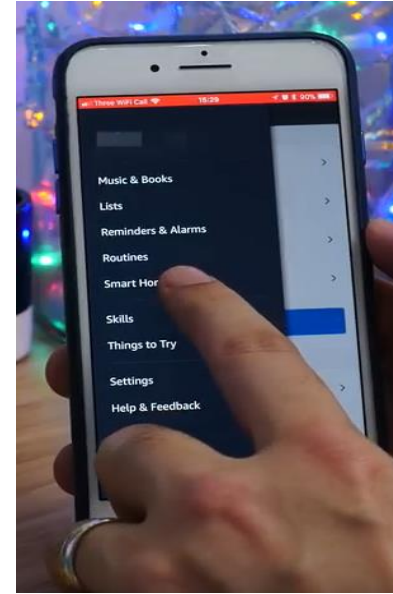

3 Connect the Oven to Alexa

Step One:

Open Alexa App Click on Skills

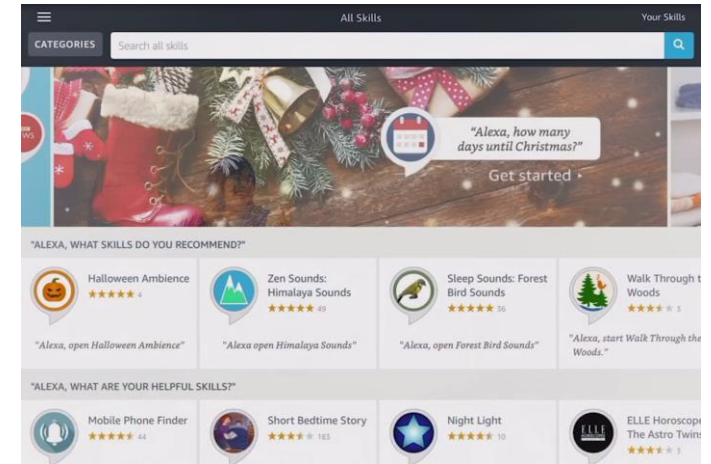

Step Two:

Next to categories on the menu bar type in Home Connect

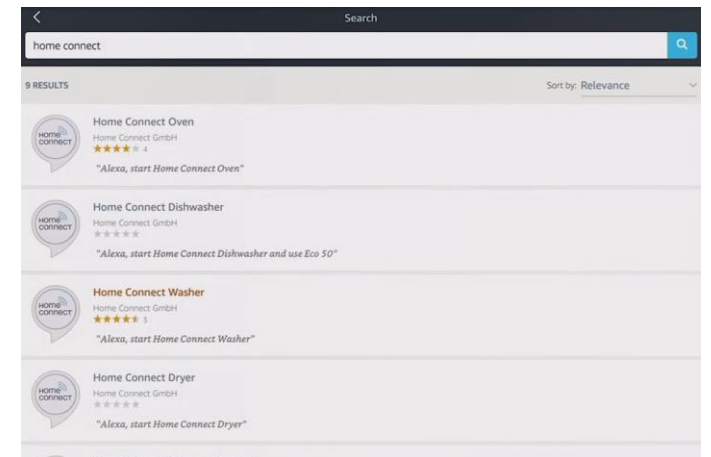

Step Three: Choose your appliance

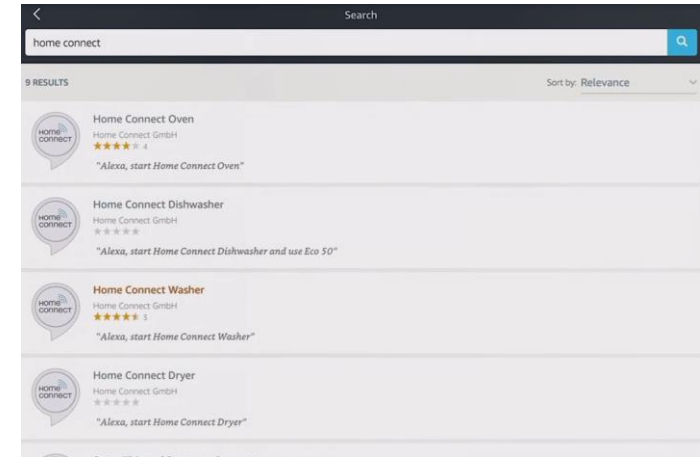

Step Four: Click Enable

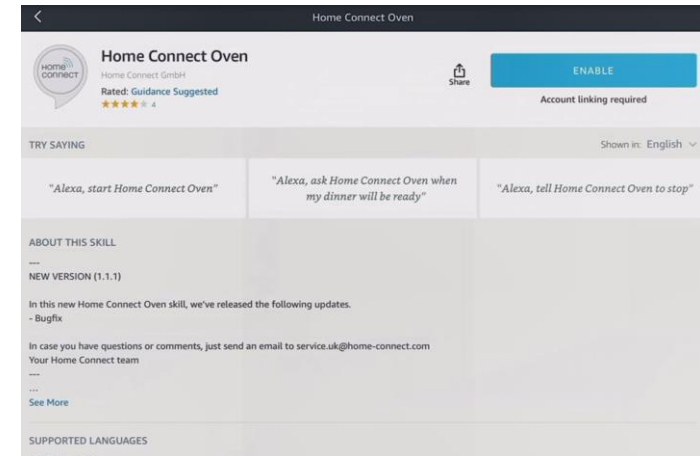

Step Five:

Log in using your HomeConnect details

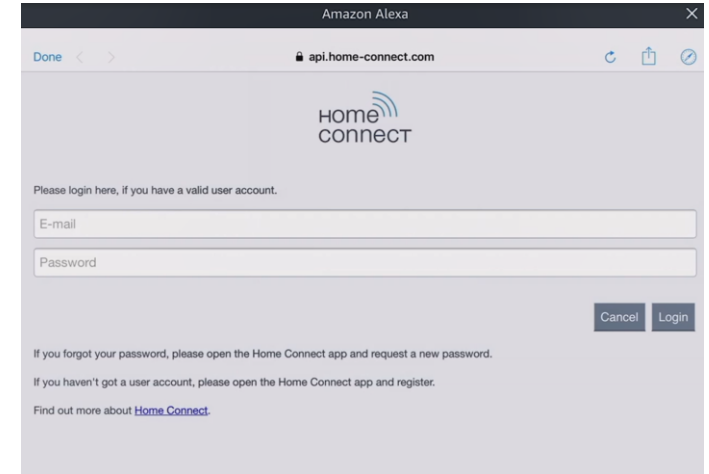

The screenshot shows the Amazon Alexa app interface for logging into a HomeConnect account. At the top, the address bar displays 'api.home-connect.com'. The HomeConnect logo is centered. Below it, a prompt says 'Please login here, if you have a valid user account.' There are two input fields: 'E-mail' and 'Password'. To the right of these fields are 'Cancel' and 'Login' buttons. Below the input fields, there are three lines of text: 'If you forgot your password, please open the Home Connect app and request a new password.', 'If you haven't got a user account, please open the Home Connect app and register.', and 'Find out more about [Home Connect](#).'

Step Seven:

Click Approve

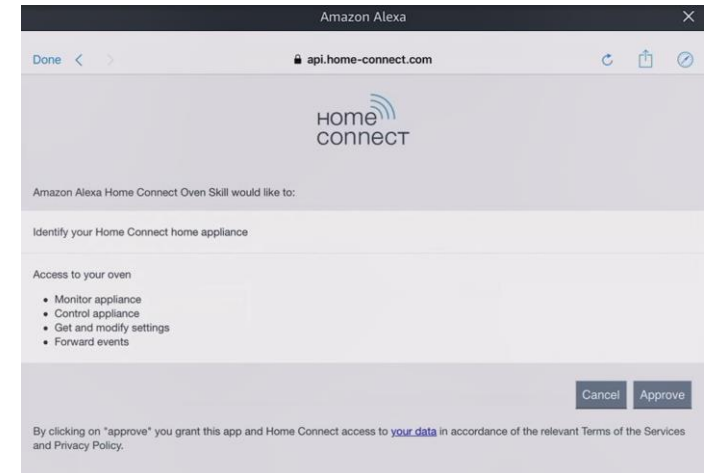

The screenshot shows the Amazon Alexa app interface for approving access to a HomeConnect oven. The address bar displays 'api.home-connect.com'. The HomeConnect logo is centered. Below it, the text reads 'Amazon Alexa Home Connect Oven Skill would like to:'. This is followed by a section titled 'Identify your Home Connect home appliance'. Below this, there is a section titled 'Access to your oven' with a list of permissions: 'Monitor appliance', 'Control appliance', 'Get and modify settings', and 'Forward events'. At the bottom right are 'Cancel' and 'Approve' buttons. At the very bottom, a small line of text states: 'By clicking on "approve" you grant this app and Home Connect access to [your data](#) in accordance of the relevant Terms of the Services and Privacy Policy.'

4 Use Alexa with voice commands

Before you can use Alexa with your appliances you will need to do the following:

Ovens

- Turn the appliance on
Press menu
Press Remote Start
You can turn the appliance off
This will activate the remote start and will stay active for 24 hours

Washing Machine

- Turn the appliance on
Press Remote Start on the front of the appliance
Do not turn the appliance off
This will activate the remote start and will stay active for 24 hours unless you open the door

Dishwasher

- Turn the appliance on
Press Remote Start on the control panel of the appliance
Do not turn the appliance off
This will activate the remote start and will stay active for 24 hours unless you open the door

Oven Alexa Voice Commands

Voice commands that can be used with Alexa and your Home Connect appliances

Oven

"Alexa, start Home Connect oven"

"Alexa, tell Home Connect oven to start".

Alexa starts the dialogue right away, guiding you through all the necessary steps.

Once you have become more familiar with this skill, try saying something like:

"Alexa, tell Home Connect oven to start top-bottom heating at 180 degrees for 10 minutes"

This shortcut lets you perform the settings quickly.

To stop the oven, say: "Alexa, tell Home Connect oven to turn off".

Voice commands that can be used with Alexa and your Home Connect appliances

Oven

If you wish to change the heating mode, say: "Alexa, tell Home Connect oven to set hot air".

You can change the temperature as follows: "Alexa, tell Home Connect oven to increase the temperature by 10 degrees" or "Alexa, tell Home Connect oven to set 120 degrees".

To change the cooking time, you can say the following, for example:

"Alexa, tell Home Connect oven to extend the cooking time by 10 minutes" or "Alexa, tell Home Connect oven to set 1 hour and 15 minutes".

To request the status, say: "Alexa, ask Home Connect oven when my dinner will be ready" or "Alexa, ask Home Connect oven which heating mode is set" or "Alexa, ask Home Connect oven for its status".

Dishwasher Alexa Voice Commands

Voice commands that can be used with Alexa and your Home Connect appliances

Dishwasher

"Alexa, start Home Connect dishwasher"

"Alexa, tell Home Connect dishwasher to start".

Alexa starts the dialogue right away, guiding you through all the necessary steps.

If you are already more familiar with the skill, try saying something more advanced such as:

"Alexa, start Home Connect dishwasher with Eco 50".

This shortcut lets you select your favourite wash program quickly and directly in just one sentence.

To query how long the wash program has left to go, say: "Alexa, ask Home Connect dishwasher for the remaining time"

Washing Machine Alexa Voice Commands

Voice commands that can be used with Alexa and your Home Connect appliances

Washing machine

"Alexa, start Home Connect washing machine"

"Alexa, tell Home Connect washing machine to start".

Alexa starts the dialogue right away, guiding you through all the necessary steps.

Once you have become more familiar with this skill, try saying something like:

"Alexa, start Home Connect washing machine for cottons at 30 degrees".

This shortcut lets you perform the settings quickly.

Voice commands that can be used with Alexa and your Home Connect appliances

Washing machine

To stop the washing machine, say: "Alexa, tell Home Connect washing machine to stop" (Note: Depending on the run time, you may have to manually set the "Rinse" program so that you can open the door)

To request the status, say: "Alexa, ask Home Connect washing machine when the laundry will be ready." or "Alexa, ask Home Connect washing machine which program is set" or "Alexa, ask Home Connect washing machine for its status".

