



BN68-25132D-00

About the Buttons on the Remote Control (Samsung Smart Remote)

- The images, buttons, and functions of the remote control may differ with the model or geographical area.
- If you use the remote control that comes with your TV to control another TV, some functions may not operate normally.
- Use the Samsung Smart Remote less than 6 m from the TV. The usable distance may vary with the wireless environmental conditions.
- The Universal Remote function operates normally only when you use the Samsung Smart Remote that comes with the TV.
- For specific functions of each button on the Samsung Smart Remote, access the **Remote Control Guide** (Home) > left directional button > Settings > All Settings > Support > Tips and User Guides > Remote Control Guide).

The remote control does not work.

- Check if the remote control sensor at the bottom of the TV blinks when you press the (Power) button on the remote control.
 - If it does not blink, replace the remote control's batteries. Make sure that the batteries are installed with their poles (+/-) in the correct direction. Alkaline batteries are recommended for longer battery life.
- Try pointing the remote directly at the TV from 1.5-1.8 m away.
- If your Samsung Smart Remote (Bluetooth Remote) does not work, try pairing it with the TV again.

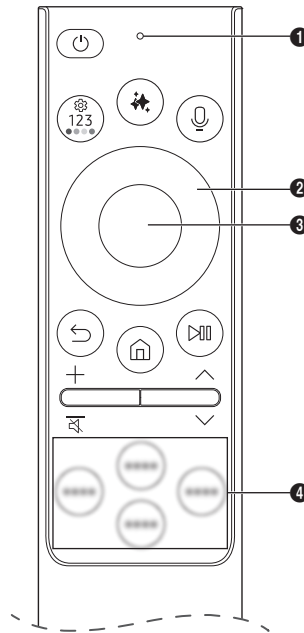
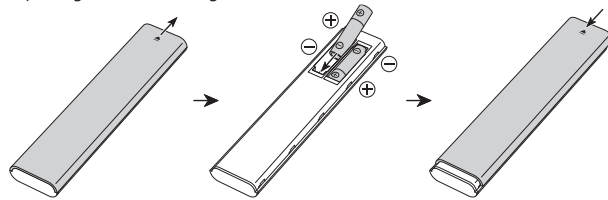

Button	Description
(Power)	Press to turn the TV on or off.
1 MIC	Used as MIC when using voice recognition with the remote control. <ul style="list-style-type: none"> • Do not impact the MIC hole or use a sharp object to poke into the hole.
(*) (AI)	Opens the AI function. Press the button to open the Samsung Vision AI Companion function. Samsung Vision AI Companion is an interactive AI service that answers your questions and provides the information you need. <ul style="list-style-type: none"> • Find out the key AI capabilities from the launched Samsung Vision AI Companion.
(Voice Assistant)	Runs Voice Assistant. Press and hold the button, say a command, and then release the button to run Voice Assistant. <ul style="list-style-type: none"> • The supported Voice Assistant's languages and features may differ by geographical area.
(123) (Settings / Number / Colour button)	You can access Setting menu / virtual numeric pad / Colour buttons / Option pad / SmartThings directly. <ul style="list-style-type: none"> • Accessing the SmartThings app using this button may not be supported, depending on the model. • Use this button to access additional options that are specific to the feature in use. • Press to bring up the virtual numeric pad on the screen. Use the numeric keypad to enter numeric values. Select numbers and then select Done or Enter Number to enter a numeric value. Use to change the channel, enter a PIN, enter a ZIP code, etc. • When pressed for 1 second or more, the Shortcuts menu screen appears.
2 Directional button (up, down, left, right)	Moves the focus and changes the values seen on the TV's menu.
3 Select	Selects or runs a focused item. When pressed while you are watching a broadcast programme, detailed programme information appears.
(Return)	Press to return to the previous menu. When pressed for 1 second or more, the running function is terminated. When pressed while you are watching a programme, the previous channel appears.
(Smart Hub)	Press to switch to the Home Screen. <ul style="list-style-type: none"> • If you press this button for more than 1 second, the same function as when pressing the (*) button is achieved.
(Play/pause)	When pressed, the playback controls appear. Using these controls, you can control the media content that is playing. To use Game Bar, press and hold the button in Game Mode . <ul style="list-style-type: none"> • Game Bar may not be supported depending on the model or geographical area.
+ / - (Volume)	Move the button up or down to adjust the volume. To mute the sound, press the button. When pressed for 2 seconds or more, the Accessibility Shortcuts appears. <ul style="list-style-type: none"> • may not be present, depending on the model.
^ / v (Channel)	Move the button up or down to change the channel. To see the Guide screen, press the button. <ul style="list-style-type: none"> • When pressed for 1 second or more, the Channel List screen appears.
4 Launch app button	Press each button to run its function. <ul style="list-style-type: none"> • Available apps may differ depending on the geographical area or contents provider.
(Return) + (Play/pause) (Pairing)	If the Samsung Smart Remote does not pair to the TV automatically, point it at the front of the TV, and then press and hold the (Return) and (Play/pause) buttons simultaneously for 3 seconds or more.

UK Declaration of Conformity

Manufacturer

Name: Samsung
 Registered Trade Name: Samsung Electronics Co., Ltd
 Address: 129 Samsung-ro, Yeongtong-gu, Suwon-si, Gyeonggi-do, Korea

Product Details

Product: Smart Control
 Model(s): VG-TM2280

Declaration and applicable standards

We hereby declare under our sole responsibility that the product above is in compliance with the essential requirements of the Radio Equipment Regulations 2017 by application of:

EMC

EN 301 489-1 V2.2.3
 EN 301 489-17 V3.3.1

Safety

EN IEC 62368-1:2020+A11:2020
 EN 62479:2010

Radio

EN 300 328 V2.2.2

and the Restriction of the Use of Certain Hazardous Substances in Electrical and Electronic Equipment Regulations 2012 by application of EN IEC 63000:2018.

Signed for and on behalf of: Samsung

Samsung Euro QA Lab, Saxony Way, Yateley, GU46 6GG, UK *
 2025-11-20 (Place and date of signature)

 Glenn Bodman – Director
 Regulatory Compliance
 (Name and signature of authorized person)

* This is not the address of Samsung Service Centre. Please see the address or the phone number of Samsung Service Centre in the warranty card or contact the retailer where you purchased your product.

SAMSUNG

About the Buttons on the Standard Remote Control

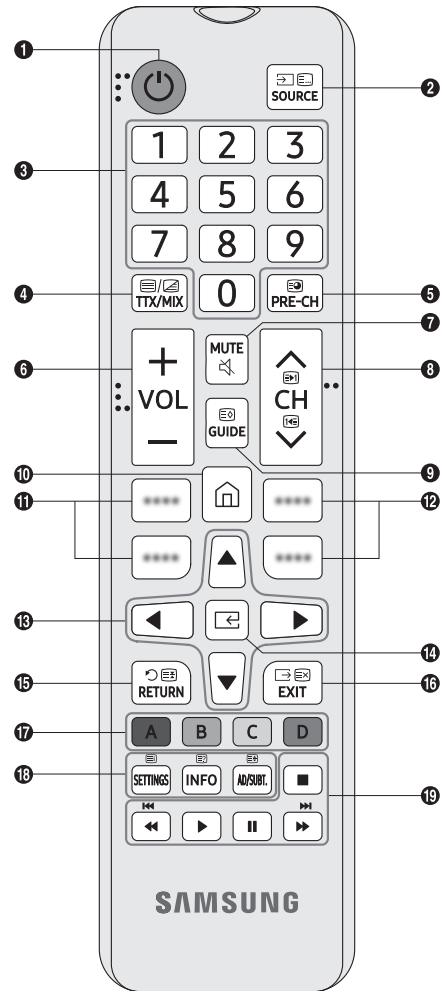

Number	Description
1	⏻ (Power) Turns the TV on and off.
2	Displays and selects available video sources.
3	Gives direct access to channels.
4	Alternately selects Teletext mode, Full TTX / Double TTX / Mix / Live TV.
5	Returns to the previous channel.
6	Adjusts the volume.
7	Turns the sound on/off.
8	Changes the current channel.
9	Displays the Guide screen.
10	Press to switch to the Home Screen. Press and hold for more than 1 second to launch Samsung Vision AI Companion. <ul style="list-style-type: none"> This function may not be supported depending on the model or geographical area.
11, 12	Press each button to run its function. <ul style="list-style-type: none"> Available apps may differ depending on the geographical area or contents provider.
13	Moves the cursor, selects the on-screen menu items, and changes the values seen on the TV's menu.
14	☑ (Select) Selects or runs a focused item.
15	Returns to the previous menu or channel.
16	Exits the menu.
17	Use these buttons according to the directions on the TV screen.
18	SETTINGS Displays the main on-screen menu. INFO Displays information about the current programme or content. AD/SUBT. Displays the Accessibility Shortcuts.
19	Use these buttons with specific features. Use these buttons according to the directions on the TV screen.

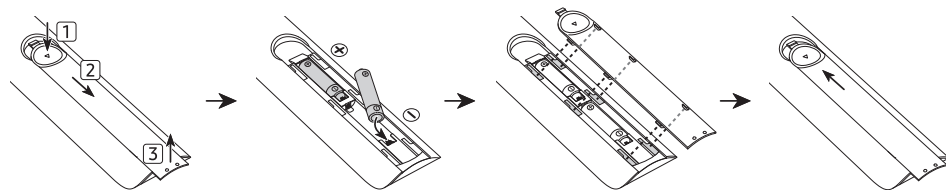

- The images, buttons, and functions of the remote control may differ depending on the model or geographical area.
- This remote control has Braille points on the Power, Channel, and Volume buttons and can be used by visually impaired persons.
- If you use the remote control that comes with your TV to control another TV, some functions may not operate normally.

The remote control does not work.

- Check if the remote control sensor at the bottom of the TV blinks when you press the ⏻ button on the remote control.
 - If it does not blink, replace the remote control's batteries. Make sure that the batteries are installed with their poles (+/-) in the correct direction. Alkaline batteries are recommended for longer battery life.
- Try pointing the remote directly at the TV from 1.5-1.8 m away.