



Brief and handy: everything your dishwasher needs...
Before using for the first time, read the operating instructions!

1

Adjusting the water softening system *

Ask your water supply company what the water hardness is and enter this...

Water-hardness value °dH	Hardness range	mmol/l	Setting value
0 - 6	Soft	0 -1.1	H:00
7 - 8	Soft	1.2-1.4	H:01
9 -10	Medium	1.5-1.8	H:02
11-12	Medium	1.9-2.1	H:03
13-16	Medium	2.2-2.9	H:04
17-21	Hard	3.0-3.7	H:05
22-30	Hard	3.8-5.4	H:06
31-50	Hard	5.5-8.9	H:07

* Only before the first wash or if the water hardness has changed

Quickly done...

How to adjust

- Switch on the ON/OFF switch
 - Press **setup 3 sec.** button for 3 seconds.
- The display shows **Hxx** and **Set**
- Press the Start button until the correct water hardness level is set.
 - To store the settings, press the < button for 3 seconds.

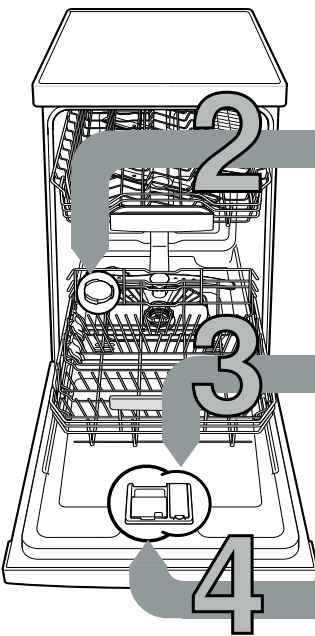

Add special salt

Dissolves limescale (not necessary when set to 0!) ...

For optimal washing results



Open the lid.

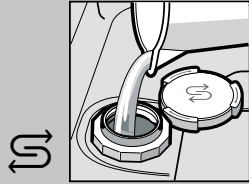

Only fill the salt dispenser with water before the first wash.



Add special salt (never use detergent!).



Close the lid. Rinse immediately.

Add rinse aid

Gets it sparkling clean ...

For optimum drying results



Press marking 1, lift lid 2.



Add rinse aid.



Close lid. CLICK!

Add detergent

A lot of dirt, a lot of detergent ...



If required, open the cover (press button).



Attention: Combination products are not suitable for all programmes, follow manufacturer's instructions.



Pour detergent into the dry detergent dispenser only.



Slide cover shut, press. PLOP!

5 Switch on the appliance

6 Select programme

Quick, economical or intensive ...

Overview of programmes

This overview describes all the possible programmes. You can see which programmes your appliance offers from its control panel. The values given in the programme details are laboratory measurements compliant with European standard EN 60436. The consumption figures depend on the selected programme and additional functions. The programme duration will be different if the machine is short of rinse additive or the function is turned off.

- * half normal load
- ** Suitable programme for running at night: it takes longer, but is extremely quiet.

	Intensive 70°	Auto 45°/65°	Eco 50°	Silence ** 50°	Express 65°	Express 60°	Express 45°	Glass 40°	Favourite	Machine Care
Duration in hrs : mins.	1:55 - 2:05	1:35 - 2:40	3:40	4:00	1:00	1:29	0:29 *	1:35 - 1:38	0:15	2:10 - 2:15
Energy consumption in kWh	1,090 - 1,200	0,650 - 1,100	0,704	0,800	1,050	0,850	0,700	0,600 - 0,700	0,050	1,130 - 1,345
Water consumption in litres	10,5 - 13	7 - 14,5	8,5	9,6	10	11	9,4	10,5 - 13,1	4	14 - 15,2

You will find descriptions of possible additional functions in your instruction manual.

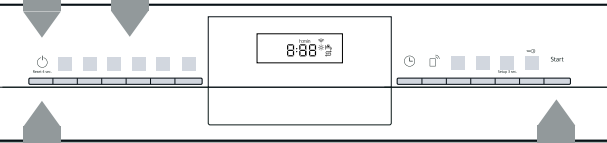

7 Start the programme Off we go...

8 Switch off the appliance Everything OK...



Maintenance and care

For perfect rinsing results ...

Cleaning waste water pump

Filters
... check, if required, clean.

Rotate filter cylinder, remove filter system ...

rinse under running water ...

insert ...

Screw on filter system
NOTE MARK!

- Pull out the mains plug.
- Remove filters and scoop out water.
- Lever off cover (A).
- Check area around the fan impeller for foreign objects.
- Click cover shut (B).
- Insert filters.

Spray arms
... Remove blockages/deposits.

pull lower arm upwards ...

unscrew upper arm ...

clean spray nozzles under running water (if required use toothpicks) ...

insert lower arm ...

Rectify small faults yourself...

... because self-help is worth it!

For more information, see the instruction manual

Fault	Possible causes	Remedy
Display E32 / -00 and lights up	Supply fitting jammed or calcified Water supply not connected	<ul style="list-style-type: none"> ▶ Supply fitting open. ▶ 1. Unscrew water connection. ▶ 2. Clean filter in the water supply. ▶ 3. Flow rate must be min. 10 l/min., when water supply is open. ▶ If the flow rate is less, replace the supply fitting. ▶ Install supply hose without kinks. ▶ Connect water supply. (Drinking water connection in the instruction manual).
Display E92 / -40	Filters are soiled or blocked	▶ Clean the filters (see above).
Display E61 / -03 and lights up	Waste water hose is blocked or kinked Cover of waste water pump not fitted	<ul style="list-style-type: none"> ▶ Reposition the waste water hose without kinks. ▶ Attach cover (see above).
Display E61 / -02 and lights up	Waste water pump blocked	▶ Clean waste water pump (see above).
Other error display Exx / -xx lights up	Appliance technically defective	<ul style="list-style-type: none"> ▶ Call the after-sales service (name the fault display). ▶ Unplug the appliance.
Residual water in the appliance	Programme has not yet ended	▶ Close the appliance and switch it on or terminate the programme (see Terminating the programme).
Rust on cutlery	Cutlery not rust-resistant Hard knife blades are more susceptible External rack	<ul style="list-style-type: none"> ▶ Use dishwasher-proof cutlery. ▶ Never wash rusting parts in the appliance.

Fault	Possible causes	Remedy
Tableware is not clean Sand or gritty residue on the tableware 	<ul style="list-style-type: none"> Tableware lies against one another or on top of each other Not enough detergent Unsuitable programme selected Spray arm nozzles are blocked Filters are contaminated, not firmly seated Spray arms blocked 	<ul style="list-style-type: none"> ▶ Separate tableware, prevent contact points. ▶ Follow the manufacturer's instructions (detergent). ▶ Select a more intensive programme ▶ Clean spray arms (see above) ▶ Clean the filters (see above). ▶ Arrange tableware so that spray arms can rotate freely.
Spots and streaks	Rinse aid dosage too high / too low	<ul style="list-style-type: none"> ▶ In the case of streaks: reduce detergent dosage. ▶ In the case of water or limescale marks: increase dosage.
Tableware not dry	Rinse aid The combined detergent used has a poor drying performance. Appliance setting	<ul style="list-style-type: none"> ▶ Increase dosage. ▶ Change product. ▶ Use rinse aid.
Milky deposits on the tableware (removable)	The water softening function is wrongly configured Insufficient special salt	<ul style="list-style-type: none"> ▶ Activate intensive drying (depending on model). ▶ Configure water softening system ▶ Add special salt
Milky deposits, glasses clouded / opaque (cannot be removed)	Glasses not dishwasher-proof	<ul style="list-style-type: none"> ▶ Use dishwasher-resistant glasses. ▶ Use glass-protective cleaners.
Plastic / tableware items discoloured	Not enough detergent Discolouration by food dyes (tomato sauce)	<ul style="list-style-type: none"> ▶ Follow the manufacturer's instructions (detergent). ▶ Discolouration will not damage the appliance; fade after further wash cycles.

Cancel the programme ...

During the programme, press the button for approx. 4 sec. (reset).

All displays light up, then "0:01" appears in the display "0:00" appears after the programme has finished

Load the appliance correctly ...

Insert dishwasher-proof tableware (roughly remove large remnants of jam, dairy products and meals without leaving residue from ash, wax, lubricating grease, paint, adhesive labels) as described in the instruction manual and check that the spray arms can rotate freely