

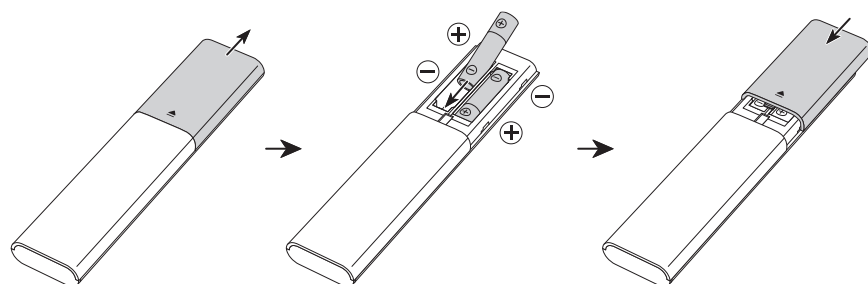

BN68-25091F-00

About the Buttons on the Remote Control

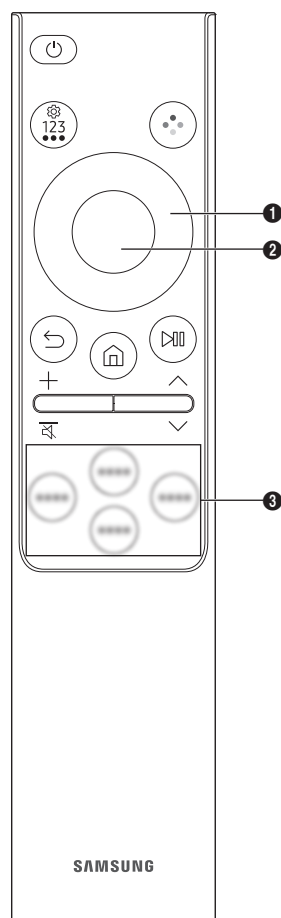

Button	Description
(Power)	Press to turn the TV on or off.
(Settings / Number / Option button)	You can access Setting menu / virtual numeric pad / Option pad / SmartThings directly. <ul style="list-style-type: none"> Accessing the SmartThings app using this button may not be supported, depending on the model. Use this button to access additional options that are specific to the feature in use. Press to bring up the virtual numeric pad on the screen. Use the numeric keypad to enter numeric values. Select numbers and then select Done or Enter Number to enter a numeric value. Use to change the channel, enter a PIN, ZIP code and etc. When pressed for 1 second or more, the Shortcuts menu screen appears.
(Colour button)	When pressed, coloured buttons appear on the screen. Use this button to access additional options that are specific to the feature in use.
① Directional button (up, down, left, right)	Moves the focus and changes the values seen on the TV's menu.
② Select	Selects or runs a focused item. When pressed while you are watching a broadcast programme, detailed programme information appears.
(Return)	Press to return to the previous menu. When pressed for 1 second or more, the running function is terminated. When pressed while you are watching a programme, the previous channel appears.
(Smart Hub)	Press to switch to the Home Screen. Press and hold for more than 1 second to launch Samsung Vision AI Companion function. Samsung Vision AI Companion is an interactive AI service that answers your questions and provides the information you need. <ul style="list-style-type: none"> Find out the key AI capabilities from the launched Samsung Vision AI Companion. This function may not be supported depending on the model or geographical area.
(Play/pause)	When pressed, the playback controls appear. Using these controls, you can control the media content that is playing.
+/- (Volume)	Move the button up or down to adjust the volume. To mute the sound, press the button. When pressed for 2 seconds or more, the Accessibility Shortcuts appears. <ul style="list-style-type: none"> may not be present, depending on the model.
^ / v (Channel)	Move the button up or down to change the channel. To see the Guide screen, press the button. <ul style="list-style-type: none"> When pressed for 1 second or more, the Channel List screen appears.
③ Launch app button	Press each button to run its function. <ul style="list-style-type: none"> Available apps may differ depending on the geographical area or contents provider.

- The images, buttons, and functions of the remote control may differ with the model or geographical area.
- If you use the remote control that comes with your TV to control another TV, some functions may not operate normally.

The remote control does not work.

- Check if the remote control sensor at the bottom of the TV blinks when you press the button on the remote control.
 - If it does not blink, replace the remote control's batteries. Make sure that the batteries are installed with their poles (+/-) in the correct direction. Alkaline batteries are recommended for longer battery life.
- Try pointing the remote directly at the TV from 1.5-1.8 m away.

SAMSUNG

About the Buttons on the Standard Remote Control

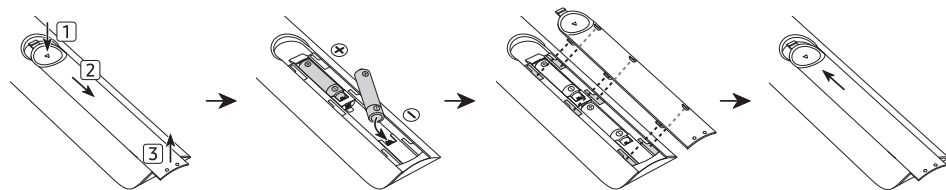
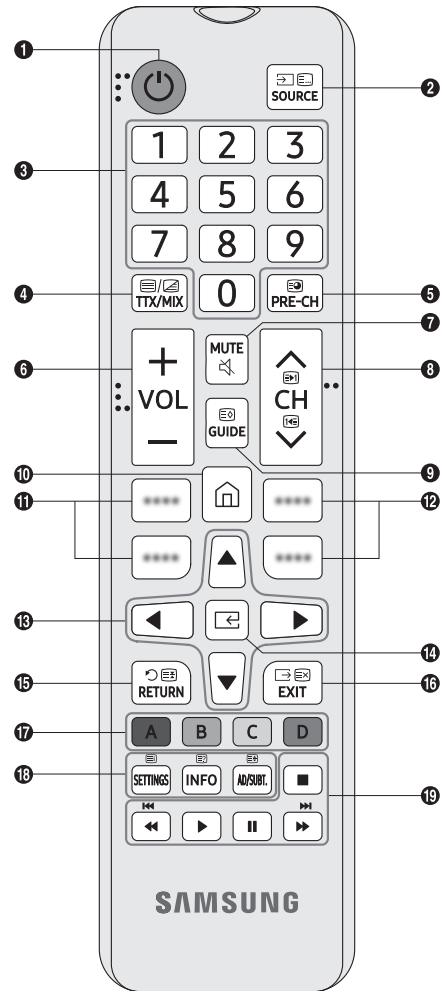

Number	Description
1	⏻ (Power) Turns the TV on and off.
2	Displays and selects available video sources.
3	Gives direct access to channels.
4	Alternately selects Teletext mode, Full TTX / Double TTX / Mix / Live TV.
5	Returns to the previous channel.
6	Adjusts the volume.
7	Turns the sound on/off.
8	Changes the current channel.
9	Displays the Guide screen.
10	Press to switch to the Home Screen. Press and hold for more than 1 second to launch Samsung Vision AI Companion. <ul style="list-style-type: none"> This function may not be supported depending on the model or geographical area.
11, 12	Press each button to run its function. <ul style="list-style-type: none"> Available apps may differ depending on the geographical area or contents provider.
13	Moves the cursor, selects the on-screen menu items, and changes the values seen on the TV's menu.
14	⏏ (Select) Selects or runs a focused item.
15	Returns to the previous menu or channel.
16	Exits the menu.
17	Use these buttons according to the directions on the TV screen.
18	SETTINGS Displays the main on-screen menu. INFO Displays information about the current programme or content. AD/SUBT. Displays the Accessibility Shortcuts.
19	Use these buttons with specific features. Use these buttons according to the directions on the TV screen.

- The images, buttons, and functions of the remote control may differ depending on the model or geographical area.
- This remote control has Braille points on the Power, Channel, and Volume buttons and can be used by visually impaired persons.
- If you use the remote control that comes with your TV to control another TV, some functions may not operate normally.

The remote control does not work.

- Check if the remote control sensor at the bottom of the TV blinks when you press the ⏻ button on the remote control.
 - If it does not blink, replace the remote control's batteries. Make sure that the batteries are installed with their poles (+/-) in the correct direction. Alkaline batteries are recommended for longer battery life.
- Try pointing the remote directly at the TV from 1.5-1.8 m away.