

# Upright Vacuum Cleaner

## User Manual



VCS 6135 AR  
VCS 6135 AB

**EN**

01M-8837693200-1118-01  
01M-8837683200-1118-01

**beko**

# Please read this user manual first!

Dear Valued Customer,

Thank you for selecting this Beko appliance. We hope that you get the best results from your appliance which has been manufactured with high quality and state-of-the-art technology. Therefore, please read this entire user manual and all other accompanying documents carefully before using the appliance and keep it as a reference for future use. If you handover the appliance to someone else, give the user manual as well. Follow the instructions by paying attention to all the information and warnings in the user manual.

Remember that this user manual may also apply to other models. Differences between models are explicitly described in the manual.

## Meanings of the Symbols

Following symbols are used in various sections of this manual:

	Important information and useful hints about usage.
--	---

	<b>WARNING:</b> Warnings against dangerous situations concerning the security of life and property.
--	---

	Protection class for electric shock.
--	--------------------------------------



This product has been produced in environmentally friendly modern facilities.



This product does not contain PCB's

# CONTENT

---

## **1 Important safety and environmental instructions 4-6**

---

1.1 General safety .....	4
1.2 Compliance with WEEE Directive and Disposing of the Waste Product .....	5
1.3 Compliance with RoHS Directive .....	5
1.4 Package information .....	5
1.5 Plug Wiring .....	6

## **2 Your stick vacuum cleaner 7-8**

---

2.1 Overview .....	7
2.2 Technical data .....	8

## **3 Usage 9-11**

---

3.1 Intended use .....	9
3.2 Installation .....	9
3.2.1 Installation of the body and the handle ..	9
3.3 Operating the appliance .....	9
3.3.1 Using the brush roller .....	9
3.4 Accessories .....	10

## **4 Cleaning and care 12-14**

---

4.1 Cleaning the dust container .....	12
4.2 Cleaning the pre-motor filter .....	12
4.3 Cleaning the post motor filter .....	13
4.4 Cyclone separator .....	13
4.5 Replace the brush and belt .....	13
4.6 Storage .....	14

## **5 Guarantee 15**

---

# 1 Important safety and environmental instructions

This section contains safety instructions that will help protect from risk of personal injury or property damage.

Failure to follow these instructions voids any granted warranty.

## 1.1 General safety

- This appliance complies with international safety standards. This appliance can be used by children aged from 8 years and above and persons with reduced physical, sensory or mental capabilities or lack of experience and knowledge if they have been given supervision or instruction concerning use of the appliance in a safe way and understand the hazards involved. Children shall not play with the appliance. Cleaning and user maintenance shall not be made by children without supervision.
- If the power cable or the appliance itself is damaged, do not use it. Contact an authorised service.
- Your mains power supply should comply with the information supplied on the rating plate of the appliance.
- The mains plug is fitted with a 13A fuse. Ensure the same rating fuse is used should it need replacement.
- Do not use the appliance with an extension cable.
- Prevent damage to the power cable by not squeezing, bending, or rubbing it on sharp edges.
- Do not touch the appliance or its plug when it is plugged in if your hands are damp or wet.
- Do not pull the power cable when unplugging the appliance.
- Do not vacuum flammable materials (cigarette ash, fireplace ash).
- Do not vacuum water or other liquids.
- Keep turbo brush away from hair, face, fingers, uncovered feet, or loose clothing.
- Protect the appliance from rain, humidity and heat sources.
- Never use the appliance in or near places where combustible or inflammable ambience or places are present.
- Unplug the appliance before cleaning and maintenance.

# 1 Important safety and environmental instructions

- Do not immerse the appliance or its power cable in water for cleaning.
- Do not attempt to dismantle the appliance in any way other than that shown in the Cleaning and Care section of this user manual.
- Only use the original parts or parts recommended by the manufacturer.
- Do not clean the particles such as cement, plaster and compressed paper in order to prevent the filter from being clogged and the motor being damaged.
- Do not use the appliance without filters; otherwise it can get damaged.
- If you keep the packaging materials, store them out of the reach of children.

## 1.2 Compliance with WEEE Directive and Disposing of the Waste Product



This product complies with EU WEEE Directive (2012/19/EU). This product bears a classification symbol for waste electrical and electronic equipment (WEEE). This product has been manufactured with high quality parts and materials which can be reused and are suitable for recycling. Do not dispose of the waste product with normal domestic and other wastes at the end of its service life. Take it to the collection center for the recycling of electrical and electronic equipment. Please consult your local authorities to learn about these collection centers.

## 1.3 Compliance with RoHS Directive

The product you have purchased complies with EU RoHS Directive (2011/65/EU). It does not contain harmful and prohibited materials specified in the Directive.

## 1.4 Package information



Packaging materials of the product are manufactured from recyclable materials in accordance with our National Environment Regulations. Do not dispose of the packaging materials together with the domestic or other wastes. Take them to the packaging material collection points designated by the local authorities.

# 1 Important safety and environmental instructions

## 1.5 Plug Wiring

The moulded plug on this appliance incorporates a 13 A fuse. Should the fuse need to be replaced an ASTA approved BS1362 fuse of the same rating must be used. Do not forget to refit the fuse cover. In the event of losing the fuse cover, the plug must not be used until a replacement fuse cover has been fitted. Colour of the replacement fuse cover must be the same colour as that visible on the pin face of the plug. Fuse covers are available from any good electrical store.

- **Fiting a different plug**

- As the colours of the wires in the mains lead of this appliance may not correspond with the coloured markings identifying the terminals on your plug, proceed as follows:
- Brown cable = L (Live)
- Blue cable = N (Neutral)
- Green/yellow cable must be connected to ground (E)  $\equiv$  line
- With the alternative plugs a 13 A fuse must be fitted either in the plug or adaptore or in the main fuse box. If in doubt contact a qualified electrician.

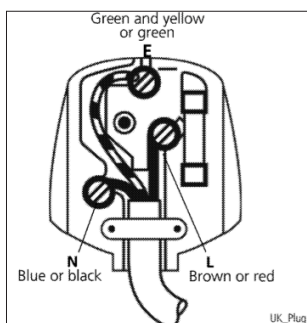

## 2 Your stick vacuum cleaner

### 2.1 Overview

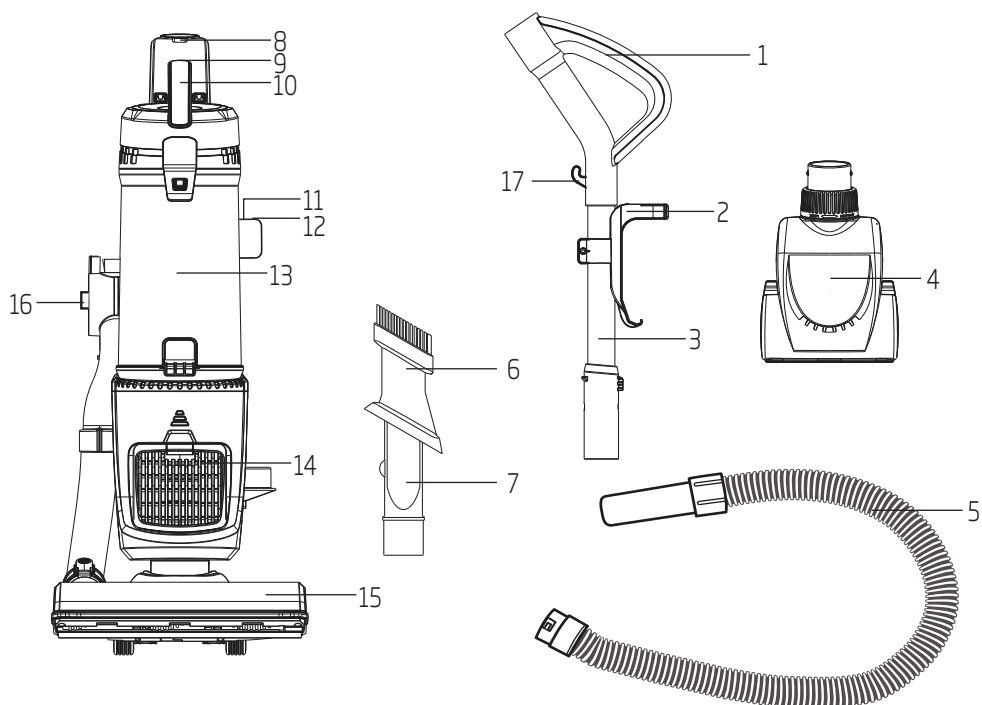

## 2 Your stick vacuum cleaner

1. Handle
2. Turbo brush storage hook
3. Tube
4. Special Turbo/Animal Brush (VCS 6135 AR)
5. Hose
6. Dust brush
7. Nozzle crevice tool
8. Handle release button
9. Dust container release button
10. Dust container handle
11. Hose and vacuum suction button
12. Brush switch button
13. Dust container
14. Exhaust filter
15. Brush
16. Hose / floor suction knob
17. Cord storage hook

### 2.2 Technical data

**Supply voltage** : 220-240V~ 50-60 Hz

**Power** : 700 W



## 3 Usage

### 3.1 Intended use

This appliance is intended for domestic use. It is not suitable for industrial use.

### 3.2 Installation

#### 3.2.1 Installation of the body and the handle

1. Remove the hose from the hose socket.

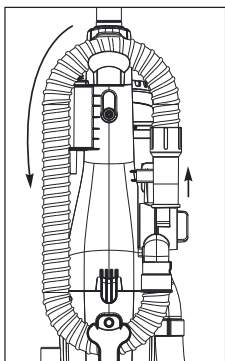

2. Fit the hose into the handle part and fix it by turning the hose clockwise.
3. Insert the handle into the main body (you will hear a click tone).

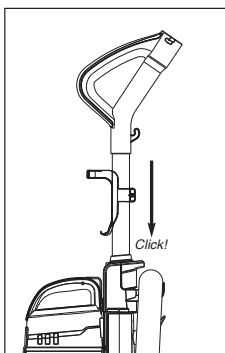

4. To remove the handle, press the handle release button and pull out the handle from the main body.

### 3.3 Operating the appliance

1. Pull out the power cord from the cord storage hook.
2. Plug in the appliance.
3. Adjust the hose / floor suction knob according to the use of brush roller or tools.
4. Press the on/off button to switch on your appliance.

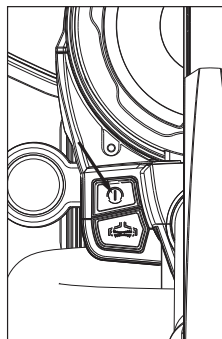

5. When you press on/off button to start the appliance.
6. After using the appliance, switch it off by pressing the On/off button.

#### 3.3.1 Using the brush roller

Adjust the hose / floor suction knob to the floor type.

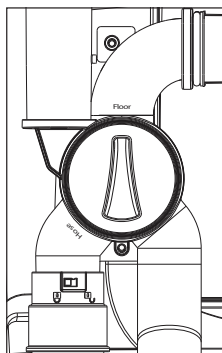

You can adjust the brush roller by using the brush switch button.

Push the brush switch button for carpet.

– The brush roller is in use.

## 3 Usage

- Push the brush switch button for hard floor again.  
– The brush roller is not in use.

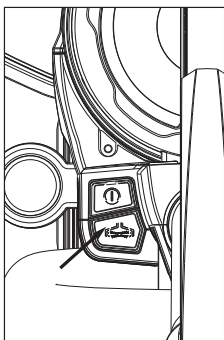

The brush roller is not in use when the appliance is in upright position.

### 3.4 Accessories

You can store the 3in1 accessory tool on the main body tool holder.

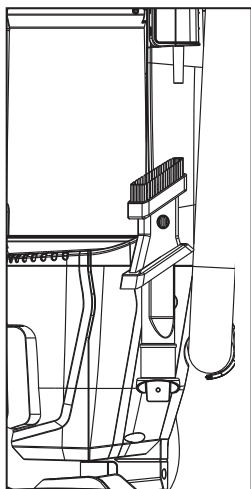

#### Use the accessories with the tube

1. Remove the tube from the main body by pushing the tube release button.
2. Assemble the required accessory onto the tube.

3. Adjust the hose / floor suction knob to the floor type.

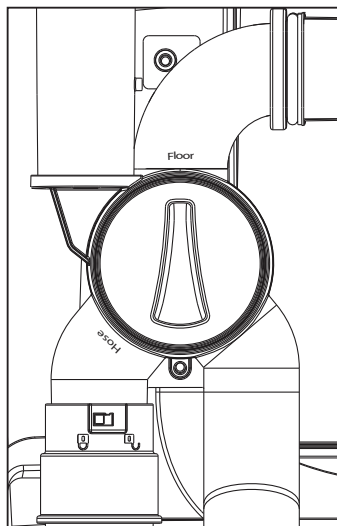

#### Use the accessories with the hose

1. To use the accessories remove the hose from the handle part by turning it anticlockwise.
2. Assemble the required accessory onto the hose.
3. Adjust the hose / floor suction knob to the hose type.

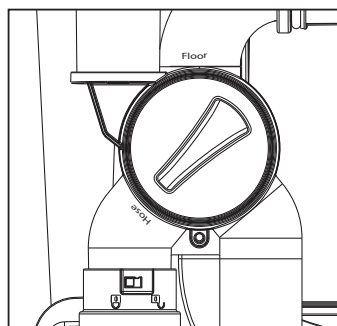

#### Crevice tool

Attach the crevice tool to the inner side of the hose/tube.

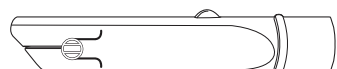

## 3 Usage

### Dust brush

Attach the dust brush onto the crevice tool (you will hear a click tone).

To remove the dust brush from the crevice tool push the knob and pull it out.

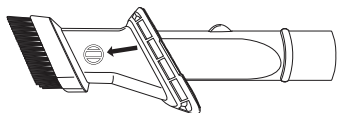

### Upholstery tool

Attach the upholstery tool side onto the crevice tool (you will hear a click tone).

To remove the dust brush from the crevice tool push the knob and pull it out.

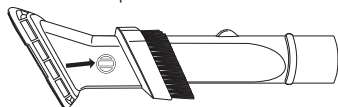

### Brush tool

Attach the brush tool to the inner side of the hose.

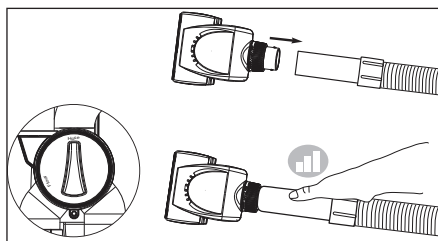

### Special Turbo/Animal Brush (VCS 6135 AR)

Use the special turbo/animal brush (4) to easily remove your pet's hair from your sofa and furniture.

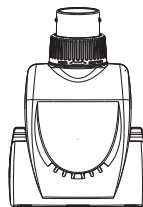

**WARNING:** The appliance must be in upright position during the use of the tools.

## 4 Cleaning and care

For replacement filters please visit [www.beko.co.uk/appliances/small\\_appliances](http://www.beko.co.uk/appliances/small_appliances)

Switch off and unplug the appliance before cleaning it.



**WARNING:** Never use gasoline, solvent, abrasive cleaning agents, metal objects or hard brushes to clean the appliance.

### 4.1 Cleaning the dust container



It is recommended to clean the dust container after each use.

1. Press the dust container release button and pull the handle of the dust container to remove it.

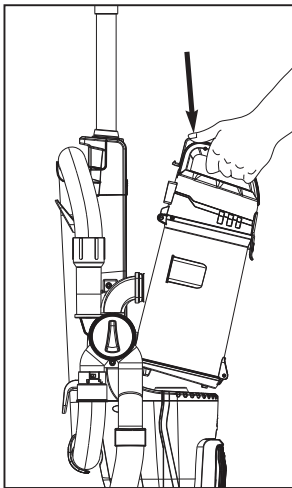

2. Hold the dust container over a dust bin.

3. Press the dust container open button and empty it.

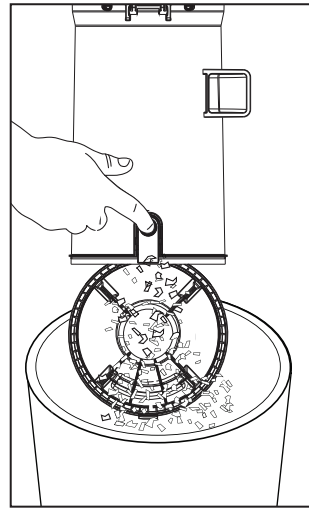

4. After the dust container is empty close the opened lid gently.

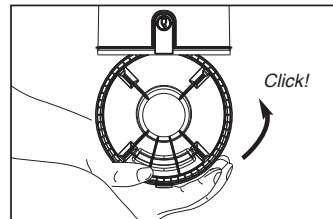

### 4.2 Cleaning the pre-motor filter

1. Open the filter cover by pulling the latch gently.

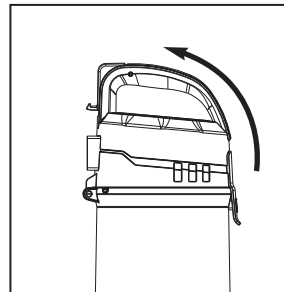

2. Remove the pre-motor filter.

## 4 Cleaning and care

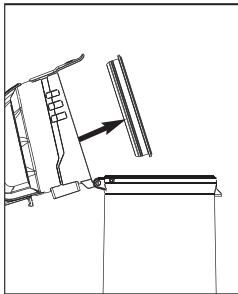

3. Wash the pre-motor filter with warm water until it gets clean (let the clean filter to dry 24 hours).

### 4.3 Cleaning the post motor filter

1. Open the post motor filter cover with the release button.

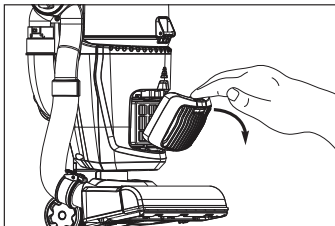

2. Remove the post motor filter by pressing its release button.

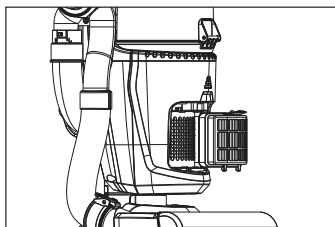

3. Wash the post motor filter with warm water until it gets clean (let the clean filter to dry 24 hours).
4. After the filters are completely dry, put them back into the main body.

### 4.4 Cyclone separator

1. Open the filter cover by pulling the latch gently.
2. Hold and pull the cyclone from its handles and take it out from the dust container.
3. Clean the cyclone with a dry cloth.
4. Follow the steps above in reverse order to assemble the parts together again.

### 4.5 Replace the brush and belt

1. Unplug the appliance and turn it over.
2. Remove 6 screws from the button cover.

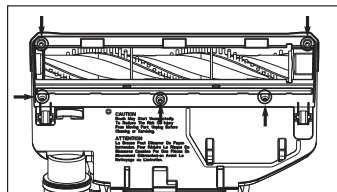

3. Remove the cover.

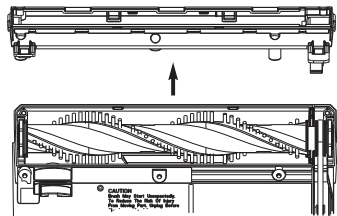

4. Remove the brush roller and check it for wear on the belt. Loop the new belt around the motor and brush channel.
5. Hold the brush roller and stretch the belt until it can be slotted back.

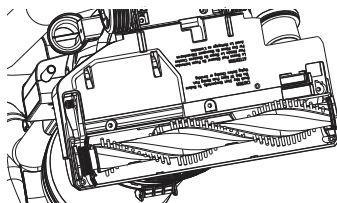

Rotate the brush roller to ensure free movement of the belt.

6. Refit the brush cover by screwing it back.

## 4 Cleaning and care

### 4.6 Storage

- If you do not intend to use the appliance for a long time, please store it carefully.
- Turn off and unplug the appliance. Wind the power cord around the cord storage hooks, and the hose around the hose storage hooks.

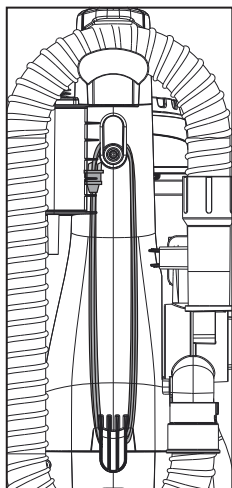

## 5 Guarantee

### 12 months breakdown and repair guarantee

Guarantor: **Beko plc, 1 Greenhill Crescent, Watford, Hertfordshire. WD18 8UF**

The guarantee does not in any way diminish your statutory or legal rights.

**Your appliance has the benefit of our manufacturer's guarantee which covers the product for 12 months from the date of original purchase.**

This gives you reassurance that if within that time, your appliance is proven to be defective because of either workmanship or materials, we will at our discretion either repair or replace your appliance.

The appliance must be correctly installed, located and operated in accordance with the instructions contained in the user manual. The guarantor disclaims any liability for accidental or consequential damage.

The Guarantee is subject to the following conditions:

- Documentary proof of the original purchase date is provided.
- The appliance has been installed and operated correctly in accordance with our operating and maintenance instructions.
- The appliance is used only on the electricity supply shown on the rating plate.
- The appliance has only been used for normal domestic purposes.
- The appliance has not been altered, serviced, dismantled or otherwise interfered with by any person.
- The appliance is used in the United Kingdom or the Republic of Ireland.
- Any parts removed during repair work or any product that has been replaced becomes our property.
- The guarantee is not transferrable if the product is resold.

The Guarantee does not cover:

- Transit, installation or delivery damage.
- Accidental damage.
- Misuse or abuse.
- Replacement of any consumable item or accessories. These include but are not limited to: plugs, cables, light bulbs, knobs, filters and flaps.
- Repairs or replacements required as a result of unauthorised repairs or inexpert installation that fails to meet the requirements contained in the user guide or instruction book.
- Repairs to products used in commercial or non-residential household premises.

### How to obtain after sales service, help or general advice

**Please keep your purchase receipt or other proof of purchase in a safe place as you will need to show us this document if your product requires attention within the guarantee period.**

Please also record your product details below, which will allow you to access our services more quickly and help us identify your product. The model number is printed on the front of the user guide and the serial and model number is shown on your products rating plate.

Model number	Serial number	Purchased from	Date of purchase

Please call our UK based Customer Service department if you need urgent help or advice from us:

United Kingdom and Northern Ireland: **0333 207 9710**  
Republic of Ireland: **01 862 3411**  
You can also contact us through our website: **[www.beko.co.uk](http://www.beko.co.uk)**

