

SAMSUNG

WAM5500/WAM3500/WAM1500

Wireless Audio - 360 R5/R3/R1 User Manual

imagine the possibilities

Thank you for purchasing this Samsung product.
To receive more complete service,
please register your product at
www.samsung.com/register

Contents

GETTING STARTED

| | |
|---|---|
| Accessories..... | 3 |
| Speaker Top..... | 3 |
| Operation Terminology | 3 |
| OLED Display and LED Indicator Descriptions..... | 5 |
| Speaker Bottom..... | 6 |
| Connecting the Power Cord..... | 7 |
| Installing on a wall | 8 |

CONNECTING TO A WI-FI NETWORK

| | |
|--|----|
| Connecting to Bluetooth Devices | 9 |
| Connecting TV to the speaker | 11 |
| Connecting to TV via bluetooth (TV SoundConnect)..... | 11 |

APPENDIX

| | |
|----------------------------------|----|
| Troubleshooting..... | 12 |
| Open Source Licence Notice | 14 |
| Licences..... | 14 |
| Specifications | 14 |

| | |
|--|----|
| Regulatory Compliance Statements | 16 |
| Warning | 16 |
| CAUTION..... | 16 |
| Wiring the Main Power Supply Plug (UK Only) | 17 |
| Safety precautions..... | 18 |
| Power Supply Precautions | 18 |
| Installation Precautions | 18 |
| Usage Precautions..... | 19 |
| Cleaning Precautions | 20 |
| Additional Information | 20 |
| About the Network Connection..... | 20 |
| Works with SmartThings™..... | 20 |
| Copyright | 20 |

Getting Started

Accessories

Confirm you have the supplied accessories shown below.

- WAM5500/WAM3500

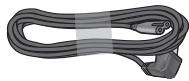

Power Cord

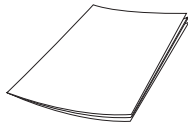

Quick Setup Guide

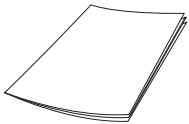

Regulatory Guide

- WAM1500



Power Cord

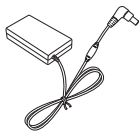

Power Adapter

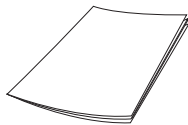

Quick Setup Guide

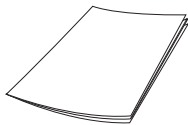

Regulatory Guide



CAUTION

✓ Do not place any items on top off or sit on the main unit.

Speaker Top

Operation Terminology

Touch/Tap



Touch and Hold



Swipe

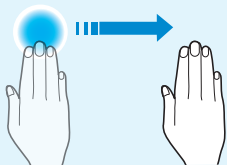
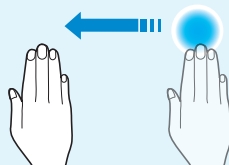

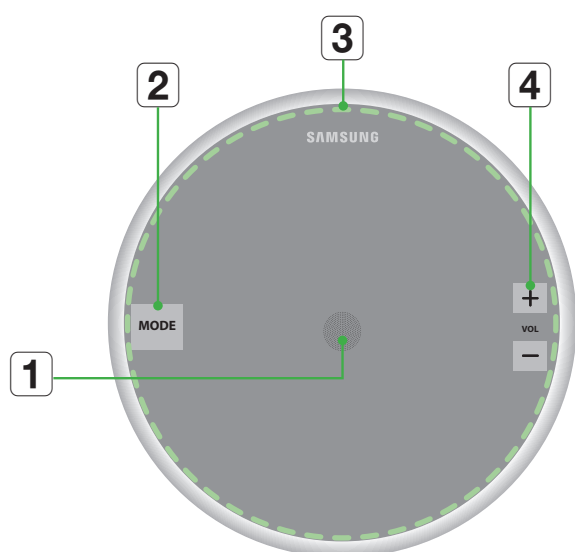

< WAM5500/WAM3500 >

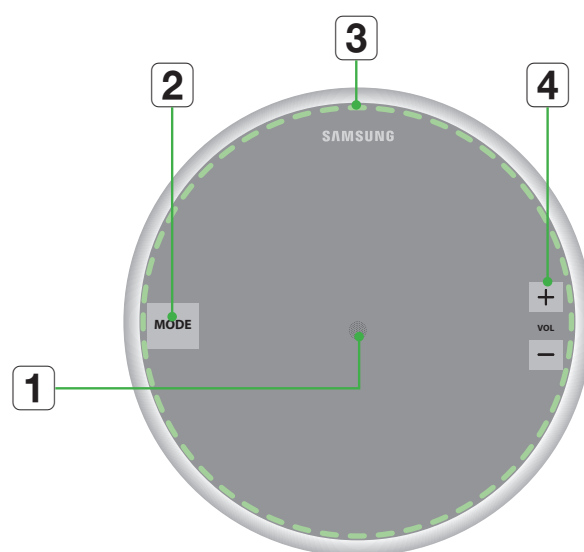

< WAM1500 >

| | | | |
|---|-------------------|---------------------|---|
| 1 | Display | WAM5500/ WAM3500 | Displays the current status. |
| | Indicator | WAM1500 | Flashes, glows, or changes colour depending on the speaker's status. |
| 2 | MODE Button | | Toggle between the TV SoundConnect, Bluetooth and Wi-Fi modes. |
| 3 | Touch Area | | <p>Tap in the Touch Area to play music or to pause playback. Tap to mute the sound if the TV SoundConnect function is enabled.</p> <ul style="list-style-type: none"> • Play/Pause : Tap the Touch Area to toggle between playback and pause. • Mute : If TV SoundConnect is enabled, tap the Touch Area to mute or unmute the sound. • Previous/Next Song : Swipe LEFT TO RIGHT to play the next song. Swipe RIGHT TO LEFT to play the previous song. • Standby mode : Touch and hold anywhere in the Touch Area for 5 seconds. Touch the touch area to wake the speaker up. • Power Off : Touch and hold anywhere in the Touch Area for 10 seconds. Touch the touch area to turn the speaker back on. |
| 4 | Volume +,- Button | | To adjust the volume rapidly, touch and hold + or - key. |















NOTE

- ✓ To reset the speaker, touch and hold the Volume (-,+) button at the same time for 5 seconds.

■ OLED Display and LED Indicator Descriptions

<R3/R5 OLED indicator>

| OLED Display | Description | Indicated Action |
|---|--|---|
|  | Circle size increases or decreases, then fades out | Power on / Wake-up / Power off |
|  | Play icon | Play |
|  | Pause icon | Pause |
|  | Volume status | Volume up or down |
|  | Wave moves to the right | Next song |
|  | Wave moves to the left | Previous song |
|  | Mute icon | Mute (from the App or by tapping in the Touch Area when TV SoundConnect is active.) |
|  | Group icon (Two circles partially overlapped) | Group/Surround mode |
|  | Ungroup icon (Two circles separated) | Un-Group/Release Surround mode |
|  | Bluetooth icon (blinking) | Bluetooth Pairing |
|  | TV icon (blinking) | TV SoundConnect Pairing |
|  | Exclamation icon | Wireless router disconnected |
|  | Wi-Fi Pairing | Wi-Fi mode |

<R1 LED indicator>

| LED Colour | Description | Indicated Action |
|-------------------|----------------------|--|
| White | ON | 1) Power On 2) Volume max/min |
| | Flashing | 1) Touch control 2) Wake up 3) Any connecting or group action 4) StandBy Mode (fade in/out repeatedly then after a few hours, auto off) |
| Red | Flashing (6 seconds) | Wireless router disconnected |
| Off | All off | Power Off |

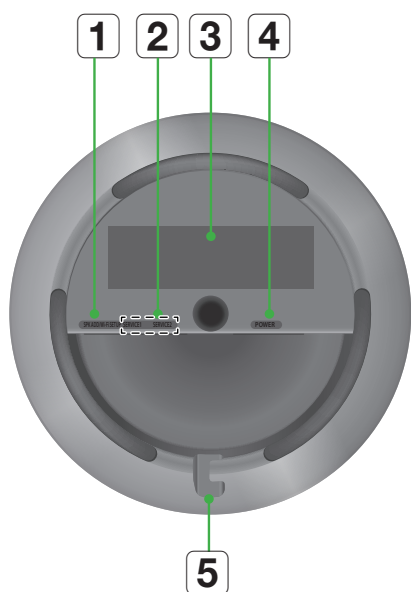

< WAM5500 >

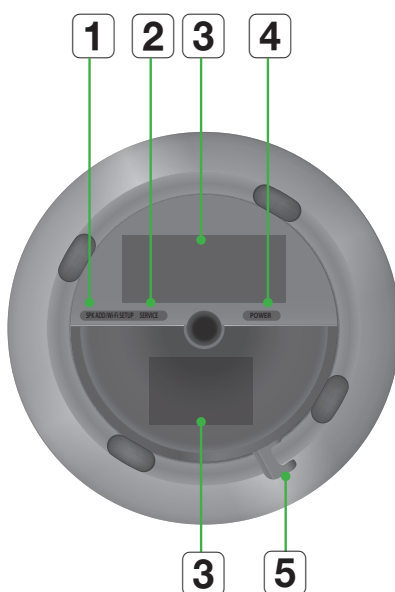

< WAM3500 >

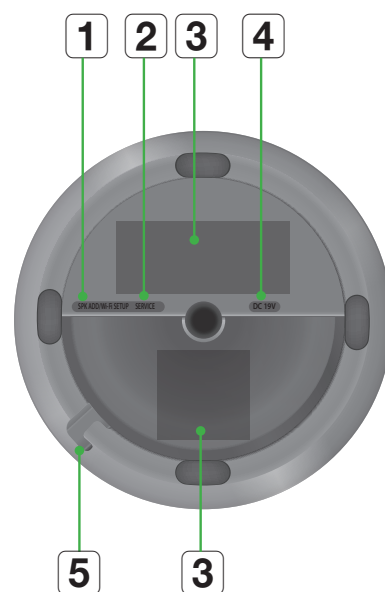

< WAM1500 >

| | | |
|---|-----------------------|---------------------|
| 1 | SPK ADD/Wi-Fi SETUP | |
| 2 | SERVICE | |
| 3 | Label | |
| 4 | POWER | WAM5500/ WAM3500 |
| | DC 19V | WAM1500 |
| 5 | Notch for Power Cable | |

- Press this button to pair your speaker with a HUB (Not Included) or add another speaker.
- Press and hold this button for more than 5 seconds when connecting the speaker to your network using the Wi-Fi Setup method. (Requires a smart device and the Samsung Multiroom app.)

For service only.

-

Connection for the product's power cord.

-

■ Connecting the Power Cord

<WAM5500, WAM3500 Only>

- 1 Connect the power cord of your speaker as shown. It will connect at an angle.
- 2 Push the power cord into the notch at the edge of the speaker bottom. This lets the speaker rest flat when you stand it up.

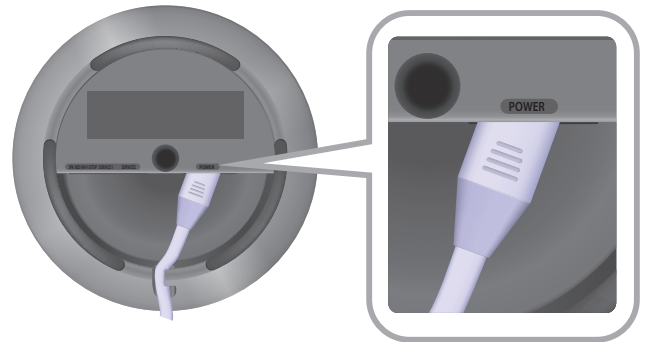

<WAM1500 Only>

- 1 Connect the adaptor's input power cord to the adaptor.
- 2 Connect the adaptor's output power cord (with the round plug) to the DC 19V jack on the speaker.
- 3 Push the power cord into the notch at the edge of the speaker bottom. This lets the speaker rest flat when you stand it up.

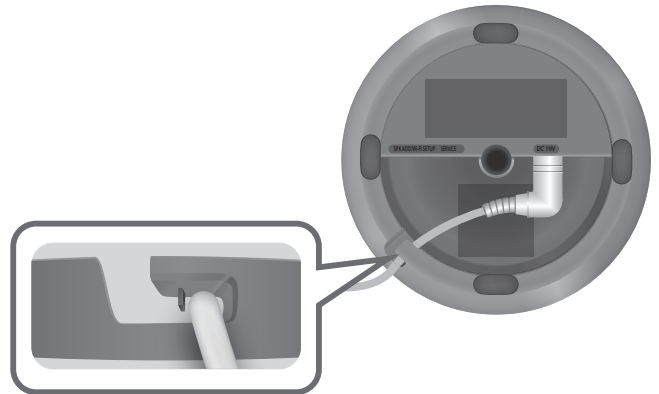

NOTE

- ✓ Make sure to rest the AC/DC Adapter flat on a table or the floor. If you place the AC/DC Adapter so that it is hanging with the AC cord input facing upwards, water or other foreign substances could enter the Adapter and cause the Adapter to malfunction.

Installing on a wall

You can purchase a wall mount separately to install the speaker on a wall if you want.

■ Considerations for purchasing

- Endurable load : WAM5500 : Above 10.8 Kg
WAM3500 : Above 8.0 Kg
WAM1500 : Above 5.6 Kg
- Hole size : 1/4 - 20 threaded insert



NOTE

- ✓ Since Wall-mount installation is optional, you must purchase the corresponding accessories separately.
- ✓ Please have a qualified installer install the Wall Mount Bracket.
- ✓ Ask a professional installation company to mount your product on the wall.
- ✓ Check the strength of the wall before you install the Wall Mount Bracket. If the strength is insufficient, make sure to reinforce the wall before installing the Wall Mount Bracket and the speaker on the wall.
- ✓ For more information, please refer to the Wall Mount's manual.
- ✓ Samsung Electronics is not liable for any damage to the product due to the product being installed inappropriately.
- ✓ Please beware not to install the speaker being laid down or turned upside down.

Connecting to a Wi-Fi network

Connecting to Bluetooth Devices

You can connect the product to a Bluetooth device to enjoy the music stored in your Bluetooth device.

- 1 Touch the **MODE** button on top of the speaker one or more times until you hear “Bluetooth is ready.”

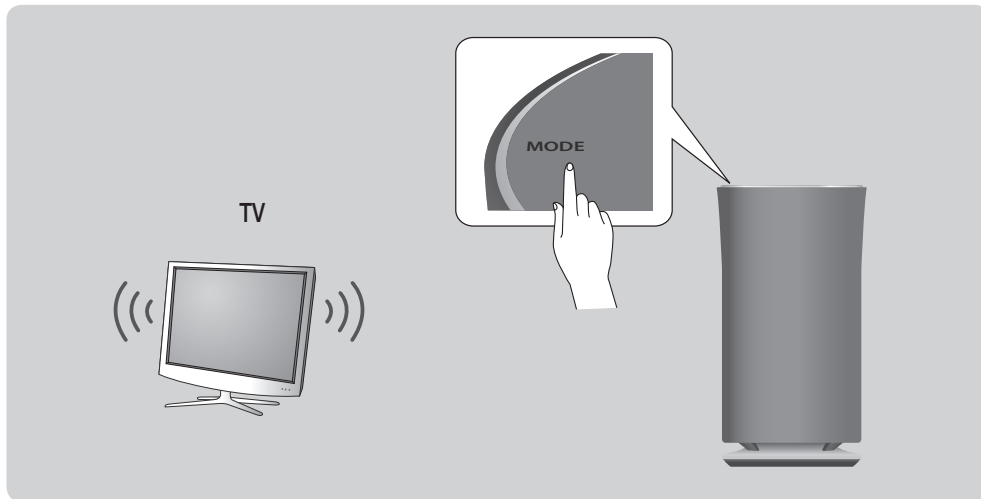

- 2 Turn on the Bluetooth function of your smart device, and then select **Search**.
- 3 Select the **[Samsung] R5**, **[Samsung] R3** or **[Samsung] R1**.
The Bluetooth connection between the smart device and the product is made.
- 4 Without connection with **Samsung Multiroom** app, you might see **Samsung Wireless Audio** on the Bluetooth device list. Select it.



NOTES

- ✓ A Bluetooth device may cause noise or malfunction, depending on usage, when:
 - A part of your body is in contact with the receiving/transmitting system of the Bluetooth device or the product.
 - It is subject to electrical variation from obstructions caused by a wall, corner, or by office partitioning.
 - It is exposed to electrical interference from same frequency-band devices including medical equipment, microwave ovens, and wireless LANs.
- ✓ Pair the product with the Bluetooth device while they are close together.
- ✓ Bluetooth connection mode, the Bluetooth connection will be lost if the distance between the product and the Bluetooth device exceeds 32 feet (10 m). Even within range, the sound quality may be degraded by obstacles such as walls or doors.

- ✓ This product may cause electric interference during its operation.
- ✓ The product supports SBC data (44.1kHz, 48kHz).
- ✓ In Bluetooth mode, the Play/Pause/Next/Prev functions are available in Bluetooth devices supporting AVRCP.
- ✓ Connect only to a Bluetooth device that supports the A2DP (AV) function.
- ✓ You cannot connect to a Bluetooth device that supports only the HF (Hands Free) function.
- ✓ Only one Bluetooth device can be paired at a time.
- ✓ If you unplug the product, the Bluetooth connection is terminated. To re-establish the connection, plug the product into an outlet, and then set the Bluetooth connection again.

Connecting TV to the speaker

■ Connecting to TV via bluetooth (TV SoundConnect)

TV SoundConnect function allows you to conveniently connect Samsung TV to external speaker(s) wirelessly and enjoy the TV sound.

- 1 Turn on the speaker, and then touch the **MODE** button on its top panel.

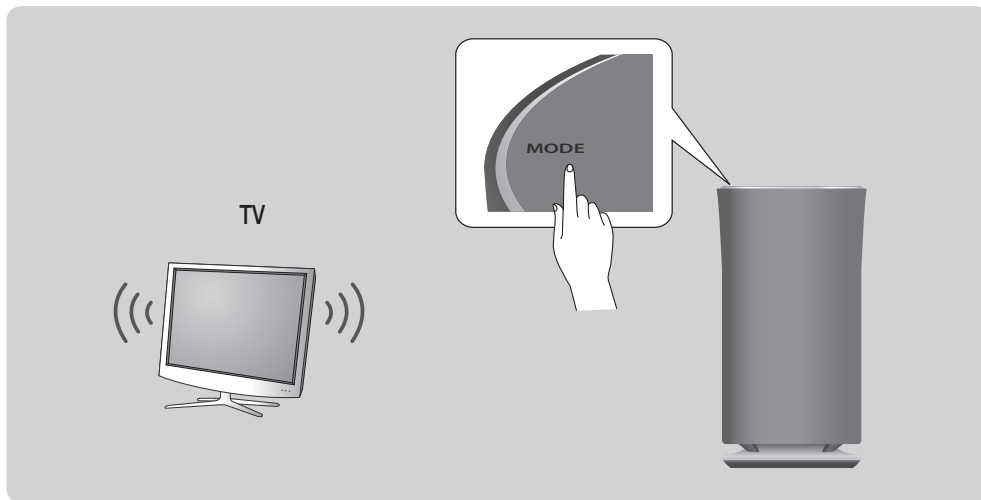

- 2 Touch and hold the **MODE** button for more than 5 seconds to reset TV SoundConnect.
- 3 A pop-up appears on the TV asking you to approve the connection. Approve to continue.



NOTES

- ✓ Optimal pairing distance is 6.5 feet(2 m) or less.
- ✓ If you unplug the WAM speaker, the TV SoundConnect connection is terminated. To re-establish the connection, plug the speaker into an outlet, and then touch the **MODE** button one or more times until you hear "TV SoundConnect is ready.". Then skip number 2 and 3 step. Speaker will output TV sound automatically.
- ✓ When the speaker is in Standby mode, the TV SoundConnect connection is not terminated. To connect new TV, follow above 1, 2, 3 steps.
- ✓ Operational range of TV SoundConnect
 - Recommended pairing range: up to 6.5 feet(2 m).
 - Recommended operating range: up to 32 feet(10 m).
 - The connection may be lost or sound may stutter if the distance between the TV and the product exceeds 32 feet(10 m).
- ✓ The SoundConnect feature is available on some Samsung TVs released since 2012. Check whether your TV supports the SoundShare or SoundConnect function. (For further details, refer to the TV's user's manual.)
- ✓ Instability in the network environment may cause connection to be lost or sound to stutter.

Appendix

Troubleshooting

Before requesting service, please check the following.

| Symptom | Check | Remedy |
|--|---|--|
| The unit will not turn on. | <ul style="list-style-type: none">Is the power cord plugged into the outlet? | <ul style="list-style-type: none">Connect the power cord to the outlet. |
| Hub and product is not paired. | <ul style="list-style-type: none">When the Hub is plugged in, do the HUB's front indicators show it's operating properly?Is the LAN cable connected to the wireless router and the HUB properly? | <ul style="list-style-type: none">Reset the HUB. (Refer to the HUB's user manual for details.) Unplug the HUB and plug it in again. Check whether the pairing indicator on the front of the HUB is blinking or not.Reset the product (see page 4). Click here. Unplug the product and plug it in again. |
| A function does not work when the button is pressed. | <ul style="list-style-type: none">Is there static electricity in the air? | <ul style="list-style-type: none">Disconnect the power plug and connect it again. |
| Sound is not produced. | <ul style="list-style-type: none">Is the volume set to minimum? | <ul style="list-style-type: none">Connect the product correctly.Adjust the volume. |
| The TV SoundConnect (TV pairing) failed. | <ul style="list-style-type: none">Does your TV support TV SoundConnect?Is your TV firmware the latest version?Does an error occur when connecting? | <ul style="list-style-type: none">TV SoundConnect is supported by some Samsung TVs released after 2012. Check your TV to see if it supports TV SoundConnect.Confirm TV SoundConnect is set to On in your TV's menu.Update your TV with the latest firmware.Contact the Samsung Call Centre.Touch and hold the MODE button for more than 5 seconds to reset TV SoundConnect and connect a new TV. |

| Symptom | Check | Remedy |
|-------------------------------|--|--|
| HUB doesn't work properly | <ul style="list-style-type: none"> • Is the HUB plugged in? • Is the LAN cable connected to the wireless router and the HUB properly? • When the Hub is plugged in, do the HUB's front indicators show it's operating properly? | <ul style="list-style-type: none"> • Plug in the HUB. • Connect the LAN cable to the ETHERNET SWITCH on the back of the HUB and to your wireless router. • Reset the HUB. (Refer to the HUB's user manual for details.) • If you experience troubles with connecting the HUB and product, try relocating the product so that the product is closer to the wireless router or HUB. |
| Product doesn't work properly | <ul style="list-style-type: none"> • Is the product plugged in? | <ul style="list-style-type: none"> • Plug in the product. • Unplug the product, plug it back in, and then reconnect it to the router. • Reset the product (see page 4). Click here. • If used with a HUB <ul style="list-style-type: none"> - Make sure the smart device and the HUB are connected to the same Wi-Fi network. - Make sure the HUB's indicator LED's show that it is working correctly. - If the problem persists, reset the HUB. (Refer to the HUB's user manual for details.) - Unplug, then plug in the HUB. Then, unplug and plug in the product. - If you experience troubles with connecting the HUB and product, try relocating the product so that the product is closer to the wireless router or HUB. |



NOTE

- ✓ If the problem persists, consult the service centre for troubleshooting.

Open Source Licence Notice

- For further information on Open Sources used in this product, please visit the website: <http://opensource.samsung.com>

Licences

- The Spotify Software is subject to third party licences found here : www.spotify.com/connect/third-party-licences.
- For more information about Spotify Connect, please visit www.spotify.com/connect





Specifications

| | | | |
|---------|--|---------------------|-----------------------|
| General | Weight | R5 (WAM5500) | 2.7 Kg |
| | | R3 (WAM3500) | 2.0 Kg |
| | | R1 (WAM1500) | 1.4 Kg |
| | Dimensions | R5 (WAM5500) | Ø166.0 X 313.0 (H) mm |
| | | R3 (WAM3500) | Ø144.0 X 273.0 (H) mm |
| | | R1 (WAM1500) | Ø123.0 X 234.0 (H) mm |
| | Operating Temperature Range | | +5°C to +35°C |
| | Operating Humidity Range | | 10 % to 75 % |
| Network | Wireless LAN | | Built-in |
| | Security | WEP (OPEN/SHARED) | |
| | | WPA-PSK (TKIP/AES) | |
| | | WPA2-PSK (TKIP/AES) | |
| | Overall Standby Power consumption (W) (When all network ports are set to on) | R5 (WAM5500) | 2.5W |
| | | R3 (WAM3500) | 3.6W |
| | | R1 (WAM1500) | 2.5W |
| | Touch and hold a touch area for 10 seconds to deactivate Wi-Fi and Bluetooth and turn the power off. | | |

- Network speeds equal to or below 10Mbps are not supported.
- Design and specifications are subject to change without prior notice.
- For the power supply and power consumption, refer to the label attached to the product.
- See product bottom for important safety information.

- Weight and dimensions are approximate.
 - This user manual is based on the product using the Android or iOS operating system.
 - App screen is based on Android operating system and it may change after you upgrade the software version.
 - For further details on using the product, visit www.samsung.com.
- An administration fee may be charged if either
 - (a) an engineer is called out at your request and there is no defect in the product (i.e. where you have failed to read this user manual).
 - (b) you bring the unit to a repair centre and there is no defect in the product (i.e. where you have failed to read this user manual).
 - The amount of such administration charge will be advised to you before any work or home visit is carried out.

Regulatory Compliance Statements

| | | |
|--|---|---|
|  | <div style="border: 1px solid black; padding: 5px; text-align: center;"> CAUTION RISK OF ELECTRIC SHOCK DO NOT OPEN </div> |  |
| <p>The lightning flash and arrowhead within the triangle is a warning sign alerting you to dangerous voltage inside the product.</p> | <p>CAUTION: TO REDUCE THE RISK OF ELECTRIC SHOCK, DO NOT REMOVE THE COVER (OR BACK). NO USER SERVICEABLE PARTS INSIDE. REFER SERVICING TO QUALIFIED SERVICE PERSONNEL.</p> | <p>The exclamation point within the triangle is a warning sign alerting you to important instructions accompanying the product.</p> |

Warning

- To reduce the risk of fire or electric shock, do not expose this appliance to rain or moisture.
- Do not expose this apparatus to dripping or splashing.
Do not put objects filled with liquids, such as vases on the apparatus.
- To turn this apparatus off completely, you must pull the power plug out of the wall socket.
Consequently, the power plug must be easily and readily accessible at all times.

CAUTION

TO PREVENT ELECTRIC SHOCK, MATCH WIDE BLADE OF PLUG TO WIDE SLOT, FULLY INSERT.

- This apparatus shall always be connected to a AC outlet with a protective grounding connection.
- To disconnect the apparatus from the mains, the plug must be pulled out from the mains socket, therefore the mains plug shall be readily operable.
- Do not expose this apparatus to dripping or splashing. Do not put an object filled with liquid, such as a vase, on the apparatus.
- To turn this apparatus off completely, you must pull the power plug out of the wall socket.
Consequently, the power plug must be easily and readily accessible at all times.

■ Wiring the Main Power Supply Plug (UK Only)

IMPORTANT NOTICE

The mains lead on this equipment is supplied with a moulded plug incorporating a fuse. The value of the fuse is indicated on the pin face of the plug and if it requires replacing, a fuse approved to BS1362 of the same rating must be used. Never use the plug with the fuse cover removed. If the cover is detachable and a replacement is required, it must be of the same colour as the fuse fitted in the plug. Replacement covers are available from your dealer. If the fitted plug is not suitable for the power points in your house or the cable is not long enough to reach a power point, you should obtain a suitable safety approved extension lead or consult your dealer for assistance. However, if there is no alternative to cutting off the plug, remove the fuse and then safely dispose of the plug. Do not connect the plug to a mains socket as there is a risk of shock hazard from the bared flexible cord. Never attempt to insert bare wires directly into a mains socket. A plug and fuse must be used at all times.

IMPORTANT NOTICE

The wires in the mains lead are coloured in accordance with the following code:– BLUE = NEUTRAL BROWN = LIVE As these colours may not correspond to the coloured markings identifying the terminals in your plug, proceed as follows:– The wire coloured BLUE must be connected to the terminal marked with the letter N or coloured BLUE or BLACK. The wire coloured BROWN must be connected to the terminal marked with the letter L or coloured BROWN or RED.

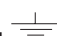
WARNING : DO NOT CONNECT EITHER WIRE TO THE EARTH TERMINAL WHICH IS MARKED WITH THE LETTER E OR BY THE EARTH SYMBOL , OR COLOURED GREEN OR GREEN AND YELLOW.

■ Important Safety Instructions

Read these operating instructions carefully before using the unit. Follow all the safety instructions listed below.

Keep these operating instructions handy for future reference.

- 1 Read these instructions.
- 2 Keep these instructions.
- 3 Heed all warnings.
- 4 Follow all instructions.
- 5 Do not use this apparatus near water.
- 6 Clean only with a dry cloth.
- 7 Do not block any ventilation openings. Install in accordance with the manufacturer's instructions.
- 8 Do not install near any heat sources such as radiators, heat registers, stoves, or other apparatus (including AV receivers) that produce heat.

- 9 Do not defeat the safety purpose of the polarized or grounding-type plug. A polarized plug has two blades with one wider than the other. A grounding type plug has two blades and a third grounding prong. The wide blade or the third prong are provided for your safety. If the provided plug does not fit into your outlet, consult an electrician for replacement of the obsolete outlet.
- 10 Protect the power cord from being walked on or pinched particularly at plugs, convenience receptacles, and the point where it exits the apparatus.
- 11 Only use attachments/accessories specified by the manufacturer.
- 12 Use only with the cart, stand, tripod, bracket, or table specified by the manufacturer, or sold with the apparatus. When a cart is used, use caution when moving the cart/apparatus combination to avoid injury from tip-over.
- 13 Unplug this apparatus during lightning storms or when unused for long periods of time.
- 14 Refer all servicing to qualified service personnel. Servicing is required when the apparatus has been damaged in any way, such as when the power-supply cord or plug is damaged, liquid has been spilled or objects have fallen into the apparatus, the apparatus has been exposed to rain or moisture, does not operate normally, or has been dropped.



Safety precautions

Power Supply Precautions

- Do not overload outlets or extension cords.
 - This may result in abnormal heat or fire.
- Do not plug in or unplug the power cord with wet hands.
- Do not place the product near heating equipment.
- To clean the power plug blades, remove the plug from the wall outlet and wipe the blades with a dry cloth only.
- Do not bend the power cord or pull it forcefully.
- Do not put heavy objects on the power cord.
- Do not plug the power cord into a loose or damaged outlet.
- Fully insert the power cord's plug into the the wall outlet so that the plug is firmly attached to the outlet.
 - If the connection is unstable, there is a risk of fire.

Installation Precautions

- Do not install the product near equipment or objects that generate heat or produce fire (candles, mosquito coils, heaters, radiators, etc.). Do not install in direct sunlight.
- When moving the product, turn off the power and disconnect all cords (include the power cord) from the unit.
 - A damaged cord may cause a fire and poses a risk of electric shock.
- Installing the product in environments with high heat or humidity, dust, or extreme cold, can lead to quality problems or cause the product to malfunction. Before you install the product in an environment that is outside the norm, please contact a Samsung service centre for additional information.

- When placing the product on a shelf, cabinet, or desk, make sure the top panel faces upwards.
- Do not place the product on an unstable surface (e.g. a shaky shelf, a tilted desk, etc.).
 - Dropping the product can cause it to malfunction and poses a risk of injury. Severe vibration or impact can also cause the product to malfunction and lead to a fire hazard.
- Install your product with enough space around it for ventilation.
 - Leave at least 4 inches (10cm) at the rear of the product and more than 2 inches (5cm) on each side of the product.
- Keep the plastic packing materials out of reach of your children.
 - Children playing with the plastic packing materials run the risk of suffocation.

■ Usage Precautions

- Using for an extended time at high volume may cause serious damage to your hearing.
 - If you are exposed to sound louder than 85db for an extended time, you may adversely affect your hearing. The louder the sound is, the more seriously damaged your hearing may become. Note that an ordinary conversation is between 50 to 60 db and road noise is approximately 80 db.
- This product contains dangerous high voltage. Do not attempt to disassemble, repair, or modify it yourself.
 - Contact a Samsung service centre when your product is in need of repair.
- Do not place any container that contains liquid on the product (e.g. a vase, beverages, cosmetics, chemicals, etc.). Do not allow any metal objects (e.g. coins, hair clips, etc.) or flammable material (e.g. paper, matches, etc.) to enter the product (through the air vents, I/O ports, etc.).
 - If any harmful material or liquid enters the product, turn off the product immediately, unplug the power cord, and then contact a Samsung service centre.
- Do not drop the product. In case of a mechanical breakdown, disconnect the power cord and contact a Samsung service centre.
 - There is a risk of fire or electric shock.
- Do not hold or pull the product by the power cord or the signal cable.
 - A damaged cable can cause the product to malfunction, cause a fire, and poses a risk of electric shock.
- Do not use or keep flammable materials near the product.
- If the product emits an abnormal sound or a burnt smell or smokes, unplug the power-cord immediately and contact a Samsung service centre.
- If you smell gas, ventilate the room immediately. Do not touch the power plug of the product. Do not turn the product off or on.
- Do not strike or subject the product to a sudden shock. Do not pierce the product with a sharp object.
- This product can be moved and placed indoors.
- This product is not waterproof or dustproof.
- Be careful when moving the product to avoid dropping it and possibly damaging it.

Cleaning Precautions

- Never use alcohol, solvents, waxes, benzene, thinners, air freshener, or lubricants to clean the product, or spray insecticide on the product.
 - Using any of these materials can discolor the exterior coating or cause it to split or peel off, or remove the labelling on the product.
- To clean the product, unplug the power cord, and then wipe the product with a clean, dry, soft cloth (Microfiber, cotton).
 - Avoid leaving dust on the product. Dust can scratch its the surface.

Additional Information

About the Network Connection

- Depending on the wireless router used, some network operations may perform differently.
- For detailed information on networking with a wireless router or modem, refer to the router's or modem's documentation.
- Select one wireless channel that is not used currently. If the selected channel is used by another communication device nearby, radio interference may result in communication failure.
- In compliance with the newest Wi-Fi certification specifications, the HUB does not support WEP, TKIP, or TKIP-AES (WPA2 Mixed) security encryption in networks running in the 802.11n mode.
- By its nature, wireless LAN may experience radio interference depending on the environmental conditions (such as wireless router performance, distance, obstruction, interference with other wireless devices, etc.)
- WEP encryption does not work with WPS (PBC) / WPS (PIN).

Works with SmartThings™

- This product is compatible with SmartThings.
- SmartThings service varies from country to country.
- For more information, visit <http://www.smartthings.com>

Copyright

© 2015 Samsung Electronics Co.,Ltd.

All rights reserved; No part or whole of this user's manual may be reproduced or copied without the prior written permission of Samsung Electronics Co.,Ltd.

- Hereby, Samsung Electronics, declares that this equipment is in compliance with the essential requirements and other relevant provisions of Directive 1999/5/EC.



The original Declaration of Conformity may be found at <http://www.samsung.com>, go to Support > Search Product Support and enter the model name. This equipment may be operated in all EU countries. This equipment may only be used indoors.



UNITED KINGDOM

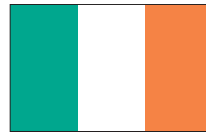

EIRE

This Samsung product is warranted for the period of twelve (12) months from the original date of purchase, against defective materials and workmanship. In the event that warranty service is required, you should return the product to the retailer from whom it was purchased. However, Samsung Authorised Dealers and Authorised Service Centres in other EC Countries will comply with the warranty on the terms issued to purchasers in the country concerned. In case of difficulty, details of our Authorised Service Centres are available from:

**Samsung Electronics U.K. Ltd
Samsung Customer Support Centre
Selectapost 38, Sheffield, S97 3FJ
United Kingdom**

**United Kingdom
Tel : 0330 SAMSUNG (7267864)
www.samsung.com/uk/support**

**EIRE
Tel : 0818 717100
www.samsung.com/ie/support**

■ WARRANTY CONDITIONS

1. The warranty is only valid if, when warranty service is required, the warranty card is fully and properly completed and is presented with the original invoice or sales slip or confirmation, and the serial number on the product has not been defaced.
2. Samsung's obligations are limited to the repair or, at its discretion, replacement of the product or the defective part.
3. Warranty repairs must be carried out by Authorised Samsung Dealers or Authorised Service Centres. No re-imbursement will be made for repairs carried out by non Samsung Dealers and, any such repair work and damage to the products caused by such repair work will not be covered by this warranty.
4. This product is not considered to be defective in materials nor workmanship by reason that it requires adaptation in order to conform to national or local technical or safety standards in force in any Country other than the one for which the product was originally designed and manufactured. This warranty will not cover, and no re-imbursement will be made for such adaptation nor any damage which may result.
5. This warranty covers none of the following:
 - a) Periodic check ups, maintenance and repair or replacement of parts due to normal wear and tear.
 - b) Cost relating to transport, removal or installation of the product.
 - c) Misuse, including the failure to use this product for its normal purposes or incorrect installation.
 - d) Damage caused by Lightning, Water, Fire, Acts of God, War, Public Disturbances, incorrect mains voltage, improper ventilation or any other cause beyond the control of Samsung.
6. This warranty is valid for any person who legally acquired possession of the product during the warranty period.
7. The consumers statutory rights in any applicable national legislation whether against the retailer arising from the purchase contract or otherwise are not affected by this warranty. Unless there is national legislation to the contrary, the rights under this warranty are the consumers sole rights and Samsung, its subsidiaries and distributors shall not be liable for indirect or consequential loss or any damage to records, compact discs, videos or audio taper or any other related equipment or material.

SAMSUNG ELECTRONICS (U.K.) LTD.

Contact SAMSUNG WORLD WIDE

If you have any questions or comments relating to Samsung products, please contact the SAMSUNG customer care centre.

| Country | | Contact Centre ☎ | Web Site |
|---------------|--------------------|--|--|
| North America | U.S.A | 1-800-SAMSUNG (726-7864) | www.samsung.com/us/support |
| | CANADA | 1-800-SAMSUNG (726-7864) | www.samsung.com/ca/support (English) www.samsung.com/ca_fr/support (French) |
| Latin America | MEXICO | 01-800-SAMSUNG (726-7864) | www.samsung.com/mx/support |
| | BRAZIL | 0800-124-421 (Demais cidades e regiões) 4004-0000 (Capitais e grandes centros) | www.samsung.com/br/support |
| | COSTA RICA | 0-800-507-7267 00-800-1-SAMSUNG (726-7864) | www.samsung.com/latin/support (Spanish) www.samsung.com/latin_en/support (English) |
| | DOMINICAN REPUBLIC | 1-800-751-2676 | www.samsung.com/latin/support (Spanish) www.samsung.com/latin_en/support (English) |
| | ECUADOR | 1-800-10-7267 1-800-SAMSUNG (72-6786) | www.samsung.com/latin/support (Spanish) www.samsung.com/latin_en/support (English) |
| | EL SALVADOR | 800-6225 800-0726-7864 | www.samsung.com/latin/support (Spanish) www.samsung.com/latin_en/support (English) |
| | GUATEMALA | 1-800-299-0013 1-800-299-0033 | www.samsung.com/latin/support (Spanish) www.samsung.com/latin_en/support (English) |
| | HONDURAS | 800-2791-9267 800-2791-9111 | www.samsung.com/latin/support (Spanish) www.samsung.com/latin_en/support (English) |
| | JAMAICA | 1-800-234-7267 1-800-SAMSUNG (726-7864) | www.samsung.com/latin_en/support (English) |
| | NICARAGUA | 001-800-5077267 | www.samsung.com/latin/support (Spanish) www.samsung.com/latin_en/support (English) |
| | PANAMA | 800-7267 800-0101 | www.samsung.com/latin/support (Spanish) www.samsung.com/latin_en/support (English) |
| | PUERTO RICO | 1-800-682-3180 | www.samsung.com/latin/support (Spanish) www.samsung.com/latin_en/support (English) |
| | TRINIDAD & TOBAGO | 1-800-SAMSUNG(726-7864) | www.samsung.com/latin/support (Spanish) www.samsung.com/latin_en/support (English) |
| | VENEZUELA | 0-800-SAMSUNG (726-7864) | www.samsung.com/ve/support |
| | COLOMBIA | Bogotá 600 12 72 Gratis desde cualquier parte del país 01 8000 112 112 | www.samsung.com/co/support |
| | CHILE | 800-SAMSUNG(726-7864) | www.samsung.com/cl/support |
| | BOLIVIA | 800-10-7260 | www.samsung.com/cl/support |
| | PERU | 0800-777-08 | www.samsung.com/pe/support |
| | ARGENTINE | 0800-555-SAMSUNG (0800-555-7267) | www.samsung.com/ar/support |
| | URUGUAY | 000-405-437-33 | www.samsung.com/latin/support (Spanish) www.samsung.com/latin_en/support (English) |
| | PARAGUAY | 009-800-542-0001 | www.samsung.com/latin/support (Spanish) www.samsung.com/latin_en/support (English) |
| Europe | UK | 0330 SAMSUNG (7267864) | www.samsung.com/uk/support |
| | EIRE | 0818 717100 | www.samsung.com/ie/support |
| | GERMANY | 0180 6 SAMSUNG bzw. 0180 6 7267864* (*0,20 €/Anruf aus dem dt. Festnetz, aus dem Mobil-funk max. 0,60 €/Anruf) | www.samsung.com/de/support |
| | FRANCE | 01 48 63 00 00 | www.samsung.com/fr/support |
| | ITALIA | 800-SAMSUNG (800.7267864) | www.samsung.com/it/support |
| | SPAIN | 0034902172678 | www.samsung.com/es/support |
| | PORTUGAL | 808 20 7267 | www.samsung.com/pt/support |

| Country | | Contact Centre ☎ | Web Site |
|---------|-------------|--|---|
| Europe | LUXEMBURG | 261 03 710 | www.samsung.com/support |
| | NETHERLANDS | 0900-SAMSUNG (0900-7267864) (€ 0,10/Min) | www.samsung.com/nl/support |
| | BELGIUM | 02-201-24-18 | www.samsung.com/be/support (Dutch) www.samsung.com/be_fr/support (French) |
| | NORWAY | 815 56480 | www.samsung.com/no/support |
| | DENMARK | 70 70 19 70 | www.samsung.com/dk/support |
| | FINLAND | 030-6227 515 | www.samsung.com/fi/support |
| | SWEDEN | 0771 726 7864 (0771-SAMSUNG) | www.samsung.com/se/support |
| | POLAND | 801-172-678* lub +48 22 607-93-33 * * (koszt połączenia według taryfy operatora) | www.samsung.com/pl/support |
| | HUNGARY | 0680SAMSUNG (0680-726-786) 0680PREMIUM (0680-773-648) | www.samsung.com/hu/support |
| | SLOVAKIA | 0800 - SAMSUNG (0800-726 786) | www.samsung.com/sk/support |
| | AUSTRIA | 0800-SAMSUNG (0800-7267864) [Only for Premium HA] 0800-366661 [Only for Dealers] 0810-112233 | www.samsung.com/at/support |
| | SWITZERLAND | 0800 726 78 64 (0800-SAMSUNG) | www.samsung.com/ch/support (German) www.samsung.com/ch_fr/support (French) |
| | CZECH | 800 - SAMSUNG (800-726786) | www.samsung.com/cz/support |
| | CROATIA | 072 726 786 | www.samsung.com/hr/support |
| | BOSNIA | 055 233 999 | www.samsung.com/support |
| | MONTENEGRO | 020 405 888 | www.samsung.com/support |
| | SLOVENIA | 080 697 267 (brezplačna številka) 090 726 786 (0,39 EUR/min) klicni center vam je na voljo od ponedeljka do petka od 9. do 18. ure. | www.samsung.com/si |
| | SERBIA | 011 321 6899 | www.samsung.com/rs/support |
| | BULGARIA | 800 111 31, Безплатна телефонна линия | www.samsung.com/bg/support |
| | ROMANIA | 08008 726 78 64 (08008 SAMSUNG) Apel GRATUIT | www.samsung.com/ro/support |
| CIS | CYPRUS | 8009 4000 only from landline, toll free | |
| | GREECE | 80111-SAMSUNG (80111 726 7864) only from land line | www.samsung.com/gr/support |
| | LITHUANIA | 8-800-77777 | www.samsung.com/lt/support |
| | LATVIA | 8000-7267 | www.samsung.com/lv/support |
| | ESTONIA | 800-7267 | www.samsung.com/ee/support |
| | RUSSIA | 8-800-555-55-55 (VIP care 8-800-555-55-88) | www.samsung.com/ru/support |
| | BELARUS | 810-800-500-55-500 | www.samsung.com/support |
| | GEORGIA | 0-800-555-555 | www.samsung.com/support |
| | ARMENIA | 0-800-05-555 | www.samsung.com/support |
| | AZERBAIJAN | 0-88-555-55-55 | www.samsung.com/support |
| | KAZAKHSTAN | 8-10-800-500-55-500 (GSM: 7799, VIP care 7700) | www.samsung.com/support |
| | UZBEKISTAN | 8-10-800-500-55-500 (GSM: 7799) | www.samsung.com/support |
| | KYRGYZSTAN | 00-800-500-55-500 | www.samsung.com/kz_ru/support |
| China | TAJIKISTAN | 8-10-800-500-55-500 | www.samsung.com/support |
| | MONGOLIA | +7-495-363-17-00 | www.samsung.com/support |
| | UKRAINE | 0-800-502-000 | www.samsung.com/ua/support (Ukrainian) www.samsung.com/ua_ru/support (Russian) |
| | MOLDOVA | 0-800-614-40 | www.samsung.com/support |
| China | CHINA | 400-810-5858 | www.samsung.com/cn/support |
| | HONG KONG | (852) 3698 4698 | www.samsung.com/hk/support (Chinese) www.samsung.com/hk_en/support (English) |
| | MACAU | 0800 333 | www.samsung.com/support |

| Country | | Contact Centre ☎ | Web Site |
|---------|---------------|---|--|
| S.E.A | SINGAPORE | 1800-SAMSUNG(726-7864) | www.samsung.com/sg/support |
| | AUSTRALIA | 1300 362 603 | www.samsung.com/au/support |
| | NEW ZEALAND | 0800 726 786 | www.samsung.com/nz/support |
| | VIETNAM | 1800 588 889 | www.samsung.com/vn/support |
| | THAILAND | 0-2689-3232, 1800-29-3232 | www.samsung.com/th/support |
| | MYANMAR | +95-01-2399-888 | www.samsung.com/support |
| | MALAYSIA | 1800-88-9999 603-77137477 (Overseas contact) | www.samsung.com/my/support |
| | INDONESIA | 021-56997777 08001128888 | www.samsung.com/id/support |
| | PHILIPPINES | 1-800-10-7267864 [PLDT] 02-4222111 [Other landline] | www.samsung.com/ph/support |
| | TAIWAN | 0800-329999 | www.samsung.com/tw/support |
| | JAPAN | 0120-363-905 | www.samsung.com/jp/support |
| S.W.A | INDIA | 1800 3000 8282 - Toll Free 1800 266 8282 - Toll Free | www.samsung.com/in/support |
| | BANGLADESH | 09612300300 | www.samsung.com/in/support |
| | SRI LANKA | 94117540540 | www.samsung.com/support |
| MENA | EGYPT | 08000-7267864 16580 | www.samsung.com/eg/support |
| | ALGERIA | 021 36 11 00 | www.samsung.com/n_africa/support |
| | IRAN | 021-8255 [CE] | www.samsung.com/iran/support |
| | SAUDI ARABIA | 8002474357 | www.samsung.com/sa/support www.samsung.com/sa_en/support (English) |
| | PAKISTAN | 0800-Samsung (72678) | www.samsung.com/pk/support |
| | TUNISIA | 80-1000-12 | www.samsung.com/n_africa/support |
| | U.A.E | 800-SAMSUNG (800 - 726 7864) | www.samsung.com/ae/support (English) www.samsung.com/ae_ar/support (Arabic) |
| | OMAN | 800-SAMSUNG (800 - 726 7864) | |
| | KUWAIT | 183-CALL (183-2255) | |
| | BAHRAIN | 8000-GSAM (8000-4726) | |
| | QATAR | 800-CALL (800-2255) | www.samsung.com/tr/support |
| | TURKEY | 444 77 11 | |
| | JORDAN | 0800-22273 06 5777444 | www.samsung.com/Levant/support (English) |
| | SYRIA | 18252273 | www.samsung.com/Levant/support (English) |
| | MOROCCO | 080 100 22 55 | www.samsung.com/n_africa/support |
| Africa | SOUTH AFRICA | 0860 SAMSUNG (726 7864) | www.samsung.com/support |
| | BOTSWANA | 8007260000 | |
| | NAMIBIA | 08 197 267 864 | |
| | ZAMBIA | 0211 350370 | |
| | MAURITIUS | 23052574020 | |
| | REUNION | 262508869 | |
| | MOZAMBIQUE | 847267864 / 827267864 | |
| | NIGERIA | 0800-726-7864 | www.samsung.com/africa_en/support |
| | Ghana | 0800-10077 0302-200077 | |
| | Cote D'Ivoire | 8000 0077 | www.samsung.com/africa_fr/support |
| | SENEGAL | 800-00-0077 | |
| | CAMEROON | 7095-0077 | www.samsung.com/support |
| | KENYA | 0800 545 545 | |
| | UGANDA | 0800 300 300 | |
| | TANZANIA | 0800 755 755 / 0685 889 900 | |
| | RWANDA | 9999 | |
| | BURUNDI | 200 | |
| | DRC | 499999 | |
| | SUDAN | 1969 | |

SAMSUNG



Correct Disposal of This Product (Waste Electrical & Electronic Equipment)

(Applicable in the European Union and other European countries with separate collection systems)

This marking on the product, accessories or literature indicates that the product and its electronic accessories (e.g. charger, headset, USB cable) should not be disposed of with other household waste at the end of their working life. To prevent possible harm to the environment or human health from uncontrolled waste disposal, please separate these items from other types of waste and recycle them responsibly to promote the sustainable reuse of material resources.

Household users should contact either the retailer where they purchased this product, or their local government office, for details of where and how they can take these items for environmentally safe recycling.

Business users should contact their supplier and check the terms and conditions of the purchase contract. This product and its electronic accessories should not be mixed with other commercial wastes for disposal.