

User Manual

GETTING STARTED? EASY.

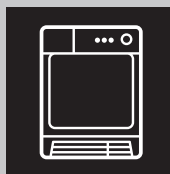

ZDH8903PZ

EN User Manual
Tumble Dryer

ZANUSSI

SAFETY INFORMATION

Before beginning the installation and use of this appliance, carefully read the supplied instructions. The manufacturer is not responsible for any injuries or damages that are the result of incorrect installation or usage. Always keep the instructions in a safe and accessible location for future reference.



- Read the supplied instructions.

CHILDREN AND VULNERABLE PEOPLE SAFETY



WARNING!

Risk of suffocation, injury or permanent disability.

- This appliance can be used by children aged from 8 years and above and persons with reduced physical, sensory or mental capabilities or lack of experience and knowledge if they have been given supervision or instruction concerning the use of the appliance in a safe way and understand the hazards involved.
- Children between 3 and 8 years of age and persons with very extensive and complex disabilities shall be kept away from the appliance unless continuously supervised.
- Children of less than 3 years of age should be kept away from the appliance unless continuously supervised.
- Do not let children play with the appliance.
- Keep all packaging away from children and dispose of it appropriately.
- Keep detergents away from children.
- Keep children and pets away from the appliance when the door is open.
- If the appliance has a child safety device, it should be activated.
- Children shall not carry out cleaning and user maintenance of the appliance without supervision.

GENERAL SAFETY

- Do not change the specification of this appliance.
- If the tumble dryer is put on top of a washing machine, use the stacking kit. The stacking kit, available from your authorized

vendor, can be used only with the appliance specified in the instructions supplied with the accessory. Read it carefully before installation (refer to the Installation leaflet).

- The appliance can be installed as freestanding or below a kitchen counter with correct space (refer to the Installation leaflet).
- Do not install the appliance behind a lockable door, a sliding door or a door with a hinge on the opposite side, that would prevent the appliance door from being fully open.
- The ventilation opening in the base must not be covered by a carpet, mat, or any floor covering.
- **WARNING:** The appliance must not be supplied through an external switching device, such as a timer, or connected to a circuit that is regularly switched on and off by a utility.
- Connect the mains plug to the mains socket only at the end of the installation process. Make sure that the mains plug is accessible after installation.
- If the mains power supply cable is damaged, it must be replaced by the manufacturer, its Authorised Service Centre or similarly qualified persons to avoid an electrical hazard.
- Do not exceed the maximum load of 8 kg (refer to the "Programme chart" chapter).
- Do not use the appliance if items have been soiled with industrial chemicals.
- Wipe away lint or packaging debris that has accumulated around the appliance.
- Do not run the appliance without a filter. Clean the lint filter before or after each use.
- Do not dry unwashed items in the tumble dryer.
- Items that have been soiled with substances such as cooking oil, acetone, alcohol, petrol, kerosene, spot removers, turpentine, waxes and wax removers should be washed in hot water with an extra amount of detergent before being dried in the tumble dryer.
- Items such as foam rubber (latex foam), shower caps, waterproof textiles, rubber backed articles and clothes or

pillows fitted with foam rubber pads should not be dried in the tumble dryer.

- Fabric softeners, or similar products, should only be used as specified by the product manufacturer's instructions.
- Remove all objects from items that could be a source of fire ignition such as lighters or matches.
- **WARNING:** Never stop a tumble dryer before the end of the drying cycle unless all items are quickly removed and spread out so that the heat is dissipated.
- Before any maintenance operation, deactivate the appliance and disconnect the mains plug from the socket.

SAFETY INSTRUCTIONS

INSTALLATION

- Remove all the packaging.
- Do not install or use a damaged appliance.
- Follow the installation instructions supplied with the appliance.
- Always take care when moving the appliance as it is heavy. Always use safety gloves and enclosed footwear.
- Do not install or use the appliance where the temperature can be lower than 5°C or higher than 35°C.
- The floor area on which the appliance is to be installed must be flat, stable, heat resistant and clean.
- Make sure that there is air circulation between the appliance and the floor.
- Always keep the appliance vertical when it is being moved.
- The rear surface of the appliance must be put against a wall.
- When the appliance is in its permanent position, check if it is levelled correctly with the aid of a spirit level. If it is not, adjust the feet accordingly.

ELECTRICAL CONNECTION



WARNING! Risk of fire and electric shock.

- Connect the mains plug to the mains socket only at the end of the installation. Make sure that there is access to the mains plug after the installation.
- The appliance must be earthed.

- Make sure that the parameters on the rating plate are compatible with the electrical ratings of the mains power supply.
- Always use a correctly installed shockproof socket.
- Do not use multi-plug adapters and extension cables.
- Do not pull the mains cable to disconnect the appliance. Always pull the mains plug.
- Do not touch the mains cable or the mains plug with wet hands.
- This appliance complies with the E.E.C. Directives.

USE



WARNING! Risk of injury, electric shock, fire, burns or damage to the appliance.

- This appliance is for household use only.
- Do not dry damaged (torn, frayed) items that contain padding or fillings.
- Only dry fabrics which are suitable for drying in a tumble dryer. Follow the instructions on the fabric label.
- If you have washed your laundry with a stain remover start an extra rinse cycle before you start the dryer.
- Do not drink or prepare food with the condensed water/distilled water. It can cause health problems to people and pets.
- Do not sit or stand on the open door of the appliance.
- Do not dry dripping wet clothes in a tumble dryer.

CARE AND CLEANING



WARNING! Risk of injury or damage to the appliance.

- Do not use water spray and steam to clean the appliance.
- Clean the appliance with a moist soft cloth. Only use neutral detergents. Do not use any abrasive products, abrasive cleaning pads, solvents or metal objects.
- To prevent damage to the cooling system be careful when you clean the appliance.

COMPRESSOR



WARNING! Risk of damage to the appliance.

- The compressor and its system in the tumble dryer is filled with the special agent which is free from fluoro-chloro-hydrocarbons. This system must stay tight. The damage of the system can cause a leakage.

DISPOSAL



WARNING! Risk of injury or suffocation.

- Disconnect the appliance from the mains electrical and water supplies.
- Cut off the mains electrical cable close to the appliance and dispose of it.
- Remove the door catch to prevent children or pets from becoming trapped in the drum.
- Dispose of the appliance in accordance with local requirements for the disposal of Waste Electrical and Electronic Equipment (WEEE).

EASY START

PRODUCT DESCRIPTION

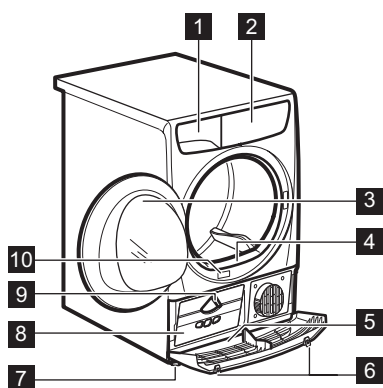

- 1 Water container
- 2 Control panel
- 3 Appliance door
- 4 Primary Filter
- 5 Bottom cover with the airflow slots



WARNING! Do not put any object on the bottom cover

- 6 Buttons to open the bottom cover
- 7 Adjustable feet
- 8 Heat exchanger door
- 9 Knob to lock the heat exchanger door
- 10 Rating plate



For ease of loading laundry or ease of installation the door is reversible. (see separate leaflet).

CONTROL PANEL

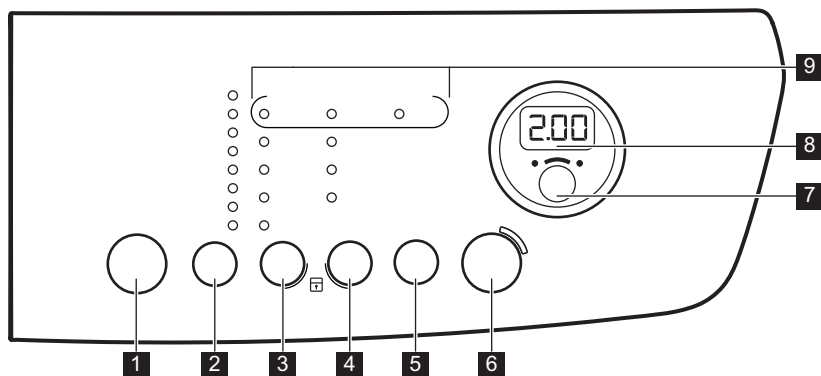

- 1 On / Off button ①
- 2 Programme selection touchpad **P**
- 3 Dryness selection touchpad ☀
- 4 Anticrease selection touchpad ⌚
- 5 Time touchpad ⌚
- 6 Start/Pause touchpad ▶||
- 7 Delay touchpad ↻
- 8 Display
- 9 Indicators



Press the touch buttons with your finger in the area with the symbol or name of the option. Do not wear gloves when you operate the control panel. Make sure that the control panel is always clean and dry.

Indicators

Indicators	Description
	Time Drying
	Child lock
	Condenser
	Water container
	Filter
2.00	Programme duration
10' - 2.00	Time Drying duration
60' - 20h	Delay start duration

PROGRAMME TABLE

Programmes	Type of load	Load (max.) ¹⁾ / Fabric mark
²⁾ Cottons Eco	Cycle to be used to dry cotton with "cotton cupboard" dryness level, with maximum energy saving.	8kg/
Cottons	Cycle defined to dry all types of cotton ready to store (cupboard dry).	8kg/
Synthetics	Drying level: Extra Dry, Cupboard Dry, Iron Dry	3,5kg/
Mix	Cotton and synthetic fabrics. Low temperature programme. Delicate programme with warm air.	3kg/
Easy Iron+	Easy care fabrics for which a minimum of ironing is necessary. The drying results can be different from one type of fabric to another. Shake the items before putting them in the appliance. When the programme has ended, immediately remove the items and put them on a hanger.	1kg (or 5 shirts)/

Programmes	Type of load	Load (max.) ¹⁾ / Fabric mark
Duvet	Single or double duvets and pillows (with feather, down or synthetic fillings).	3kg/ ☼☼☼
Refresh	Refreshing textiles that were in storage.	1kg
Time Drying	With this programme you can use the Time option and set the programme duration.	8kg/ ☼☼☼

1) The maximum weight refers to dry items.

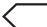
2) The  Cottons Cupboard Dry ECO programme is the “Standard cotton programme” according to Commission Regulation EU No. 392/2012. It is suitable for drying normal wet cotton laundry and it is the most efficient programme in terms of energy consumption for drying wet cotton laundry.

OPTIONS

DRYNESS ☼☼

This function helps to get the laundry more dried.

There are 4 possible selections:

- ☼ Extra Dry
- ☼☼ Strong Dry (for Cotton only)
- ☼☼☼ Cupboard Dry
- ☼☼☼ Iron Dry

ANTICREASE 90 MIN

Extends the anti-crease phase by 60 minutes at the end of the drying cycle. This function reduces creases. The laundry can be removed during the anti-crease phase.

ANTICREASE 60 MIN

Extends of 30 minutes the standard anticrease phase (30 minutes) at the end of the drying cycle. This function prevents the laundry from creases.

The laundry can be removed during the anticrease phase.

ANTICREASE 30 MIN

Anticrease phase (30 minutes) at the end of the drying cycle. This function prevents the laundry from creases. The laundry can be removed during the anticrease phase.

TIME

This option is applicable only to the Time Drying programme. You can set the programme duration, from a minimum of 10 minutes to a maximum of 2 hours. The setting of the duration is related to the quantity of laundry in the appliance.



We recommend that you set a short duration for small quantities of laundry or for only one item.

OPTIONS TABLE

Programmes	☀				⌚			🔊
	☀	☀	☀	☀	Anti-crease 90 min	Anti-crease 60 min	Anti-crease 30 min	
👉 Cottons Eco			■		■	■	■	
Cottons	■	■	■	■	■	■	■	
Synthetics	■		■	■	■	■	■	
Mix			■		■	■	■	
Easy Iron+				■	■	■	■	
Duvet			■					
Refresh					■	■	■	
Time Drying					■	■	■	■

SETTINGS

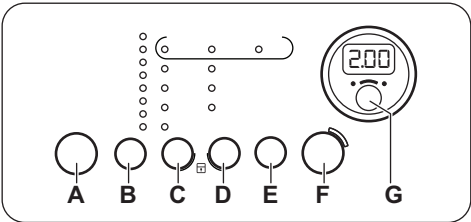

- A.** On / Off button ⏻
- B.** Programme selection touchpad **P**
- C.** Dryness selection touchpad ☀
- D.** Anticrease selection touchpad ⌚
- E.** Time touchpad ⌚
- F.** Start/Pause touchpad ▶||
- G.** Delay touchpad ⌚

CHILD LOCK FUNCTION

This option prevents children to play with the appliance while a programme operates. The programme knob and the touchpads are locked. Only the on/off button is unlocked.

Activating the child lock option:

- Press the on/off button to activate the appliance.
 - Wait approximately 8 seconds.
 - Press and hold touchpads **(C)** and **(D)** at the same time. The child lock indicator comes on.
- The child lock indicator comes on.

i It is possible to deactivate the child lock option while a programme operates. Press and hold the same touchpads until the child lock indicator goes off.

BUZZER ON/OFF

To deactivate or activate the acoustic signals, press and hold for approximately 2 seconds touch buttons **(B)** and **(C)** at the same time.



ADJUSTMENT OF THE REMAINING LAUNDRY MOISTURE DEGREE

To change the default degree of the remaining moisture of the laundry:

- Press the on/off button to activate the appliance.
- Wait approximately 8 seconds.

3. Press and hold buttons **(B)** and **(D)** at the same time.

One of these indicators comes on:

-  the maximum dry laundry
-  the more dry laundry
-  the standard dry laundry

4. Press the button **(F)** again and again until the indicator of the correct level comes on.
5. To confirm the adjustment, press and hold buttons **(B)** and **(D)** at the same time for approximately 2 seconds.

BEFORE FIRST USE

Before you use the appliance for the first time:

- Clean the tumble dryer drum with a moist cloth.
- Start a 1 hour programme with moist laundry.



At the beginning of the drying cycle (first 3-5 min) there could be a slightly higher sound level. This is due to the compressor starting up. This is normal for compressor powered appliances such as refrigerators and freezers.

DAILY USE

START A PROGRAMME WITHOUT DELAY START

1. Prepare the laundry and load the appliance.



CAUTION! Make sure that when you close the door, the laundry does not get caught between the appliance door and the rubber seal.

2. Press the on/off button to activate the appliance.
3. Set the correct programme and options for the type of load.

The display shows the programme duration.



The drying time you see on the display, when the cotton programme is selected, is related to the load of 5 kg and standard conditions. Real drying time will depend on type of the load (quantity and composition), the room temperature and the humidity of your laundry after spin drying phase.

4. Press the Start/Pause touch button.

The programme starts.

STARTING THE PROGRAMME WITH DELAY START

1. Set the correct programme and options for the type of load.
2. Press the delay start button again and again until the display shows the delay time you want to set.



You can delay the start of a programme from a minimum of 60 minutes to a maximum of 20 hours.

3. Press the Start/Pause touchpad.

The display shows the countdown of the delay start.

When the countdown is completed, the programme starts.

CHANGE A PROGRAMME

1. Press the on/off button to deactivate appliance
2. Press the on/off button to activate the appliance.
3. Set the programme.



STAND-BY FUNCTION

To decrease the energy consumption, this function automatically deactivates the appliance:

- After 5 minutes if you do not start the programme.
- After 5 minutes from the end of the programme.

AT THE END OF THE PROGRAMME

When the programme is completed:



- An intermittent acoustic signal operates.
- The indicator  flashes.
- The indicators  Filter and  Tank comes on.
- The Start/Pause indicator is on.

The appliance continues to operate with the crease guard phase for approximately other 30 minutes.

The crease guard phase removes creases from your laundry.

You can remove the laundry before the crease guard phase is completed. We recommend, for better results, that you remove the laundry when the phase is almost completed or completed.

When the crease guard phase is completed:

- The indicator  is on but does not flash.
- The indicators  Filter and  Tank comes on.
- Start/Pause indicator goes off.

1. Press the on/off button to deactivate the appliance.
2. Open the appliance door.
3. Remove the laundry.
4. Close the appliance door.







Always clean the filter and empty the water container when a programme is completed.

HINTS AND TIPS

PREPARING THE LAUNDRY

- Close the zips.
 - Close the fasteners of duvet covers.
 - Do not dry ties or ribbons loose (e.g. apron ribbons). Tie them before you start a programme.
 - Remove all items from pockets.
 - Turn items with the internal layer made of cotton inside out. Cotton layer must be faced outwards.
 - Always set the programme suitable for the type of laundry.
- Do not put light and dark colours together.
 - Use suitable programme for cottons, jersey and knitwear to reduce shrinkage.
 - Do not exceed the maximum load stated in the programmes chapter or shown on the display.
 - Dry only the laundry that is suitable for tumble drying. Refer to the fabric label on the items.
 - Do not dry large and small items together. Small items can be trapped inside the large items and remain wet.

Fabric label	Description
	Laundry is suitable for tumble drying.
	Laundry is suitable for tumble drying at higher temperatures.
	Laundry is suitable for tumble drying at low temperatures only.
	Laundry is not suitable for tumble drying.

CARE AND CLEANING

CLEANING THE FILTER

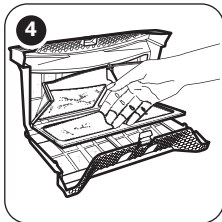
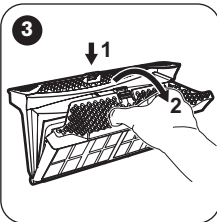
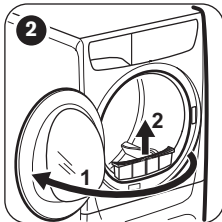
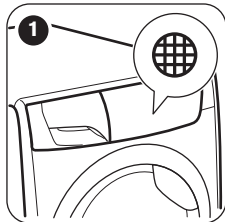

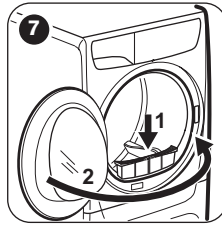
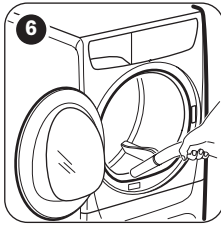
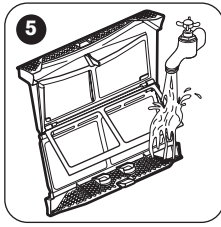

DRAINING THE WATER CONTAINER

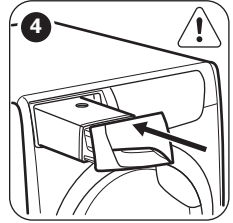
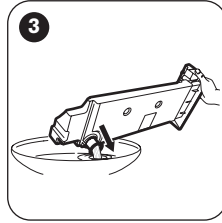
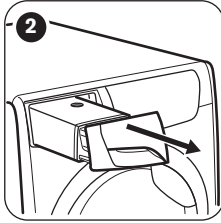
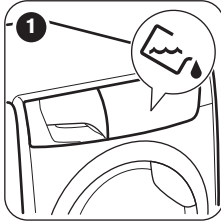

i You can use the water from the water container as an alternative to distilled water (e.g. for steam ironing). Before you use the water, remove dirt residues with a filter.

CLEANING THE CONDENSER

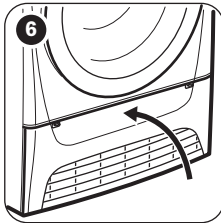
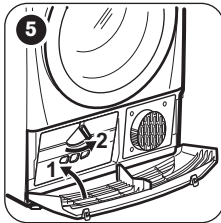
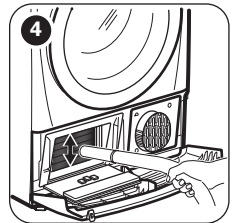
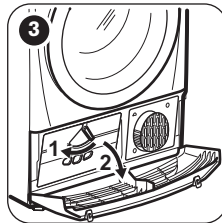
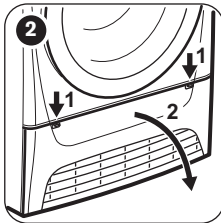
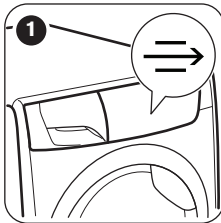

! **CAUTION!** Do not touch the metal surface with bare hands. Risk of injury. Wear protective gloves. Clean carefully to avoid damaging the metal surface.

CLEANING THE DRUM

! **WARNING!** Disconnect the appliance before you clean it.

Use a standard neutral soap detergent to clean the inner surface of the drum and drum lifters. Dry the cleaned surfaces with a soft cloth.



CAUTION! Do not use abrasive materials or steel wool to clean the drum.

CLEANING THE CONTROL PANEL AND HOUSING

Use a standard neutral soap detergent to clean the control panel and housing.

Use a moist cloth to clean. Dry the cleaned surfaces with a soft cloth.



CAUTION! Do not use furniture cleaning agents or cleaning agents which can cause corrosion.

CLEANING THE AIRFLOW SLOTS

Use a vacuum cleaner to remove fluff from the airflow slots.

TROUBLESHOOTING

Problem	Possible solution
You cannot activate the appliance.	Make sure that the mains plug is connected to the mains socket.
	Check fuse in fuse box (domestic installation).
The programme does not start.	Press Start/Pause.
	Make sure that the appliance door is closed.
The appliance door does not close.	Make sure that the installation of the filter is correct.
	Make sure that the laundry does not catch between the appliance door and the rubber seal.
The appliance stops during operation.	Make sure that the water container is empty. Press Start/Pause to start the programme again.
The cycle time is too long or unsatisfactory drying result. ¹⁾	Make sure that the weight of the laundry is applicable to the duration of the programme.
	Make sure that the filter is clean.
	The laundry is too wet. Spin the laundry in the washing machine again.
	Ensure that the room temperature is higher than +5°C and lower than +35°C. Optimal room temperature is 19°C to 24°C.
	Set the Time Drying or the Extra Dry programme. ²⁾
The display shows Err .	If you want to set a new programme, deactivate and activate the appliance.
	Make sure that the options are applicable to the programme.

Problem	Possible solution
The display shows (e.g. E51).	Deactivate and activate the appliance. Start a new programme. If the problem occurs again, contact the Service.

1) After maximum 5 hours, the programme ends automatically.

2) It can happen that some area remains humid when drying big items (e.g. bed sheets).

If the drying results are not satisfactory

- The set programme was incorrect.
- The filter is clogged.
- The condenser is clogged.
- There was too much laundry in the appliance.
- The drum is dirty.
- Incorrect setting of the conductivity sensor
(See chapter "*Settings - Adjustment of the*

remaining laundry moisture degree " for better setting).

- The airflow slots are clogged.
- Room temperature is too low or too high
(optimal room temperature 19°C to 24°C)

TECHNICAL DATA

Height x Width x Depth	850 x 600 x 600 mm (maximal 665 mm)
Max. depth with the appliance door open	1090 mm
Max. width with the appliance door open	950 mm
Adjustable height	850 mm (+ 15 mm - feet regulation)
Drum volume	118 l
Maximum load volume	8 kg
Voltage	230 V
Frequency	50 Hz
Sound power level	66 dB
Necessary fuse	13 A
Total power	900 W
Energy efficiency class	A+
Energy consumption on the standard cotton programme with the full load. ¹⁾	2,60 kWh
Energy consumption on the standard cotton programme with the partial load. ²⁾	1,38 kWh
Annual energy consumption ³⁾	308,20 kWh
Left-on mode power absorption ⁴⁾	0,50 W
Off mode power absorption ⁴⁾	0,50 W
Type of use	Household

Allowed ambient temperature	+ 5°C to + 35°C
Level of protection against ingress of solid particles and moisture ensured by the protective cover, except where the low voltage equipment has no protection against moisture	IPX4
This product contains fluorinated greenhouse gases, hermetically sealed	
Gas designation	R134a
Weight	0,30 kg
Global-warming potential (GWP)	1430

1) With reference to EN 61121. 8 kg of cotton centrifuged at 1000 rpm.

2) With reference to EN 61121. 4 kg of cotton centrifuged at 1000 rpm.

3) Energy consumption per year in kWh, based on 160 drying cycles of the standard cotton programme at full and partial load, and the consumption of the low-power modes. Actual energy consumption per cycle will depend on how the appliance is used (REGULATION (EU) No. 392/2012).

4) With reference to EN 61121.

The information given in the chart above is compliant with the EU Commission regulation 392/2012 implementing directive 2009/125/EC.

CONSUMPTION DATA

Programme	Spun at / residual humidity	Drying time ¹⁾	Energy consumption ²⁾
Cottons Eco 8 kg			
Cupboard Dry	1400 rpm / 50%	147 min.	2,03 kWh
	1000 rpm / 60%	179 min.	2,60 kWh
Iron Dry	1400 rpm / 50%	113 min.	1,47 kWh
	1000 rpm / 60%	135 min.	1,79 kWh
Cottons Eco 4 kg			
Cupboard Dry	1400 rpm / 50%	86 min.	1,14 kWh
	1000 rpm / 60%	102 min.	1,38 kWh
Synthetics 3,5 kg			
Cupboard Dry	1200 rpm / 40%	58 min.	0,71 kWh
	800 rpm / 50%	72 min.	0,90 kWh

1) For partial loads, the cycle time is shorter and appliance uses less energy.

2) Improper ambient temperature and/or poorly centrifuged laundry can prolong cycle time and increase the energy consumption.

PRODUCT INFORMATION SHEET IN REFERENCE TO E.U. REGULATION 1369/2017

Product Information Sheet	
Trade Mark	ZANUSSI
Model	ZDH8903PZ PNC916098607
Rated capacity in kg	8
Air vented or condenser tumble dryer	Condenser
Energy efficiency class	A+
Energy consumption in kWh per year, based on 160 drying cycles of the standard cotton programme at full and partial load, and the consumption of the low-power modes. Actual energy consumption per cycle will depend on how the appliance is used.	308,20
Automatic tumble drier or non-automatic tumble drier	Automatic
Energy consumption of the standard cotton programme at full load in kWh	2,60
Energy consumption of the standard cotton programme at partial load in kWh	1,38
Power consumption of the off-mode in W	0,50
Power consumption in left-on mode in W	0,50
Duration of the left on mode in minutes	10
The 'standard cotton programme' used at full and partial load is the standard drying programme to which the information in the label and the fiche relates, this programme is suitable for drying normal wet cotton laundry and it is the most efficient programme in terms of energy consumption for cotton.	
Weighted programme time of the 'standard cotton programme at full and partial load' in minutes	135
Programme time of the 'standard cotton programme at full load' in minutes	179
Programme time of the 'standard cotton programme at partial load' in minutes	102
Condensation efficiency class on a scale from G (least efficient) to A (most efficient)	B
Average condensation efficiency of the standard cotton programme at full load as a percentage	81
Average condensation efficiency of the standard cotton programme at partial load as a percentage	81
Weighted condensation efficiency for the 'standard cotton programme at full and partial load'	81

Sound power level in dB	66
Built in appliance Y/N	No

The information given in the chart above is compliant with the EU Commission regulation 392/2012 implementing directive 2009/125/EC.

ENVIRONMENTAL CONCERNS

Recycle materials with the symbol . Put the packaging in relevant containers to recycle it. Help protect the environment and human health by recycling waste of electrical and electronic appliances. Do not dispose of appliances marked

with the symbol  with the household waste. Return the product to your local recycling facility or contact your municipal office.

WWW.ZANUSSI.COM/SHOP

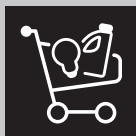

CE

136960360-A-502018