

Ref: 5194

TARA HILL, GOREY, CO. WEXFORD



QUINN PROPERTY
www.quinnproperty.ie

Valuable C. 3.3 Acre Development Site In An Exceptional Location For Sale by Online Auction On Tuesday 14th of July at 12 Noon

LOCATION:

These prime sites are situated in the highly sought-after residential setting opposite Saint Kevin's Church, Tara Hill, one of the area's most charming local landmarks. They are conveniently located just 50 metres from the local primary school and approximately 3km from Hughes Foodmarket & Convenience Store. Nestled in north County Wexford, the area enjoys spectacular coastal views stretching towards Ballymoney and Courtown. Renowned as a popular holiday destination, it boasts a selection of beautiful sandy beaches nearby, including Kilgorman Strand, Saleen, Ballymoney Beach and Dodd's Rocks. Golf enthusiasts are well catered for, with two renowned courses within easy reach, while a wide range of outdoor pursuits and leisure activities can be enjoyed throughout the surrounding countryside and coastline. The bustling town of Gorey, with its excellent choice of shops, schools, restaurants and amenities, is just 6km away, while Dublin is within comfortable commuting distance at approximately one hour by car.

DESCRIPTION:

This well-located site has received planning permission under Planning Reference Number: 20250966W for Four Detached, four bedroom homes each with detached garages. This exclusive development will comprise four individual residential plots (Sites A-D) arranged around a private access road with a central turning head, providing safe and convenient vehicle access to each property. The site is bordered by established mature trees and landscaped boundaries, creating a private and attractive setting while maintaining a strong connection to the surrounding countryside. Each plot has been carefully designed to accommodate a detached family home with a dedicated garage and generous outdoor space.



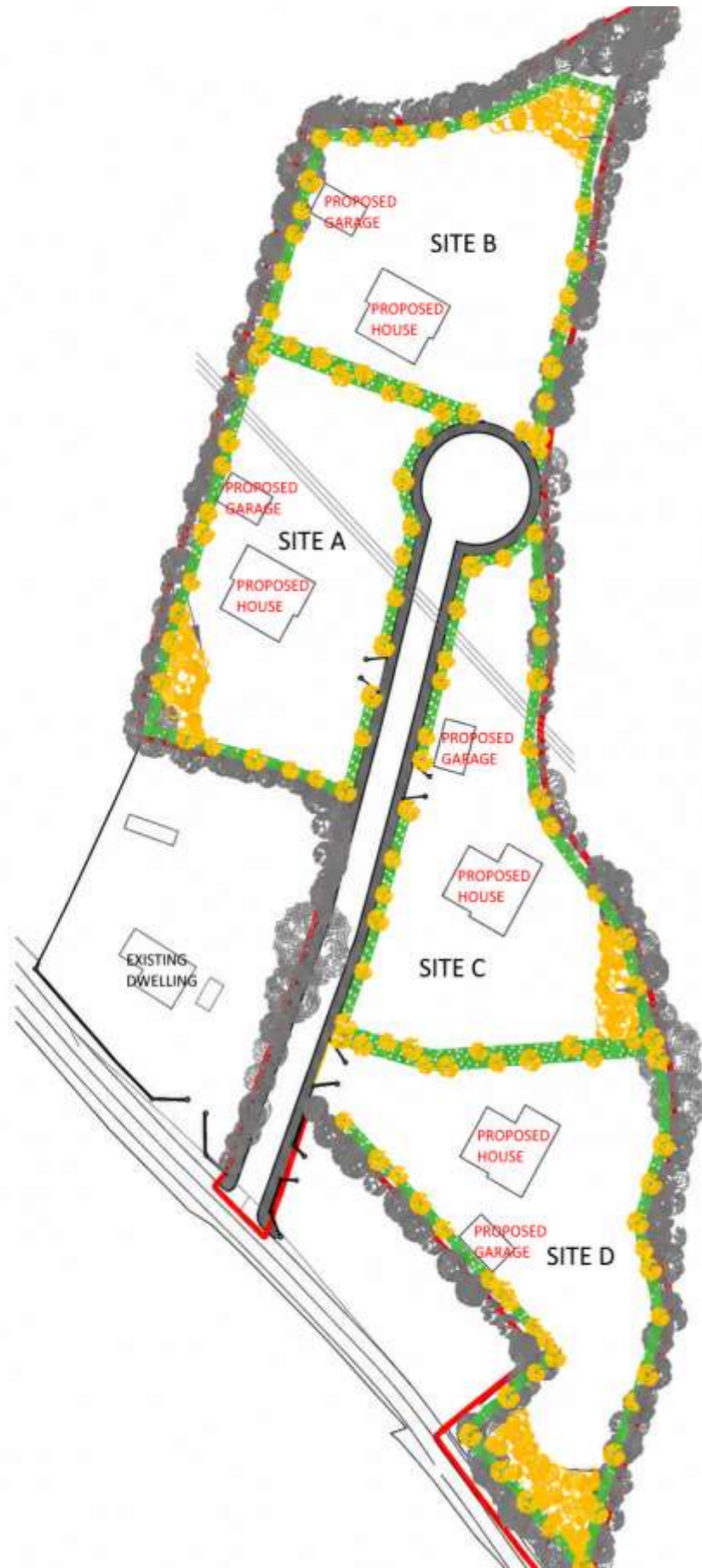

PROPOSED GROUND FLOOR PLAN 1:100
 PROPOSED GROUND FLOOR AREA 147.40 SQ METRES (1586 SQ FEET)
 TOTAL FLOOR AREA 299.20 SQ METRES (3219 SQ FEET)



PROPOSED FIRST FLOOR PLAN 1:100
 PROPOSED FIRST FLOOR AREA 151.80 SQ METRES (1633 SQ FEET)

DIRECTIONS:

From Gorey's Main Street, continue South-West onto the Arklow Road and turn right onto L5032 at John Bass Tyres. Continue along this road for approximately 8km and the property will be on your right, marked with a **QUINN** PROPERTY auction board.

P.O.A.



Legal: Garrett Fitzpatrick, Lombard Cullen & Fitzpatrick Solicitors, 10 McDermott Street, Gorey, Co. Wexford. Tel: 053 9421324

The above particulars are issued by QUINN PROPERTY on the understanding that any negotiations whatsoever concerning the property are conducted through QUINN PROPERTY. Every care has been taken in the preparation of these particulars, but the Auctioneer does not hold himself responsible for any inaccuracy, or for any expense incurred in inspecting the property should it not be suitable, or withdrawn from sale.