

TO LET
FITTED OFFICES



FLEMING
C O U R T

FLEMING PLACE, DUBLIN 2.



**ONE OF DUBLIN'S
MOST PRESTIGIOUS
BUSINESS LOCATIONS
IN THE HEART
OF THE CBD.**

**2,729 SQ.M.
(29,370 SQ.FT.)
OF PRIME OFFICE
ACCOMMODATION.**

Fleming Court comprises a modern five-storey detached Grade A office building, with a unique "blue-glass" external elevation. The building was developed in 2001 with a refurbishment undertaken in 2015.

Three self contained office suites are currently available to lease on the ground, first and second floors with the benefit of on-site secure car parking. The ground floor suite extends to 175 sq. m. (1,883 sq.ft.) and is open plan in configuration with the benefit of a kitchenette facility. The part 1st and 2nd floors extend to 277 sq.m. (2,981 sq.ft.) and 504 sq.m. (5,425 sq.ft.) respectively and are predominantly open plan in configuration with the benefit of cellular offices and kitchenette facilities on both floors. All 3 office suites are regular bright floor plates and can easily be configured to suit a variety of business types.





AMAZON

CLAYTON HOTEL

BOI CORPORATE BANKING

LINKEDIN OFFICE CAMPUS

GRAND CANAL

LINKEDIN

GROUPON
MACQUARIE GROUP
CBRE

HUAWEI
CROWE

MUZINICH & CO
PROXIMO SPIRITS

ADDLESHAW GODDARD

MESPIL HOTEL

CANADIAN EMBASSY

BANK OF IRELAND

EBS

STORYFUL
SANNE

SKY IRELAND
AMAZON

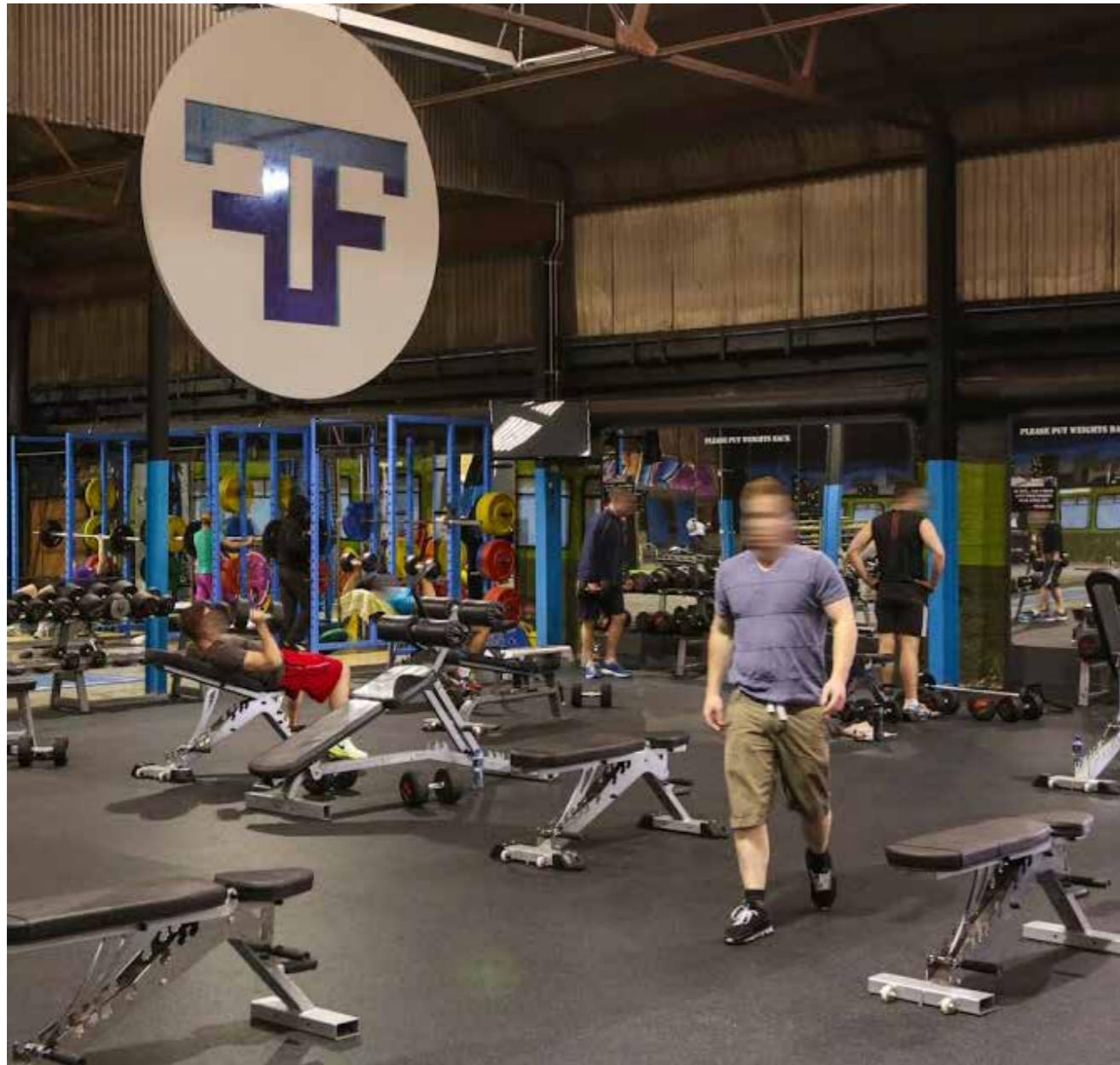

FLEMING
COURT

BANK OF IRELAND





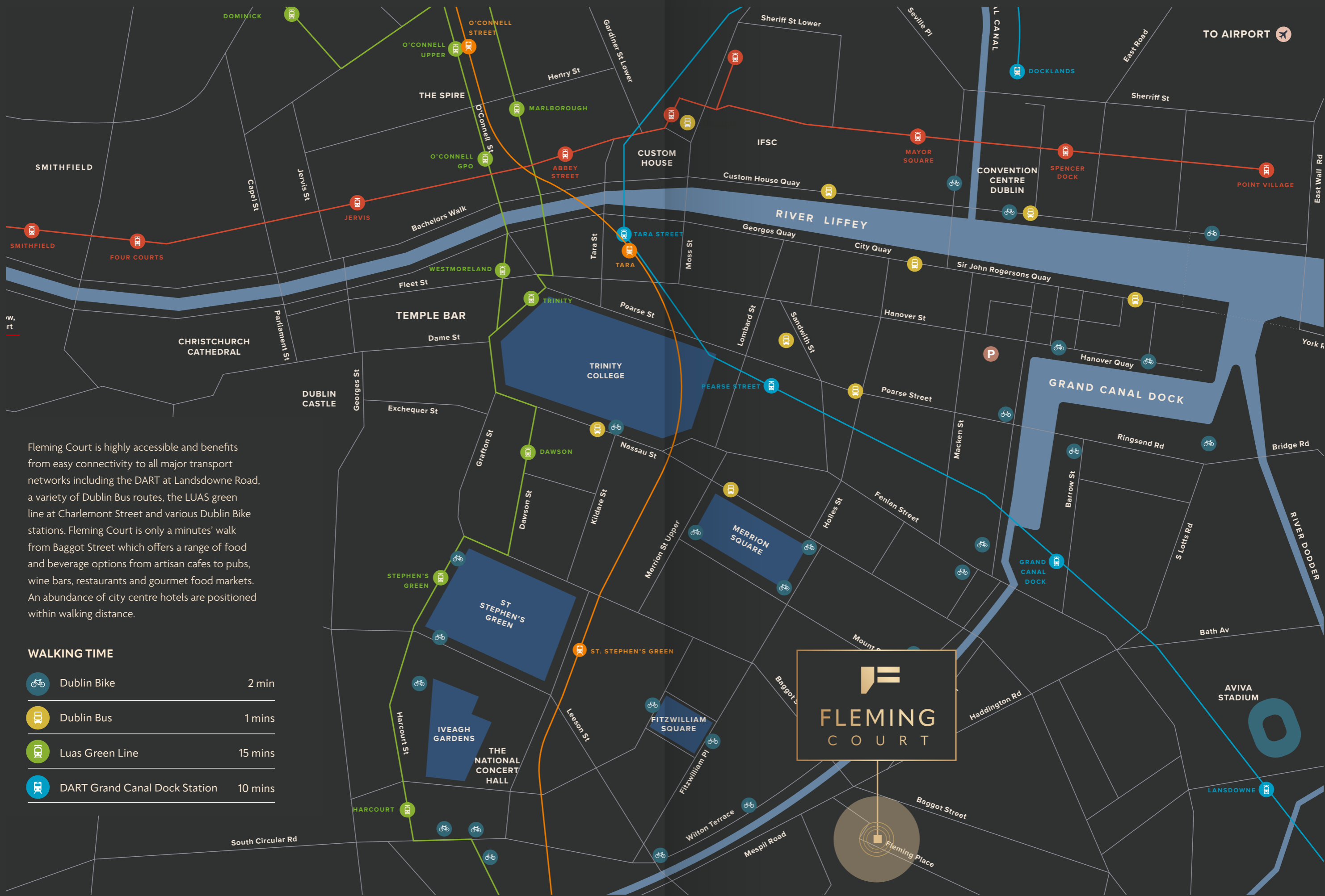

Fleming Court is conveniently situated on Fleming Place just off the Mespil Road in one of Dublin's most prestigious business locations. Immediately adjacent the Grand Canal, the offices are a short stroll from Baggot Street Bridge, Haddington Road, Fitzwilliam Square and Merrion Square. The surrounding area is home to many established indigenous and international occupiers including Amazon, LinkedIn, Sky Ireland, Jazz Pharmaceuticals, Bank of Ireland, AIB, and the Health Service Executive. Occupiers within the building include CSC Capital Markets, Sparkasse Bank Malta Plc, Signal Education Ltd, and Kennelly Tax Advisors Ltd.





Fleming Court is highly accessible and benefits from easy connectivity to all major transport networks including the DART at Landsdowne Road, a variety of Dublin Bus routes, the LUAS green line at Charlemont Street and various Dublin Bike stations. Fleming Court is only a minutes' walk from Baggot Street which offers a range of food and beverage options from artisan cafes to pubs, wine bars, restaurants and gourmet food markets. An abundance of city centre hotels are positioned within walking distance.

WALKING TIME

-  Dublin Bike 2 min
-  Dublin Bus 1 mins
-  Luas Green Line 15 mins
-  DART Grand Canal Dock Station 10 mins

FLOOR PLANS

GROUND FLOOR

175 sq.m. / 1,883 sq.ft.

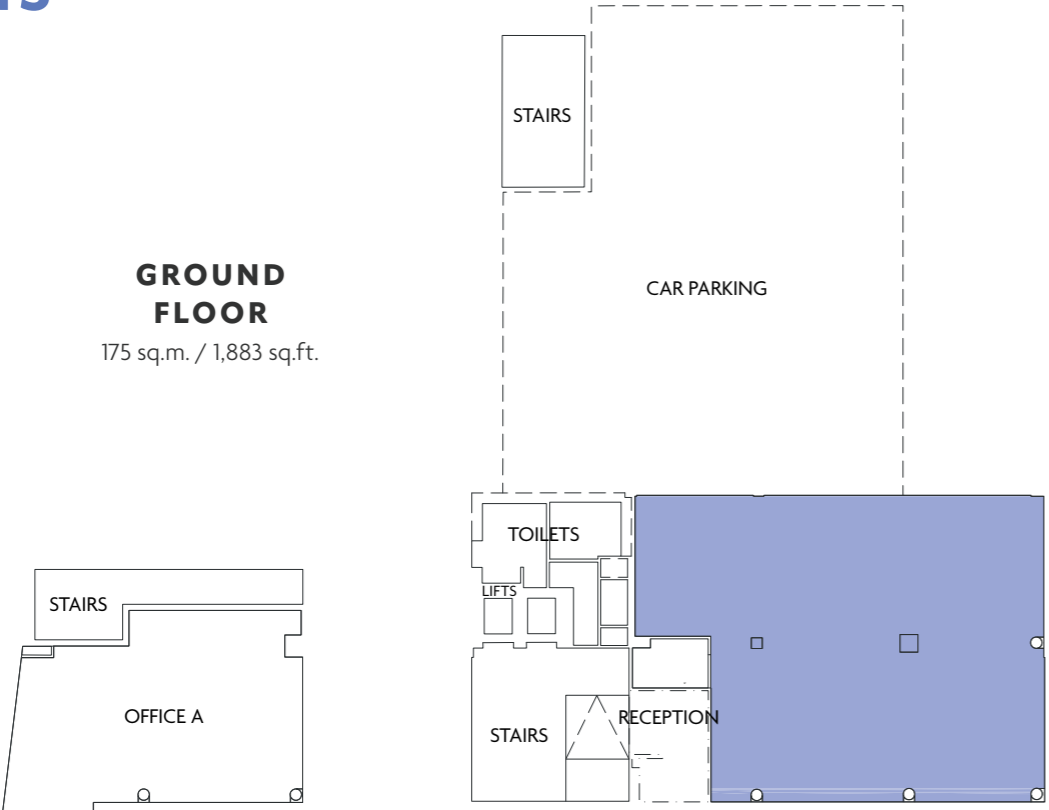

FIRST FLOOR

277 sq.m. / 2,981 sq.ft.



SECOND FLOOR

504 sq.m. (5,425 sq.ft.)



Floor Plans provided are for illustrative purposes only.





SCHEDULE OF ACCOMMODATION:

Floor	Sq M	Sq Ft
Part Ground	175	1,883
Part 1st Floor	277	2,981
Part 2nd Floor	504	5,424
Total	956	10,319

Measured on a net internal area basis.

ANNUAL OUTGOINGS:

Quoting Rent: €565.11 per sq.m. p.a.
Car Parking: €3,750 per space p.a.

Rates (2022)

Ground Floor €10,569 p.a.
 1st Floor €15,458 p.a.
 2nd Floor €28,429 p.a.

Service Charge (2022)

Ground Floor €15,176 p.a.
 1st Floor €24,079 p.a.
 2nd Floor €43,731 p.a.

FURTHER INFORMATION

Lease terms and details available on request. Inspections strictly by appointment through sole letting agents BNP Paribas Real Estate.



57 Adelaide Road
 Dublin 2, D02 Y3C6
 realestate.bnpparibas.ie
 PSRA No: 002702

Keith O'Neill
 +353 1 661 1233
 +353 86 857 9696
 keith.oneill@bnpparibas.com

John Cannon
 +353 1 661 1233
 +353 87 396 6725
 john.cannon@bnpparibas.com

DISCLAIMER: BNP Paribas Real Estate gives notice that these particulars are set out for general outline only, for the guidance of intending lessees and do not constitute, nor constitute part of an offer or contract. All descriptions, dimensions, references to condition and other details are given without responsibility and any intending lessees should not rely on them as statements or representations of fact, but must satisfy themselves or otherwise as to the correctness of each of them. All floor areas are approximate.



FLEMING
C O U R T



BNP PARIBAS
REAL ESTATE

BNPPARIBAS.IE