

For Sale

Bogganfin, Ballymurray, Co. Roscommon, F42 KP28

DOUGLAS NEWMAN GOOD
DNG

IVAN
CONNAUGHTON

BER **B**



Offers in Excess of: €450,000

Attractive five-bedroom residence in excellent condition throughout currently set out as a four-bedroom residence and one bedroom apartment, occupying an overall floor area of c. 2,364 sq.ft. To rear is a double garage with a floor area of c. 1,106 sq.ft. Standing on c. 1.15 Acres of private mature gardens, viewing comes highly recommended.

This property is located in a much sought after area c. 5km from Roscommon Town and c. 23km from Athlone/M6 Dublin to Galway Motorway.

Viewing is strictly by appointment with the auctioneer.

DNG Ivan Connaughton invite enquiries and offers.

Call 090-6663700 or email info@dngivanconnaughton.ie for more information or to arrange a viewing.

Hallway

5.93m (19'5") x 2.4m (7'10")

Living Room

4.63m (15'2") x 4.2m (13'9")

Open Plan Kitchen/Living Area

8.83m (29'0") x 3.62m (11'11")

Bathroom

1.78m (5'10") x 1.2m (3'11")

Office/Bedroom 5

2.84m (9'4") x 4.18m (13'9")

WC

1.47m (4'10") x 1.82m (6'0")

Kitchen/Living Area

7.52m (24'8") x 4.27m (14'0")

Dining Room

2.79m (9'2") x 3.86m (12'8")

Utility Room

2.13m (7'0") x 3.83m (12'7")

Garage

3.43m (11'3") x 3.64m (11'11")

Landing

5.53m (18'2") x 2.43m (8'0")

Bedroom 1

3.32m (10'11") x 4.19m (13'9")

Bedroom 2

3.41m (11'2") x 4.19m (13'9")

Bathroom

1.83m (6'0") x 2.41m (7'11")

Bedroom 3

2.99m (9'10") x 2.57m (8'5")

Dressing Room

2.25m (7'5") x 1.49m (4'11")

En-Suite

1.8m (5'11") x 2.56m (8'5")

Bedroom 4

3.16m (10'4") x 4.2m (13'9")

Hot Press

1.07m (3'6") x 1.47m (4'10")

OTHER FEATURES

- Prime Located, site area of c. 1.15 Acres
- Magnificent manicured gardens & mature trees
- Range of flowers and shrubbery beds
- Driveway kerbed & stones, extends to rear
- Ample parking
- Extensive outbuildings to rear c. 1,106 sq.ft
- Garage adjoining residence
- Property has Commercial Planning for a Garden Centre
- Viewing highly recommended







Bogganfin, Ballymurray, Co. Roscommon, F42 KP28



Bogganfin, Ballymurray, Co. Roscommon, F42 KP28



Bogganfin, Ballymurray, Co. Roscommon, F42 KP28











Bogganfin, Ballymurray, Co. Roscommon, F42 KP28



Bogganfin, Ballymurray, Co. Roscommon, F42 KP28



Bogganfin, Ballymurray, Co. Roscommon, F42 KP28



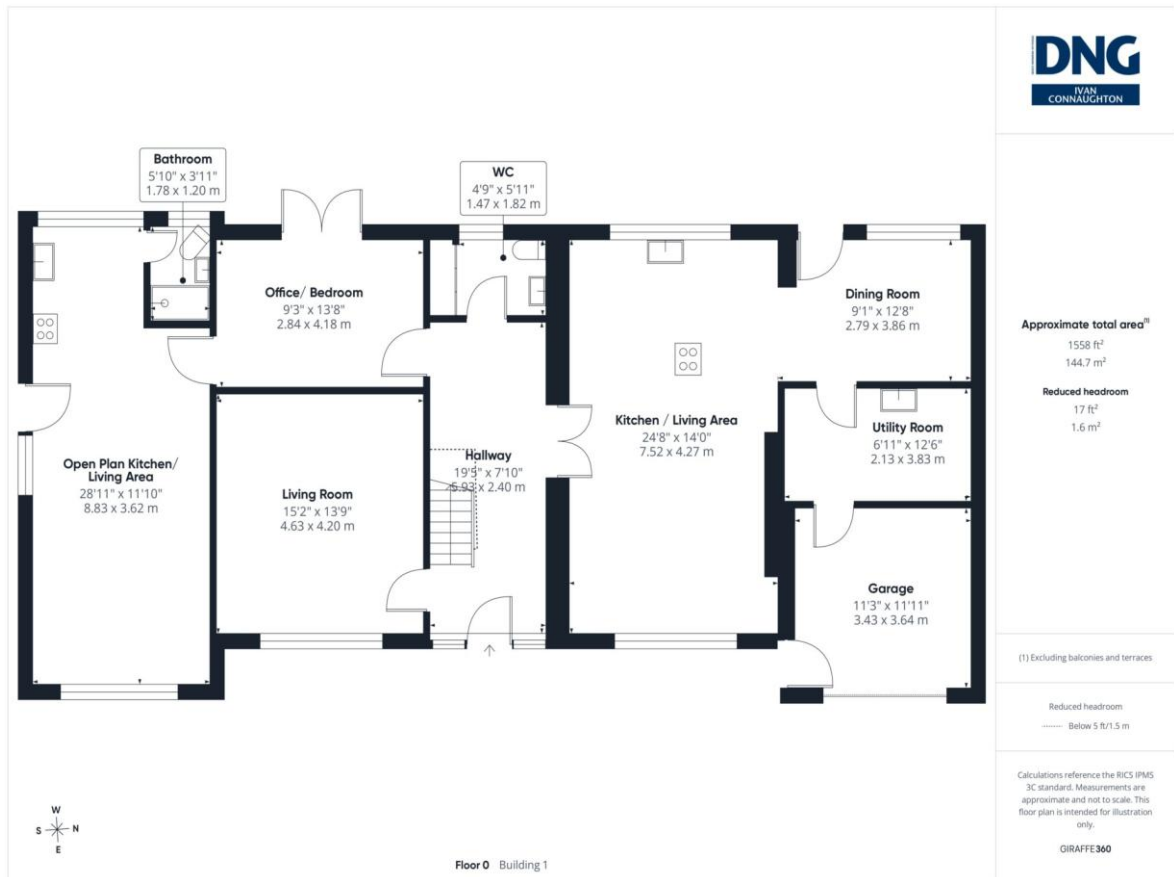

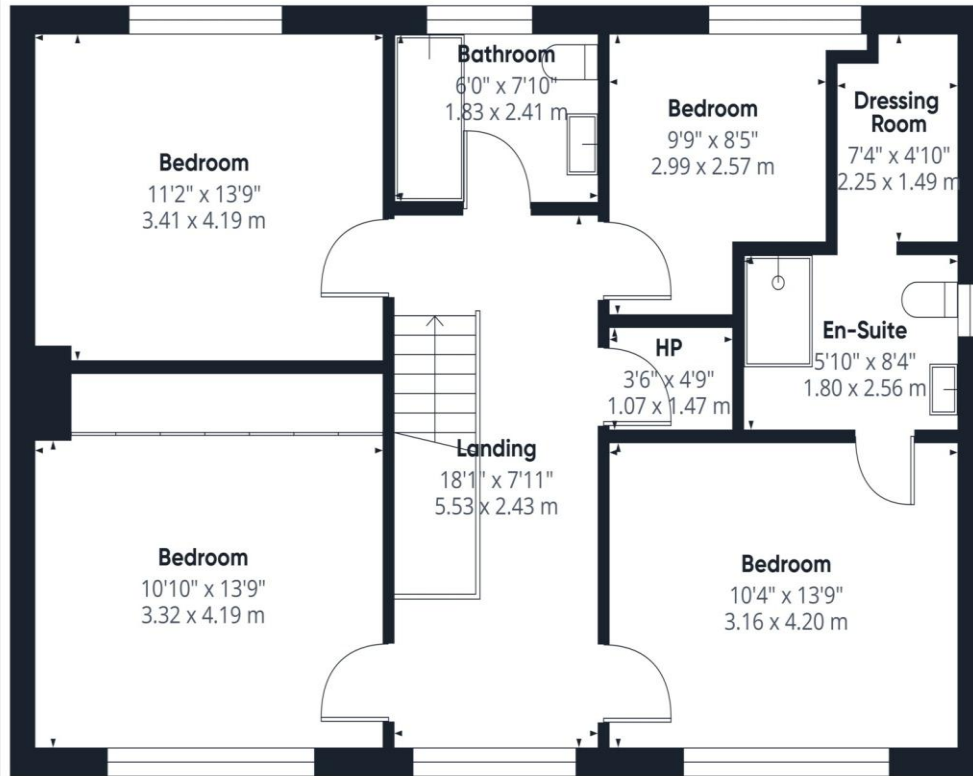

Approximate total area⁽¹⁾
806 ft²
74.9 m²

(1) Excluding balconies and terraces

Calculations reference the RICS IPMS 3C standard. Measurements are approximate and not to scale. This floor plan is intended for illustration only.

GIRAFFE360



Floor 1 Building 1