



**FOR SALE BY PRIVATE TREATY**

**NO. 1 OAKLAND DRIVE,  
GREYSTONES,  
ENNIS ROAD,  
LIMERICK V94FA4E**

**GUIDE PRICE: €430,000**





## DESCRIPTION

Property Partners de Courcy O Dwyer are delighted to offer for sale this substantial extended five bedroomed semi detached property located in this popular Limerick suburb close to a host of amenities to include TUS, The Gaelic Grounds, Thomond Park, Jetland Shopping Centre as well as an excellent selection of both primary and secondary schools. The property is also within a short walk of Limerick city centre.

The accommodation comprises of entrance porch, entrance hall, sitting room, living room, kitchen/breakfast room, utility room, shower room, dining room, five bedrooms and bathroom.

Outside there are extensive front, side and rear gardens and we believe there may be potential to build a separate property on this site subject to the necessary planning permission.

A viewing of this property is highly recommended.





## SPECIAL FEATURES

---

Semi Detached

Double glazed windows

Oil fired central heating

Two storey extension

Five bedrooms

Three reception rooms

Extra large side garden with road frontage offering potential to develop subject to the necessary planning permission

Adjacent to Limerick Gaelic Grounds, Limerick Lawn Tennis Club, Jetland Shopping Centre, TUS and a selection of primary and secondary schools

## ACCOMMODATION

---

- **Entrance Porch** Hardwood entrance door.
- **Entrance Hallway**
- **Sitting Room** Feature open tiled fireplace.
- **Living Room** Marble open fireplace with marble hearth. TV point. Covings.
- **Kitchen/Breakfast Room** Array of eye and floor level units. Single drainer stainless steel sink unit with mixer tap. Plumbed for dishwasher. Door to ...
- **Utility Room** Plumbed for washing machine. Door to rear garden.
- **Shower Room** Shower with Mira Elite 2 electric shower. W. C. Wash hand basin. Fully tiled walls and floor.
- **Dining Room**
- **Upstairs**
- **Bathroom** Bath. W. C. Wash hand basin in vanity unit. Tiled floor and part tiled walls.
- **Bedroom 1** Range of fitted wardrobes with overhead presses. Wash hand basin in vanity unit.
- **Bedroom 2** Range of fitted wardrobes and shelving.
- **Bedroom 3** Fitted wardrobes. Wash hand basin.
- **Bedroom 4** Fitted wardrobes. Wash hand basin.
- **Bedroom 5** Fitted wardrobes. Overhead presses and workstation.
- **Outside** Fully walled front side and rear gardens. The front garden is accessed via double steel gates to a concrete driveway. It is part lawned with mature borders with variety of plants, shrubs and trees. Extra large side entrance way with a good height laurel hedge surround. Private rear garden mainly laid to lawn. Large garden shed of block construction.

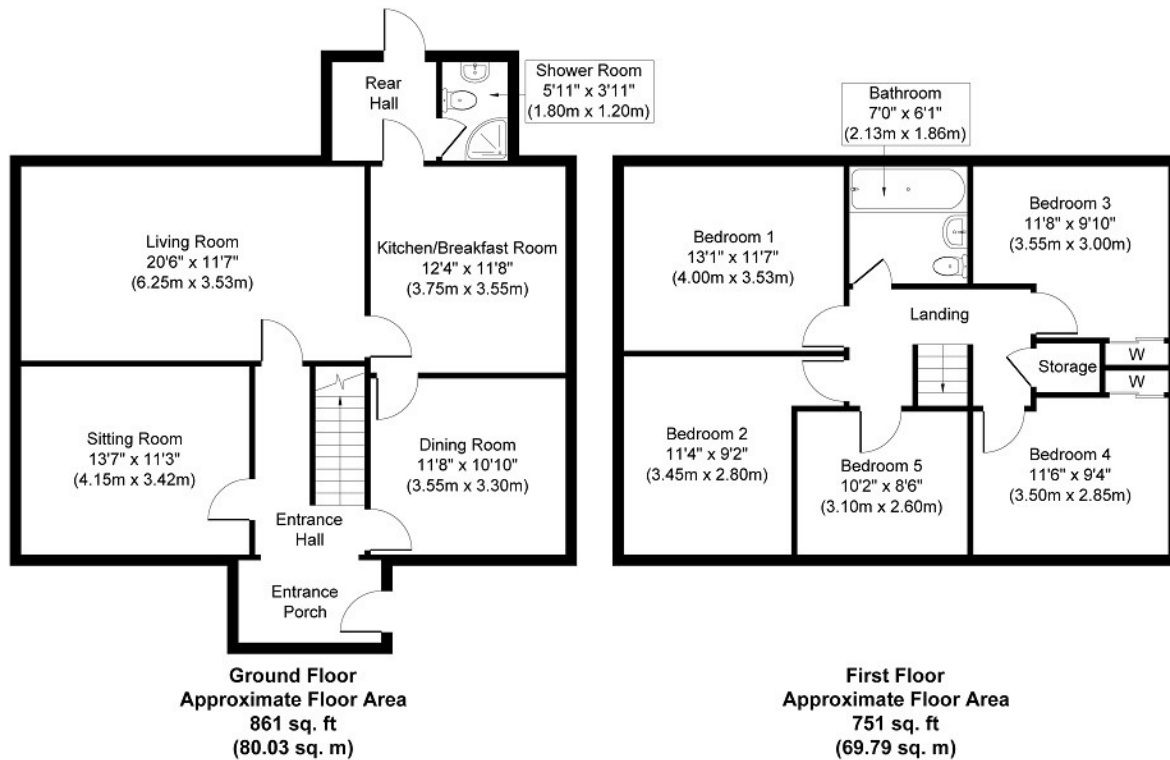

Whilst every attempt has been made to ensure the accuracy of the floor plan contained here, measurements of doors, windows, rooms and any other items are approximate and no responsibility is taken for any error, omission or mis-statement. The measurements should not be relied upon for valuation, transaction and/or funding purposes. This plan is for illustrative purposes only and should be used as such by any prospective purchaser or tenant. The services, systems and appliances shown have not been tested and no guarantee as to their operability or efficiency can be given.

Copyright V360 Ltd 2026 | www.houseviz.com

## PRICE

€430,000.

## DIRECTIONS

Google Map: V94FA4E

## VIEWING DETAILS

By appointment only

## Contact Negotiator

Geoffrey de Courcy

## Contact Agent

PROPERTY PARTNERS DE COURCY O'DWYER  
M: 061 410 410  
E: decourcyodwyer@propertypartners.ie

**PROPERTY  
PARTNERS**

Disclaimer - These particulars do not constitute an offer or contract. Measurements are approximate and no responsibility is taken for any mis-statement or omission in these particulars, which are for the guidance of intending purchasers only. All negotiations must be done through Property Partners De Courcy O'Dwyer.