



## Auskurra, Dunmore East, Co Waterford. X91X0C9.

**For Sale**

**€550,000**

Bedrooms 4  
Reception Rooms 2  
Bathroom's/WC's 2  
Size c. 182sq.m. /c. 1,959sq.ft.



PSRA Licence Number: 004069



52 High Street  
Waterford  
051852233

[info@dngreidandcoppinger.ie](mailto:info@dngreidandcoppinger.ie)  
[www.dngreidandcoppinger.ie](http://www.dngreidandcoppinger.ie)  
[www.dng.ie](http://www.dng.ie)

Whereas every effort has been made to ensure the accuracy of these particulars, the contents there in are for description and general information purposes only and should not be fully relied upon. DNG Reid & Coppinger and their servants or agents assume no responsibility for and give no guarantees, undertakings or warranties concerning the accuracy, completeness or up to date nature of the information and do not accept any liability whatsoever arising from any errors or omissions. The information does not constitute or form part of a contract and cannot be relied on as a representation of fact. Receipt of these particulars is under the strict understanding that all further dealings with this property be conducted with DNG Reid & Coppinger. All express, implied representations or guarantees, warranties or terms and conditions that may arise under law, custom, usage or otherwise are expressly excluded to the fullest extent permitted by the applicable law.



## DESCRIPTION

Spacious detached dormer style family home situated just 1.5km from the renowned fishing village of Dunmore East. The property is nestled on c. 1.28 acres with magnificent views of the sea, of the surrounding countryside and the Wexford coastline. Located in a countryside setting yet the property is only c.1.5kms to Dunmore East lower village, beach, shops and leisure facilities, and a host of local eateries. The property is surrounded by natural stone walls with mature lawns and mature shrubbery and is entered by a sweeping tarmac driveway. The property has benefit of two stables to the rear of the property which would make an ideal property for the equestrian enthusiast, the site is apportioned into gardens to the front and large garden to the rear. This light filled family home has a spacious hallway with tiled flooring, living room, kitchen/diner, spacious sitting room with featured fireplace with wood burning stove and double glass doors to maximise the natural light and beautiful views, utility room, two bedrooms with a further two bedrooms on the first floor with main ensuite and walk in wardrobe.

## LOCATION

The property is located just on the outskirts of Dunmore East Village near Holy Cross Church, Killea and c.1.5 kms to Dunmore East lower village, c.1km from Creaden beach and c.9kms to Woodstown beach and c.15kms to Waterford City. Dunmore East is a picturesque seaside fishing village and tourist destination, located on the Southeast coastline at the entrance to the Waterford Estuary. Dunmore East offers an abundance of outdoor pursuits and facilities from sailing, angling, boat tours, cliff, and woodland walks, as well as several beaches and coves to explore.

**ASKING PRICE €550,000**

**FOR FURTHER INFORMATION AND VIEWING DETAILS PLEASE CONTACT  
DNG REID & COPPINGER AUCTIONEERS 051852233**



Whereas every effort has been made to ensure the accuracy of these particulars, the contents there in are for description and general information purposes only and should not be fully relied upon. DNG Reid & Coppinger and their servants or agents assume no responsibility for and give no guarantees, undertakings or warranties concerning the accuracy, completeness or up to date nature of the information and do not accept any liability whatsoever arising from any errors or omissions. The information does not constitute or form part of a contract and cannot be relied on as a representation of fact. Receipt of these particulars is under the strict understanding that all further dealings with this property be conducted with DNG Reid & Coppinger. All express, implied representations or guarantees, warranties or terms and conditions that may arise under law, custom, usage or otherwise are expressly excluded to the fullest extent permitted by the applicable law.









Whereas every effort has been made to ensure the accuracy of these particulars, the contents there in are for description and general information purposes only and should not be fully relied upon. DNG Reid & Coppinger and their servants or agents assume no responsibility for and give no guarantees, undertakings or warranties concerning the accuracy, completeness or up to date nature of the information and do not accept any liability whatsoever arising from any errors or omissions. The information does not constitute or form part of a contract and cannot be relied on as a representation of fact. Receipt of these particulars is under the strict understanding that all further dealings with this property be conducted with DNG Reid & Coppinger. All express, implied representations or guarantees, warranties or terms and conditions that may arise under law, custom, usage or otherwise are expressly excluded to the fullest extent permitted by the applicable law.





Whereas every effort has been made to ensure the accuracy of these particulars, the contents there in are for description and general information purposes only and should not be fully relied upon. DNG Reid & Coppinger and their servants or agents assume no responsibility for and give no guarantees, undertakings or warranties concerning the accuracy, completeness or up to date nature of the information and do not accept any liability whatsoever arising from any errors or omissions. The information does not constitute or form part of a contract and cannot be relied on as a representation of fact. Receipt of these particulars is under the strict understanding that all further dealings with this property be conducted with DNG Reid & Coppinger. All express, implied representations or guarantees, warranties or terms and conditions that may arise under law, custom, usage or otherwise are expressly excluded to the fullest extent permitted by the applicable law.

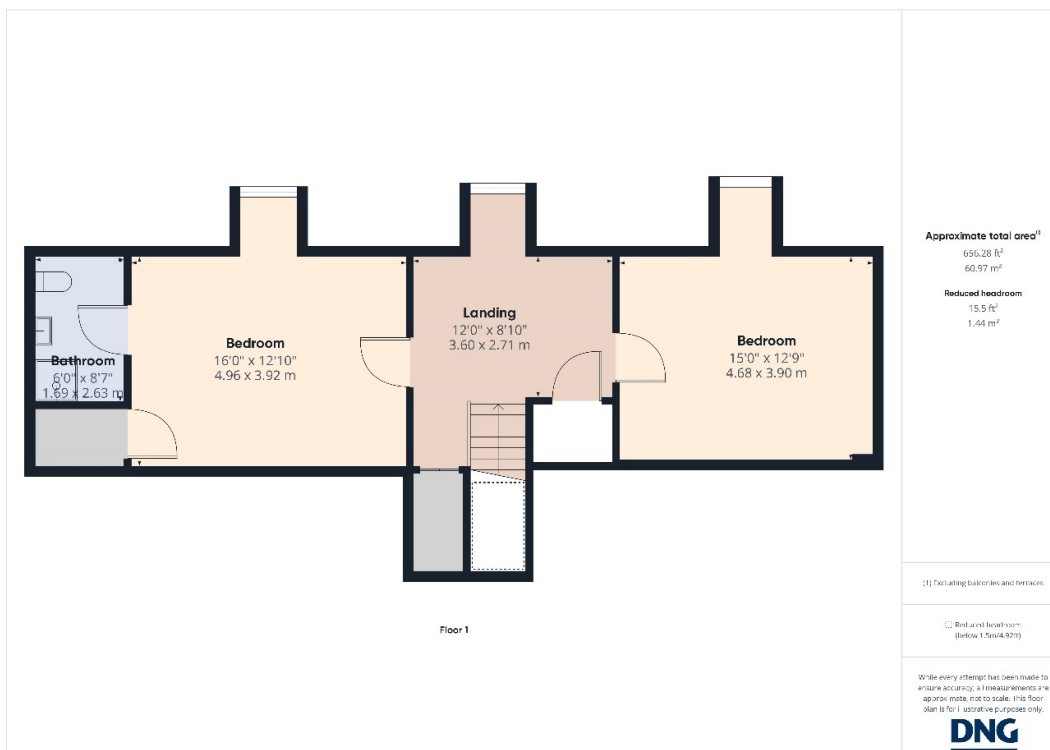

Whereas every effort has been made to ensure the accuracy of these particulars, the contents there in are for description and general information purposes only and should not be fully relied upon. DNG Reid & Coppinger and their servants or agents assume no responsibility for and give no guarantees, undertakings or warranties concerning the accuracy, completeness or up to date nature of the information and do not accept any liability whatsoever arising from any errors or omissions. The information does not constitute or form part of a contract and cannot be relied on as a representation of fact. Receipt of these particulars is under the strict understanding that all further dealings with this property be conducted with DNG Reid & Coppinger. All express, implied representations or guarantees, warranties or terms and conditions that may arise under law, custom, usage or otherwise are expressly excluded to the fullest extent permitted by the applicable law.



## ACCOMMODATION

### Entrance Hall

2.71 x 4.02

Tiled flooring.

### Living Room

4.63 x 4.13

Solid wood flooring. Open fireplace. Curtains to window.

### Kitchen

5.42 x 3.63

Tiled flooring. Fully fitted kitchen units.

### Utility Room

1.82 x 3.66

Tiled flooring. Plumbed for washing machine and dryer. Door to rear garden.

### Sitting Room

5.18 x 3.60

Laminate timber flooring. Stove. Double doors to rear garden.

### Bathroom

2.42 x 2.59

Tiled flooring. Walls tiled halfway and in shower unit. WC, WHB and shower.

### Bedroom 1

4.54 x 3.02

Carpet flooring. Curtains to window.

### Bedroom 2

3.01 x 2.99

Carpet flooring. Curtains to window.

**Stairs to first floor landing all in solid wood flooring.**

### Bedroom 3

4.96 x 3.92

Solid wood flooring. Velux window. Blinds to window.

### En Suite

1.69 x 2.63

Tiled floor and shower area. WC, WHB, shower.

### Bedroom 4

4.68 x 3.90

Solid wood flooring. Velux window.



## GARDEN

Front garden in lawn with mature shrubbery and tarmacadam driveway. Rear garden is in lawn with patio area and garden shed

## BER

Rating: C1

BER No.: 116780941

EPI: 159.09kWh/msq/yr

## FEATURES

uPVC double glazed windows

C1 BER rating

Oil heating with newly fitted oil burner

c. 1.28 acres

c.1.5kms to Dunmore East

Detached stables



Whereas every effort has been made to ensure the accuracy of these particulars, the contents there in are for description and general information purposes only and should not be fully relied upon. DNG Reid & Coppinger and their servants or agents assume no responsibility for and give no guarantees, undertakings or warranties concerning the accuracy, completeness or up to date nature of the information and do not accept any liability whatsoever arising from any errors or omissions. The information does not constitute or form part of a contract and cannot be relied on as a representation of fact. Receipt of these particulars is under the strict understanding that all further dealings with this property be conducted with DNG Reid & Coppinger. All express, implied representations or guarantees, warranties or terms and conditions that may arise under law, custom, usage or otherwise are expressly excluded to the fullest extent permitted by the applicable law.