 Ainley's Industrial Estate, Elland HX5 9JP T: +44 (0) 1422 314488 E: enquiries@drivemedical.co.uk W: www.drivemedical.co.uk/technical	TITLE:  <b>MERCURY GT PARTS MANUAL</b>	DATE: 26/07/07	SHEET No: 1
		DRAWN: PMK	CHECKED: REVISION No: A
		SCALE: NTS	DWG No: Z40956

SEPERATE COMPONENTS AVAILABLE:

DRIVE ASSEMBLY

C09-022-02600 - TRANSAXLE  
 C09-022-01500 - EM BRAKE  
 C09-022-02400 - 750W MOTOR  
 C09-022-02300 - CARBON BRUSH

C09-022-01600 - 950W MOTOR  
 C09-022-02600 - TRANSAXLE (FOR  
 950W MOTOR)

CONTROLLER AND MOUNT

C10-011-00600 - 200A CONTROLLER  
 C10-011-00700 - SOLENOID  
 C10-022-00901 - CTRLR MOUNT  
 C10-022-00100 - CTRLR COVER

COLOUR CODED - REAR SHROUD:

S08-022-00211 (RED)  
 S08-022-00254 (BLUE)  
 S08-022-00271 (SILVER)

REAR LIGHT SET:

C16-022-01000

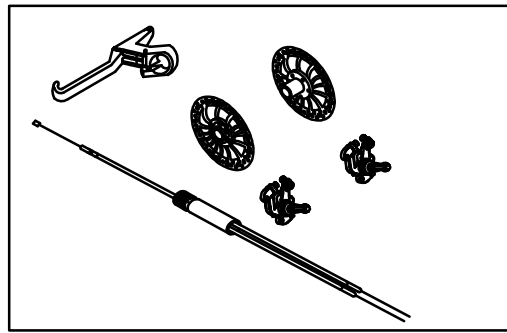

S06-022-00200:  
CABLE BRAKE AS'Y

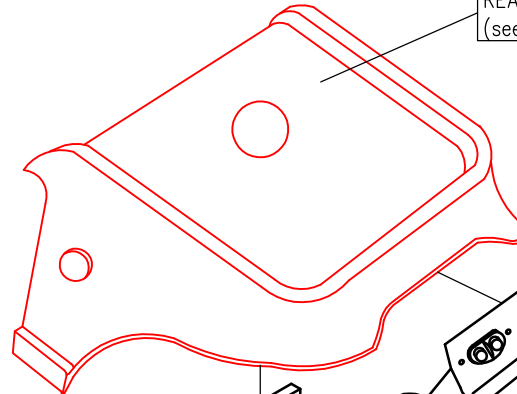

REAR SHROUD AS'Y  
(see list top right)

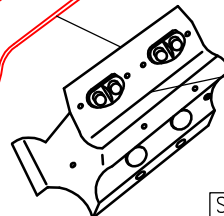

S08-022-00300:  
REAR BUMPER AS'Y

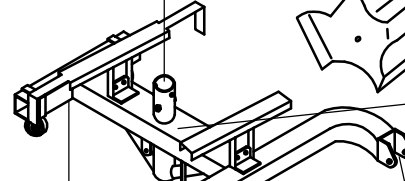

S01-022-00200:  
'H' FRAME AS'Y

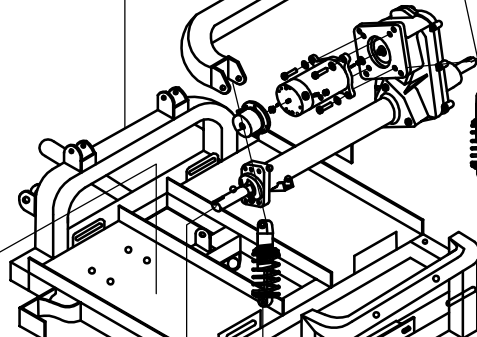

DRIVE ASSEMBLY:  
(see list top left)

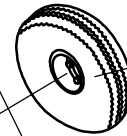

S06-022-00100:  
REAR WHEEL AS'Y

C03-022-02000:  
REAR ABSORBER



C31-005-00100:  
BATTERY STRIPS

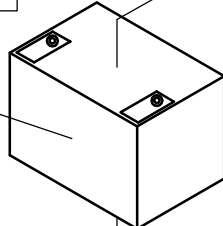

12V70AH:  
70ah BATTERY

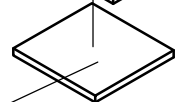

C25-022-00500:  
RUBBER BATTERY PAD



S06-022-00100:  
REAR WHEEL AS'Y



S04-022-00200:  
LH ANTI-TIP WHEEL

S04-022-00100:  
RH ANTI-TIP WHEEL

CONTROLLER &  
MOUNT (see list left)

S01-022-00300:  
FRAME, REAR SECTION

Ainley's Industrial Estate, Elland HX5 9JP  
 T: +44 (0) 1422 314488  
 E: enquiries@drivemedical.co.uk  
 W: www.drivemedical.co.uk/technical

TITLE:  
  
**MERCURY GT  
 PARTS MANUAL**

DATE: 26/07/07  
 DRAWN: PMK  
 SCALE: NTS

SHEET No: 2  
 REVISION No: A  
 DWG No: Z40956

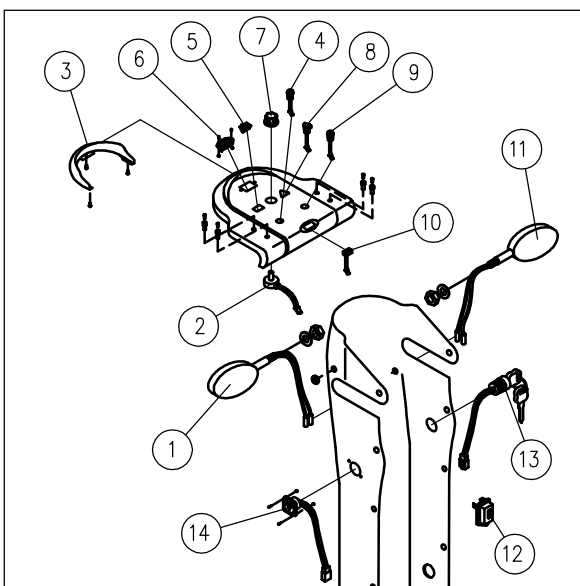
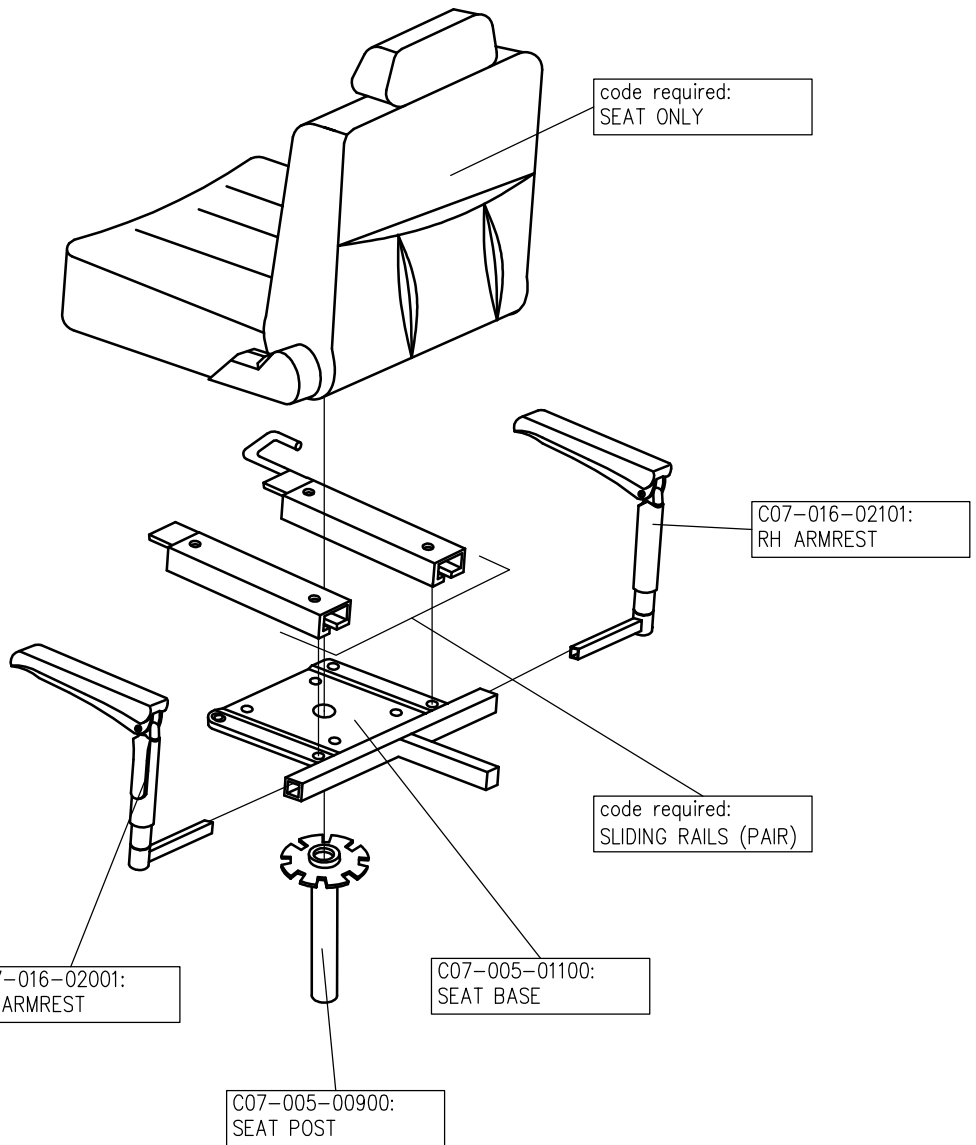

TILLER PARTS AVAILABLE:

1. C16-022-01300: LH FRONT SIGNAL LAMP
2. M41210509100: CURTIS SPEED POT
3. C08-022-03100: SHADE
4. code required: HEADLAMP SWITCH
5. M41610401000: INDOOR / OUTDOOR SWITCH
6. C11-022-00100: BATTERY INDICATOR
7. 3D2600200000: SPEED DIAL KNOB
8. L41600100000: HAZARD SWITCH
9. C16-022-00700:: HORN BUTTON
10. C11-001-00700: INDICATOR (SIGNAL) SWITCH
11. C16-022-01500: RH FRONT SIGNAL LAMP
12. C12-001-10701: FLASHER RELAY
13. M41810807000: IGNITION SWITCH AS'Y
14. M41210216000: CHARGER SOCKET
15. code required: INTERNAL TILLER HORN

**drive**<sup>™</sup>

Ainley's Industrial Estate, Elland HX5 9JP  
 T: +44 (0) 1422 314488  
 E: enquiries@drivemedical.co.uk  
 W: www.drivemedical.co.uk/technical

TITLE:

MERCURY GT  
 PARTS MANUAL

DATE: 26/07/07

SHEET No: 3

DRAWN: PMK

CHECKED:

REVISION No: A

SCALE: NTS

DWG No: Z40956

REV No.	DETAILS	DATE	DRAWN
A	8A CHARGER ADDED	16-6-14	PMK

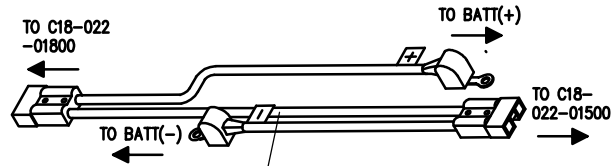

C18-022-01600: UN-FUSED BATTERY CABLE

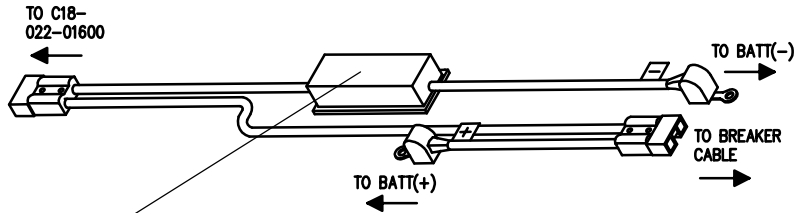

C18-022-01500: 200A FUSED BATTERY CABLE

C18-022-01300: REAR HARNESS

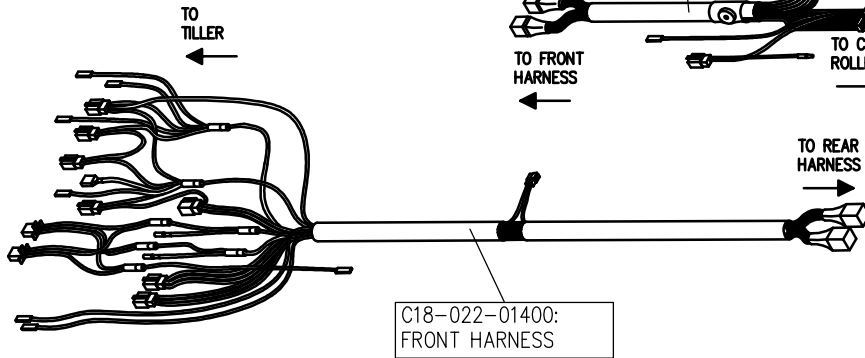
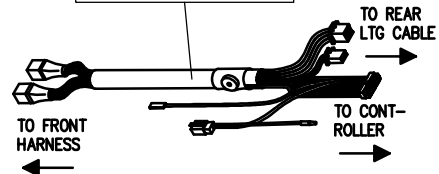

C18-022-01400: FRONT HARNESS

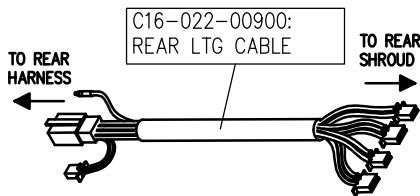

C16-022-00900: REAR LTG CABLE

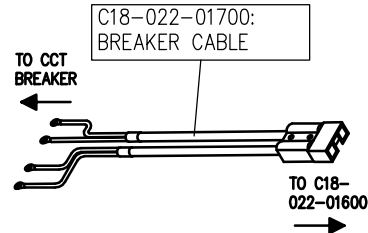

C18-022-01700: BREAKER CABLE

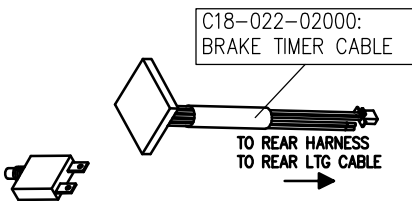

C18-022-02000: BRAKE TIMER CABLE

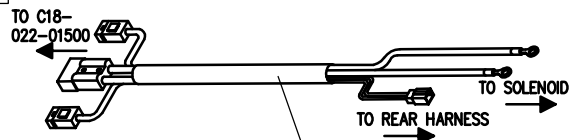

C18-022-01800: CONTROLLER CABLE (HIGH POWER FEED)

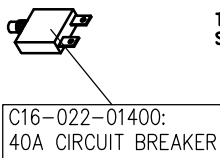

C16-022-01400: 40A CIRCUIT BREAKER

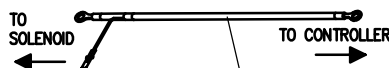

C18-022-01900: SOLENOID CABLE

C12-005-00800: 8A CHARGER (NOT SHOWN)