

# RESTWELL RISE & RECLINE ARMCHAIRS LARS AND SVEN - OWNER'S HANDBOOK

## CONTENTS

1. Introduction
2. Model Description
3. Parts Description
4. Personal Safety
5. Installation Instructions
6. Operating Instructions and Guidelines
7. Care and Maintenance
8. Specification
9. Fair Wear and Tear Policy
10. Warranty
11. Appendix A: Backrest Assembly Instruction sheet
12. Appendix B: Wiring configuration

## INTRODUCTION

The Restwell range of lift, rest and recline armchairs are designed to be both comfortable and stylish whilst also enhancing your mobility.

This armchair is available in a variety of styles and cover material to suit most décor. There are 6 models available. This manual covers all 6 models of armchair. All armchairs are made to the highest quality and are CE marked. They have a weight limit of 27½ stone (175kg), except for the manual recline armchairs which have a weight limit of 120kg (19 stone). They all feature a back rest recline / legrest elevate function.

Restwell is a brand of Drive Medical. Drive Medical is an ISO 9001:2000 certified company. For more details about our products please see your local dealer. To find your local dealer please contact:

**Drive Medical Ltd,**  
Ainley's Industrial Estate,  
Elland, United Kingdom HX5 9JP  
Tel: +44 (0) 1422 314488  
Web: [www.drivemedical.co.uk](http://www.drivemedical.co.uk)  
Email: [enquiries@drivemedical.co.uk](mailto:enquiries@drivemedical.co.uk)



## MODEL DESCRIPTION

- **The Lars Manual recline armchair.** This armchair is available in genuine Buffalo leather with PVC back match. It features easy recline control with side arm mounted cup trigger release.
- **The Lars Electric recline armchair.** This armchair is available in genuine Buffalo leather with PVC back match. It features a basic handset which reclines the backrest and elevated the legrest electrically.
- **The Lars Electric rise armchair.** This armchair is available in genuine Buffalo leather with PVC back match.
- **The Sven Manual recline armchair.** This armchair is available in genuine Buffalo leather with PVC back match. It features easy recline control with side arm mounted cup trigger release.
- **The Sven Electric recline armchair.** This armchair is available in genuine Buffalo leather with PVC back match. It features a basic handset which reclines the backrest and elevated the legrest electrically.
- **The Sven Electric rise armchair.** This armchair is available in genuine Buffalo leather with PVC back match. It features a standard handset which only requires approximately 8cm / 3" behind the armchair hence is ideal where space is a premium.

The single motor features a standard handset which only requires approximately 6cm / 2" behind the armchair hence is ideal where space is a premium.

The dual motor version allows the back rest and leg rest to operate independently.

## PARTS DESCRIPTION



## PERSONAL SAFETY

Please follow the safety guidelines below to ensure that you get the best from your armchair for many years to come. Failure to follow these guidelines could result in injury or damage:

- **Just one at a time.** *Ensure that only one person uses the armchair at a time.*
- **Footrests are for feet.** *Ensure that nobody sits or puts their entire body weight on the elevated footrest as this could result in injury and/or damage*
- **Watch for walls.** *Ensure that the armchair is out of range from walls and furniture when operating to avoid damage to upholstery and décor.*
- **Stop Child.** *Ensure that all children and pets are supervised when around the armchair. Do not allow children to use the handset, and that all visitors are aware of the potential trapping danger from mechanisms.*
- **Take your key.** *The handset comes with a key jack. It is recommended that you remove the key when you are not using the armchair to prevent any body else using the armchair and becoming trapped.*
- **Be careful of the scissor mechanism.** *The elevating leg rest uses a scissor mechanism. Please ensure that no body parts or clothing, blankets, etc are caught in the scissor mechanism when operating.*
- **Practice makes perfect.** *In certain circumstances or with some medical conditions the user needs to practice using the rise recline armchair in the presence of a trained attendant. A trained attendant may be a care professional or a family member who has been trained in assisting a rise recline armchair user with daily activities.*
- **Weight Limit.** *Observe and do not exceed the weight limits on the armchair*
- **Battery backup.** *Ensure that the battery back up is replaced very year or when the battery back up is used in the event of a power cut. See the section on Installation Instructions about inserting backup batteries.*
- **Electrical systems.** *Periodically visually inspect the handset and power cord for signs of wear, chafing or cracks. Also, ensure that no liquid or food is ingressed in to the electrical systems. Failure to do so may affect the performance of the armchair.*
- **Call for assistance.** *It is recommended that some users have a telephone to hand when using the rise recline armchair. This is in case they experience difficulty and need to call for help. Please note do not use a mobile telephone whilst operating the armchair. It is recommended that you pull out the handset key before using a mobile telephone. Failure to do so could cause damage to the electrical systems.*
- **Carelessness causes fire.** *Although the foam and fabric used on the armchair are fire retardant to legally specified levels, caution should be taken to avoid fire. Please ensure that all cigarettes and matches are properly extinguished. Also, be careful of other fire hazards such as electric and gas fires, etc nearby,*

# INSTALLATION INSTRUCTIONS

- To assemble your recline armchair, first install the back rest. Slide the back on ensuring the two back rest brackets go over the two back rest receiver brackets on the armchair. Push down hard on the back rest to lock in position. Ensure both sides of the back rest are locked in position before use. Your dealer may have done this prior to delivery. This procedure is described in more detail with photographs on a separate sheet supplied with the armchair. A copy of this sheet is also included in the back of this handbook.
- Then plug the armchair in to the mains and operate the armchair so it moves. To install the battery backup, first unplug the armchair. Then press the plastic tab on the battery compartment lid whilst removing. Install two 9V PP3 batteries in to the battery back up place on the main control box underneath the chair. Replace the battery compartment lid. (See appendix B for a photo showing the compartment's location).
- Your armchair comes supplied with all peripherals (i.e. handset and actuator) connected. If you need to plug or unplug any of the peripherals please contact your dealer for information on how to this.
- Please contact Drive Medical should you require the wiring configuration details for any of the armchairs

# OPERATING INSTRUCTIONS AND GUIDELINES

## General Operation (all electrical model)

- To allow the armchair to operate, the key jack must first be inserted in to the safety lock. This is a safety precaution and the key jack should be removed when the armchair is not in use to prevent accidental movement of the armchair.
- The power LED will illuminate when the armchair is operating.
- Ensure that you have read the section on personal safety before operating the armchair.
- The rise armchair is controlled by the standard handset. The electric recline armchair is controlled by the basic

## Operation ( Standard Handset )

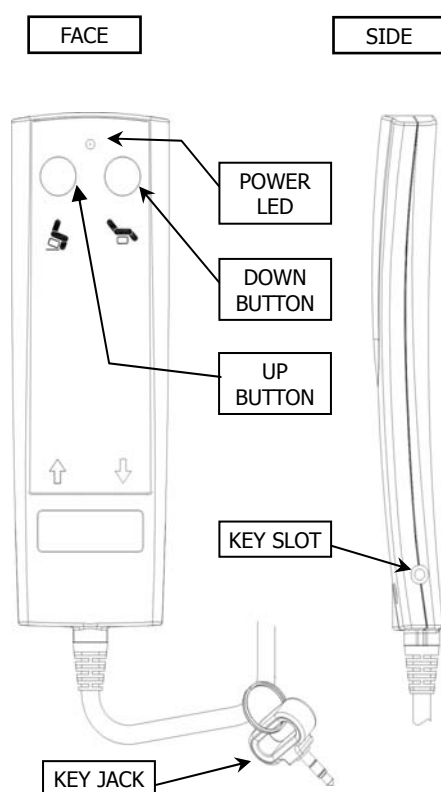

- Press the 'Up' button to raise the back rest to the upright position, lower the leg rest and raise / tilt the armchair to allow easy access.
- Press the 'Down' button to lower the armchair, elevate the leg rest and recline the back rest. The leg rest elevates and the back rest reclines simultaneously.

## Operation ( Basic Handset )

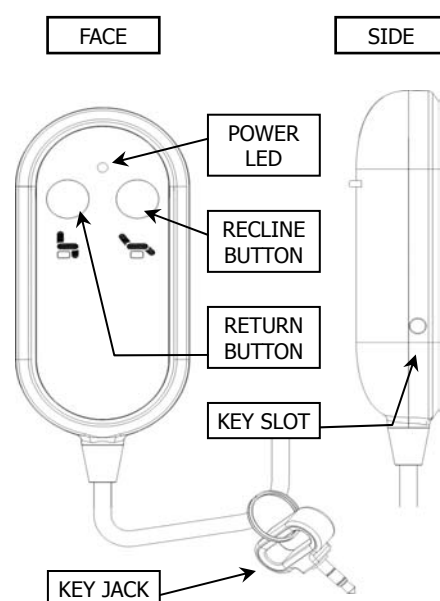

- Press the 'Recline' button to lower the armchair, elevate the leg rest and recline the back rest. The leg rest elevates and the back rest reclines simultaneously.
- Press the 'Return' button to raise the back rest and lower the leg rest to the armchair normal chair position.

## CARE AND MAINTENANCE

- **Leather care.** Periodically inspect the leather for any signs of wear or damage such as pulls, tears, or gaps. Please note that leather is a natural product and will not look the same in every location..
- **Electrical and control systems.** Periodically inspect the cord and hand control for cracks, wear, holes and loose wires.
- **Battery backup.** The Restwell range of armchairs has a battery backup system which is designed for emergency use in the event of a power failure. The battery should be replaced annually or after a power failure. The backup system has very limited power so should only be used in the event of a power failure or emergency. The backup system requires two 9V PP3 batteries.
- **Servicing.** Restwell rise recline armchairs are designed to be maintenance free and do not require regular servicing. However, if a problem does occur with your armchair or you require a spare part please contact your Drive Medical dealer..
- **Cleaning the Upholstery – all leather.** We recommend cleaning leather with a slightly moist cloth only, and not using cleaning agents. If you feel you must use a cleaning agent, please use only the agents which have been especially made for cleaning leather. Please also make sure the cloth or sponge you use to clean the leather (with warm water or special leather cleaning agents) is appropriate to use for wiping leather.

## PERSONAL SAFETY

Chair Model	Chair dimensions ( in cm / in )			Seat dimensions ( in cm / in )			Weight Limit
	Depth	Width	Height	Depth	Width	Height	
Lars Manual	100 / 39½”	90 / 35½”	104 / 41”	53 / 20¾”	44.5 / 17½”	47.5 / 18¾”	120kg
Lars Electric	100 / 39½”	90 / 35½”	104 / 41”	53 / 20¾”	44.5 / 17½”	47.5 / 18¾”	175kg
Lars Rise	100 / 39½”	90 / 35½”	110 / 43¼”	53 / 20¾”	44.5 / 17½”	51 / 20”	175kg
Sven Manual	99 / 39”	90 / 35½”	101 / 39¾”	54 / 21¼”	42 / 16½”	49.5 / 19½”	120kg
Sven Electric	99 / 39”	90 / 35½”	101 / 39¾”	54 / 21¼”	42 / 16½”	49.5 / 19½”	175kg
Sven Rise	99 / 39”	90 / 35½”	104 / 41”	54 / 21¼”	42 / 16½”	51 / 20”	175kg

- All the above dimensions are for the armchairs in their normal chair position.
- All Restwell rise & recline armchairs are CE marked and meet the relevant British Fire Retardancy Standards
- All rise & recline armchairs have a serial number label on them, which is located on the armchair frame.
- All electrical armchairs have a weight limit of 175 kg (27½ stone).
- All manual recline armchairs have a weight limit of 120 kg (19 stone).

## FAIR WEAR AND TEAR POLICY

Your new armchair is covered by the warranty below. Please note however this Warranty does not include:

- *Damage from misuse, and use over the specified weight limited.*
- *Material fading over time of through sunlight.*
- *Damage from spills or leaks.*
- *Cigarette and match burns.*
- *Collision damage ( rubbing against wall, etc)*
- *Accidental tear and damage.*
- *Damage arising from misuse (e.g. people sitting on an elevated footrest, etc)*

## WARRANTY

Your Restwell lift, rest and recline armchair comes with a comprehensive twelve-month warranty. For warranty issues and claims please contact your Drive Medical dealer.

### Warranty Conditions:

1. Any work or replacement part installation must be carried out by an authorized Drive Medical dealer / service agent.
2. To apply the warranty should your armchair require attention please contact the designated service agent listed below.
3. Should any part of the armchair require repair of full or part replacement as a result of a manufacturing or material defect within twelve-month of receiving the armchair, parts will be supplied free of charge.  
Note: The guarantee is not transferable
4. Any repaired or replaced parts will be covered by this warranty for the balance of the warranty period on the armchair.
5. Parts replaced after the original warranty has expired will be covered by a three-month warranty.
6. Consumable items supplied will not generally be covered during the normal warranty period unless such items require repair or replacement clearly as a direct result of a manufacturing or material defect.  
Such items include (among others): upholstery, batteries
7. The above warranty conditions apply to brand new chairs. If you are unsure whether your chair is covered, check with the service agent. Products supplied by Drive Medical as ex-demonstration carry a six-month warranty.
8. Under normal circumstances, no responsibility will be accepted where the armchair has required repair as a direct result of:
  - a) The armchair part not having been maintained in accordance with the manufacturer's recommendations
  - b) Failure to use the manufacturer's specified parts
  - c) The armchair or part having been damaged due to neglect, accident or improper use
  - d) The armchair or part having been altered from the manufacturer's specifications or repairs having been attempted before the service agent is notified.

In the event of your armchair requiring attention, please contact your service agent / dealer and give all relevant details so they can act quickly. Please contact Drive Medical for advice if you do not know where the armchair was originally purchased from.

The manufacturer reserves the right to alter without notice any weights, measurements or other technical data shown in this manual. All figures, measurements and capacities shown in this manual are approximate and do not constitute specification.

# DEALER STAMP

# APPENDIX A: INSTRUCTION SHEET

## BACK ASSEMBLY PROCEDURE

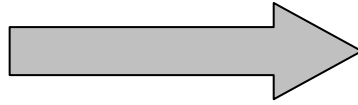

Firstly, operate the armchair so it is in the reclined position. Then position the back to line up with the bayonet slots.



To insert the back into the fixed slots, then apply pressure downwards, pushing down on the back, ensuring both sides click to lock in position.

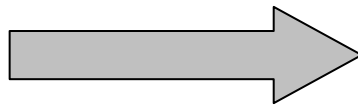
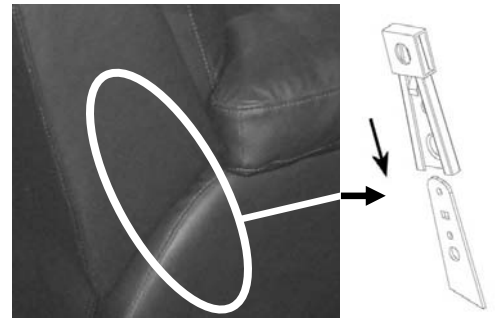

Operate the armchair to its position. Please remember to fasten the panel to the Velcro below.



\* **Note:** Before using, ensure both sides of the back are securely locked in position

## BACK REMOVAL PROCEDURE

Pull the spring strips from both sides out and up.

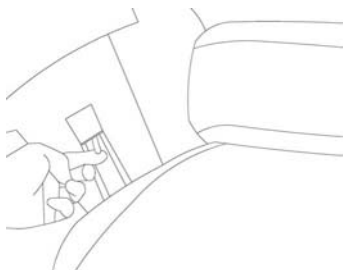

\* **Note:** To remove the back, pull the spring strips out and up simultaneously.

\* **Note:** It takes 2 people to remove the back.

# APPENDIX B: WIRING CONFIGURATION

Below shows the wiring diagram for the electric recline armchair & rise armchairs. It also shows the location of the battery back up compartment.

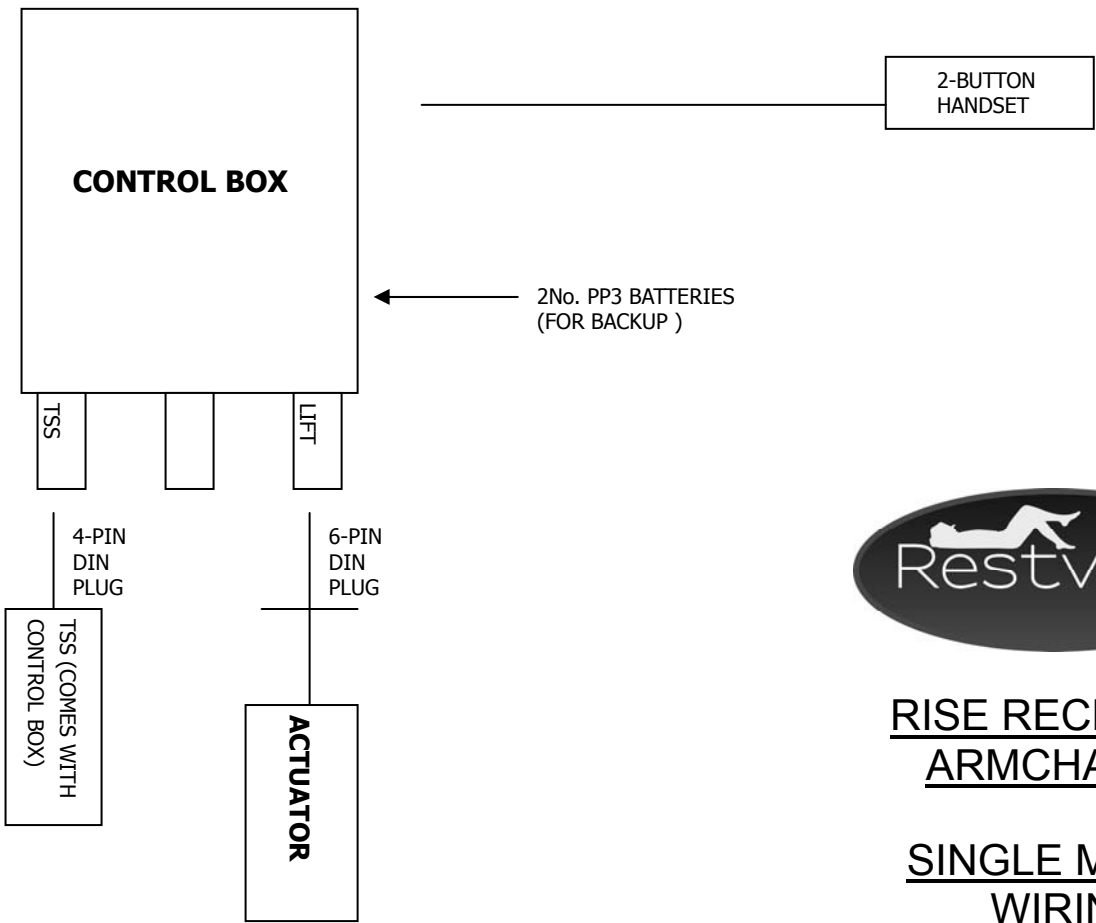
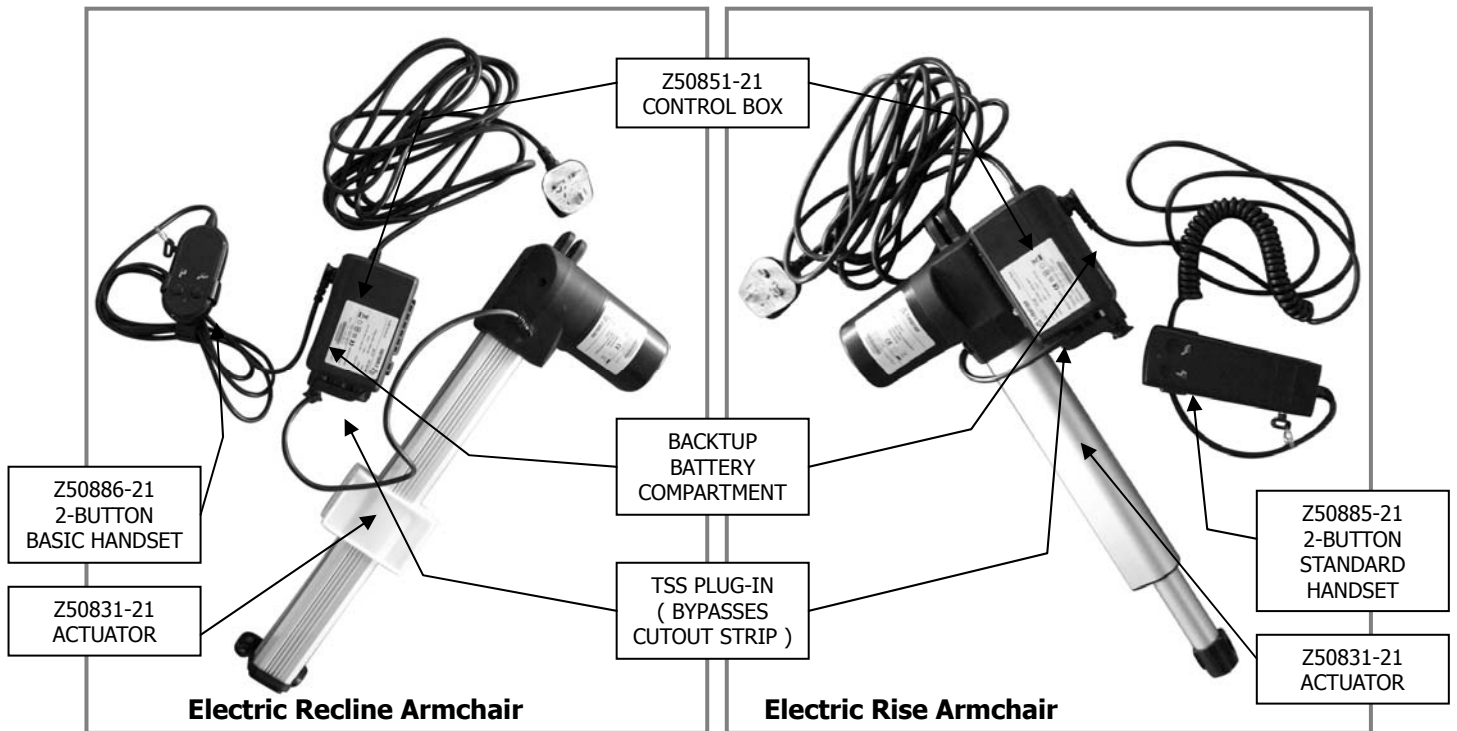

## RISE RECLINER ARMCHAIRS

## SINGLE MOTOR WIRING CONFIGURATION