

# CROSSBAR AXLE ASSEMBLY INSTRUCTIONS

(ref. SR2820900)



**Subject :** with those instructions, you have the detailed operations to assemble the crossbar axle on SAMSOFT 175 and MINI SAMSOFT 150.

**Required tools :** no specific tools.

## Step 1 :

Lubricate the suspension axle (F) and place the crossbar (E) as illustrated in the exploded view on the right, inserting the spacers (D) inside the boom (A).

Secure the attachment checking the clips (C) are well engaged in the through shaft (B) grooves.

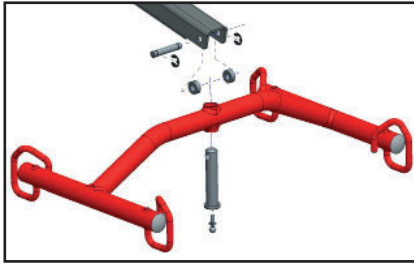

**Note :** the ball (G) is not used for MINI SAMSOFT 150.

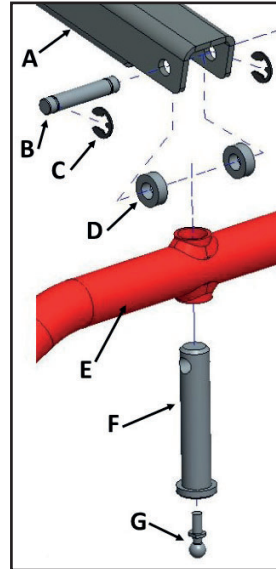

## Step 2 :

Check the assembly is correct by referring to the diagram below, and by positioning a load on the crossbar:

- MINI SAMSOFT 150 : 150 kg
- SAMSOFT 175 : 175 kg

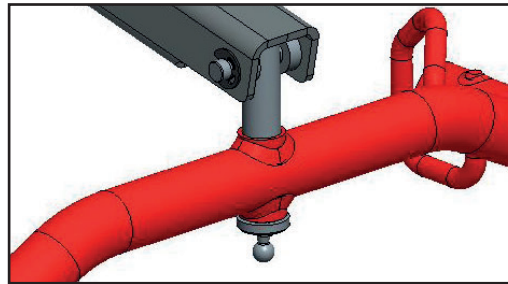

For any question or precision, you can contact the CUSTOMER SERVICE.



Drive DeVilbiss Healthcare France

Chaussée du Ban la Dame - Parc d'activités Eiffel Energie - ZAC du Ban la Dame

BP19 - 54390 FROUARD - FRANCE

Tél : +33 (0)3 83 495 495 - Fax : +33 (0)3 83 495 496 - www.drivedevilbiss.fr



Ref. M54062000 - 02/2019 - Rev. 1

# CROSSBAR AXLE ASSEMBLY INSTRUCTIONS

(ref. SR2820900)



**Subject :** with those instructions, you have the detailed operations to assemble the crossbar axle on SAMSOFT 175 and MINI SAMSOFT 150.

**Required tools :** no specific tools.

## Step 1 :

Lubricate the suspension axle (F) and place the crossbar (E) as illustrated in the exploded view on the right, inserting the spacers (D) inside the boom (A).

Secure the attachment checking the clips (C) are well engaged in the through shaft (B) grooves.

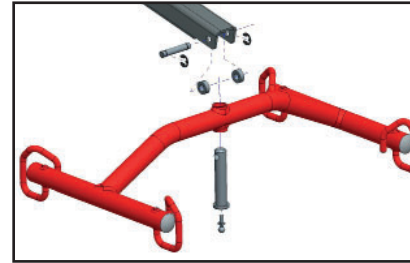

**Note :** the ball (G) is not used for MINI SAMSOFT 150.

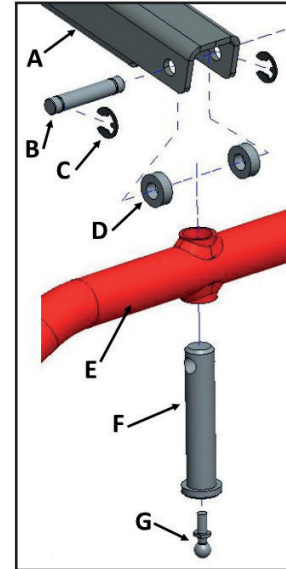

## Step 2 :

Check the assembly is correct by referring to the diagram below, and by positioning a load on the crossbar:

- MINI SAMSOFT 150 : 150 kg
- SAMSOFT 175 : 175 kg

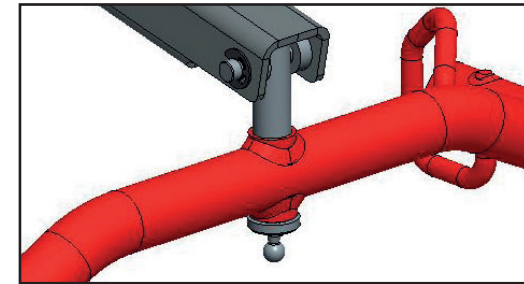
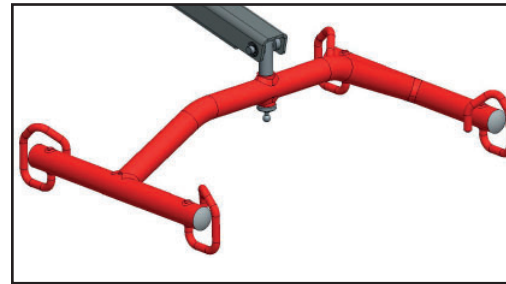

For any question or precision, you can contact the CUSTOMER SERVICE.



Drive DeVilbiss Healthcare France

Chaussée du Ban la Dame - Parc d'activités Eiffel Energie - ZAC du Ban la Dame

BP19 - 54390 FROUARD - FRANCE

Tél : +33 (0)3 83 495 495 - Fax : +33 (0)3 83 495 496 - www.drivedevilbiss.fr



Ref. M54062000 - 02/2019 - Rev. 1