

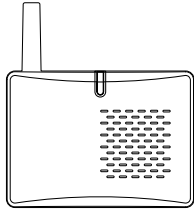

# iVISION+

Wireless Video Intercom

## IVP-GU (Gateway Chime Unit) Installation Instructions



### ATTENTION:

Thank you for purchasing the iVISION+ wireless video intercom. Before installation and usage, please read this instruction manual thoroughly and keep this safe for future reference.

### IVP-GU features

SENSOR ALERT Function with OPTEX WIRELESS2000: TC-10U & TD-20U\*1  
"OPEN DOOR" Relay Output Function \*2  
AC/DC (10~24V) Adaptable  
Chime On-Off Mode

\*1 SENSOR ALERT Function substitutes a push on IVP-DU with a sensor detection.  
OPTEX WIRELESS2000 TC-10U and/or TD-20U must be configured to work with iVISION+ system in a stable environment  
\*2 Relay Output function must meet other requirements dependent on the third party equipment.  
OPTEX will not be held responsible for any damage or injuries caused due to using this function.

## 1. IMPORTANT NOTICE

**Operations under harsh environments** such as out of warranted temperature, rapid temperature change, high humidity, constant moisturization may cause the unit to malfunction.

**Electronic device** such as TVs, Radios, PCs, Microwave ovens or any other device with an electric motor may cause the unit to malfunction.

**Impact or shocks** can cause severe damage to the unit. Please handle the unit with care and operate without exerting strong forces.

**Transmission range** of communication between units may decrease under the following conditions.

- Any unit is installed on a metal surface.
- Presence of reinforced concrete, steel doors or other metal construction materials between units.
- Places near strong radio sources such as broadcast stations or substations.

### While installing/using a Gateway Chime Unit

- Do not install/use in damp, steamy or dusty environments.
- Do not hold the Gateway Chime Unit to your ear - your hearing could be damaged.
- Do not install in an unstable location or where subject to strong vibration.

## 2. CHOOSING LOCATION

If there is a pre-existing door bell inside the house, a Gateway Chime Unit (IVP-GU) may be capable of adapting the pre-existing power wires (AC/DC 10-24V 3 Wmax).

IVP-GU bridges a communication between OPTEX WIRELESS2000 system and iVISION+ system. IVP-GU should be located in a place where the unit has a clear signal reception and transmission availability.

The performance of a IVP-GU is dependent on the transmission environment of radio signals from locations of connecting units. A communication range will be significantly reduced by more number and thickness of walls which the signal is required to pass.

For iVISION+ system, maximum communication range is around 300ft (100m) in an open air environment. Following materials may decrease the maximum communication range and may potentially cause loss of transmission signals.

- Metal barricades such as metal doors and shutters.
- Walls with aluminium foil insulation.
- Concrete or galvanized metal walls.

Gateway Chime Unit uses 2.4GHz radio frequency for iVISION+ system and 418 MHz radio frequency for expansion to OPTEX WIRELESS2000 devices.

## 3. PARTS IDENTIFICATION

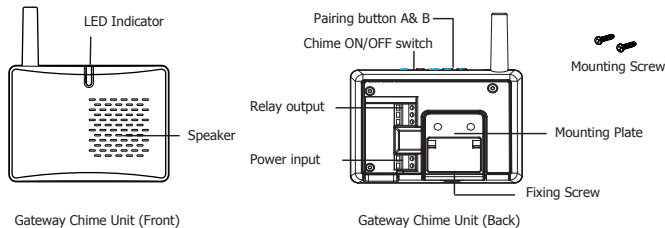

## 5. INSTALLATION

One iVISION+ system can host up to 2 units of Gateway Chime Unit (IVP-GU).

If "OPEN DOOR" Relay Output function is used, please carefully choose a location for each of IVP-GU to secure a physical access to the IVP-GU. For the optimal radio performance, mount IVP-GUs high on a wall and in an open area avoiding a metal surface and surrounding.

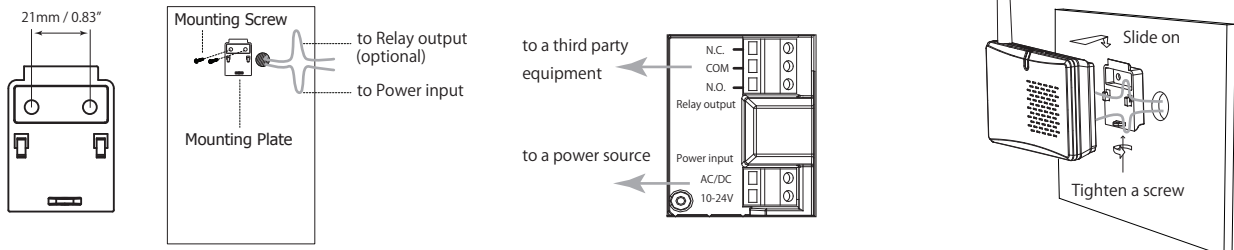

(1) Fix a Mounting Plate on a feasible location

(2) Run a power cable to the location and connect to the Power input. If applicable, also run a relay connection from the Relay output to the third party equipment.

(3) Slide the IVP-GU onto the Mounting Plate and tighten the Fixing Screw at the bottom.

## 6. PAIRING WITH IVP-HU

**NOTE: An additional Device DU, HU and GU must be paired to HU as follows:**

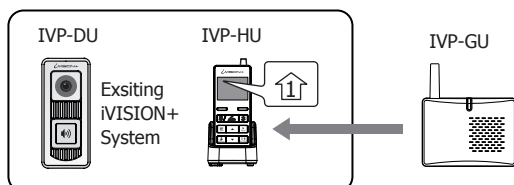

### How to add IVP-GU to HU

- (1) Press pairing button twice in the back of IVP-HU. The unit will be in "PAIRING MODE".
- (2) Proceed to "SCAN" by pressing "Left function key". IVP-HU starts scanning for other devices for 60 seconds.
- (3) Press both A and B buttons while powering up the GU to enter the pairing mode. Once IVP-GU is paired, HU shows "GW CONNECTED".

Note: if it is a just out of box, IVP-GU is in the pairing mode when powered on.

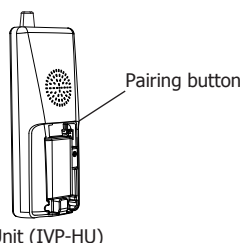

Top view

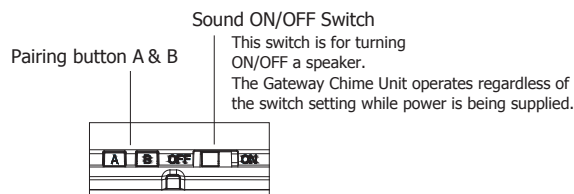

\* HOME ID is a unique identification number for your iVISION+ system.

- (4) Press IVP-DU push button once and hold pairing button located at the bottom of battery compartment until it makes a keeping sound.

## 7. PAIRING WITH OPTEX WIRELESS2000 SYSTEM

NOTE: Please configure IVP-GU before pairing WIRELESS2000 device.

To connect iVISION+ system to OPTEX WIRELESS2000 devices (e.g. TC-10U) HOME ID must be assigned to IVP-GU prior to pairing.

Gateway Chime Unit (IVP-GU) can be paired with OPTEX TC-10U & TD-20U devices.

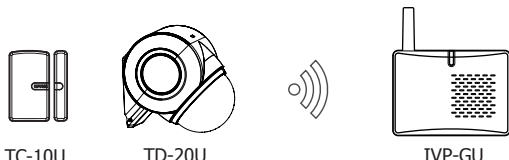

When paired with TC-10U or TD-20U, following features are available;

- If corresponding Door Camera Unit (IVP-DU) is connected to an external power source, TC-10U or TD-20U can trigger an image capture from the IVP-DU.
- IVP-GU can act as an extra chime unit in WIRELESS2000 system.

### 7-1 Pairing TC-10U & TD-20U to Gateway Chime Unit

One IVP-GU can host 2 units of TC-10U or/and TD-20U, each into zone 1 and 2. Both zone 1 and zone 2 will be associated to a Door Camera Unit (IVP-DU) which is corresponding to the IVP-GU. In total, one iVISION+ system can host 4 WIRELESS2000 devices through 2 IVP-GUs.

(STEP 1) Clear/initialize IVP-GU for a new pairing of WIRELESS2000 devices

Enter into a pairing mode by holding down B button. LED starts blinking. Select a zone by pressing B button. Hold down A button until two short beeps sound. Repeat the same process for another zone if necessary. Exit the pairing mode by holding down B button or proceed to STEP3 if pairing immediately.

- Zone 1, LED blinks slowly at 1 Hz (Green/Red)
- Zone 2, LED blinks fast at 2 Hz (Green/Red)

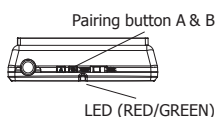

If a zone of IVP-GU already has an assigned WIRELESS2000 device, the zone will not be overwritten and register another WIRELESS2000 device. When pairing is denied, rapid beeps will sound.

(STEP 2) Prepare IVP-GU into a pairing mode

Enter into a pairing mode by holding down B button. LED starts blinking. Select a zone by pressing B button. The pairing mode continues for 30 seconds.

(STEP 3) Send pairing signal to IVP-GU

While the IVP-GU is in a pairing mode for a designated zone, trigger TC-10U or TD-20U to send a radio signal. IVP-GU will register the signal with a chime. Exit the pairing mode by holding down B button. LED stops blinking when in a normal operation mode.

NOTE: How to trigger WIRELESS2000 devices

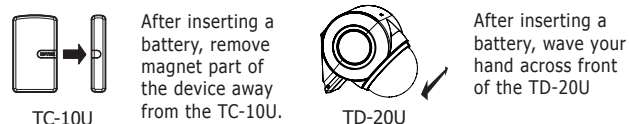

(STEP 4) Confirm operation of WIRELESS2000 devices

Trigger the paired WIRELESS2000 device. IVP-GU will blink LED and ring a chime (Sound ON/OFF Switch must be ON). IVP-HU will also respond by a chime sound unless a volume on IVP-HU is set to null. IVP-HU will also capture an image from a corresponding IVP-DU if the IVP-DU is connected to an external power source.

NOTE: Low battery notification of WIRELESS2000 devices

When any paired WIRELESS2000 has a low battery condition, IVP-GU will make a short beep following a chime sound. Low battery beep does not sound if the sound switch on IVP-GU is set to OFF.

## 8. ADDITIONAL SETTING

To change a chime volume of IVP-GU

- Press button A to acknowledge current chime volume level. Press A button again to change volume level to the next. The volume changes within 4 levels and the lowest volume will follow the loudest. Leave the setting at the desirable volume level. To completely turn off the chime, set Sound ON/OFF Switch to OFF.

SENSOR ALERT mode Enable/Disable setting

- By disabling SENSOR ALERT mode, iVISION+ system become ignorant of connected WIRELESS2000 devices. This setting is changed by holding "Right Function Key" on a Handheld Monitor Unit (IVP-HU). The LED on IVP-GU indicates the current setting. When in RED, SENSOR ALERT is Enabled. When in GREEN, SENSOR ALERT is Disabled

## 9. SPECIFICATION

### 9-1 Dimensions

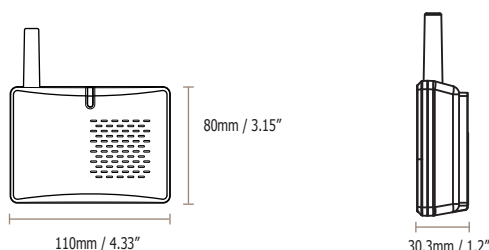

### 9-2 Specification Table

MODEL NAME: OPTEX iVISION+ (IVP-GU) Gateway Chime Unit

Operating Temperature	0 to 40 degC (32 to 104 degF)
Operating Humidity	< 90% RH (no condensation)
Dust/Water Protection	N/A (Indoor Use Only)
Radiowave Frequency	2.4 GHz and 418MHz
Power	AC/DC 10-24V 3W(max)
Relay Output	1C 50VAC/24VDC 1A max

## 10. WARRANTY

- This product is under a warranty for a normal usage for 18 months from the date of manufacturing. The date of manufacturing can be identified from a LOT number indicated on a label placed in a back of IVP-GU.

LOT: YYWWZ (e.g. LOT 1350Z)

YY indicates last two digits of the year manufactured (e.g. "13" = Year 2013)

WW indicates Xth week of the year manufactured (e.g. "50" = 50th week)

- The warranty may **not be applicable** when any of following circumstances is found.
  - Mechanical or electrical modification is made to the product and the good's appearance indicates an alterations or a significant damage.
  - The product is already been diagnosed by someone other than the manufacturer.
  - Product malfunction is resulting from an improper usage, an accident, natural disaster or any environmental event.
  - Please call our technical assistance before arranging a return.



OPTEX CO., LTD. (JAPAN)

URL: <http://www.optex.net/>

OPTEX INC. (U.S.)

URL: <http://www.optexamerica.com/>

OPTEX DO BRASIL LTDA. (Brazil)

URL: <http://www.optex.net/br/es/sec/>

OPTEX (EUROPE) LTD. / EMEA HQ (U.K.)

URL: <http://www.optexeurope.com/>