



Paper Plate Monkey

Go bananas with this fun paper plate monkey! The sturdiness of a paper plate and its round shape makes it perfect for making fun animal faces. With some paint, card and glue you can create your own jungle of paper plate animals.

You will need:

- Paper plates • Brown paint • Pink card • White card • A glass (to draw around)
- Paintbrush • Black felt tip pen • Pencil • Glue • Scissors • An adult to help you



Paint a paper plate with brown paint and leave it to dry.

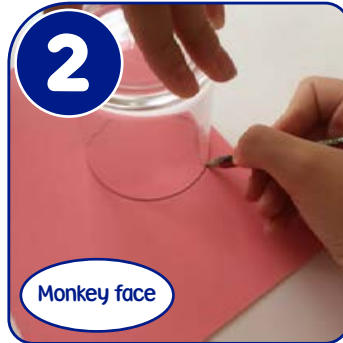

On pink card, draw around a glass three times to make a face shape.

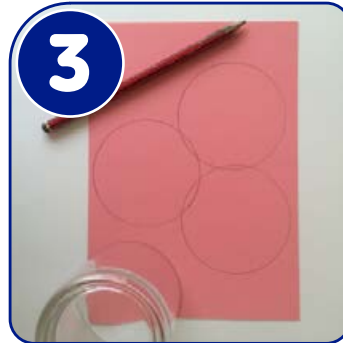

The shape should look similar to the one above.



Cut out the face shape.



Paint two large discs of white card with brown paint.



Glue a small disc of pink card to the centre of each of the brown discs.



Cut two small discs of white card and draw on black pupils.



Stick the ears, face and eyes onto the painted paper plate.



With a black felt tip pen, draw a nose and mouth onto your cheeky monkey's face. He is now ready to stick on your wall or add elastic to make a funky monkey mask!

Why not try creating some other paper plate animals like the ones we made below.

