

Perfect Fit Pleated Blinds

Fitting Guide

A Comprehensive Guide For Fitting Your New
Perfect Fit Pleated Blinds

ORDER
BLINDS



WHAT IS NEEDED

Screwdriver

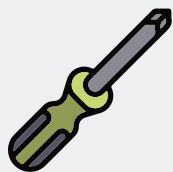

WHAT IS INCLUDED

Perfect Fit Frame + Blind

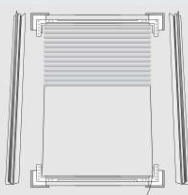

Brackets

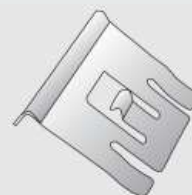

IMPORTANT INFORMATION

Be careful when opening packaging so as not to damage the fabric.

Unpack the blind and frame. Please ensure you've located the brackets before disposing of the packaging. Please also read the following instructions carefully before you start fitting your blind.

If you have any questions or need further guidance on installing your Perfect Fit Pleated Blinds, please do not hesitate to contact our customer service team on 0115 9699933 or alternatively you can email info@orderblinds.co.uk.

PUT THE FRAME TOGETHER

1

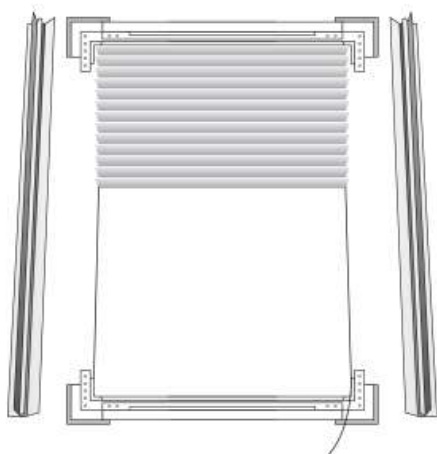

PUTTING THE FRAME TOGETHER

Lay out all the parts of the frame and blind face down on a clean even surface. Next unravel the side guide cords and control cords which will be wrapped around your blind.

Your blind will be attached to the top and bottom parts of the frame by side guide cords. Repeat on the other side of the blind.

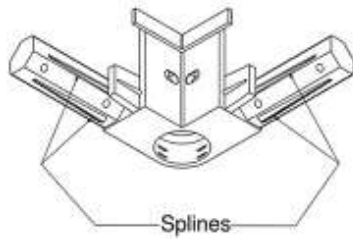

Use the push fit corner pieces to join the side rails to the top and bottom frames of the blind. Simply push them into the slots in the frame pieces to lock them into place.

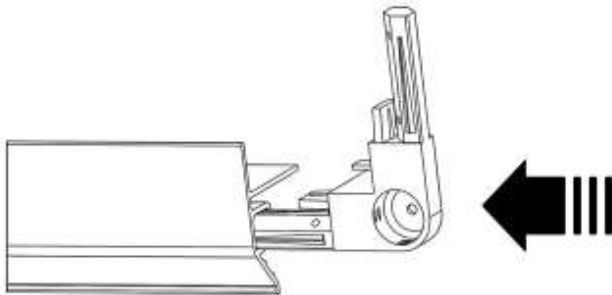

Once this has been completed, your Perfect Fit frame and blind are ready to be fitted.

ATTACHING THE BRACKETS

2



To ensure all the brackets are in the correct position for fitting use the 85mm side of the fitting card for the bottom brackets. Please use 122mm side of the card for the top brackets.

For ease of insetion, use some washing up liquid on the base of each bracket.

Line the bracket with the base or top of the fitting card and fit the bracket by pushing it between the glass and the rubber seal of the window.

Repeat for all 4 corners.

ATTACH THE FRAME AND BLIND TO THE WINDOW

3

Line up the holes in the Perfect Fit frame with the brackets, then firmly press the frame onto each bracket one side at a time. Once completed your frame and blind are now installed.

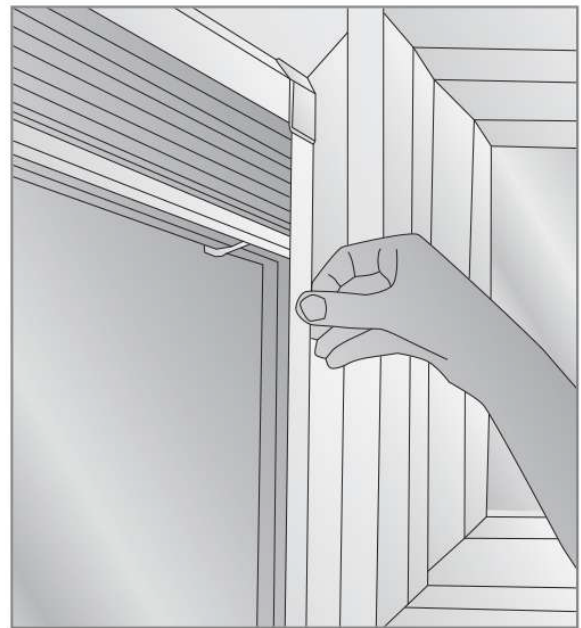

ORDER
BLINDS



ADDITIONAL INFORMATION

4

We'd love to see how your new blinds look in your home! Share your photos with us on social media, and don't forget to tag us **@orderblinds**.

Your stylish design could be featured on our page to inspire other customers. Whether it's a bold statement or a subtle touch, your space could be the perfect inspiration for others looking to refresh their home.

Please note, our opening hours are:

Monday - 9:00am - 5:00pm

Tuesday - 9:00am - 5:00pm

Wednesday - 9:00am - 5:00pm

Thursday - 9:00am - 5:00pm

Friday - 9:00am - 3:00pm

Order Blinds Online Ltd
Unit 10, Barbrey Business Park,
Orston Lane, Bottesford
Leicestershire NG13 0GY

ORDER
BLINDS 



0115 9699933



info@orderblinds.co.uk