

# #58230

220-240V~50Hz, 80W, IPX8

Hmax 2.2m Hmin 0.02m  $\frac{\nabla}{1.22m}$

# Bestway®

## Pool+Drain Pump OWNER'S MANUAL

### Shanghai

Bestway Global Holding Inc.  
No.3065 Cao An Road,  
Shanghai, 201812, China  
Tel: 86 21 6913 5588  
Fax: 86 21 5913 8383  
E-mail: info@bestway-shanghai.com

### Hong Kong

Bestway (Hong Kong) International Ltd.  
Suite 713, 7/Floor, East Wing, Tsim Sha Tsui Centre,  
66 Mody Road, Kowloon, Hong Kong  
Tel: 852 2997 7169  
Fax: 852 2997 7869  
E-mail: info@bestway-hongkong.com

### Europe

Bestway (Europe) S.r.l.  
Via Resistenza 5,  
20098 San Giuliano M.se (Mi) - Italy  
Tel: 39 02 9884 881  
Fax: 39 02 9884 8828  
E-mail: info@bestway-europe.com

### Central & South America

Bestway Central & South America Ltda  
Salar Ascotan 1282, Parque Enea,  
Pudahuel, Santiago, Chile  
Tel: 562 3203 6438  
Fax: 562 3203 6409  
E-mail: info@bestway-southamerica.com

### U.S.A.

Bestway (USA) Inc.  
3249 E. Harbour Drive, Phoenix, Arizona 85034,  
United States of America  
Tel: 1 480 838 3888  
Fax: 1 480 304 3349  
E-mail: sales@bestway-northamerica.com

### Australia

Bestway Australia Pty Limited  
Unit 10/71-83 Asquith Street,  
Silverwater, NSW 2128, Australia  
Tel: 61 2 9037 1388  
Fax: 61 2 9737 9423  
E-mail: info@bestway-australia.com

[www.bestway-global.com](http://www.bestway-global.com)  
[www.bestway-service.com](http://www.bestway-service.com)

**WARNING**  
**IMPORTANT SAFETY INSTRUCTIONS**  
**READ AND FOLLOW ALL INSTRUCTIONS**

**WARNING** – The pump is to be supplied by an isolating transformer or supplied through a residual current device (RCD) having a rated residual operating current not exceeding 30 mA.

**WARNING** – The power source on the wall of building should keep more than 4m away from pool and at a height of 1.2m at least.

**WARNING** – The appliance must be supplied by earthed power source.

**WARNING – RISK OF ELECTRIC SHOCK** – The pump cannot be used while people are inside the pool.

**DO NOT BURY CORD.** Locate cord to minimize abuse from lawn mower, hedge trimmers, and other equipment.

**WARNING – TO REDUCE THE RISK OF ELECTRIC SHOCK –**

The supply cord cannot be replaced. If the cord is damaged the appliance should be scrapped.

**WARNING** – Extension cords can't be used.

**CAUTION** – This pump is for use with storable pools only. Do not use with permanently-installed pools. A storable pool is constructed so that it is capable of being readily disassembled for storage and reassembled to its original integrity. A permanently-installed pool is constructed in or on the ground or in a building such that it cannot be readily disassembled for storage.

**IMPORTANT** – Using the pump with an unmatched electrical supply is dangerous and will result in catastrophic failure of pump.

**RISK OF ELECTRIC SHOCK** – When working with electricity, turn the electrical power off at the circuit breaker and lock breaker door. Failure to do so will result in increased risk of shock, injury and possibly death.

**DO NOT REMOVE THE GROUNDING PRONG OR MODIFY THE PLUG IN ANY WAY. DO NOT USE ADAPTOR PLUGS.** Consult a qualified electrician for any questions related to the validity of your plugs grounding.

Handle the pump with care. Do not pull or carry the pump by the power cord. Never pull a plug from the outlet by yanking the power cord. Keep cord free from abrasions. Sharp objects, oil, moving parts, and heat should never be exposed to the pump.

**WARNING** – This appliance is not intended for use by persons (including children) with reduced physical, sensory or mental capabilities, or lack of experience and knowledge, unless they have been given supervision or instruction concerning use of the appliance by a person responsible for their safety. Children should be supervised to ensure that they do not play with the appliance.

Cleaning and user maintenance must be performed by an adult above 18 years old who is familiar with the risk of electric shock.

**Caution:** Read the instruction before using the appliance and installation/reassemble each time.

**WARNING – RISK OF ELECTRIC SHOCK –** Do not put the plug into the water.

**NOTE:** Please examine equipment before use. Notify Bestway at the customer service address listed on this manual for any manufacturing defect or missing parts at the time of purchase. Verify that the equipment components represent the pump model that you had intended to purchase.

**NOTE:** The plug of pump shall be at least 3.50m away from the pool.

**NOTE:** Atmospheric conditions may affect the performance and life span of your pump. Unnecessary wear and tear may occur during periods of cold, heat and exposure to sun. Whenever possible shelter the pump from these conditions.

It is imperative to change as soon as possible all the deteriorated parts. Only use the parts approved by the manufacturer.

**IMPORTANT:** Always remember to unplug the drain pump after each using.

**NOTE:** Assembly and disassembly by adults only.

**NOTE:** The pump is used for cleaning and other maintenance of swimming pools.

Don't plug or unplug the appliance if hand is wet.

Always unplug the appliance:

- On raining days
- Before cleaning or other maintenance
- Leave it unattended on holidays

When the appliance will be not used for long time, such as in the winter, the pump should be disassembled and stored indoor.

Safekeeping the instruction. For reconstruction the pool set every time, please always refer to the instructions.

If instruction is missed, please contact with Bestway or search it in website: [www.bestway-service.com](http://www.bestway-service.com)

**NOTE:** This product is not intended for commercial use.

**SAVE THESE INSTRUCTIONS.**

## Parts Reference Overview

Before assembling the drain pump, become familiar with all parts. (See Fig.1)

P6005	P6124	P6556	P6555	P6H565
Hose Seal Ring	Hose Clamp	Hose	Adaptor	Hose Adaptor

**NOTE:** To order spare parts for the drain pump, list the part No.

## Pump Installation and Operation

1. Connect the provided hose to the drain pump by fastening the hose clamp. (See Fig.2)

**NOTE:** Two types of hose adaptors are provided to be used with different garden hoses, see Fig.3 & Fig.4 for assembly.

2. Vertically place the drain pump into the pool with the other end of hose to the drain area. (Check local regulations for drainage by-laws)

**NOTE:** Do not put the plug into the pool.

3. To turn on the pump, insert the plug into a proper socket.

**NOTE:** When the water level of the pool is less than 2cm, do not use the drain pump.

**NOTE:** Keep the drain pump vertical at all times.

**NOTE:** Do not dry run the pump.

Fig.1

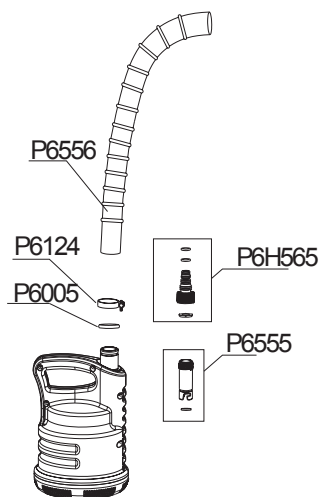

Fig.2

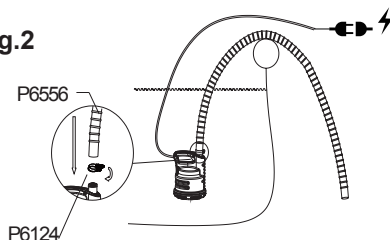

Fig.3

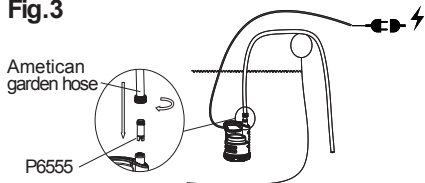
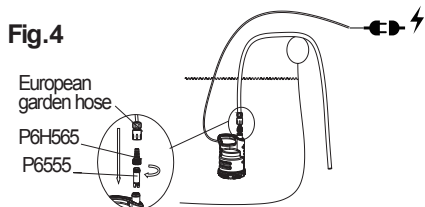

Fig.4



## Pump Maintenance and Storage

**CAUTION: YOU MUST ENSURE THE DRAIN PUMP IS UNPLUGGED BEFORE PERFORMING MAINTENANCE OR SEVERE RISK OF INJURY OR DEATH EXISTS.**

1. Unplug the pump.
2. Loosen the hose clamps, and remove the hose from the drain pump.
3. Dry the pump with a cloth and store in a dry location out of reach from children.