

Existing Site Plan 1:500

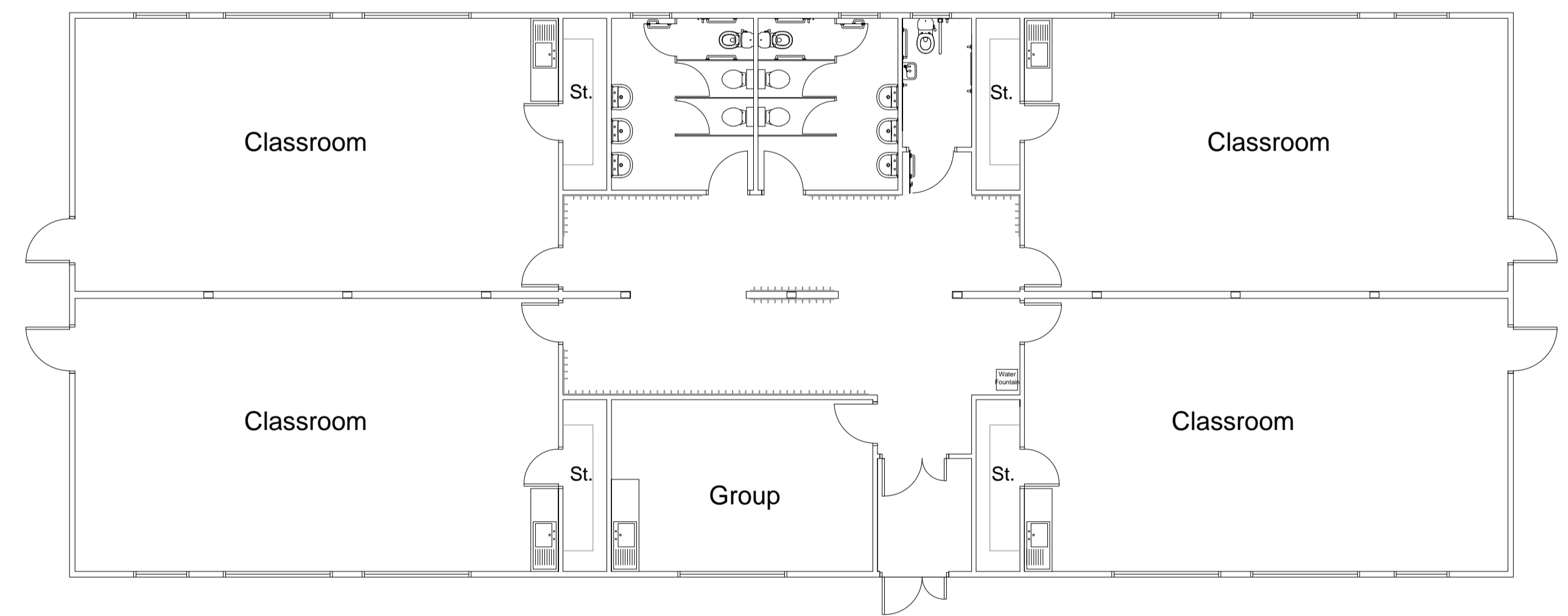

ST. JOHN VIANNEY R.C. PRIMARY SCHOOL, HILLHEAD ROAD, NEWCASTLE, NE5 1DN.	
Project title	Proposed 4 Classroom Annexe
Drawing title	Proposed Plans & Elevations
Wm C HARVEY LTD Quantity Surveyors Building Surveyors Design Consultants HARFORD HOUSE COWEN ROAD BLAYDON ON TYNE NE21 5TW Tel: 0191 414 0020 Fax: 0191 414 1097 Email: office@wmharvey.co.uk	Scale 1:100, 1:500 Date FEB 2019 Job number CH1555 Drawing number M-03FC