



# THE CLOISTER

OGLE STREET, FITZROVIA

£4,850,000



A stylish and rarely seen town house located in the wonderful and stylish area of Fitzrovia.

## The Cloister

106 Great Portland Street, London, W1W 6PF  
T. +44 (0)20 7436 6210 F. +44 (0)20 7436 7261  
E. [info@thecloister.co.uk](mailto:info@thecloister.co.uk) W. [www.thecloister.co.uk](http://www.thecloister.co.uk)  
Head Office, 64 Knightsbridge, London, SW1X 7JF





# OGLE STREET, FITZROVIA

£4,850,000



## The Cloister

106 Great Portland Street, London, W1W 6PF  
T. +44 (0)20 7436 6210 F. +44 (0)20 7436 7261  
E. [info@thecloister.co.uk](mailto:info@thecloister.co.uk) W. [www.thecloister.co.uk](http://www.thecloister.co.uk)  
Head Office, 64 Knightsbridge, London, SW1X 7JF



# OGLE STREET, FITZROVIA

£4,850,000

**Floor Qualification** We wish to inform prospective purchasers that we have prepared these sales particulars as a general guide. We have not carried out a detailed survey, nor tested the services, appliances and specific fittings. Room sizes are approximate and rounded; they are taken between internal wall surfaces and therefore include cupboards, shelves, etc. Accordingly, they should not be relied upon for carpets and furnishings. Formal notice is also given that all fixtures and fittings, carpentry, curtains, blinds and kitchen equipment, whether fixed or not, are deemed reasonable by the vendor unless specifically identified within these particulars.

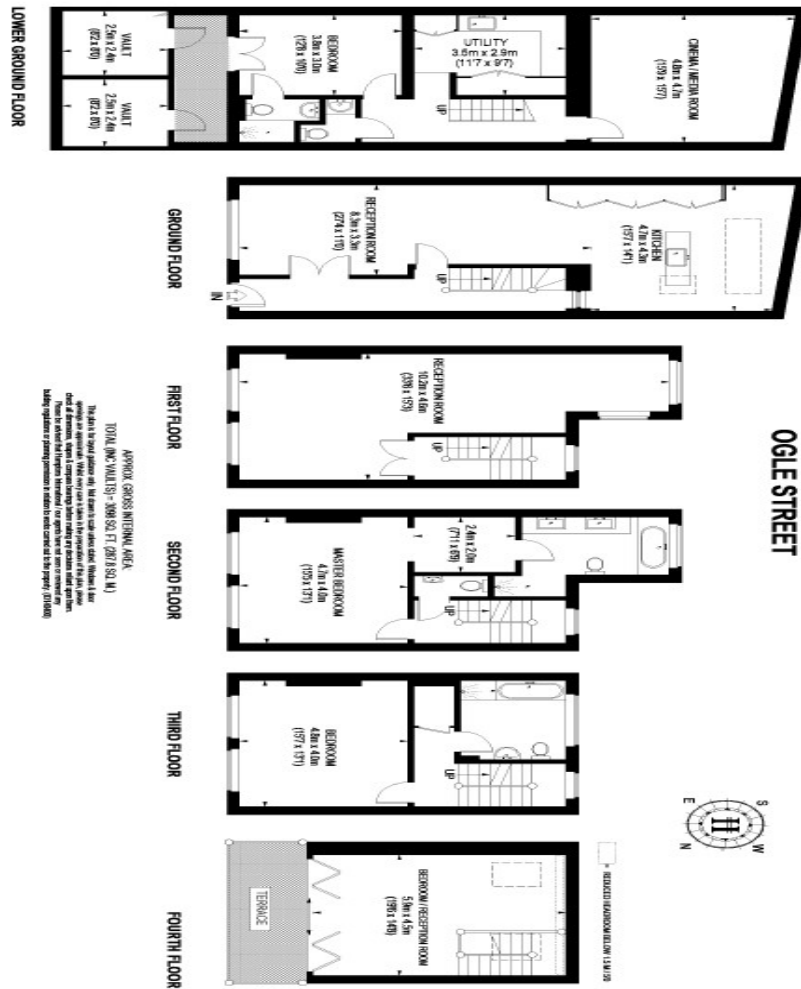

## Important Notices:

Particulars: These particulars are not an offer or contract, nor part of one. You should not rely on statements by The Cloister in the particulars or by word of mouth or in writing ("information") as being factually accurate about the property, its condition or its value. Neither The Cloister nor any joint agent has any authority to make any representations about the property, and accordingly any information given is entirely without responsibility on the part of the agents, seller(s), lessor(s) or landlord(s). Any areas, measurements or distances are approximate. The text, photographs and plans are for guidance only and are not necessarily comprehensive. Regulations etc: Any reference to alterations to, or use of, any part of the property does not mean that any necessary planning, building regulations or other consent has been obtained. A buyer, lessee or tenant must find out by inspection or in other ways that these matters have been properly dealt with and that all information is correct. All items usually known as tenant's fixtures and fittings whether mentioned or not in these particulars are excluded from the sale or tenancy but certain items may be available by separate negotiation.

Copy Right: The copyright of all details, photographs and floorplans remain exclusive to The Cloister.

## The Cloister

106 Great Portland Street, London, W1W 6PF  
T. +44 (0)20 7436 6210 F. +44 (0)20 7436 7261  
E. info@thecloister.co.uk W. www.thecloister.co.uk  
Head Office, 64 Knightsbridge, London, SW1X 7JF

