

# Week Lane, **Dawlish Warren**, EX7 0LZ



A spectacular 2 double bedroom holiday lodge situated in the secluded, luxury Tree Tops lodge development with stunning views towards the sea. It really is a home from home, offering everything you would expect from a luxury fully furnished holiday home.

£135,000

01626 862379

[www.fraserandwheeler.co.uk](http://www.fraserandwheeler.co.uk)

**FRASER & WHEELER**

## ACCOMODATION

Complete with private parking and spacious wrap around decking to enjoy those summer evenings outside. The highlight of the lodge undoubtedly its wonderful living area. Whether you choose to wind down peacefully at the end of the day, or enjoy a leisurely evening catching up with friends, you will find yourself in truly idealistic surroundings.

The beautifully designed kitchen comes with integrated fridge freezer, microwave, cooker and hob and plenty of cupboard and worktop space. The modern well equipped kitchen and adjacent dedicated dining area provide the perfect space for entertaining family and friends. The lodge also boasts a very useful utility room with further access to the decking.

The fabulous lodge has a grand master bedroom with an en-suite with shower basin and WC and its own walk in wardrobe for that extra element of extravagance. You just will love the second bedroom with a double bed and a fitted wardrobe, it is the ideal solution when there are more people to sleep under one roof.

The contemporary designed bathroom has a full sized bath and shower attachment, toilet and basin, it is easy to see that no expense has been spared with the fixtures and finishing's.

This Holiday Park has miles of picturesque towns and beautiful countryside locally waiting to be explored. The park has a season length of 11.5 months a year during which time there are no restrictions on the amount of times an owner can visit their holiday home.





This is a holiday home for sale and holiday homes do not normally qualify for a mortgage.



**Ground Floor**  
70.7 sq.m. (761 sq.ft.) approx.

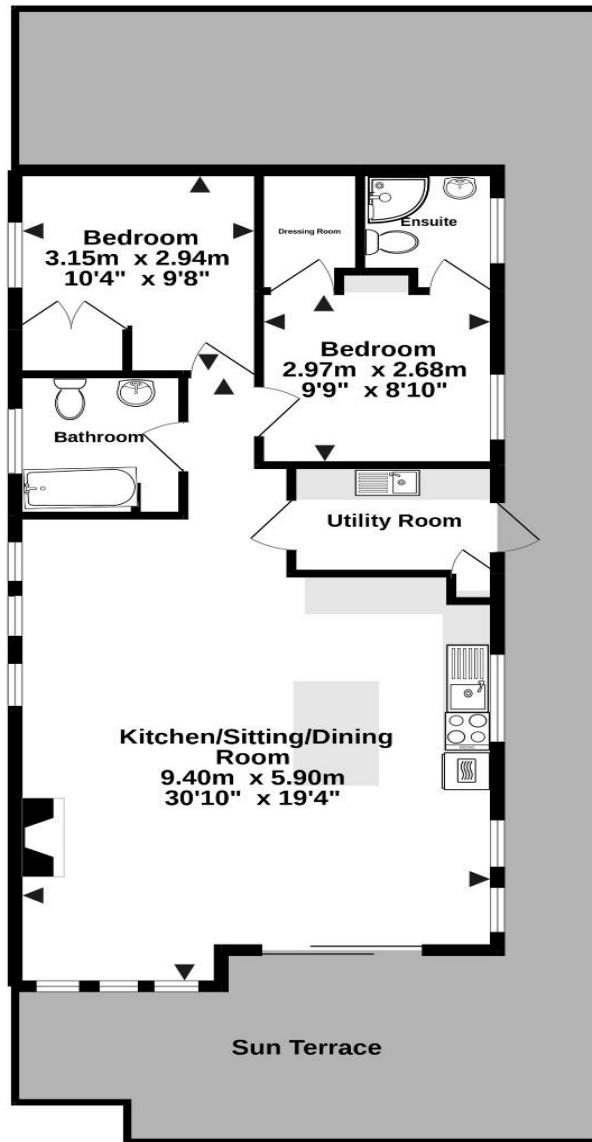

**TOTAL FLOOR AREA : 70.7 sq.m. (761 sq.ft.) approx.**

Whilst every attempt has been made to ensure the accuracy of the floorplan contained here, measurements of doors, windows, rooms and any other items are approximate and no responsibility is taken for any error, omission or mis-statement. This plan is for illustrative purposes only and should be used as such by any prospective purchaser. The services, systems and appliances shown have not been tested and no guarantee as to their operability or efficiency can be given.  
Made with Metropix ©2022

**FRASER  
&  
WHEELER**



19 Queen Street, Dawlish, Devon, EX7 9HB  
Telephone: 01626 862379  
Email: [info@fraserandwheeler.co.uk](mailto:info@fraserandwheeler.co.uk)  
[www.fraserandwheeler.co.uk](http://www.fraserandwheeler.co.uk)



Fraser & Wheeler has not tested any apparatus, equipment, fixtures and fittings or any services and cannot verify that they are in working order or fit for purpose. Prospective purchasers are advised to obtain their own independent reports from relevant professionals such as a surveyor or solicitor. Fraser & Wheeler advises buyers to make their own enquiries as to the tenure. All measurements and room descriptions are for general guide purposes only and buyers should verify information provided before purchasing furniture, fittings, carpets or appliances.