



Slades

**6 Tynham Court Bridge Street, Christchurch,
Dorset, BH23 1BL
PRICE: £265,000**

JUST A SHORT DISTANCE FROM CHRISTCHURCH HIGH STREET AND PICTURESQUE RIVER WALKS, THIS MODERNISED 2 BEDROOM GROUND FLOOR APARTMENT FOR THE OVER 55'S IS SET IN A SOUGHT AFTER COURTYARD DEVELOPMENT AND IS CLOSE TO ALL AMENITIES INCLUDING SHOPS BUSSES AND TRAIN STATION. OFFERED WITH VACANT POSSESSION.

A recently modernised purpose built 2 bedroom ground floor apartment, having been recently redecorated externally and internally and re-carpeted throughout. Situated on a sought after gated courtyard development with attractive private sun terrace and communal garden. Situated within a short walk of Christchurch High Street with all its amenities, riverside walks, 11th Century Priory and Town Quay. Regular bus services are available close to the property connecting to the surrounding areas.

An internal viewing is strongly recommended. Benefits include: Newly redecorated and carpeted throughout, double glazing, newly installed electric radiator heating and allocated car parking space.

The communal entrance door with entryphone leads to the communal entrance hall which in turn gives access to the entrance door to No 6 leading to the entrance hall comprising a broom/storage cupboard and housing the electric meter and fuse box. Entryphone. The property can also be accessed via a private door to the rear directly into the apartment.

The sitting/dining room has a feature log effect electric fire with timber fireplace surround. Twin double glazed French doors lead to the rear patio.

The kitchen comprises a range of fitted base and eye-level units with granite worktops over. Half tiled walls. Vinyl floor. Double glazed window to front. Integrated 'Neff' double stainless steel fan-assisted oven/grill. 4-ring burner electric halogen hob with extractor cooker hood over. Integrated fridge/freezer. Washing machine and dishwasher. Fitted sink with single drainer and mixer tap.

Bedroom 1 has a double glazed window to front. Double hanging wardrobe with shelving and hanging rail. Airing/storage cupboard.

Bedroom 2 has a double glazed window to the left-hand side. Built-in range of wardrobes with shelving and hanging rail.

The bathroom has a fitted white suite comprising panelled bath with 'Aqualisa' shower and screen, vanity basin and enclosed w.c. Vinyl floor. Part tiled walls.

To the rear of the property is a small paved patio with outside light and trellis fencing.

1 ALLOCATED CAR PARKING SPACE with pegola style covering.

There is a single timber gate giving access into the courtyard via a pathway from Bridge Street plus security gates which also provide vehicular access. Use of communal gardens.

N.B. The property is sold with an age restriction of 55 years and above.

A summary of the accommodation comprises:-

COMMUNAL ENTRANCE HALL
ENTRANCE HALL
SITTING/DINING ROOM: 16'6" x 16'1" (5.03m x 4.9m)
KITCHEN: 11'3" x 10'4" (3.43m x 3.15m)
BEDROOM ONE: 12' x 11'10" (3.66m x 3.61m)
BEDROOM TWO: 11' x 10'3" (3.35m x 3.12m)
BATHROOM

COUNCIL TAX BAND: D

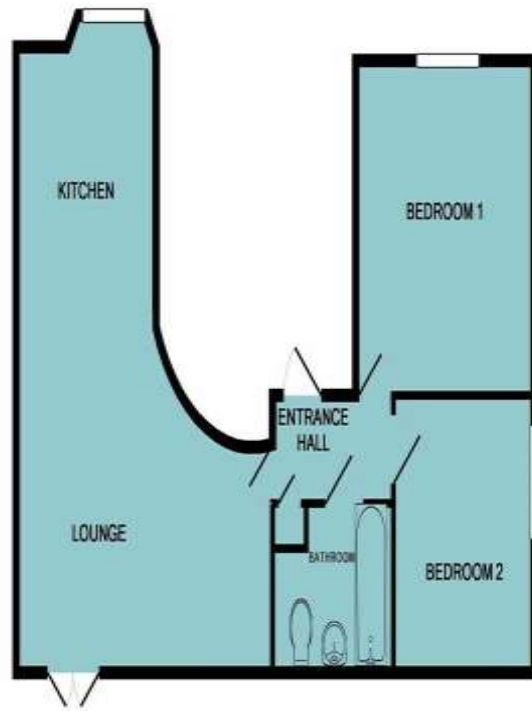

TOTAL APPROX. FLOOR AREA 56.5 SQ.M. (608 SQ.FT.)

Whilst every attempt has been made to ensure the accuracy of the floor plan contained here, measurements of doors, windows, rooms and any other items are approximate and no responsibility is taken for any error, omission, or mis-statement. This plan is for illustrative purposes only and should be used as such by any prospective purchaser. The services, systems and appliances shown have not been tested and no guarantee as to their operability or efficiency can be given.
 Made with Metropix 62017



THE CONSUMER PROTECTION FROM UNFAIR TRADING REGULATIONS (CPRs) The Agent has not tested any apparatus, equipment, fixtures and fittings or services and so cannot verify that they are in working order or fit for the purpose. A Buyer is advised to obtain verification from their Solicitor or Surveyor. References to the Tenure of a Property are based on information supplied by the Seller. The Agent has not had sight of the title documents. A Buyer is advised to obtain verification from their Solicitor. If you are interested in buying this property it is important that you contact us at the earliest opportunity. Items shown in photographs are NOT included unless specifically mentioned within the sales particulars. They may however be available by separate negotiation. Buyers must check the availability of any property and make an appointment to view before embarking on any journey to see a property. If you are making a cash offer, we shall require written confirmation of the source and availability of your funds in order that our client may make an informed decision.

DATA PROTECTION ACT 1998 Please note that all personal information provided by customers wishing to receive information and/or services from the estate agent will be processed by the estate agent, the TEAM Association Consortium Company of which it is a member and TEAM Association Limited for the purpose of providing services associated with the business of an estate agent and for the additional purposes set out in the privacy policy but specifically excluding mailings or promotions by a third party. If you do not wish your personal information to be used for any of these purposes, please notify your estate agent.



7 Castle Street, Christchurch, Dorset BH23 1DP
 Tel: (01202) 474202 or e-mail: enquiries@sladeschristchurch.co.uk
www.sladeshomes.co.uk

Energy Efficiency Rating		Current	Potential
Very energy efficient - lower running costs			
(92 plus) A			
(81-91) B			
(69-80) C		71	75
(55-68) D			
(38-54) E			
(21-38) F			
(1-20) G			
Not energy efficient - higher running costs			
England & Wales		EU Directive 2002/91/EC	