

Randalls Farm Barway CB7 5UB
£520,000

Balmforth
Estate Agents, Valuers & Letting Agents



This commercial unit extends to around 5,000 sq ft and is situated in Barway, around 10 minutes south of Ely. The unit is split into two parts, the front brick barn dating from the 1950's, of around 1,400 sq ft and the rear Atcost concrete portal barn extending to around 3,500 sq ft.

Both are offered with vacant possession, as a Freehold sale. Although the units have not been recently used, in previous years, they have been used for general and agricultural storage and prospective purchasers must make their own planning enquiries. A full building survey report is available and can be supplied on request.

We have been advised by the vendors that there are no working services on this site and prospective purchasers should therefore make their own enquires.

There is considerable residential development opportunities for the site and the vendors will require an overage for any achieved dwellings in excess of three.

UNIT 1 Atcost portal barn

60'0" x 60'0" (18.29m x 18.29m)

UNIT 2 Brick Barn

60'0" x 24'0" (18.29m x 7.32m)

VIEWING

By appointment through Balmforth Estate Agents, Valuers & Lettings Agents

T: 01638 711171 E:

mildenhall@balmforth.co.uk

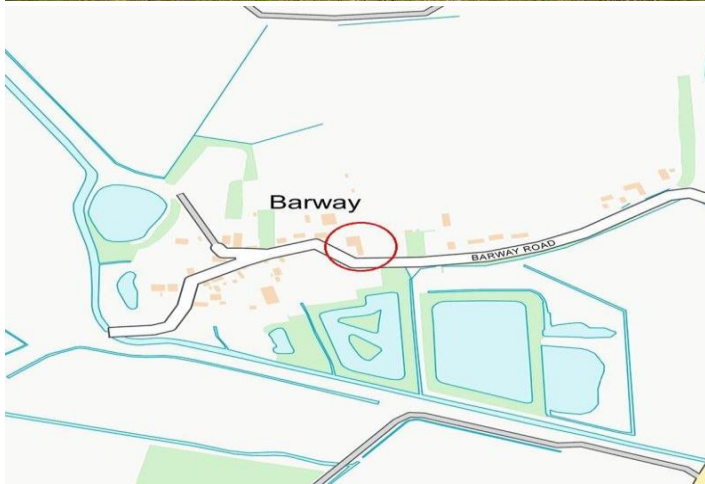

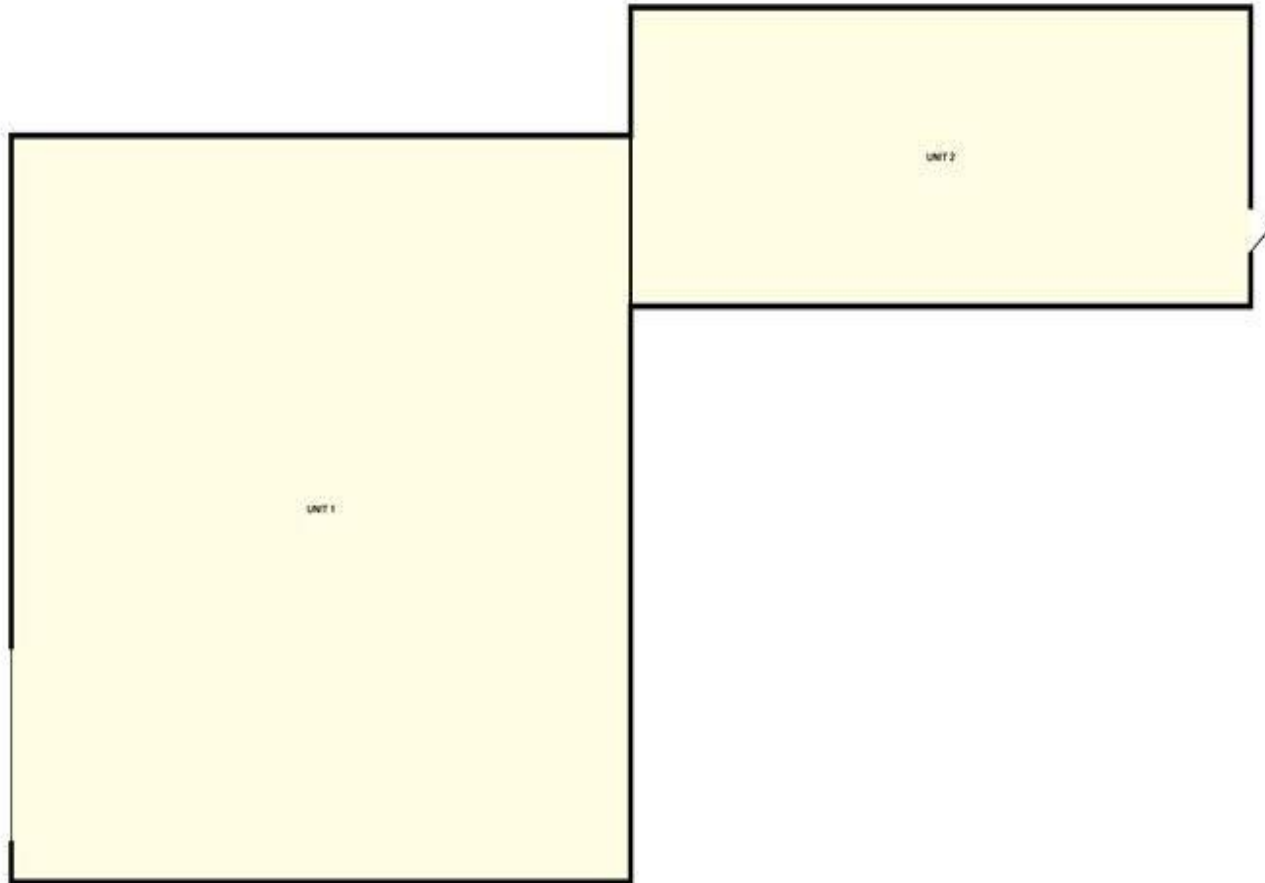

NO EPC REQUIRED

DETAILED INFORMATION AND SIGHT OF DOCUMENTS
 When used, please take care to check the accuracy of the information provided. Information
 is only given, made and any other work or equipment provided is used to the best
 of our ability. The agent is not liable for any loss or damage caused by the use of the
 information provided. The services, facilities and equipment shown here are not intended to be used
 in a way which is not intended or approved.

DISCLAIMER

The Agent has not tested any apparatus, equipment, fixtures and fittings or services and so cannot verify that they are in working order or fit for the purpose. A Buyer is advised to obtain verification from their Solicitor or Surveyor. References to the Tenure of a Property are based on information supplied by the Seller. The Agent has not had sight of the title documents. A Buyer is advised to obtain verification from their Solicitor. Items shown in photographs are NOT included unless specifically mentioned within the sales particulars. They may however be available by separate negotiation. Buyers must check the availability of any property and make an appointment to view before embarking on any journey to see a property. For further information see Consumer Protection from Unfair Trading Regulations 2008 – <http://bit.ly/sW9JSS>

DATA PROTECTION ACT 1998

Please note that all personal information provided by customers wishing to receive information and/or services from the estate agent will be processed by the estate agent, the TEAM Association Consortium Company of which it is a member and TEAM Association Limited for the purpose of providing services associated with the business of an estate agent and for the additional purposes set out in the privacy policy (copies available on request) but specifically excluding mailings or promotions by a third party. If you do not wish your personal information to be used for any of these purposes, please notify your estate agent.

DRAFT DETAILS

FBM7972



22-26 High Street, Mildenhall,
 Suffolk, IP28 7EQ
 Tel: 01638 711171
 Email: mildenhall@balmforth.co.uk
www.balmforth.co.uk