



Knowing Your Radio

www.motorolasolutions.com

Looking After Your Radio

Never leave your radio or battery in extreme temperatures (over +85 °C). For example, behind a windscreen in direct sunlight.

The radio is submersible (compliant with the IP68 standard), but only with the battery and antenna attached.

To clean your radio, use a moistened or antistatic cloth.

Ensure no contamination is on the gore port membrane, that is the area labelled as **VENT** on the back of the radio chassis.

Holding Your Radio

The radio has three microphones:

- A top front microphone for Simplex group, dispatcher, or private calls.
- A top back microphone for optional noise cancellation.
- A bottom microphone for Duplex, telephone-like calls.

1. When using high audio, hold your radio vertically with the top microphone 5–10 cm away from your mouth.
2. Speak into the top microphone.
3. Listen through the speaker.
4. Keep the antenna at least 2.5 cm away from your head and body.

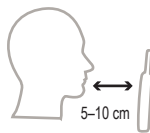

Simplex Calls

1. When using low audio, hold your radio as you would a telephone.
2. Speak into the bottom microphone.
3. Listen through the earpiece.
4. Keep the antenna at least 2.5 cm away from your head and body.



Duplex Calls

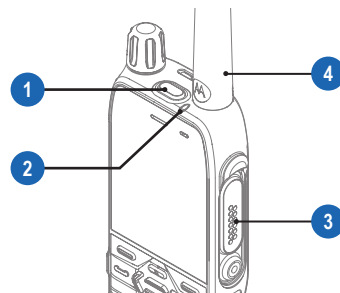

- 1 Emergency Button
- 2 LED Status Indicator
- 3 GCAI-Mini Connector
- 4 Antenna

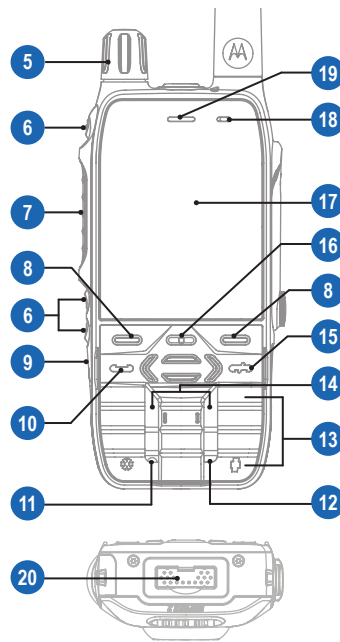

- 5 Rotary Knob
- 6 Programmable Button
- 7 Push-To-Talk Button (PTT)
- 8 Soft Key
- 9 Near-Field Communication Tag
- 10 Send Key
- 11 Bottom Microphone
- 12 Backlight Sensor
- 13 Keypad
- 14 Speaker
- 15 On/Off/End/Home Key
- 16 Menu Key
- 17 Display
- 18 Top Microphone
- 19 Earpiece
- 20 Bottom Connector

Installing the Battery

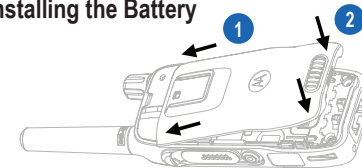

1. Insert the battery into the compartment at a high entry angle.
2. Slide the battery under the two catches.
3. Press down the battery until it clicks in place.

Removing the Battery

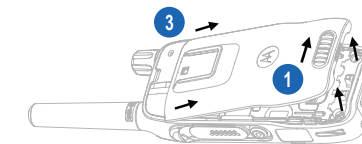

1. Slide the battery latch to the right and hold it.
2. Lift the battery.
3. Remove the battery from the compartment.

Attaching the Antenna

1. Turn off the radio before attaching the antenna.
2. Insert the threaded base of the antenna into the terminal on top of the radio.
3. Turn the antenna clockwise until snug. Do not force.

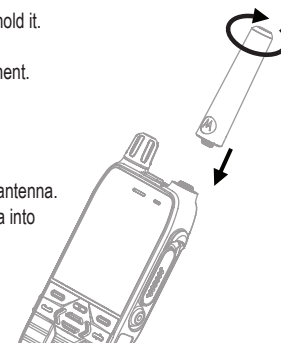

Turning the Radio On or Off

To turn the radio on or off, press and hold the **On/Off** key.

LED Status Indicator

Indication	Status when Not Charging	Status when Charging
Solid green	In use	Fully charged
Blinking green	In TMO service or idle/ Switching from TMO to DMO	90% charged
Solid red	Out of service	Rapid charge
Blinking red	Connecting to a network/ Switching from DMO to TMO	Faulty or invalid battery
Solid orange	Radio is powering on/ Transmit Inhibit mode in service	Not applicable
Blinking orange	Incoming private or phone call	Battery on standby to rapid charge
No indication	Radio powered off/ Radio in covert mode	Not applicable

Battery Capacity Information

Information	Description
	Full (80%–100% capacity)
	Middle (60%–80% capacity)
	Low (25%–60% capacity)
	Very low (5%–25% capacity)
	Less than 5% capacity

More Information on the Radio

Visit the Motorola Solutions Web site at:
<http://www.motorolasolutions.com/>

Learning Experience Portal

User documentation available at:
<https://learning.motorolasolutions.com/>

Open Source Software Legal Notices

Available in Customer Programming Software Plus (CPS Plus) DVD



This document is copyright protected. Duplications for the purpose of the use of Motorola Solutions products are permitted to an appropriate extent. Duplications for other purposes, changes, additions or other processing of this document are not permitted. Only this electronically-saved document is considered to be the original. Duplications are considered merely copies. Motorola Solutions, Inc., and its subsidiaries and affiliates do not vouch for the correctness of such kinds of copies.

MOTOROLA, MOTO, MOTOROLA SOLUTIONS and the Stylized M Logo are trademarks or registered trademarks of Motorola Trademark Holdings, LLC and are used under license. The Bluetooth® word mark and logos are registered trademarks owned by the Bluetooth SIG, Inc. and are used under license. All other trademarks are the property of their respective owners.
© 2020 Motorola Solutions, Inc. All rights reserved.

MN006359A01-AA



Status Icons

Icon	Description
	In Service (TMO)
	No Service (TMO)
	Signal Strength
	High RF Power
	Direct Mode (DMO)
	Emergency Mode
	Battery Strength
	Battery Charging
	All Ring Tones Off
	Simplex Ring Muted
	Duplex Ring Muted
	Scan
	Migration

Icon	Description
	Low Audio
	High Audio
	Earpiece Connected
	New Message Has Arrived
	New Message In Inbox
	Packet Data
	Keys Locked
	GNSS
	Non-Formatted SD Card
	USB Connected
	Bluetooth Enabled
	Wi-Fi Strength
	Wi-Fi OTAP

Unlocking the Radio

To unlock the radio after powering on, enter the code at the prompt. The default code is 0000. Your service provider may change this number before you receive your radio.

Unlocking or Locking the Keypad

To unlock or lock the keypad, press the **Menu** key followed by the * key.

Using the Radio Menu

To enter the menu, press the **Menu** key. To scroll through the menu, press the **Up** or **Down Navigation** button.

To select a menu item, press the **Select** soft key or the **Right Navigation** key.

To return to the previous level, press **Back** or the **Left Navigation** key.

To exit the menu, press the **Back** key.

Selecting TMO or DMO

From the home screen, select **Options** → **Trunked Mode** or **Direct Mode**.

Making TMO or DMO Group Calls

1. From the home screen, press the **Navigation** keys or turn the **Rotary Knob** to highlight the desired talkgroup.
2. Press **Select**.
3. Press and hold **PTT**.
4. Wait for the Talk Permit Tone (if configured) and talk.
5. To listen, release **PTT**.

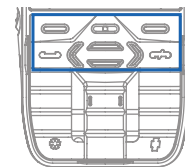
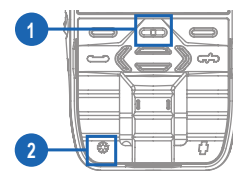

Making TMO or DMO Emergency Group Calls

1. Press and hold the **Emergency** button. The emergency alarm is sent automatically (if configured).
2. Press and hold **PTT**.
3. Wait for the Talk Permit Tone (if configured) and talk. Release **PTT** to listen. If using the Hot Mic feature, wait for the **Emergency Mic On** message to appear on the display, then talk without pressing **PTT**.
4. To exit Emergency Mode, press and hold the **Exit** soft key.

Making Simplex Private Calls

In DMO:

1. From the home screen, dial a number.
2. Press and hold **PTT** to make a call.
3. Wait for the Talk Permit Tone (if configured) and talk. Release **PTT** to listen.
4. To terminate the call, press the **End** key.

In TMO:

1. From the home screen, dial a number.
2. Press **PTT** to make a call. Wait for the called party to pick up.
3. When the call is connected, press and hold **PTT** to talk. Wait for the Talk Permit Tone (if configured). Release **PTT** to listen.
4. To terminate the call, press the **End** key.

Making Duplex Private, Phone, or PABX Calls

1. From the home screen, dial a number.
2. Press the **Send** key. The ring tone sounds till the called party answers.
3. To terminate the call, press the **End** key.

Sending Status Message

1. From the home screen, press the **Menu** key.
2. Select **Messages** → **Send Status**.
3. Highlight the required status message and press the **Send** key.
4. If the list is empty, enter a 5-digit status message number and press the **Send** key.