

How to use the Delta Clamp Dock

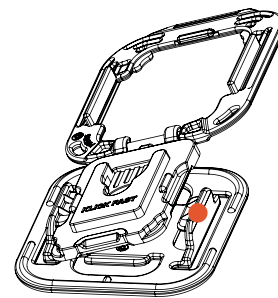

1. To release the locking ring, use the tab located at the bottom of the locking ring. Push the tab upwards to release the locking ring.

2. Remove the Klick Fast Dock: Pull one of the support tabs away from the Klick Fast Dock. Then, pull the Klick Fast Dock towards you to release it.

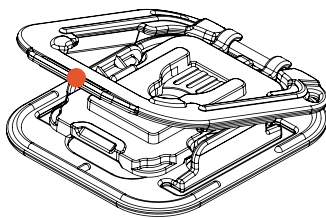
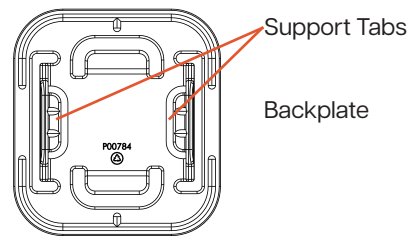
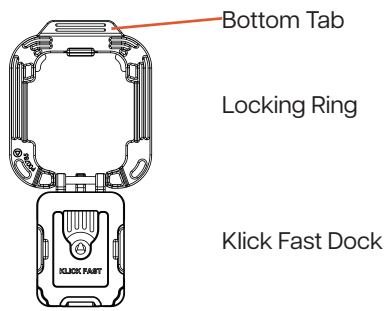
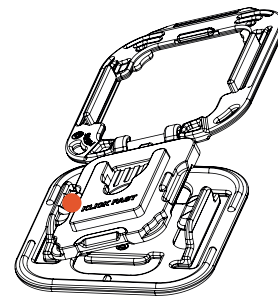
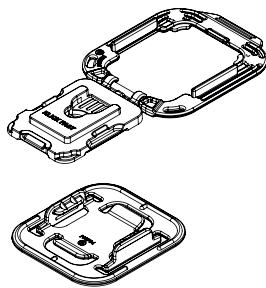

3. Position the back plate of the Delta Clamp inside the garment.

4. Insert the Klick Fast Dock on the right side of the garment. Push the Klick Fast Dock into the support tabs on the back plate that is under the garment. Angle it to one side to make the insertion easier.

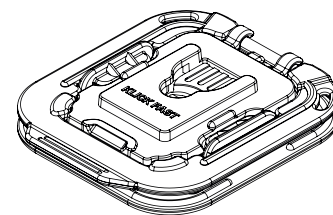
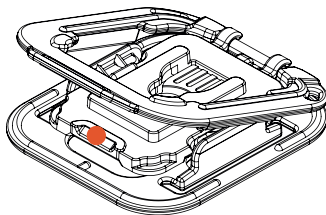

5. Secure the Klick Fast Dock: Fold the locking ring down and push until you hear a click, indicating that it is securely fastened.

6. Attach your device using one of our Klick Fast Connectors.