



The Grove, Isleworth, TW7 4JF

**One Bedroom Ground Floor Apartment | Direct Access To Small Private Garden
Own Private Entrance & Rear Residents Car Park |
Close To Local Amenities, A4, Isleworth Train Stn & Osterley Underground Station |
Approx 491Sq Ft Of Internal Floor Area**

Asking Price: £280,000

HUNTERS®
HERE TO GET *you* THERE

The Grove, Isleworth, TW7 4JF

One Bedroom Ground Floor Apartment
 Direct Access To Small Private Garden
 Own Private Entrance & Rear Residents Car Park
 One Of Old Isleworths Most Prestigious Roads
 Close To Local Amenities, A4, Isleworth Train
 Stn & Osterley Underground Station
 Approx 491Sq Ft Of Internal Floor Area

RECEPTION ROOM

6.3M X 3.6M

BEDROOM 1

3.99m (13' 1") X 2.49m (8' 2")

ENERGY PERFORMANCE RATING

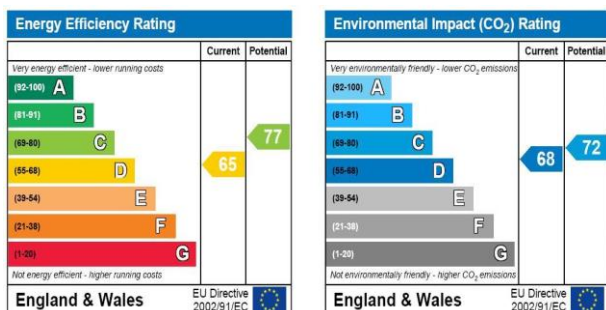

The energy efficiency rating is a measure of the overall efficiency of a home. The higher the rating the more energy efficient the home is and the lower the fuel bills will be.

OPENING HOURS

Mon - Fri: 8:30 - 18:30

Sat: 10:00 - 16:00

THINKING OF SELLING?

If you are thinking of selling your home or just curious to discover the value of your property, Hunters would be pleased to provide free, no obligation sales and marketing advice. Even if your home is outside the area covered by our local offices we can arrange a Market Appraisal through our national network of Hunters estate agents.

Hunters 104 High Street, Brentford, Middlesex,
 TW8 8AT 020 8568 2929
 brentford@hunters.com

VAT Reg. No 259 3650 77 | Registered No: 10390539 England and Wales
 Registered Office: Ground Floor 143-145 Broadway, West Ealing, London, W13 9BE
 A Hunters Franchise owned and operated under licence by Brent Property Ltd

DISCLAIMER

These particulars are intended to give a fair and reliable description of the property but no responsibility for any inaccuracy or error can be accepted and do not constitute an offer or contract. We have not tested any services or appliances (including central heating if fitted) referred to in these particulars and the purchasers are advised to satisfy themselves as to the working order and condition. If a property is unoccupied at any time there may be reconnection charges for any switched off/disconnected or drained services or appliances - All measurements are approximate.

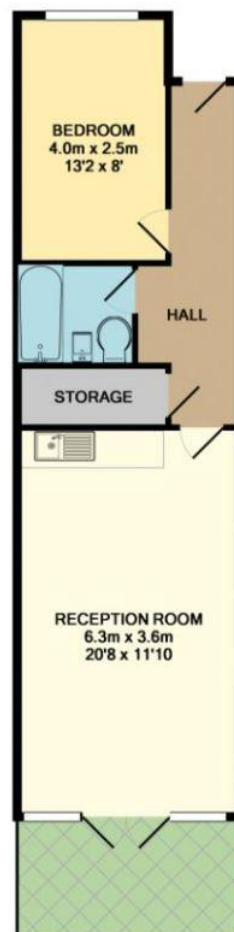

TOTAL APPROX. FLOOR AREA 45.6 SQ.M. (491 SQ.FT.)

Whilst every attempt has been made to ensure the accuracy of the floor plan contained here, measurements of doors, windows, rooms and any other items are approximate and no responsibility is taken for any error, omission, or mis-statement. This plan is for illustrative purposes only and should be used as such by any prospective purchaser. The services, systems and appliances shown have not been tested and no guarantee as to their operability or efficiency can be given.