



Anson Road, London, NW2

Two Bedroom Flat | Period Conversion | Integrated Kitchen | Wooden Floors

Open Plan Reception | Available Now |

£420.00 | Per Week

HUNTERS[®]
HERE TO GET *you* THERE

Anson Road London, NW2

Anson Road, NW2. A period style terraced house set over three floors recently converted into five magnificent flats, situated in this lovely tree lined residential street which is located between Cricklewood and Willesden Green.

This modern two bedroom flat comprises of an open plan living area with wooden floor, a white gloss kitchen and stainless steel appliances, integrated fridge/freezer and washer/dryer, 2 double bedrooms with fitted wardrobes and carpets, separate modern shower room, entry phone intercom system, gas central heating and double glazing.

The property is also ideally situated for food shopping with Somerfield and Sainsbury's at either end of the main high road. This is a splendid area to live, filled with character with a huge range of excellent places to eat, from simple diners and cafes to upmarket deli's and fine restaurants. Cricklewood offers really excellent transport links into Central London with the Jubilee

Line (zone 2), overland (National Rail) and bus routes to Brent Cross Shopping Centre (260 & 266), Golders Green (226).



0203 823 2000

willesdengreen@hunters.com

33 Walm Lane, London, NW2 5SH



VIEWING ARRANGEMENTS

By appointment with Hunters at: 33 Walm Lane, London, NW2 5SH

OPENING HOURS

Monday – Friday 8.30am – 6.30pm
Saturday 10.00am – 4.00pm

Anson Road

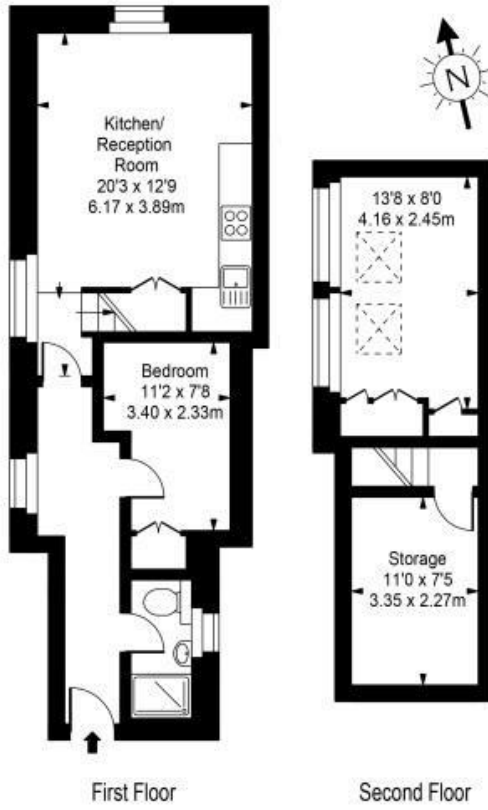

Approx Gross Internal Area **670 Sq Ft - 62.20 Sq M**

For Illustration Purposes Only - Not To Scale
Floor plan by www.creativeplanetk.com