



# RR-COM5500 COMPRESSION LOAD CELL

RAISING EXPECTATIONS

The **RR-COM5500** is a compression load cell from Red Rooster Lifting's load measuring equipment range. The cells range in capacity from 0.5 kN to 50 kN.

This compression load cell is manufactured in a range of capacities from 0.5 kN to 50 kN from high strength aluminium. It can be wired for tension or compression.

High quality gauges are used throughout the range to deliver a high accuracy.

High standard IP protection against water and dust ingress to IP66.

It is supplied as standard with an individual hand held display per load cell, or can be supplied as a system with multiple cells configured to one display.

Various fittings can be screwed into the M12/M20 threaded holes, such as eye bolts, clevises and rods.



## TECHNICAL SPECIFICATION

STANDARD LOAD RANGES	kN	0.5, 1, 2.5, 5, 10, 20, 50
SAFE SERVICE LOAD	%	150
ULTIMATE LOAD	%	300
INPUT RESISTANCE	$\Omega$	380 +/- 30
OUTPUT RESISTANCE	$\Omega$	350 +/- 2
CREEP AFTER 30 MINS (20°C)	%	< +/- 0.05%
OPERATIONAL TEMP RANGE	°C	-20 to +70
ENVIRONMENTAL PROTECTION	IP68	
CABLE LENGTH	METRES	3
INSULATION	G $\Omega$	>2 at 100V.dc
Electrical Connections 6 Core Cable, Wired in Compression Mode		
RED	+ Input	
BLUE	- Input	
YELLOW	- Output	
GREEN	+ Output	
BLACK/WHITE	Preset Cal Ref	

T: +44 (0) 1651 872101  
sales@redroosterlifting.com



# RR-COM5500

## COMPRESSION LOAD CELL

### DIMENSIONS

All measurements are in mm  
Information subject to change without notice

RAISING EXPECTATIONS

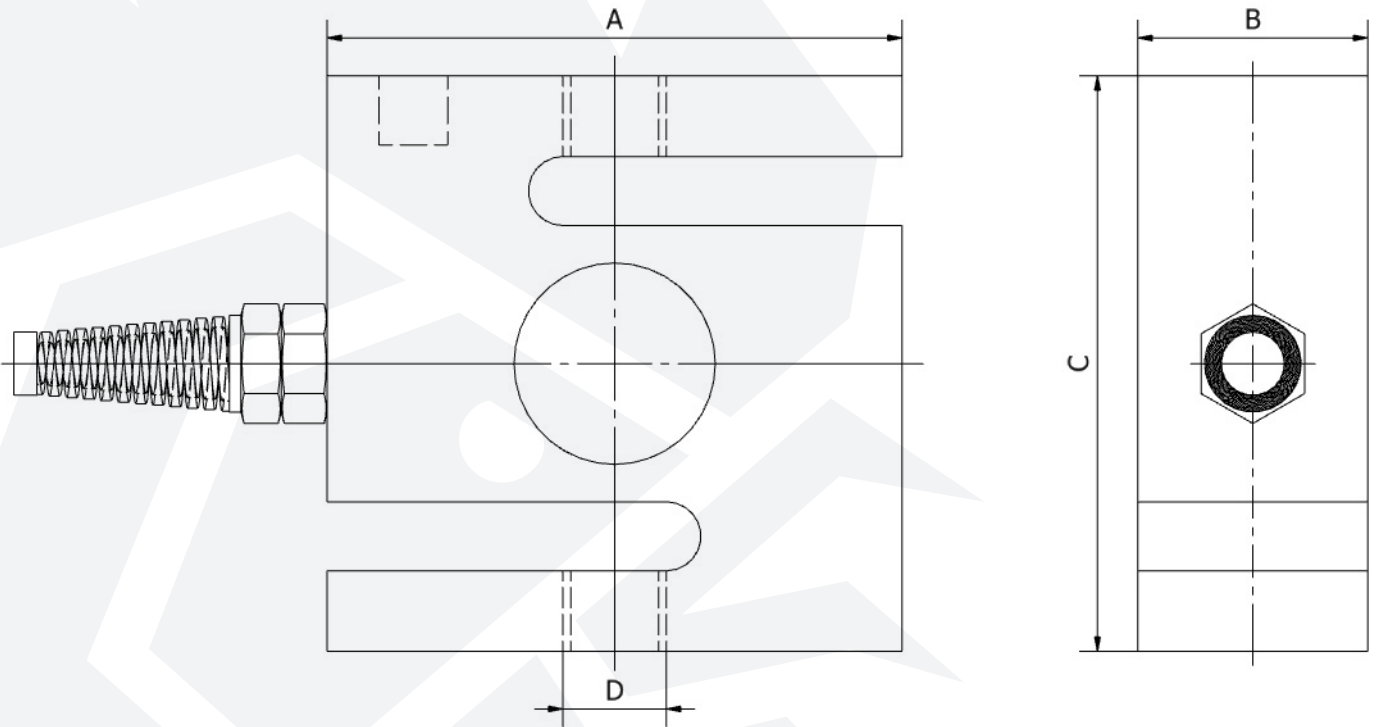

DIMENSIONS				
CAPACITY	A	B	C	D
0 - 0.5, 1, 2.5, 5kN	70.0	25.0	75.0	M12
0 - 10, 20kN	75.0	30.0	100.0	M20
0 - 50kN	100.0	30.0	120.0	M20

T: +44 (0) 1651 872101  
sales@redroosterlifting.com