

# KAPTECH

## CONVOLUTED PTFE PROCESS HOSE ASSEMBLIES

### PTFE 5000 CORROFLON

- **Excellent flexibility**  
Convoluted tube allows tight, kink-free bends and ease of handling.
- **Self-cleaning**  
The non-stick nature of the tube and the low angle of the convolutions ensure excellent cleanability.
- **Hygienic**  
Manufactured from FDA-approved PTFE.
- **Heat-resistant**  
Usable up to 260°C, dependent on specification and application details.
- **Excellent steam resistance**  
Longer service life than rubber steam hoses.
- **Durable**  
Tough outer braid protects against abrasion and damage.
- **Vacuum resistant**  
Usable with full vacuum (sizes up to 2" nb, max 130°C) dependent on specification and application details.
- **Sizes:** 1/2" up to 6" nb.
- **Wide range of end fittings:** BSP, NPT, flanges, hygienic type, etc.

- **Excellent chemical resistance**  
Inert to all but a handful of uncommon chemicals.
- **Low flow-resistance**  
The smooth low-friction tube and low angle of the convolutions give good flow capacity.

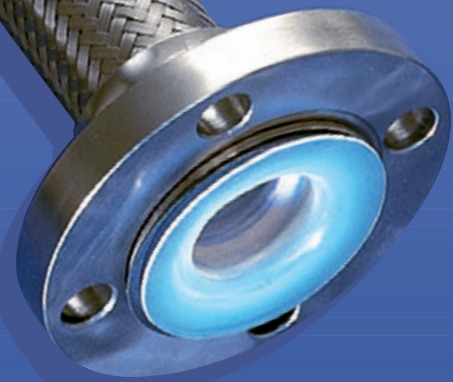
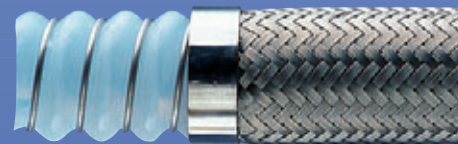

FS 28046



**HOSE & COUPLINGS DIVISION**

For capabilities and general technical data, see overleaf

# KAPTECH

## PTFE 5000 CORROFLON - CONVOLUTED PTFE PROCESS HOSE ASSEMBLIES

Kaptech PTFE 5000 Corroflon convoluted PTFE hose is widely regarded as the optimum choice for process applications, especially in the pharmaceuticals, food and chemicals industries.

**Anti-static:** In addition to the standard translucent tube, Kaptech PTFE 5000 Corroflon hose is available with an anti-static black PTFE tube (AS). This is designed for applications where fluids with a high electrical resistance such as solvents and fuels are passed through the hose and allows the dissipation of any static charge in accordance with BS2050: 1978.

**Tube Only:** An unbraided tube-only option (TO) is also available for applications where a translucent, low-pressure hose is required. Other specialist PTFE tubes are available to special order.

**Braid Options:** Kaptech PTFE 5000 Corroflon PTFE hose is provided as standard with an external stainless steel braid. It is also available with a polymer braid (PB) manufactured from a polypropylene yarn which provides a lightweight braid with excellent chemical resistance and comfortable handling characteristics. Other specialist braids and covers are available to special order.



### Pressure range.

Pressure ratings shown are for PTFE 5000-SS (stainless braid) at ambient temperature. For versions with other braid or tube-only (TO) options, please contact Guyson Technical Department.

Max working pressures are based on a 4:1 factor of safety on the burst pressures.

### Temperature range.

Usable from -73°C to +260°C dependent on specification and application details, please consult Guyson Technical Department.

Other Kaptech PTFE hoses available include: PTFE 1000 smooth bore, PTFE 3000 convoluted (industrial applications), PTFE 4000 Hyperline smooth bore (industrial applications) and Bioflex smooth bore (process applications). PTFE moulded & 'V' type bellows are also available to special order.

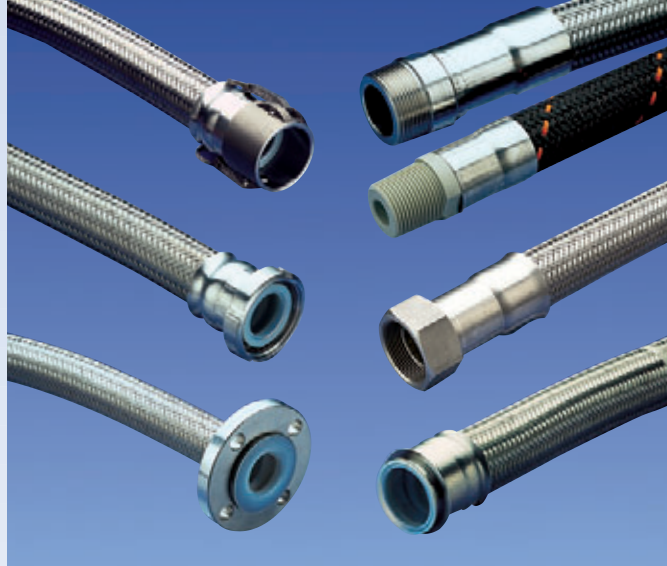

### End Fittings.

Kaptech PTFE 5000 Corroflon hose assemblies can be fitted with all conventional types of end fittings. Standard types include BSP and NPT threaded fittings in zinc-plated mild steel and 316SS; swivel flanges in 304, 316SS and polypropylene are also options. A full range of hygienic type end fittings such as RJT, IDF and Tri-clamp are available, and these can be PTFE-lined where the sealing technique allows. Cuffed ends suitable for customers to attach their own fittings are available to special order.

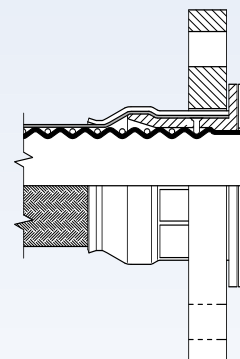

### Stainless Steel Braided

Bore Size	Minimum Bend Radius	Maximum Working Pressure	Weight Per Metre	Maximum Cont. Length
Inches	mm	bar	kg	m
1/2	38	41	0.330	28
3/4	51	35	0.450	30
1	70	31	0.700	40
1 1/4	82	27	0.820	30
1 1/2	100	23	1.500	25
2	140	20	2.100	18
2 1/2	178	16	2.580	13
3	230	14	3.290	10
4	300	10	5.050	5
6	600	5	10.000	4

Pressure ratings shown are valid for Group 2 fluids only [per Pressure Equipment Directive 97/23/EC, Art.9 (2) ]. Consult Guyson Technical Department for Group 1 (dangerous) fluids ratings.



**GUYSON INTERNATIONAL LIMITED**

**HOSE & COUPLINGS DIVISION**

Southview Business Park, Guiseley, Leeds LS20 9PR Tel: 01943 870044

e-mail: leeds@guyson.co.uk web: www.guyson.co.uk

