

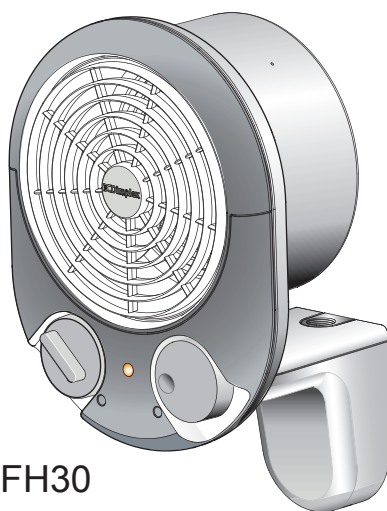

PFH30 & PFH30R Compact Commercial Fan Heaters



PFH30



PFH30R



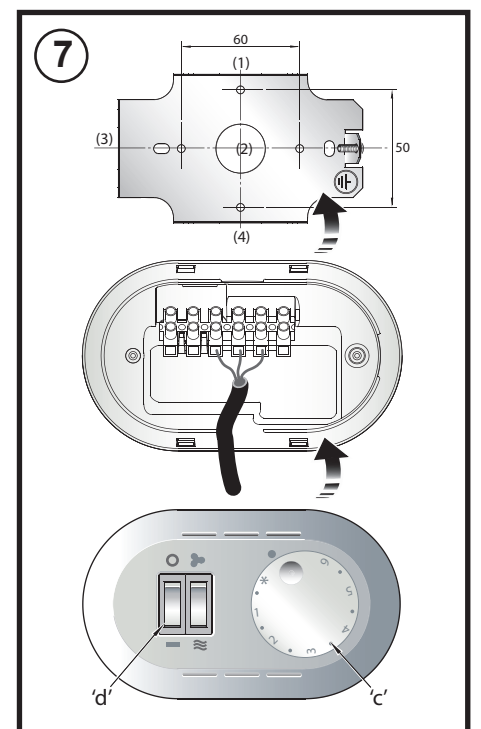
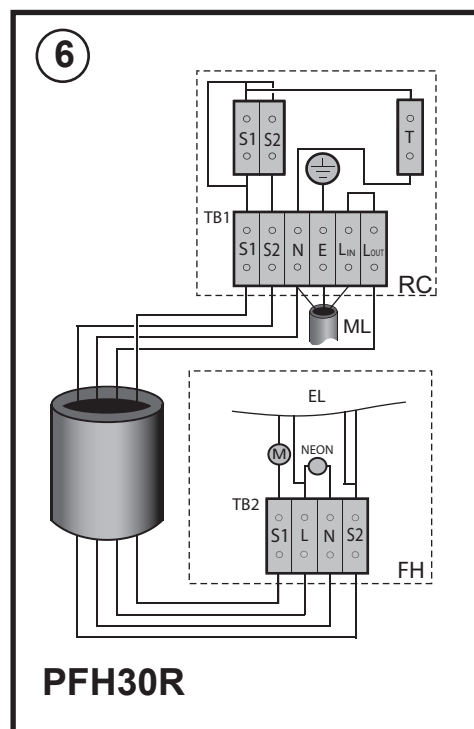
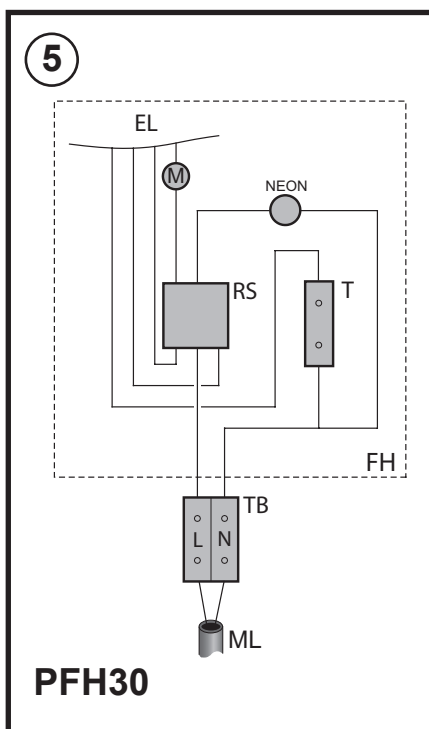
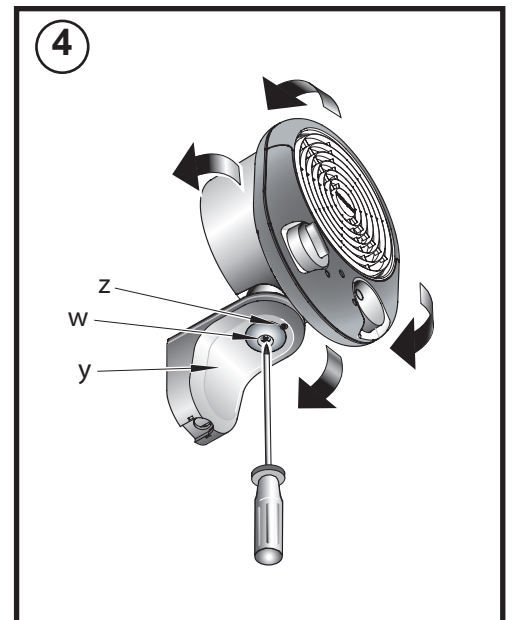
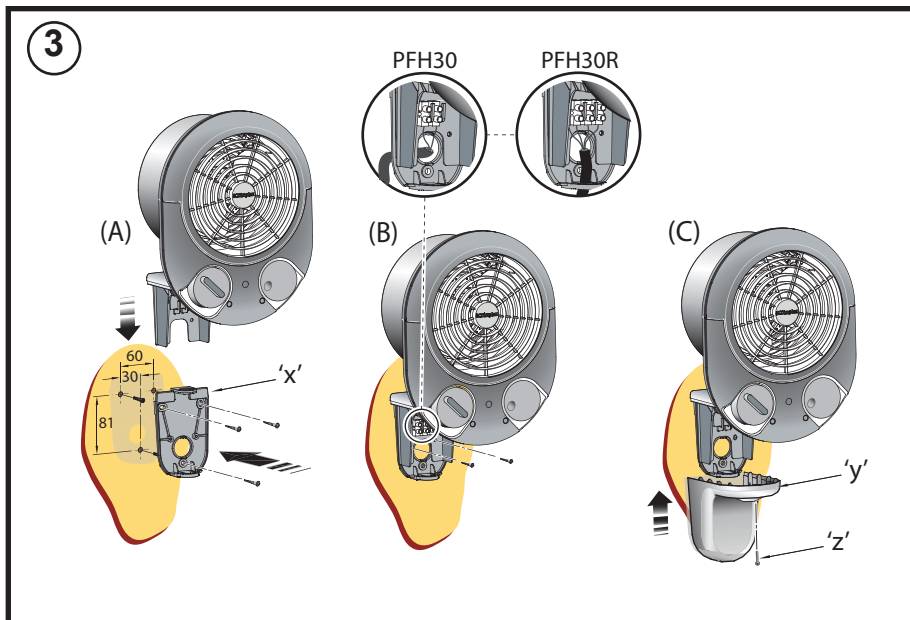
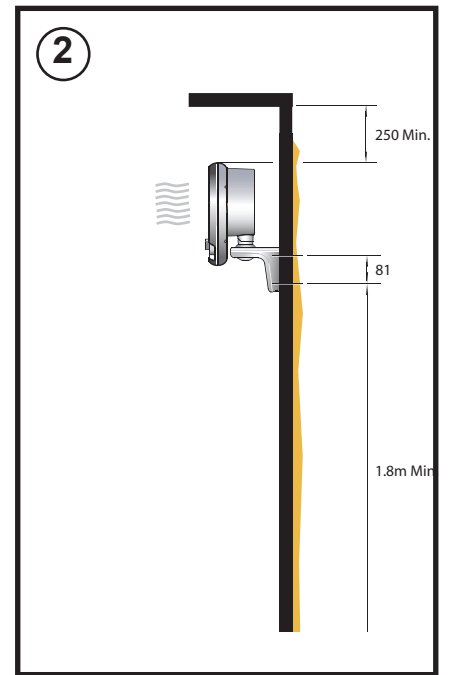
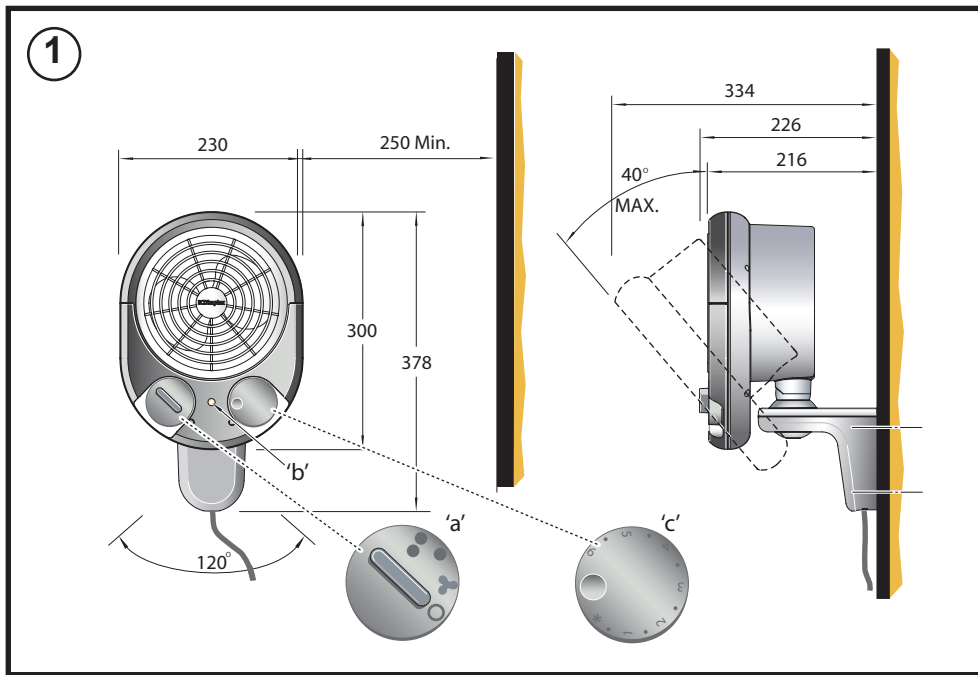

Dimplex Compact Commercial Fan Heater

Models : PFH30 and PFH30R (Remote Control)

IMPORTANT : THESE INSTRUCTIONS SHOULD BE READ CAREFULLY AND RETAINED FOR FUTURE REFERENCE

Important Safety Advice

DO NOT use the heater in the immediate surroundings of a bath, a shower or a swimming pool.

DO NOT place the heater directly below a fixed socket outlet.

DO NOT COVER or obstruct the air inlet and outlet openings in any way.

DO NOT operate the heater with the mains lead overhanging the front outlet grille.



The heater carries the warning symbol to indicate that it must not be covered.

WARNING: In order to avoid overheating do not cover the heater.

The instruction leaflet belongs to the appliance and must be kept in a safe place. If changing owners, the leaflet must be surrendered to the new owner.

IMPORTANT: If the mains lead of this appliance is damaged, it must be replaced by the manufacturer or its service agent or a similarly qualified person in order to avoid a hazard.

WARNING: In order to avoid a hazard due to inadvertent resetting of the thermal cut-out, this appliance must not be supplied through an external switching device, such as a timer, or connected to a circuit that is regularly switched on and off by the utility.

This appliance can be used by children aged from 8 years and above and persons with reduced physical, sensory or mental capabilities or lack of experience or knowledge if they have been given supervision or instruction concerning the use of the appliance in a safe way and understand the hazards involved. Children shall not play with the appliance. Cleaning and user maintenance shall not be made by children without supervision.

Children of less than 3 years should be kept away unless continuously supervised. Children aged from 3 years and less than 8 years shall only switch on/off the appliance provided that it has been placed or installed in its intended normal operating position and they have been given supervision or instruction concerning the use of the appliance in a safe way and understand the hazards involved. Children aged from 3 years and less than 8 years shall not plug in, regulate and clean the appliance or perform user maintenance.

CAUTION: Some parts of this product can become very hot and cause burns. Particular attention has to be given where children and vulnerable people are present.

Avoid use of an extension cord because the extension cord may overheat and cause risk of fire.

Ensure the PFH30R remote control unit is earthed. Always disconnect the supply before working on the product. Always ensure combustible materials such as drapes or other furnishings are kept clear of the air inlet and air outlet. This product should be mounted safely to a solid wall. Ensure the supply cables are of adequate current carrying capacity and are protected by a suitable fuse.

General

Thank you for purchasing this high power wall mounted fan heater. Designed to provide heating for small commercial environments such as garages and workshops.

The heaters work by gradually raising the air temperature in a garage or workshop and should be positioned at head height approximately (1.8m - 2.3m - see **Fig. 2**) where the controls can be reached.

The PFH30 and PFH30R heaters have an output of 3kW.

The angle the appliance is mounted at may be adjusted horizontally and vertically - see **Fig. 1** and **Fig. 4**.

Electrical

The installation of this appliance should be carried out by a competent electrician and be in accordance with the current IEE wiring regulations. The supply cable is not supplied with the appliance.

Note: A suitable local isolating switch must be provided in the electrical supply circuit as close as possible to the heater with at least 3mm clearance on each pole.

Wall Mounting

Remove the screw (see 'z' in **Fig. 3C**) to remove the cover bracket. Use the wall mounting bracket (see 'x' in **Fig. 3A**) as a guide to mark off the hole positions on a suitable wall (a minimum height of 1.8 metres is required from the floor level to the bottom hole of the bracket - see **Fig. 2**). Solid brick or concrete block walls must be drilled and plugged using the screws and wall plugs provided. Fix the wall mounting bracket to the wall and slide the heater down on to the bracket as shown in **Fig. 3A**.

Note: Ensure there is enough clearance above the wall mounting bracket for the user to slide the heater onto the bracket.

The heater is held in place to the wall mounting bracket with 2 screws - see **Fig. 3B**.

Once electrical connections have been completed - see 'Electrical Installation', re-attach the bracket cover (see 'y' in **Fig. 3C**) by sliding into place and secure with the screw - see 'z' in **Fig. 3C**.

Pivot and rotate the heater into the desired position and tighten the screw to secure - see 'w' in **Fig. 4**.

Electrical Installation

Before undertaking electrical installation, ensure the electricity supply is disconnected from any relevant fixed wiring. With the bracket cover removed proceed to feed the supply cord through the cable entry at the bottom of the mounting bracket (drill knock-out to suit).

PFH30R Remote Control - see Fig. 6

Remove the wall mounting bracket from the remote control unit. Feed the supply cord through the desired cable entry (1-4 see Fig. 7). Connect the mains lead (ML) to terminal block - see Fig. 6. Connect the 4 core cable (not supplied) from the remote control to the appliance - see Fig. 6.

Key - see Wiring Diagrams Fig. 5 -PFH30 & Fig. 6-PFH30R

RS	Rotary Switch	TB	Terminal Block
ML	Mains Lead	TB1	Terminal Block 1
S1	Switch 1	TB2	Terminal Block 2
S2	Switch 2	T	Thermostat
EL	Element	L	Live
N	Neutral	E	Earth
L in	Live In	L out	Live Out
M	Motor	NEON	Neon
RC	Remote Control	FH	Fan Heater

Note: All 4 core cable wires must be 1.5mm²

* When the heat control is set to 'Cool Blow' for cool blow, set the thermostat control to maximum.





Position 'Cool Blow' will turn the heater on and off to maintain a temperature of approximately 5°C.

Controls - PFH30 - see Fig. 1

The mains neon (see 'b' in Fig. 1) will light up to show that the heater is connected to the mains supply.

Heat Control - see 'a' in Fig. 1

The heat control positions are as follows:

-  - OFF
-  - Cool Blow*
-  - Half heat
-  - Full heat

Thermostat Control - see 'c' in Fig. 1

The heat output is controlled by the thermostat, according to the room temperature.

Turn the thermostat knob fully clockwise to maximum setting initially. When the room is warm enough, reduce the setting slowly until the heater just clicks off.

The heater will now cycle on and off to maintain your selected room temperature. An audible click may be heard when the thermostat operates - this is normal.

Note : If the heater does not come on when the thermostat is at a low setting, this is normally because the room is warmer than the thermostat setting and is not a fault.

Controls - PFH30R

The PFH30R is supplied with a wall mounted control unit. This may be mounted on a wall in a convenient location away from direct sunlight or draughty areas.

Using the mounting bracket as a guide, mark the hole positions and drill and plug the wall to suit using the screws and wall plugs provided.

The heat output is controlled by the thermostat, according to the room temperature.

Turn the thermostat knob fully clockwise to maximum setting initially. When the room is warm enough, reduce the setting slowly until the heater just clicks off.

The heater will now cycle on and off to maintain your selected room temperature. An audible click may be heard when the thermostat operates - this is normal.

Note : If the heater does not come on when the thermostat is at a low setting, this is normally because the room is warmer than the thermostat setting and is not a fault.

Thermal Safety Cut-outs

The power supply to the heater may also be interrupted if one or a combination of the following abnormal events occurs:

1. Air inlet or outlet grilles are obstructed.
2. Internal ventilation is impaired due to build up of dust and fluff.
3. Blower unit stalls.

In the event that the above events occur the cut-out switches off the heater automatically. To bring the heater back into operation, remove the cause of the overheating, then turn off the electrical supply to the heater for a few minutes. When the heater has cooled sufficiently re-connect and switch on the heater.

If the cut-out operates repeatedly, contact your supplier.

Recycling



For electrical products sold within the European Community.

At the end of the electrical products useful life it should not be disposed of with household waste. Please recycle where facilities exist. Check with your local authority or retailer for recycling advice in your country.

Cleaning

WARNING: DISCONNECT SUPPLY before carrying out maintenance.

External appearance can be maintained by wiping occasionally with a damp cloth. For stain removal, a weak soap solution can be applied with a cloth and the surface wiped dry. Care must be taken to avoid any moisture ingress into the product.

After Sales Service

Your product is guaranteed for one year from the date of purchase. After sales information or assistance with this product can be found on our website:

www.dimplex.co.uk/support.

Your rights under this guarantee are additional to your statutory rights, which in turn are not affected by this guarantee.

Please do not return a faulty product to us as this may result in loss or damage and delay in providing you with a satisfactory service.

If after following these steps your product still does not operate you should return it to your point of purchase.

Please retain your receipt as proof of purchase.