

Fairfield

V241 EXPOSED ½"
VOLUME FLOW CONTROL

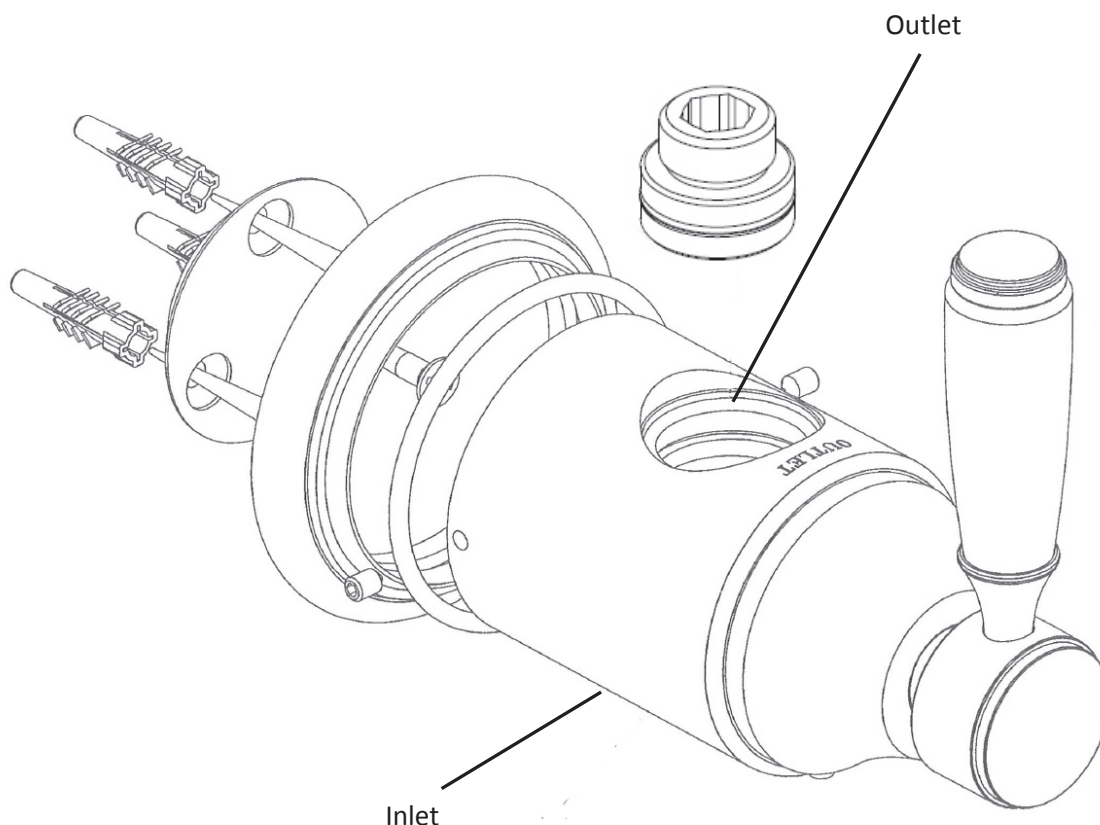

INSTALLATION INSTRUCTIONS



Use the backplate as a template to mark off the fixing holes.

Drill holes then wall plug and screw back plate accordingly.

Fit the volume / flow control back plate by securing grub screws

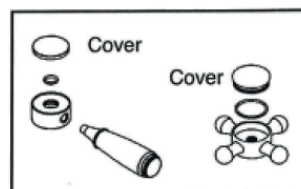

Choice of Lever / Cross top

SAMUEL HEATH
for a life less ordinary

Remove the valve body from its back plate by releasing the grub screw.
Set the valve body back plate at the required height then mark and drill screw holes and fix the back plate.

Fit both supply elbows to the valve then offer the valve to the back plate to allow you to mark off the supply lines.

Fit the riser extension to the valve body, ensuring 'o' ring is well lubricated (spares included)

Torque into place using a 5/8" hex key. Fit the volume control including its back plate to the riser extension.

With the valve body fitted to its back plate, mark around the volume control back plate (thus achieving a template) then remove the valve body, direct coupler and volume control complete.

Remove the volume control back plate by releasing the grub screw and place the volume control back plate to your template then mark off and drill the Back plate fixing holes before fitting the back plate to the wall.

Secure both the valve body and the volume control to their back plates by tightening the grub screws. Then tighten all supply connections.

Fit riser to volume control body marking off, drilling and fixing riser bracket at the desired height.

The temperature of the valve is factory set at approximately 43°C.
To fitting the lever or cross top control to the unit simply locate the central screw through the lever or cross top into the spline adaptor and ease onto the spline and replace the cover.

Additional Information

This Thermostatic valve is suitable for use with all water systems up to a maximum operating pressure of 5.0 Bar, (beyond which we recommend pressure reducing valves be fitted).

The valve has check valves fitted on both hot and cold inlets within the valve. Filters are fitted within both supply elbows.

IMPORTANT

It is essential that both hot and cold supply lines are thoroughly flushed out before installation.

In hard water areas it is recommended that a suitable Water filtration unit be fitted

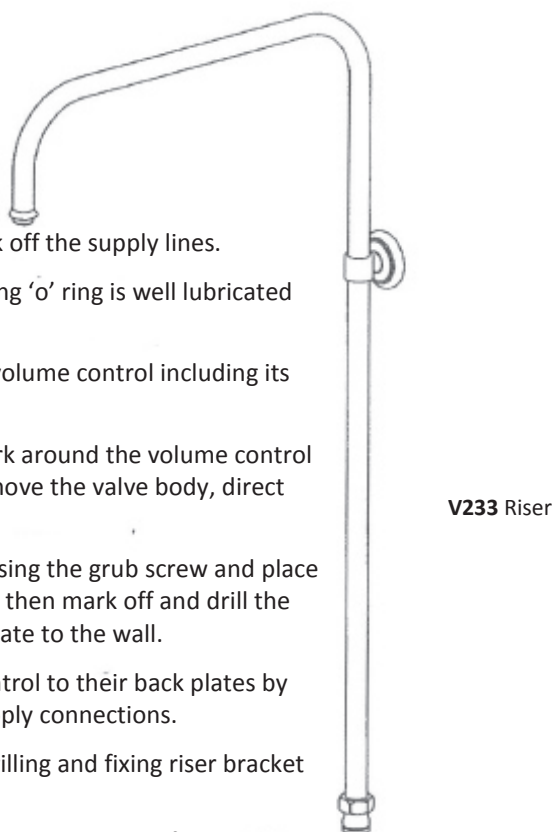

V233 Riser



V241/T Volume control and back plate

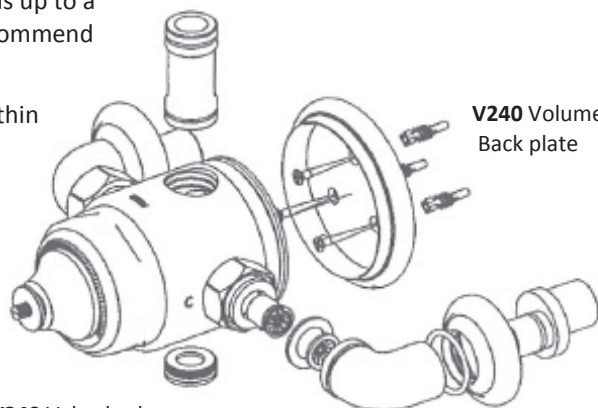

V240 Volume body Back plate

V240 Valve body

V240 Supply elbow and offset connector

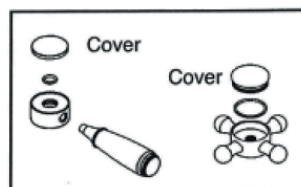

Choice of Lever / Cross top

SAMUEL HEATH
for a life less ordinary

Sales Office Direct Line: +44 (0)121 766 4200
e-mail: info@samuel-heath.com