

# SAMUEL HEATH

## Product Data Sheet

### Door Furniture Sets with Concealed Fixing

(Includes Anti-Rotation Grub Screws)

**Pre-Installation** - We recommend the use of a good quality latch for our solid door furniture, heavy sprung if using our unsprung lever handles.

1. Drill door to diameter of chassis centre  $\frac{3}{4}$ " (19mm) .
  2. Feed spindle through lock follower with spindle slot facing down.
  3. Offer the chassis to the door over spindle (leave unscrewed) then slide the alignment washer over the spindle to ensure that it is aligned correctly with the middle of the chassis.
  4. Screw the chassis to the door.
  5. Repeat sections 3 and 4 on the other side of the door.
  6. Discard alignment washers once both chassis are installed correctly.
  7. With spindle set centrally screw on roses until both are flush with the door.
  8. Complete the installation as per the main diagram (overleaf).
  9. When fitting the furniture the grub screw should be tightened securely into the spindle slot which should be facing down.
- Spindle supplied will suit standard 1  $\frac{3}{4}$ " (44mm) door.
  - If spindle length requires reducing, cut equal off both ends.
  - Longer spindle available to order Ref: P9949.xx (Plain Slotted)

**WARNING: IF THE GRUB SCREW IS NOT TIGHTENED SECURELY INTO THE SLOT THE FURNITURE MAY BECOME LOOSE**

**SAMUEL HEATH**  
**Head Office and Customer Service**  
Leopold Street  
Birmingham  
England  
B12 0UJ

T: +44 (0)121 766 4200  
F: +44 (0)121 772 3334

Info@samuel-heath.com  
www.samuel-heath.com

**US Customer Service**  
Federal I.D. No. 58-1504682  
www.samuel-heath.com

9-1884  
Issue: C

# Fitting Instructions

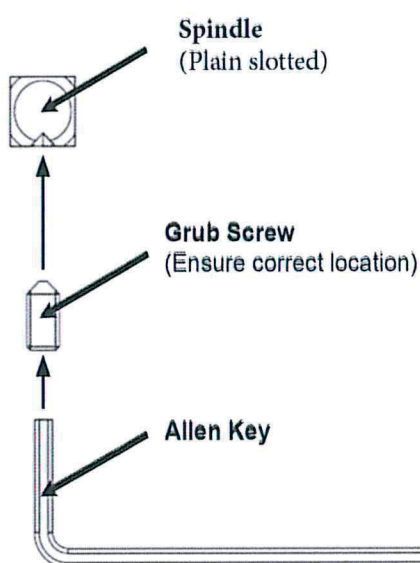
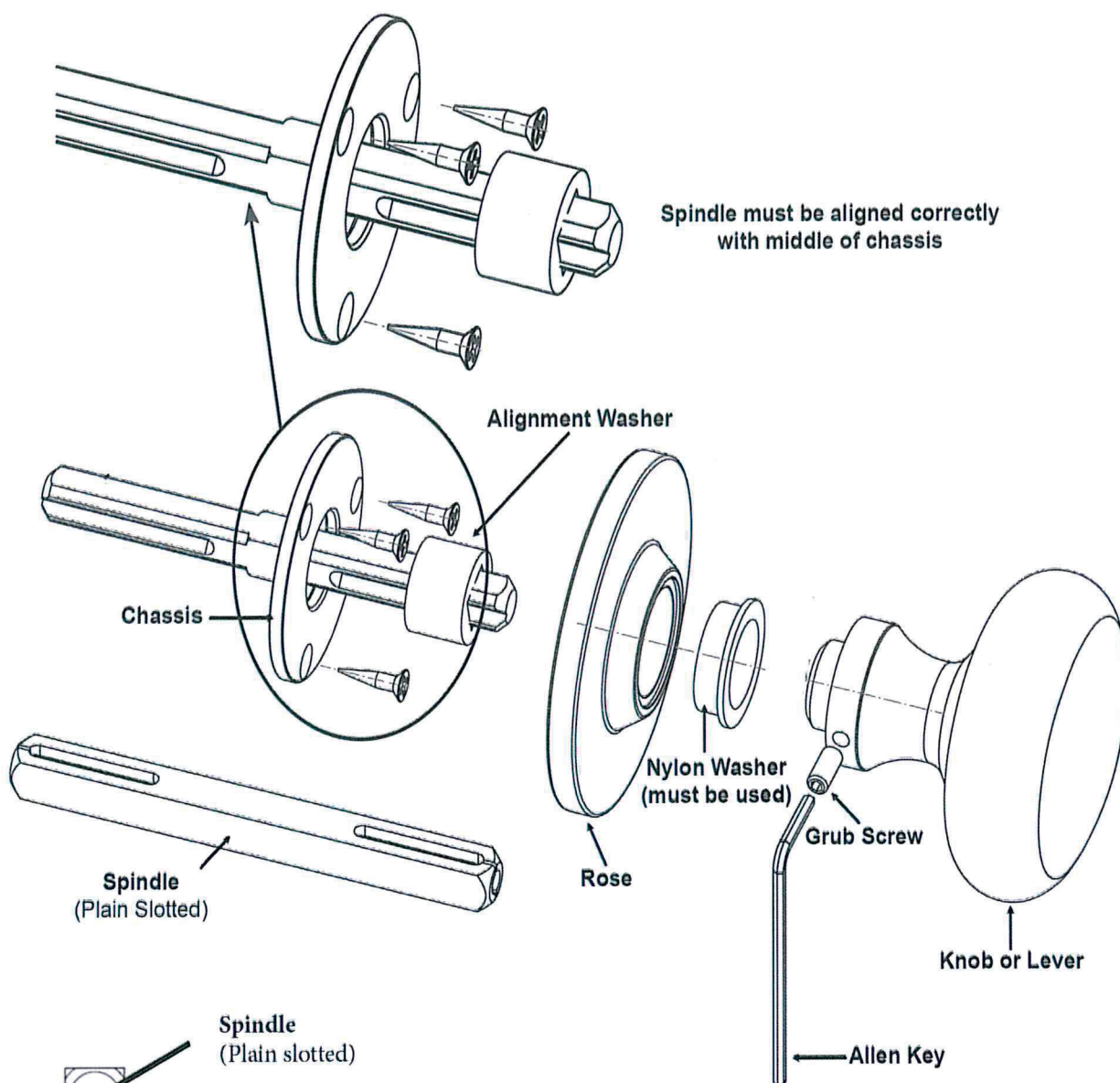

**WARNING: IF THE GRUB SCREW IS NOT TIGHTENED INTO THE SLOT SECURELY THE FURNITURE MAY BECOME LOOSE**

## **PLEASE NOTE:**

For illustration purposes the grub screw is shown here in a side view. To keep the fixing obscured it's recommended that the knob is positioned with the grub screw hole facing downward.