

SAMUEL HEATH

Product Data Sheet

N6762-B Shower Door Handle



Front



Back

Dimension Key

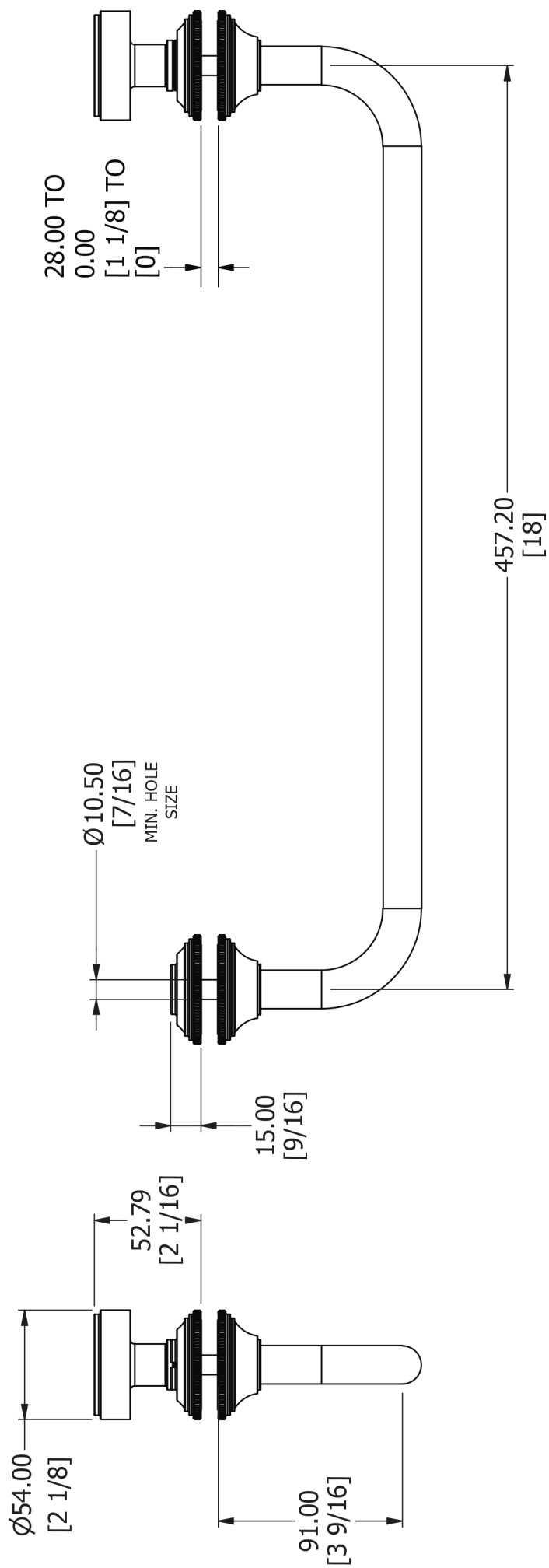
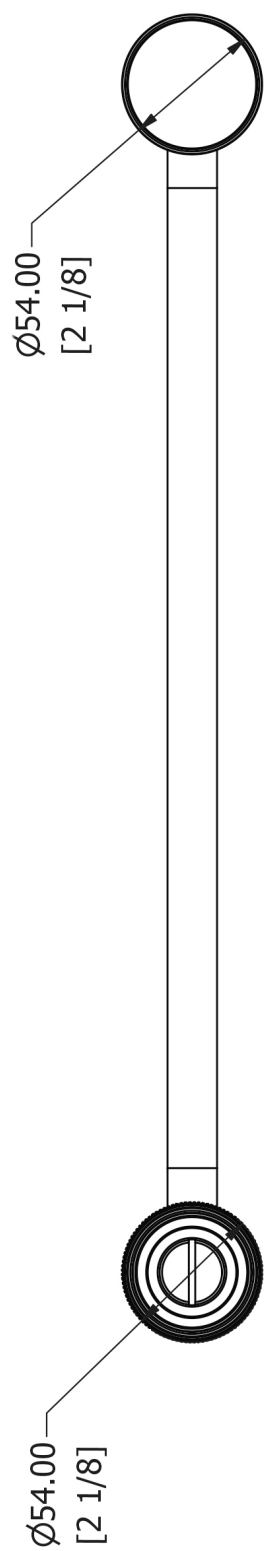

Installation

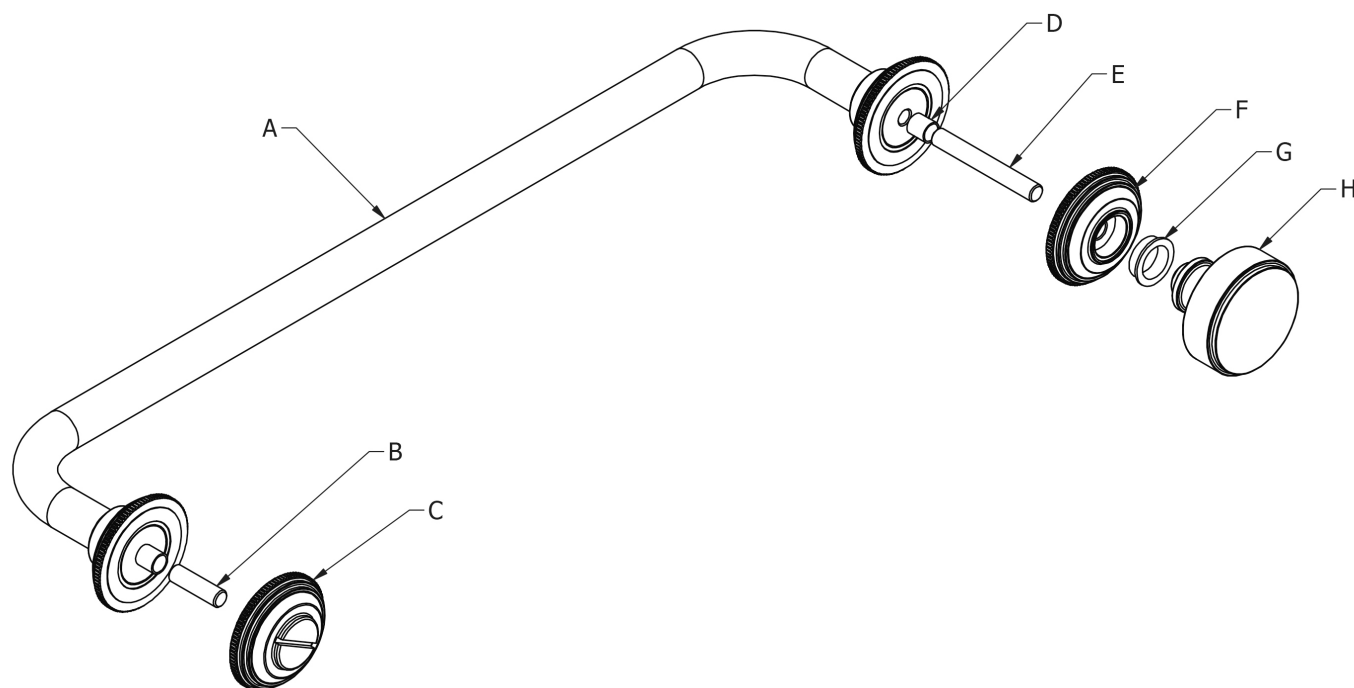

1. Screw all-threads “B” and “E” into the rail “A”, ensuring they feed through washers “D”
2. Pass the all-threads through the pre-drilled holes in the glass shower door.
3. Secure in place by assembling blanking cap “C”
4. Pass the rose “F” and washer “G” over the second all-thread and secure with knob “H”

Note: Use a suitable thread locking adhesive on components B & E

SAMUEL HEATH
Head Office and Customer Service
Leopold Street
Birmingham
England
B12 0UJ

T: +44 (0)121 766 4200
F: +44 (0)121 772 3334

Info@samuel-heath.com
www.samuel-heath.com

US Customer Service
usa@samuel-heath.com
Federal I.D. No. 58-1504682
www.samuel-heath.com/us

9-3032
Issue: C