

SAMUEL HEATH

Product Data Sheet

P6041/ P6045/ P6047 Door Handle

For use with P8020/ P8021/ P8023/ P8025/ P8026/ P8030/ P8031/
P8033/ P8035/ P8036 (Includes Anti-Rotation Grub Screw)



P6045



P6047

Fitting Instructions

Pre-Installation - A heavy sprung latch must be used with this solid door furniture.

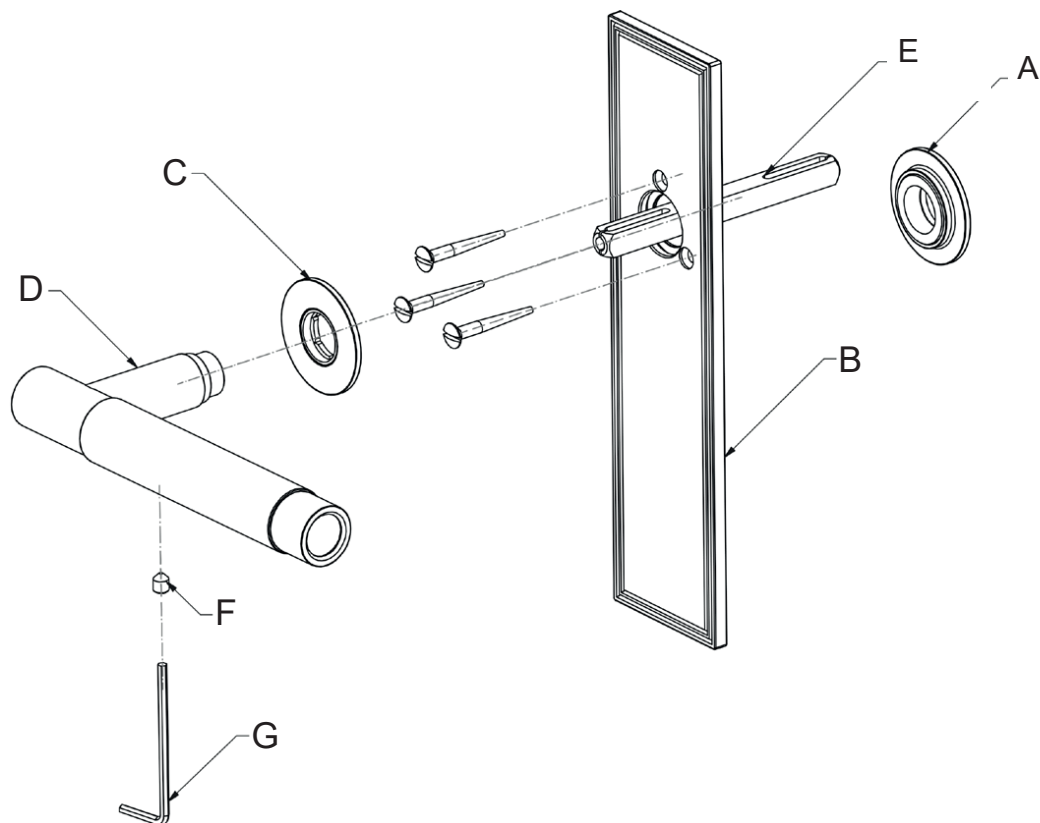

Item	Description	QTY
A	Cover With Back Plate	2
B	Back Plate (Sold Separately)	2
C	Cover for Handle Assembly	2
D	Handle Assembly	2
E	Spindle	1
F	Grub Screw	2
G	Allen Key	1

Fitting Instructions

1. Discard covers (A) on back plates as shown in the 9-1928 Concealed Back Plates Data Sheet.
 2. Fit back plate (B) as shown in the 9-1928 Concealed Back Plates Data Sheet.
 3. Screw the cover (C) included with levers onto plate (B) to conceal the fixing screws.
 4. Push handle (D) through cover (C) on to spindle (E).
 5. Secure handle (D) to spindle (E) using grub screw (F) & Allen key (G).
 6. Repeat on other side of the door.
 7. When fitting the furniture the grub screw should be tightened securely into the spindle slot which should be facing down.
- Spindle supplied will suit standard 1 3/4" (44mm) door.
 - If spindle length requires reducing, cut equal off both ends.
 - Longer spindles available to order. Ref: P9949.xx (Plain Slotted).

**WARNING: IF THE GRUB SCREW IS NOT TIGHTENED
SECURELY INTO THE SLOT
THE FURNITURE MAY COME LOOSE**

SAMUEL HEATH
Head Office and Customer Service
Leopold Street
Birmingham
England
B12 0UJ

T: +44 (0)121 766 4200

Info@samuel-heath.com
www.samuel-heath.co.uk

US Customer Service
usa@samuel-heath.com
Federal I.D. No. 58-1504682
www.samuel-heath.com

9-3038
Issue: E